



Chipsmall Limited consists of a professional team with an average of over 10 year of expertise in the distribution of electronic components. Based in Hongkong, we have already established firm and mutual-benefit business relationships with customers from,Europe,America and south Asia,supplying obsolete and hard-to-find components to meet their specific needs.

With the principle of “Quality Parts,Customers Priority,Honest Operation,and Considerate Service”,our business mainly focus on the distribution of electronic components. Line cards we deal with include Microchip,ALPS,ROHM,Xilinx,Pulse,ON,Everlight and Freescale. Main products comprise IC,Modules,Potentiometer,IC Socket,Relay,Connector.Our parts cover such applications as commercial,industrial, and automotives areas.

We are looking forward to setting up business relationship with you and hope to provide you with the best service and solution. Let us make a better world for our industry!



## Contact us

Tel: +86-755-8981 8866 Fax: +86-755-8427 6832

Email & Skype: [info@chipsmall.com](mailto:info@chipsmall.com) Web: [www.chipsmall.com](http://www.chipsmall.com)

Address: A1208, Overseas Decoration Building, #122 Zhenhua RD., Futian, Shenzhen, China



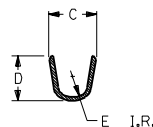
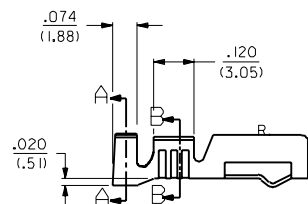
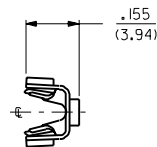
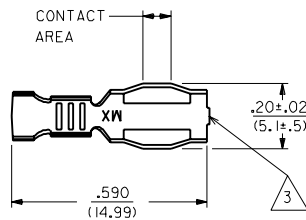

SECTION A-A

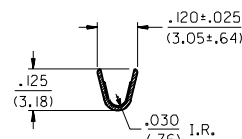

SECTION B-B

NOTES:

- 1 THESE TERMINALS ARE FOR USE WITH THE 1461-1\* SERIES HOUSINGS.
- THE -1\* GROUP CRIMPS #18 TO #22 AWG WIRE WITH INSULATION DIAMETERS OF .061/(1.55) TO .102/(2.59).
- THE -2\* GROUP CRIMPS #14 TO #16 AWG WIRE WITH AN INSULATION DIAMETER OF .140/(3.56) MAX.
- 2 THESE TERMINALS ARE PRODUCED ONLY FOR EXPORT TO JAPAN.
- 3 CARRIER CUT OFF DIMENSION: .007/(.18) MAX.
- 4 PRODUCT SPECIFICATION PS 50-36 APPLIES.
- 5 A 4° ANGLE IS ALLOWED.

MATERIAL:  
260 BRASS

PART NO.	ENG. NO.	DIM. C	DIM. D	DIM. E	FORM	PLATING PER SD5-
05-02-0047	I457-1	.145±.025 (3.68±.64)	.135 (3.43)	.045 (1.14)	CHAIN	88-P901 TIN
05-02-0048	I457-1L	.145±.025 (3.68±.64)	.135 (3.43)	.045 (1.14)	LOOSE	88-P550 SEL. GOLD
05-02-0056	I457-1GL	.145±.025 (3.68±.64)	.135 (3.43)	.045 (1.14)	LOOSE	88-P555 SEL. GOLD
05-02-0058	I457-1(P555)	.145±.025 (3.68±.64)	.135 (3.43)	.045 (1.14)	LOOSE	88-P901 TIN
	I457-1(P555)L	.145±.025 (3.68±.64)	.135 (3.43)	.045 (1.14)	LOOSE	88-P901 TIN
05-02-0049	I457-2	.21±.03 (5.3±.8)	.185±.015 (4.70±.38)	.060 (1.52)	CHAIN	88-P901 TIN
05-02-0050	I457-2L	.21±.03 (5.3±.8)	.185±.015 (4.70±.38)	.060 (1.52)	LOOSE	88-P901 TIN

			S	REV ADD -6* ECR U60463 12-19-95 SAMIEC	DIMENSIONS SHOWN (METRIC) INCH UNLESS OTHERWISE SPECIFIED TOLERANCES: ANGULAR ± .5°			▽ = 0 ▼ = 0	REVISE ONLY ON CAD SYSTEM					
			RI	ADDED OPTION ECN #13, 0016 01-14-93 RHR	INCH METRIC 3 PLACE ±.010 --- 2 PLACE ±.014 ±0.25 1 PLACE --- ±0.35			TITLE TERMINAL, COMMONING, CRIMP (I457-1* AND I457-2*)						
			R	ADD OPTION & REDRAW ECN #10538 02-11-91 A.GUZIK	DRAFT WHERE APPLICABLE MUST REMAIN WITHIN DIMENSIONS			MOLEX INCORPORATED LITTLE ROCK, AR 60532 U.S.A.						
								SHEET NO. 1 OF 3 DATE 02/11/91						
								PART NO. SD-I457-*						
								SEE CHART						
LTR.		REVISIONS	LTR.	REVISIONS	DRWG. BY AFG CHKD. BY GWF DWG. DATE 4:1			FILE NAME SD I457X1			THIS DRAWING CONTAINS INFORMATION THAT IS PROPRIETARY TO MOLEX INC. AND SHOULD NOT BE USED WITHOUT WRITTEN PERMISSION.		DIV. CP	SIZE