



Chipsmall Limited consists of a professional team with an average of over 10 year of expertise in the distribution of electronic components. Based in Hongkong, we have already established firm and mutual-benefit business relationships with customers from,Europe,America and south Asia,supplying obsolete and hard-to-find components to meet their specific needs.

With the principle of “Quality Parts,Customers Priority,Honest Operation,and Considerate Service”,our business mainly focus on the distribution of electronic components. Line cards we deal with include Microchip,ALPS,ROHM,Xilinx,Pulse,ON,Everlight and Freescale. Main products comprise IC,Modules,Potentiometer,IC Socket,Relay,Connector.Our parts cover such applications as commercial,industrial, and automotives areas.

We are looking forward to setting up business relationship with you and hope to provide you with the best service and solution. Let us make a better world for our industry!



Contact us

Tel: +86-755-8981 8866 Fax: +86-755-8427 6832

Email & Skype: info@chipsmall.com Web: www.chipsmall.com

Address: A1208, Overseas Decoration Building, #122 Zhenhua RD., Futian, Shenzhen, China



- NOTES:
 1. MATERIAL:PHOSPHOR BRONZE
 2. FINISH: PER ES-88
 102-TIN: .000200 MICROINCHES MIN OVER COPPER
 501-GOLD: .000020 MICROINCHES MIN OVER NICKEL
 THE PRIMARY SHIPPING CARTON WILL BE LABELED
 *COMPLIANT TO RoHS DIRECTIVE 2002/95/EC & ELV
 ANNEX II OF DIRECTIVE 2003/53/EC*. CARTONS W/O
 THIS LABEL MAY CONTAIN PRODUCT WITH TIN-LEAD
 IN THE PC TAIL AREA.
 3. PRODUCT SPECIFICATION & PROCESSING PARAMETERS: NONE.
 4. DIMENSIONS GIVEN ARE BEFORE PLATING.
 5. SOLDERABILITY SPECIFICATION: SMES-152 AFTER PLATING.
 6. CAMBER SPECIFICATION: .003 MM/MM OR .003 IN/IN.
 7. BURR SPECIFICATION ES-151.
 8. RECOMMENDED PCB HOLE SPECIFICATION FOR PRESS FIT PINS:
 .062 THK. PCB
 PUNCHED HOLES: .030±.002/.762±0.05
 DRILLED HOLES: .031±.0015/.0787±0.038
 PLATED THRU HOLES: .0295±.0025/.749±0.064

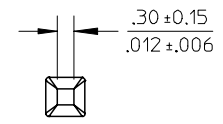
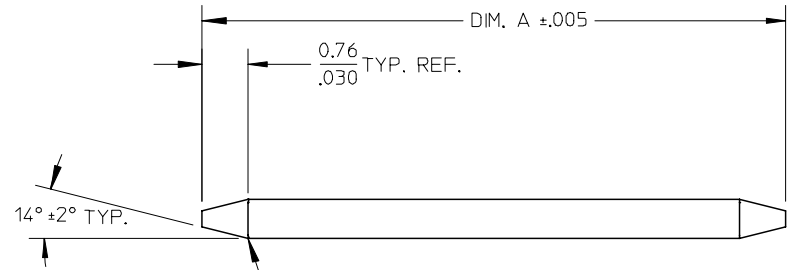

PART TO BE FREE OF ALL TOOL MARKS DUE TO COINING & TRIMMING OPERATION.

33	26.21 1.032		
31	31.75 1.250	74	31.24 1.230
30	30.48 1.200	69	20.85 .821
27	21.39 .842	68	18.29 .720
25	9.65 .380	67	16.94 .667
22	15.88 .625	66	15.49 .610
20	20.32 .800	65	14.61 .575
18	11.71 .461	64	13.08 .515
17	11.99 .472	60	10.01 .394
15	12.70 .500	58	8.56 .337
12	22.23 .875	47	19.69 .775
11	16.51 .650	46	17.86 .703
10	28.58 1.125	43	38.10 1.500
9	18.69 .736	42	13.84 .545
8	25.40 1.000	41	29.21 1.150
7	14.99 .590	40	34.93 1.375
5	11.10 .437	39	24.38 .960
4	13.46 .530	38	27.00 1.063
3	17.45 .687	37	19.05 .750
2	10.29 .405	35	23.80 .937
1	14.22 .560	34	32.26 1.270
N	DIM. A	N	DIM. A

EC NO: UCP2004-1675
 DRWN: JSCHAFFER2004/03/08
 CHK'D: 2004/03/11
 APPR: YMARGULI 2004/03/17

QUALITY SYMBOLS	GENERAL TOLERANCES (UNLESS SPECIFIED)		SCALE 8:1	DESIGN UNITS INCH	THIRD ANGLE PROJECTION	REVISE ON CAD ONLY
	mm	INCH	DIMENSION STYLE MM/IN		TITLE TERMINAL PIN 0.647.025 SQ. WIRE	
	4 PLACES ± ---	± ---	DRAWN BY SCHAFFER	DATE 2004/03/01	MOLEX INCORPORATED	
	3 PLACES ± ---	± ---	CHECKED BY SAMIEC	DATE 2004/03/04		
2 PLACES ± ---	± ---	APPROVED BY MARGULIS 2004/03/05		MATERIAL NO. SEE CHART	DOCUMENT NO. SD-4166-001	SHEET NO. 1 OF *
1 PLACE ± ---	± ---	ANGULAR ±1/2°		THIS DRAWING CONTAINS INFORMATION THAT IS PROPRIETARY TO MOLEX INCORPORATED AND SHOULD NOT BE USED WITHOUT WRITTEN PERMISSION		
DRAFT WHERE APPLICABLE MUST REMAIN WITHIN DIMENSIONS						

GEN.DOCS.	SHEETS 2-*	AJ
ANNOTATOR	SHEET 1	AJ
DOC. TYPE	SHEETS	REV.

PART NO:	ENG NO:	PART NO:	ENG NO:
	4166-1(503)		4166-33(503)
08-58-0622	4166-2(503)	08-58-0690	4166-34(503)
	4166-3(503)	08-58-0636	4166-35(503)
	4166-4(503)		4166-38(503)
08-58-0605	4166-5(503)		4166-39(503)
08-58-0607	4166-7(503)		4166-41(503)
08-58-0658	4166-8(503)		4166-42(503)
	4166-9(503)		4166-43(503)
	4166-10(503)		4166-46(503)
	4166-11(503)		4166-47(503)
	4166-12(503)		4166-58(503)
	4166-15(503)		4166-60(503)
08-58-0617	4166-17(503)		4166-64(503)
08-58-0618	4166-18(503)		4166-65(503)
	4166-20(503)		4166-66(503)
	4166-22(503)		4166-67(503)
08-58-0625	4166-25(503)		4166-68(503)
	4166-27(503)		4166-69(503)
	4166-30(503)		4166-74(503)
	4166-31(503)		

PART NO:	ENG NO:	PART NO:	ENG NO:
	4166-1(505)		4166-33(505)
08-58-0652	4166-2(505)		4166-34(505)
	4166-3(505)		4166-35(505)
	4166-4(505)		4166-38(505)
	4166-5(505)		4166-39(505)
	4166-7(505)		4166-41(505)
	4166-8(505)		4166-42(505)
	4166-9(505)		4166-43(505)
	4166-10(505)		4166-46(505)
	4166-11(505)		4166-47(505)
	4166-12(505)		4166-58(505)
	4166-15(505)		4166-60(505)
	4166-17(505)		4166-64(505)
	4166-18(505)		4166-65(505)
	4166-20(505)		4166-66(505)
	4166-22(505)		4166-67(505)
	4166-25(505)		4166-68(505)
	4166-27(505)		4166-69(505)
	4166-30(505)		4166-74(505)
	4166-31(505)		

REV: AJ	SEE SHEET 1	TITLE: KK .025 SQ PIN	SHEET No. - 6 -
DOCUMENT NUMBER: SD- 4166-001	CREATED / REVISED BY: SCHAFFER	CHECKED BY: SAMIEC	APPROVED BY: MARGULIS

