



Chipsmall Limited consists of a professional team with an average of over 10 year of expertise in the distribution of electronic components. Based in Hongkong, we have already established firm and mutual-benefit business relationships with customers from,Europe,America and south Asia,supplying obsolete and hard-to-find components to meet their specific needs.

With the principle of "Quality Parts,Customers Priority,Honest Operation,and Considerate Service",our business mainly focus on the distribution of electronic components. Line cards we deal with include Microchip,ALPS,ROHM,Xilinx,Pulse,ON,Everlight and Freescale. Main products comprise IC,Modules,Potentiometer,IC Socket,Relay,Connector.Our parts cover such applications as commercial,industrial, and automotives areas.

We are looking forward to setting up business relationship with you and hope to provide you with the best service and solution. Let us make a better world for our industry!



## Contact us

Tel: +86-755-8981 8866 Fax: +86-755-8427 6832

Email & Skype: info@chipsmall.com Web: www.chipsmall.com

Address: A1208, Overseas Decoration Building, #122 Zhenhua RD., Futian, Shenzhen, China



- NOTES:  
 1. MATERIAL:PHOSPHOR BRONZE  
 2. FINISH: PER ES-88  
 102-TIN: .000200 MICROINCHES MIN OVER COPPER  
 501-GOLD: .000020 MICROINCHES MIN OVER NICKEL  
 THE PRIMARY SHIPPING CARTON WILL BE LABELED  
 \*COMPLIANT TO RoHS DIRECTIVE 2002/95/EC & ELV  
 ANNEX II OF DIRECTIVE 2003/53/EC\*. CARTONS W/O  
 THIS LABEL MAY CONTAIN PRODUCT WITH TIN-LEAD  
 IN THE PC TAIL AREA.  
 3. PRODUCT SPECIFICATION & PROCESSING PARAMETERS: NONE.  
 4. DIMENSIONS GIVEN ARE BEFORE PLATING.  
 5. SOLDERABILITY SPECIFICATION: SMES-152 AFTER PLATING.  
 6. CAMBER SPECIFICATION: .003 MM/MM OR .003 IN/IN.  
 7. BURR SPECIFICATION ES-151.  
 8. RECOMMENDED PCB HOLE SPECIFICATION FOR PRESS FIT PINS:  
 .062 THK. PCB  
 PUNCHED HOLES: .030±.002/.762±0.05  
 DRILLED HOLES: .031±.0015/.0787±0.038  
 PLATED THRU HOLES: .0295±.0025/.749±0.064

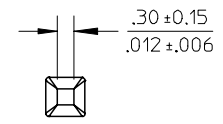
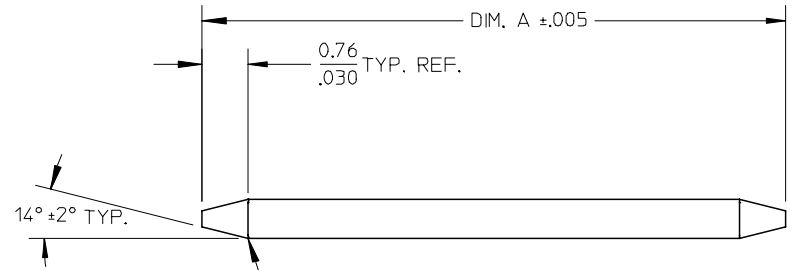

PART TO BE FREE OF ALL TOOL MARKS DUE TO COINING & TRIMMING OPERATION.

33	26.21 1.032		
31	31.75 1.250	74	31.24 1.230
30	30.48 1.200	69	20.85 .821
27	21.39 .842	68	18.29 .720
25	9.65 .380	67	16.94 .667
22	15.88 .625	66	15.49 .610
20	20.32 .800	65	14.61 .575
18	11.71 .461	64	13.08 .515
17	11.99 .472	60	10.01 .394
15	12.70 .500	58	8.56 .337
12	22.23 .875	47	19.69 .775
11	16.51 .650	46	17.86 .703
10	28.58 1.125	43	38.10 1.500
9	18.69 .736	42	13.84 .545
8	25.40 1.000	41	29.21 1.150
7	14.99 .590	40	34.93 1.375
5	11.10 .437	39	24.38 .960
4	13.46 .530	38	27.00 1.063
3	17.45 .687	37	19.05 .750
2	10.29 .405	35	23.80 .937
1	14.22 .560	34	32.26 1.270
N	DIM. A	N	DIM. A

EC NO: UCP2004-1675  
 DRWN: JSCHAFFER2004/03/08  
 CHK'D: 2004/03/11  
 APPR: YMARGULI 2004/03/17

QUALITY SYMBOLS	GENERAL TOLERANCES (UNLESS SPECIFIED)		SCALE	DESIGN UNITS	THIRD ANGLE PROJECTION	REVISE ON CAD ONLY
	mm	INCH	8:1	INCH		
	4 PLACES	± ---	± ---	DIMENSION STYLE		TITLE
	3 PLACES	± ---	± ---	MM/IN		
2 PLACES	± ---	± ---	DRAWN BY	DATE	TERMINAL PIN 0.647.025 SQ. WIRE	
1 PLACE	± ---	± ---	SCHAFFER	2004/03/01		
ANGULAR ±1/2°			CHECKED BY	DATE	MOLEX INCORPORATED	
DRAFT WHERE APPLICABLE MUST REMAIN WITHIN DIMENSIONS			APPROVED BY	DATE	MATERIAL NO.	DOCUMENT NO.
			MARGULIS	2004/03/05	SEE CHART	SD-4166-001
THIS DRAWING CONTAINS INFORMATION THAT IS PROPRIETARY TO MOLEX INCORPORATED AND SHOULD NOT BE USED WITHOUT WRITTEN PERMISSION						















