



Chipsmall Limited consists of a professional team with an average of over 10 year of expertise in the distribution of electronic components. Based in Hongkong, we have already established firm and mutual-benefit business relationships with customers from,Europe,America and south Asia,supplying obsolete and hard-to-find components to meet their specific needs.

With the principle of "Quality Parts,Customers Priority,Honest Operation,and Considerate Service",our business mainly focus on the distribution of electronic components. Line cards we deal with include Microchip,ALPS,ROHM,Xilinx,Pulse,ON,Everlight and Freescale. Main products comprise IC,Modules,Potentiometer,IC Socket,Relay,Connector.Our parts cover such applications as commercial,industrial, and automotives areas.

We are looking forward to setting up business relationship with you and hope to provide you with the best service and solution. Let us make a better world for our industry!



## Contact us

Tel: +86-755-8981 8866 Fax: +86-755-8427 6832

Email & Skype: info@chipsmall.com Web: www.chipsmall.com

Address: A1208, Overseas Decoration Building, #122 Zhenhua RD., Futian, Shenzhen, China



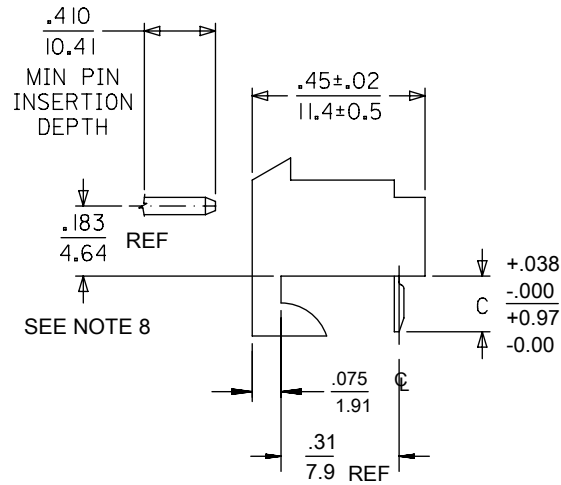
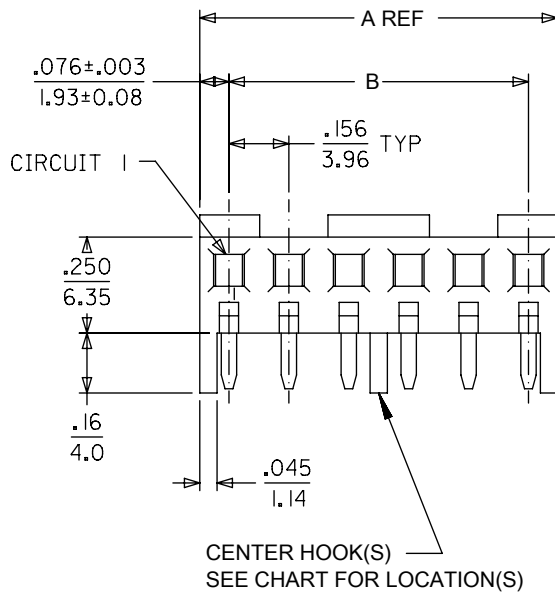

**NOTES:**

- HOUSING MATERIAL: NYLON, UL 94V-2
- FINISH:  
 (197) OVERALL REFLOWED MATTE TIN: 0.00152/.000060 MIN.  
 OVER 0.00127/.000050 MIN. NICKEL OVERALL.  
 (208) SELECT GOLD: .000015/0.00038 MIN.  
 SELECT TIN: .000100/0.00254 MIN.  
 OVERALL NICKEL UNDERPLATE: .000050/0.00127 MIN.  
 (909) OVERALL HOT TIN DIP: .000100/0.00254 MIN.
- PRODUCT SPECIFICATION: PS-08-50
- PACKAGING INFO: SEE CHARTS.
- SOLDERABILITY SPECIFICATION: SMES-152.
- TOP ENTRY OPTIONS: SEE DRAWING SDA-2145-002.
- BOTTOM ENTRY OPTIONS: SEE DRAWING SDA-2145-003
- .183/4.64 DIMENSION IS BOTTOM OF HOUSING TO CENTER OF MATING PIN AND DOES NOT REFLECT CENTER OF THE CONNECTOR HOUSING WINDOW DIMENSION.
- THIS PART CONFORMS TO CLASS B REQUIREMENTS OF COSMETIC SPECIFICATION PS-45499-002.

CKT	A	B	CENTER HOOK(S) LOCATED BETWEEN CIRCUITS
02	.308 7.82	.156±.005 3.96±0.13	NONE
03	.464 11.79	.312±.005 7.92±0.13	NONE
04	.620 15.75	.468±.005 11.89±0.13	NONE
05	.776 19.71	.624±.005 15.85±0.13	NONE
06	.932 23.67	.780±.005 19.81±0.13	NONE
07	1.088 27.64	.936±.010 23.77±0.25	NONE
08	1.244 31.60	1.092±.010 27.74±0.25	4 & 5
09	1.400 35.56	1.248±.010 31.70±0.25	4 & 5
10	1.556 39.52	1.404±.010 35.66±0.25	5 & 6
11	1.712 43.48	1.560±.010 39.62±0.25	5 & 6
12	1.868 47.45	1.716±.010 43.59±0.25	4 & 5, 8 & 9
13	2.024 51.41	1.872±.010 47.55±0.25	6 & 7, 11 & 12
14	2.180 55.37	2.028±.014 51.51±0.36	5 & 6, 9 & 10
15	2.336 59.33	2.184±.014 55.47±0.36	5 & 6, 10 & 11

2*	AB
1	AB
SHT	REV.

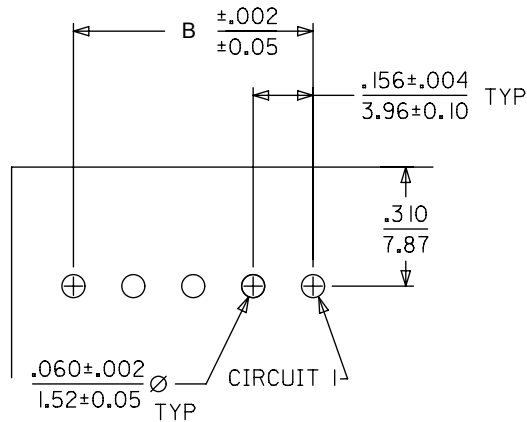

PCB LAYOUT: COMPONENT SIDE  
 RECOMMENDED PCB THICKNESS: .062/1.57

THIS DRAWING CONTAINS INFORMATION THAT IS PROPRIETARY TO MOLEX ELECTRONIC TECHNOLOGIES, LLC AND SHOULD NOT BE USED WITHOUT WRITTEN PERMISSION

DIM C TOLERANCE EC NO: 107740 DRWN: MKIPPER CHK'D: JBELL REV APPR: FSMITH 2016/08/22 2016/08/24 2016/08/26	GENERAL TOLERANCES (UNLESS SPECIFIED)		DIMENSION UNITS	SCALE		
			INCH/MM	NTS		
	4 PLACES	±	MM	INCH		DRWN BY: SAMIEC DATE: 1998/10/09
	3 PLACES	±	± 0.01			CHK'D BY: SAMIEC DATE: 1998/10/09
	2 PLACES	± 0.25	± 0.015	APPR BY: SAMIEC DATE: 1998/10/09	PRODUCT CUSTOMER DRAWING SERIES: 2145 MATERIAL NUMBER: SEE CHART CUSTOMER: GENERAL MARKET DOCUMENT NUMBER: SDA-2145-001 DOC TYPE: PSD DOC PART: 000 SHEET NUMBER: 1 OF *	
	1 PLACES	± 0.38	±	DRAWING SIZE: A THIRD ANGLE PROJECTION		
	0 PLACES	±	±			
	ANGULAR TOL ±		DRAFT WHERE APPLICABLE MUST REMAIN WITHIN DIMENSIONS			

RELEASE STATUS	RELEASE DATE
----------------	--------------



# KK 156 PCB ASSY

## 2145 RIGHT ANGLE SERIES

<b>OPTIONS</b>	RAMPS	YES	RAMPS	YES
	COLOR:	WHITE	COLOR:	WHITE
	MOLD VOID:	NONE	MOLD VOID:	NONE
	TERM MATL:	PHOS BRONZE	TERM MATL:	PHOS BRONZE
	CONTACT:	STANDARD	CONTACT:	STANDARD
	PC TAIL (C):	.145 / 3.68	PC TAIL (C):	.145 / 3.68
	PLATING:	197 - TIN	PLATING:	208 - GOLD
	TERM VOID:	NONE	TERM VOID:	NONE
	PACKAGING:	TRAY PK-2145-001	PACKAGING:	TRAY PK-2145-001
<b>Ckts</b>	<b>Material No</b>		<b>Material No</b>	
2	09-52-1026		09-62-4027	
3	09-52-1036		09-62-4037	
4	09-52-1046		09-62-4047	
5	09-52-1056		09-62-4057	
6	09-52-1066		09-62-4067	
7	09-52-1076		09-62-4077	
8	09-52-1086		09-62-4087	
9	09-52-1096		09-62-4097	
10	09-52-1106		09-62-4107	
11	09-52-1116		09-62-4117	
12	09-52-1126		09-62-4127	
13	09-52-1136		09-62-4137	
14	09-52-1146		09-62-4147	
15	09-52-1156		09-62-4157	

<b>REV:</b>	<u>ECM INFORMATION:</u>	<u>TITLE:</u>	<u>SHEET No.</u>
<b>AB</b>	<b>ECM 107740</b> <b>8/24/2016</b> <b>MKIPPER</b>	<h1 style="margin: 0;">KK 156 PCB ASSY</h1> <h2 style="margin: 0;">2145 RIGHT ANGLE SERIES</h2>	<b>- 2 -</b>
<u>DOCUMENT NUMBER:</u>	<u>CREATED / REVISED BY:</u>	<u>CHECKED BY:</u>	<u>APPROVED BY:</u>
<b>SDA-2145-001</b>	<b>MKIPPER</b>	<b>JBELL</b>	<b>FSMITH</b>



# KK 156 PCB ASSY

## 2145 RIGHT ANGLE SERIES

OPTIONS	RAMPS	YES					RAMPS	YES
	COLOR:	WHITE					COLOR:	WHITE
	MOLD VOID:	NONE					MOLD VOID:	NONE
	TERM MATL:	BRASS					TERM MATL:	BRASS
	CONTACT:	STANDARD					CONTACT:	STANDARD
	PC TAIL (C):	.145 / 3.68					PC TAIL (C):	.145 / 3.68
	PLT CODE:	197 - TIN					PLT CODE:	P909 - TIN
	TERM VOID:	NONE					TERM VOID:	NONE
	PACKAGING:	TRAY PK-2145-001					PACKAGING:	TRAY PK-2145-001
Ckt	Material No					Material No		
2	09-52-1021					09-52-3021		
3	09-52-1031					09-52-3031		
4	09-52-1041					09-52-3041		
5	09-52-1051					09-52-3051		
6	09-52-1061					09-52-3061		
7	09-52-1071					09-52-3071		
8	09-52-1081					09-52-3081		
9	09-52-1091					09-52-3091		
10	09-52-1101					09-52-3101		
11	09-52-1111					09-52-3111		
12	09-52-1121					09-52-3121		
13	09-52-1131					09-52-3131		
14	09-52-1141					09-52-3141		
15	09-52-1151					09-52-3151		

<b>REV:</b>	<u>ECM INFORMATION:</u> <b>ECM 107740</b> <b>8/24/2016</b> <b>MKIPPER</b>	<u>TITLE:</u>  <b>KK 156 PCB ASSY</b> <b>2145 RIGHT ANGLE SERIES</b>	<u>SHEET No.</u>
<b>AB</b>			<b>- 3 -</b>
<u>DOCUMENT NUMBER:</u>	<u>CREATED / REVISED BY:</u>	<u>CHECKED BY:</u>	<u>APPROVED BY:</u>
<b>SDA-2145-001</b>	<b>MKIPPER</b>	<b>JBELL</b>	<b>FSMITH</b>



# KK 156 PCB ASSY

## 2145 RIGHT ANGLE SERIES

OPTIONS	RAMPS	YES	RAMPS	YES	RAMPS	NO	RAMPS	YES
	COLOR:	BLACK	COLOR:	WHITE	COLOR:	WHITE	COLOR:	WHITE
	MOLD VOID:	NONE	MOLD VOID:	NONE	MOLD VOID:	NONE	MOLD VOID:	NONE
	TERM MATL:	BRASS	TERM MATL:	BRASS	TERM MATL:	BRASS	TERM MATL:	BRASS
	CONTACT:	STANDARD	CONTACT:	STANDARD	CONTACT:	STANDARD	CONTACT:	LOW INSERTION
	PC TAIL (C):	.145 / 3.68	PC TAIL (C):	.145 / 3.68	PC TAIL (C):	.145 / 3.68	PC TAIL (C):	.145 / 3.68
	PLT CODE:	P909 – TIN	PLT CODE:	208 – 15 GOLD	PLT CODE:	P909 – TIN	PLT CODE:	P909 – TIN
	TERM VOID:	NONE	TERM VOID:	NONE	TERM VOID:	NONE	TERM VOID:	NONE
	PACKAGING:	TRAY PK-2145-001	PACKAGING:	TRAY PK-2145-001	PACKAGING:	TRAY PK-2145-001	PACKAGING:	TRAY PK-2145-001
Ckt	Material No	Material No	Material No	Material No				
2	09-53-3021	09-62-3021						
3	09-53-3031	09-62-3031		09-52-3035				
4	09-53-3041	09-62-3041		09-52-3045				
5	09-53-3051	09-62-3051		09-52-3055				
6	09-53-3061	09-62-3061		09-52-3065				
7	09-53-3071	09-62-3071						
8	09-53-3081	09-62-3081		09-52-3085				
9	09-53-3091	09-62-3091	09-52-2097	09-52-3095				
10	09-53-3101	09-62-3101		09-52-3105				
11	09-53-3111	09-62-3111						
12	09-53-3121	09-62-3121		09-52-3125				
13	09-53-3131	09-62-3131						
14	09-53-3141	09-62-3141						
15	09-53-3151	09-62-3151		09-52-3155				

<b>REV:</b>	<u>ECM INFORMATION:</u> <b>ECM 107740</b> <b>8/24/2016</b> <b>MKIPPER</b>	<u>TITLE:</u> <h2 style="text-align: center;">KK 156 PCB ASSY</h2> <h3 style="text-align: center;">2145 RIGHT ANGLE SERIES</h3>	<u>SHEET No.</u> <b>- 4 -</b>
<b>AB</b>			
<u>DOCUMENT NUMBER:</u> <b>SDA-2145-001</b>	<u>CREATED / REVISED BY:</u> <b>MKIPPER</b>	<u>CHECKED BY:</u> <b>JBELL</b>	<u>APPROVED BY:</u> <b>FSMITH</b>



# KK 156 PCB ASSY

## 2145 RIGHT ANGLE SERIES

			RAMPS	YES	RAMPS	YES	RAMPS	
			COLOR:	WHITE	COLOR:	WHITE	COLOR:	
			MOLD VOID:	NONE	MOLD VOID:	NONE	MOLD VOID:	
			TERM MATL:	PHOS BRONZE	TERM MATL:	PHOS BRONZE	TERM MATL:	
			CONTACT:	STANDARD	CONTACT:	LOW FORCE	CONTACT:	
			PC TAIL (C):	.145 / 3.68	PC TAIL (C):	.145 / 3.68	PC TAIL (C):	
			PLT CODE:	P909 – TIN	PLT CODE:	197 – TIN	PLT CODE:	
			TERM VOID:	NONE	TERM VOID:	NONE	TERM VOID:	
			PACKAGING:	TRAY PK-2145-001	PACKAGING:	TRAY PK-2145-001	PACKAGING:	
			Material No		Material No		Material No	
			09-52-3028		50-29-0036			
			09-52-3038		50-29-0037 09-52-1030			
			09-52-3048		50-29-0038			
			09-52-3058		50-29-0039			
			09-52-3068		09-52-1060			
			09-52-3078		50-29-0040			
			09-52-3088		09-52-1080			
			09-52-3098		50-29-0041			
			09-52-3108		09-52-1100			
			09-52-3118		50-29-0042			
			09-52-3128		09-52-1120			
			09-52-3138		50-29-0043			
			09-52-3148		09-52-1140			
			09-52-3158		50-29-0044			

<b>REV:</b>	<u>ECM INFORMATION:</u>	<u>TITLE:</u>	<u>SHEET No.</u>
<b>AB</b>	<b>ECM 107740</b> <b>8/24/2016</b> <b>MKIPPER</b>	<h2 style="margin: 0;">KK 156 PCB ASSY</h2> <h2 style="margin: 0;">2145 RIGHT ANGLE SERIES</h2>	<b>- 5 -</b>
<u>DOCUMENT NUMBER:</u>	<u>CREATED / REVISED BY:</u>	<u>CHECKED BY:</u>	<u>APPROVED BY:</u>
<b>SDA-2145-001</b>	<b>MKIPPER</b>	<b>JBELL</b>	<b>FSMITH</b>