



Chipsmall Limited consists of a professional team with an average of over 10 year of expertise in the distribution of electronic components. Based in Hongkong, we have already established firm and mutual-benefit business relationships with customers from,Europe,America and south Asia,supplying obsolete and hard-to-find components to meet their specific needs.

With the principle of “Quality Parts,Customers Priority,Honest Operation,and Considerate Service”,our business mainly focus on the distribution of electronic components. Line cards we deal with include Microchip,ALPS,ROHM,Xilinx,Pulse,ON,Everlight and Freescale. Main products comprise IC,Modules,Potentiometer,IC Socket,Relay,Connector.Our parts cover such applications as commercial,industrial, and automotives areas.

We are looking forward to setting up business relationship with you and hope to provide you with the best service and solution. Let us make a better world for our industry!



Contact us

Tel: +86-755-8981 8866 Fax: +86-755-8427 6832

Email & Skype: info@chipsmall.com Web: www.chipsmall.com

Address: A1208, Overseas Decoration Building, #122 Zhenhua RD., Futian, Shenzhen, China



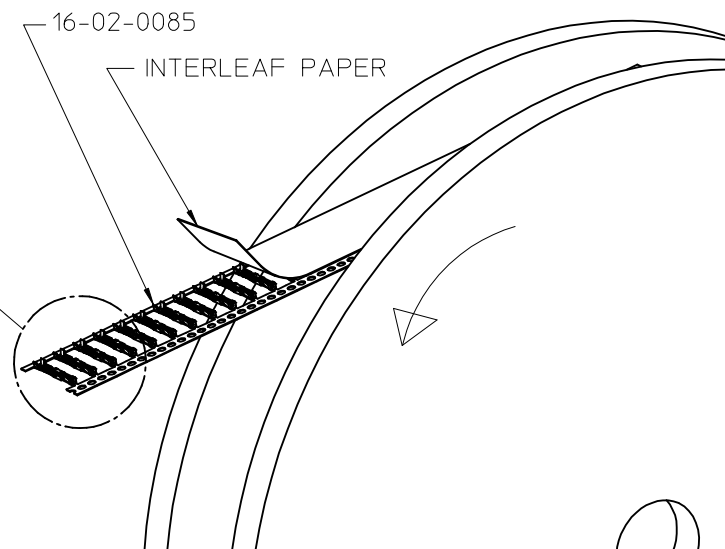
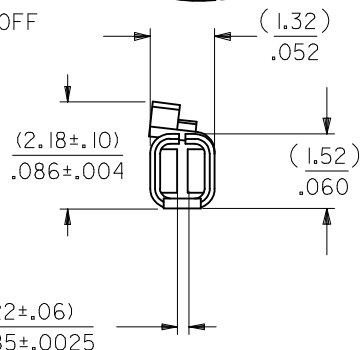
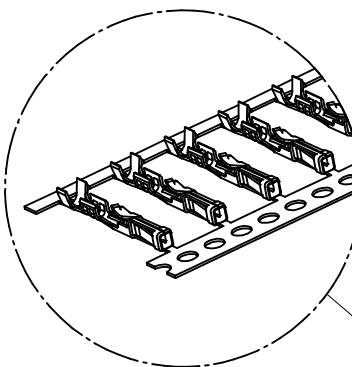
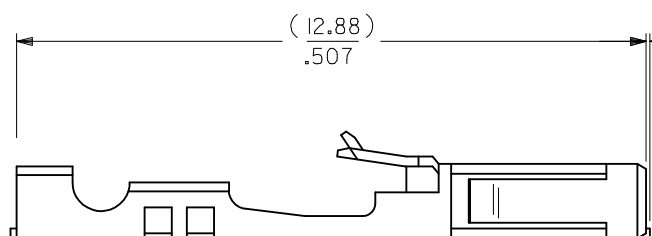
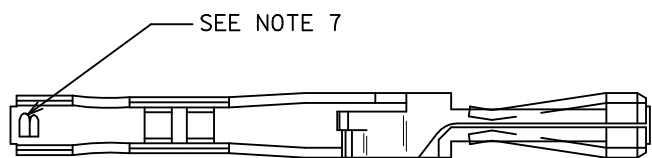

NOTES:

1. TERMINAL TO BE USED IN HOUSING 70066-**** AND 70450-****.
2. REFER TO PRODUCT SPECIFICATION PS-70058.
3. REFER TO MOLEX OPERATIONS AND SERVICE MANUAL FOR CRIMP DETAILS.
4. TERMINAL TO BE USED WITH (0.64)/.025 SQUARE PINS.
5. TERMINAL TO BE USED WITH 32-36 AWG STRANDED WIRE WITH ((0.64)/.025 MAXIMUM DIAMETER INSULATION.
6. TERMINALS SUPPLIED IN REEL FORM.
7. CRIMP SIZE INDICATOR B=32-36 AWG

PLATING:

.000030 MINIMUM GOLD PLATE IN SELECT AREA,
.000075 MINIMUM TIN PLATE IN SELECT AREA,
OVER NICKEL PLATE OVERALL.

REEL UNWIND DIR EC NO: UCP2013-5345 TIDRWN:RWHIPPLE 2013/06/11 CHKD:DMORGAN 2013-6/11 APPR:SMILLER 2013/07/09	DESCRIPTION	QUALITY SYMBOLS	GENERAL TOLERANCES (UNLESS SPECIFIED)				DIMENSION STYLE		SCALE	DESIGN UNITS	THIRD ANGLE PROJECTION			
							MM/IN		10:1	INCH				
			F7=0 F7=0 F7=0		mm	INCH	DRAWN BY	DATE	TITLE TERMINAL - BOX/CRIMP FOR 32-36 AWG ON A REEL molex					
				4 PLACES	± ---	± ---	RWHIPPLE	2013/06/11						
				3 PLACES	± ---	± .005	CHECKED BY	DATE						
				2 PLACES	± 0.13	± .01	JAS	1988/02/03						
				1 PLACE	± 0.25	± ---	APPROVED BY	DATE						
			0 PLACE	± ---	± ---	SMILLER	2013/07/09							
			ANGULAR ±1/2°				MATERIAL NO.		DOCUMENT NO.				SHEET NO.	
			DRAFT WHERE APPLICABLE MUST REMAIN WITHIN DIMENSIONS				16-02-0085		SD-70058-0017				1 OF 1	
				SIZE B		THIS DRAWING CONTAINS INFORMATION THAT IS PROPRIETARY TO MOLEX INCORPORATED AND SHOULD NOT BE USED WITHOUT WRITTEN PERMISSION								