



Chipsmall Limited consists of a professional team with an average of over 10 year of expertise in the distribution of electronic components. Based in Hongkong, we have already established firm and mutual-benefit business relationships with customers from,Europe,America and south Asia,supplying obsolete and hard-to-find components to meet their specific needs.

With the principle of “Quality Parts,Customers Priority,Honest Operation,and Considerate Service”,our business mainly focus on the distribution of electronic components. Line cards we deal with include Microchip,ALPS,ROHM,Xilinx,Pulse,ON,Everlight and Freescale. Main products comprise IC,Modules,Potentiometer,IC Socket,Relay,Connector.Our parts cover such applications as commercial,industrial, and automotives areas.

We are looking forward to setting up business relationship with you and hope to provide you with the best service and solution. Let us make a better world for our industry!



Contact us

Tel: +86-755-8981 8866 Fax: +86-755-8427 6832

Email & Skype: info@chipsmall.com Web: www.chipsmall.com

Address: A1208, Overseas Decoration Building, #122 Zhenhua RD., Futian, Shenzhen, China



CAD GENERATED DRAWING - NO PENCIL CHANGES ALLOWED

PART NO.	CURRENT RATING (A)	VOLTAGE RATING	HOUSING COLOR
0447002.Y	2A	350V	NATURAL
0447003.Y	3A	350V	NATURAL
0447004.Y	4A	350V	NATURAL
0447005.Y	5A	350V	NATURAL
044707.5Y	7.5A	350V	NATURAL
0447010.Y	10A	350V	NATURAL

% OF RATING	BLOW TIME	
	MINIMUM	MAXIMUM
100	4 HOURS	—
200	.15 SECONDS	5 SECONDS

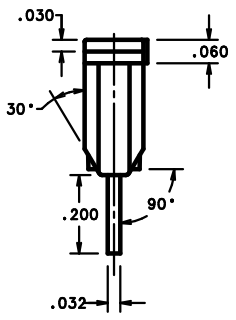
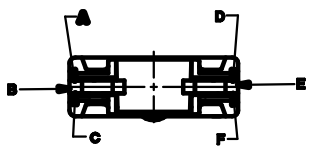
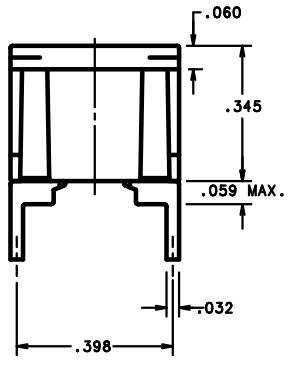
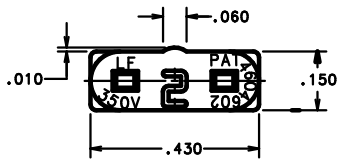

NOTES:

1. AMPERAGE RATING IS MOLDED INTO HOUSING.
2. DIMENSIONS ARE SYMMETRICAL ABOUT CENTERLINES.
3. SURFACES A, B, C, D, E & F OF THE TERMINALS TO BE PLATED AS FOLLOWS:
 .0001 INCH MIN. THICK NICKEL PLATING (UNDERCOAT)
 .000200 INCH MIN. THICK 95% TIN/5% LEAD PLATING (OVERCOAT)
4. INTERRUPTING RATING: 350VAC, 100A, UNITY POWER FACTOR.
5. FUSES ARE RECOGNIZED UNDER THE COMPONENTS PROGRAM OF UNDERWRITERS LABORATORIES AND CERTIFIED BY CSA.

NO	COMPONENT NO	DESCRIPTION	QTY/M	U/M	BILL OF MATERIAL	
					FINISH	THRU HOLE EBF FUSE
					DATE	8/24/99
					SCALE	4:1
					SUPER DRW	
					RAW STK QT	
					TOLERANCE UNLESS OTHERWISE SPECIFIED	
					TWO PLACE DEC	±.01
					THREE PLACE DEC	±.005
					ANGULAR	±1°

LTR	REVISION	CHK	APD
A	60053 - RELEASED 8/24/99	BJJ	
B	60053B-CHG PLATING INFO 04/03/00	PJM	
C	60717B-ADD BUMP TO DRWG 07/13/00	PJM	
D	61033B-CHG HOUSING COLOR TO NATURAL 01/05/01	PJM	
E	61833B-CHG "HOT STAMPED ON" TO "MOLDED INTO" 1/22/02	PJM	
F	63769B-DLT MITI LOGO 06/11/04		

UNLESS OTHERWISE SPECIFIED, DIMENSIONS DO NOT INCLUDE PLATING.
 DENOTES CRITICAL CHARACTERISTICS.
 DENOTES CPK DIMENSIONS - MINIMUM CPK VALUE
 DENOTES A CHARACTERISTIC THAT PROVIDES AN INDICATION
 OF THE PROCESSING TO BE USED IN THE MANUFACTURE FOR MEASUREMENT
 AND TRACKING TO THE APPROPRIATE INSTRUCTIONS.
 DIMENSIONS OF DIMENSIONS - MINIMUM CP VALUE
 TO BE WITHIN THE DIMENSIONAL LIMITATIONS
 SPECIFIED FOR MAXIMUM TOOL LIFE.

UNCONTROLLED DOCUMENT

OUTLINE
0447000.Y

DES PLAINES, ILLINOIS 60018

74 Littelfuse

THRU HOLE EBF FUSE