



Chipsmall Limited consists of a professional team with an average of over 10 year of expertise in the distribution of electronic components. Based in Hongkong, we have already established firm and mutual-benefit business relationships with customers from,Europe,America and south Asia,supplying obsolete and hard-to-find components to meet their specific needs.

With the principle of “Quality Parts,Customers Priority,Honest Operation,and Considerate Service”,our business mainly focus on the distribution of electronic components. Line cards we deal with include Microchip,ALPS,ROHM,Xilinx,Pulse,ON,Everlight and Freescale. Main products comprise IC,Modules,Potentiometer,IC Socket,Relay,Connector.Our parts cover such applications as commercial,industrial, and automotives areas.

We are looking forward to setting up business relationship with you and hope to provide you with the best service and solution. Let us make a better world for our industry!



Contact us

Tel: +86-755-8981 8866 Fax: +86-755-8427 6832

Email & Skype: info@chipsmall.com Web: www.chipsmall.com

Address: A1208, Overseas Decoration Building, #122 Zhenhua RD., Futian, Shenzhen, China



NOTES:

- 1) MATERIAL: GLASS FILLED POLYESTER, UL94V-0, COLOR: BLACK.
- 2) HOUSING TO BE USED WITH TERMINAL PT. NO. 70058-****
- 3) SEE CHART FOR CIRCUIT SIZES.
- 4) TO BE USED WITH (0.64)/.025 SQ. OR RD. PINS.
- 5) PARTS STACKABLE END TO END ON (2.54)/.100 CENTERS.
- 6) REFER TO PRODUCT SPECIFICATION NO. : P.S.-70058
- 7) PARTS MAY OR MAY NOT BE SUPPLIED WITH EXTERIOR CORE-OUT CONFIGURATION, SEE DWG. SD-70066-**** FOR OPTIONAL HOUSING DETAILS.
- 8) PACKAGE PER PK-70066-100.

OPTION "D"

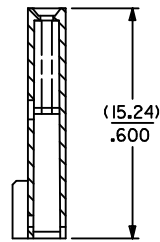
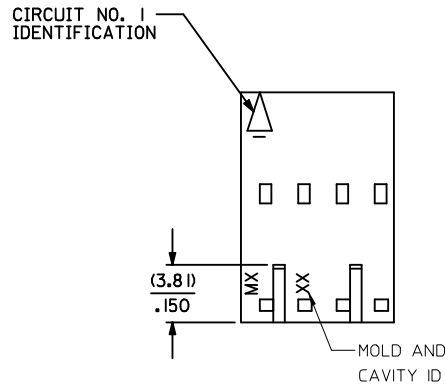
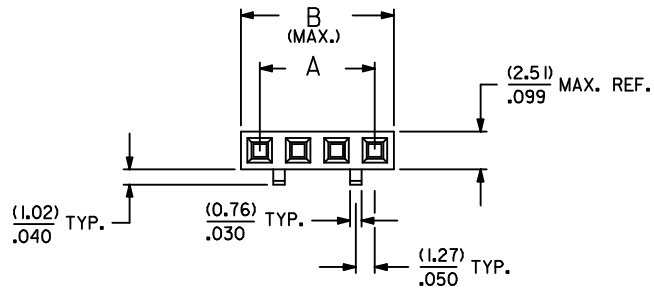

SECTION C-C

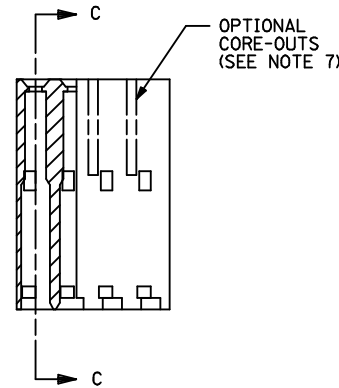

CKT. SIZE	EDP. NO.	ENG. NO.	A	B
2	50-57-9302	70066-0106	(2.54) .100	(5.05) .199
3	50-57-9303	70066-0107	(5.08) .200	(7.59) .299
4	50-57-9304	70066-0108	(7.62) .300	(10.13) .399
5	50-57-9305	70066-0109	(10.16) .400	(12.67) .499
6	50-57-9306	70066-0110	(12.70) .500	(15.21) .599
7	50-57-9307	70066-0111	(15.24) .600	(17.75) .699
8	50-57-9308	70066-0112	(17.78) .700	(20.29) .799
9	50-57-9309	70066-0113	(20.32) .800	(22.83) .899
10	50-57-9310	70066-0114	(22.86) .900	(25.37) .999
11	50-57-9311	70066-0115	(25.40) 1.000	(27.91) 1.099
12	50-57-9312	70066-0116	(27.94) 1.100	(30.45) 1.199
13	50-57-9313	70066-0117	(30.48) 1.200	(32.99) 1.299
14	50-57-9314	70066-0118	(33.02) 1.300	(35.53) 1.399
15	50-57-9315	70066-0119	(35.56) 1.400	(38.07) 1.499
16	50-57-9316	70066-0120	(38.10) 1.500	(40.61) 1.599
17	50-57-9317	70066-0121	(40.64) 1.600	(43.15) 1.699
18	50-57-9318	70066-0122	(43.18) 1.700	(45.69) 1.799
19	50-57-9319	70066-0123	(45.72) 1.800	(48.23) 1.899
20	50-57-9320	70066-0124	(48.26) 1.900	(50.77) 1.999
21	50-57-9321	70066-0125	(50.80) 2.000	(53.31) 2.099
22	50-57-9322	70066-0126	(53.34) 2.100	(55.85) 2.199
23	50-57-9323	70066-0127	(55.88) 2.200	(58.39) 2.299
24	50-57-9324	70066-0128	(58.42) 2.300	(60.93) 2.399
25	50-57-9325	70066-0129	(60.96) 2.400	(63.47) 2.499

LOCATE MOLD & CAVITY ID EC NO: UCP2014-4216 DRWR:RWHIPPLE 2014/04/11 CHKD:DMORGAN 2014/04/11 APPR:SMILLER 2014/04/28	QUALITY SYMBOLS ▽=0 ▽=0 ▽=0	GENERAL TOLERANCES (UNLESS SPECIFIED)		DIMENSION STYLE IN/MM		SCALE	DESIGN UNITS INCH	THIRD ANGLE PROJECTION		
		4 PLACES ± --- ± ---	DRAWN BY RWHIPPLE	DATE 2014/04/11	TITLE SALES, 70066-OPT.D					
		3 PLACES ± --- ± ---	CHECKED BY DMORGAN	DATE 2014/04/11	MATERIAL NO. SEE CHART					
		2 PLACES ± --- ± ---	APPROVED BY SMILLER	DATE 2014/04/28	DOCUMENT NO. SD-70066-0106-0129					
DRAFT WHERE APPLICABLE MUST REMAIN WITHIN DIMENSIONS		ANGULAR ±1/2°		SIZE C		SHEET NO. 1 OF 1		THIS DRAWING CONTAINS INFORMATION THAT IS PROPRIETARY TO MOLEX INCORPORATED AND SHOULD NOT BE USED WITHOUT WRITTEN PERMISSION		