



Chipsmall Limited consists of a professional team with an average of over 10 year of expertise in the distribution of electronic components. Based in Hongkong, we have already established firm and mutual-benefit business relationships with customers from,Europe,America and south Asia,supplying obsolete and hard-to-find components to meet their specific needs.

With the principle of “Quality Parts,Customers Priority,Honest Operation,and Considerate Service”,our business mainly focus on the distribution of electronic components. Line cards we deal with include Microchip,ALPS,ROHM,Xilinx,Pulse,ON,Everlight and Freescale. Main products comprise IC,Modules,Potentiometer,IC Socket,Relay,Connector.Our parts cover such applications as commercial,industrial, and automotives areas.

We are looking forward to setting up business relationship with you and hope to provide you with the best service and solution. Let us make a better world for our industry!



## Contact us

Tel: +86-755-8981 8866 Fax: +86-755-8427 6832

Email & Skype: info@chipsmall.com Web: www.chipsmall.com

Address: A1208, Overseas Decoration Building, #122 Zhenhua RD., Futian, Shenzhen, China



PT. 01:

1. FINISH TO ORDER
2. INSPECT
3. ASSEMBLE

PT. 02:

1. FINISH TO ORDER
2. INSPECT
3. ASSEMBLE

ASSEMBLY:

1. ASSEMBLE
2. ASSEMBLE
3. FINAL INSP.

4. SHIPPING

BIENT ZZIXW

Form C-13-06

.616 WAS .7160  
 .508 WAS .5160  
 .258 WAS .330  
 .355 WAS .500  
 WORKING  
 POSITION ADDED  
 LBS/M WAS  
 30.3 21  
 K.D. 21  
 3-26 85  
 O.P.S ADDED  
 REF. NAME  
 O.P. NO. WAS  
 2009185JWS  
 K.D. 21  
 3-18-85  
 3  
 DWG NO. WAS  
 0097-C-0951  
 .0162 WAS  
 .018  
 MAT'L THICKNESS  
 WAS .0042  
 P.T. 02 ADDED  
 K.D. 21  
 4  
 10-21-85  
 ADDED .4500  
 REMOVED DETAIL  
 P.T. 02 WAS REC'D.  
 P.T. 01 WAS I/L  
 WAS 7.00  
 K.D. 21  
 12-10-85  
 5  
 P.T. 03 WAS  
 8041-D-095A  
 K.D. 21  
 8-7-86  
 6  
 14.970 WAS 15.000  
 .548 WAS .700 4  
 REVISED VIEW  
 4 ANVIL  
 9-5-86  
 7  
 1.500 WAS  
 4.500  
 \*NOTE REVISED  
 P.T. 03 WAS  
 4 LEGID  
 K.D. 21  
 11-26-86  
 8  
 97-944 WAS  
 97-950-  
 CHANGE SHAPE  
 OF RIVET  
 ECN4118  
 805-24-87  
 9  
 ADD OPTO  
 ASSEMBLE  
 ECN5123  
 805-24-87  
 10  
 ES 3-27-91

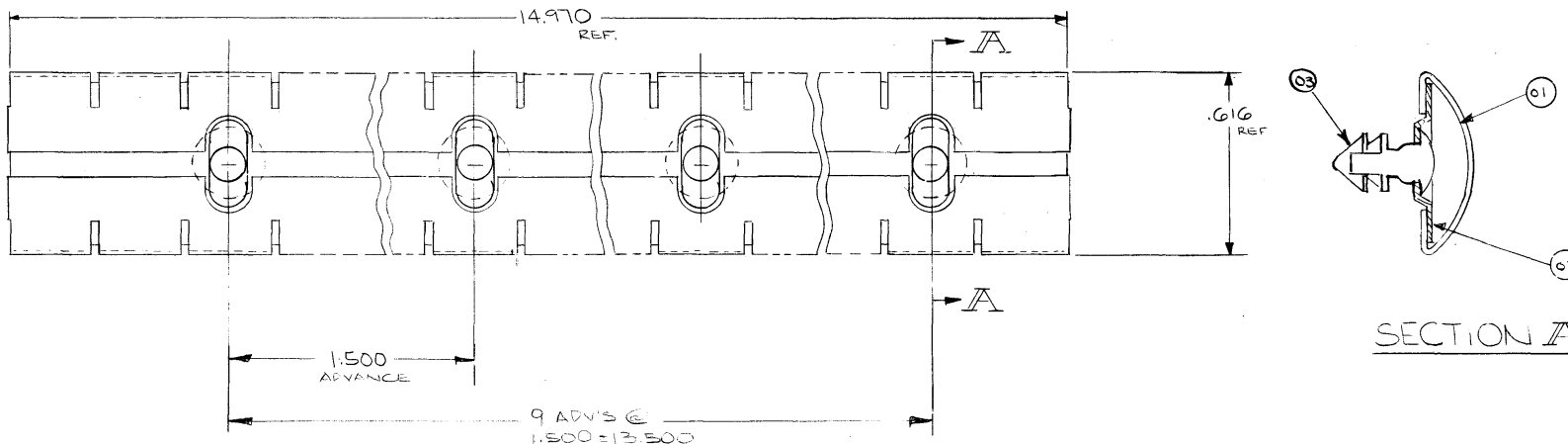
 DWG. 0097-C-0952  
 NO.

 TOL UNLESS  
 OTHERWISE SPEC:  
 DEC ± .010  
 FRACT. ±  
 ANGLES ±

0097-C-0952

	10	03	FASTENER - SEE DWG 0097-D-0944 ①
	1	02	.0162 X .600 BRASS REF. SEE DWG. 0097-C-0932
	1	01	.0038 X 1.320 BE.CU. REF. SEE DWG. 0097-C-0931
REQ'D	ITEM	MATERIAL	
INSTRUMENT SPECIALTIES COMPANY, Inc.			REF. DWG.
DELAWARE WATER GAP, PA			
DRAWN BY	DATE	APPROVED	SCALE
CRS	3-21-85	3/21/85	2:1
SUB		DWG. NO.	
10		0097-C-0952	