



Chipsmall Limited consists of a professional team with an average of over 10 year of expertise in the distribution of electronic components. Based in Hongkong, we have already established firm and mutual-benefit business relationships with customers from,Europe,America and south Asia,supplying obsolete and hard-to-find components to meet their specific needs.

With the principle of “Quality Parts,Customers Priority,Honest Operation,and Considerate Service”,our business mainly focus on the distribution of electronic components. Line cards we deal with include Microchip,ALPS,ROHM,Xilinx,Pulse,ON,Everlight and Freescale. Main products comprise IC,Modules,Potentiometer,IC Socket,Relay,Connector.Our parts cover such applications as commercial,industrial, and automotives areas.

We are looking forward to setting up business relationship with you and hope to provide you with the best service and solution. Let us make a better world for our industry!



Contact us

Tel: +86-755-8981 8866 Fax: +86-755-8427 6832

Email & Skype: info@chipsmall.com Web: www.chipsmall.com

Address: A1208, Overseas Decoration Building, #122 Zhenhua RD., Futian, Shenzhen, China



1.25MM CENTER FFC JUMPER CABLE (HIGH TEMPERATURE) CHART

"A" DIM.	1.18 +/- .079 INCHES 30 +/-2.00 MM		2 +/- .079 INCHES 51 +/-2.00 MM		3 +/- .118 INCHES 76 +/-3.00 MM		4 +/- .118 INCHES 102 +/-3.00 MM		5 +/- .157 INCHES 127 +/-4.00 MM		6 +/- .157 INCHES 152 +/-4.00 MM		7 +/- .157 INCHES 178 +/-4.00 MM		8 +/- .157 INCHES 203 +/-4.00 MM		9 +/- .197 INCHES 229 +/-5.00 MM		10 +/- .197 INCHES 254 +/-5.00 MM		12 +/- .197 INCHES 305 +/-5.00 MM	
	STIFFENER	TYPE "A"	TYPE "D"	TYPE "A"	TYPE "D"	TYPE "A"	TYPE "D"	TYPE "A"	TYPE "D"	TYPE "A"	TYPE "D"	TYPE "A"	TYPE "D"	TYPE "A"	TYPE "D"	TYPE "A"	TYPE "D"	TYPE "A"	TYPE "D"	TYPE "A"	TYPE "D"	TYPE "A"
CKTS: 4	151680701	151680700	151680703	151680702	151680705	151680704	151680707	151680706	151680709	151680708	151680711	151680710	151680713	151680712	151680715	151680714	151680717	151680716	151680719	151680718	151680721	151680720
CKTS: 6	151680101	151680102	151680103	151680104	151680105	151680106	151680107	151680108	151680109	151680110	151680111	151680112	151680113	151680114	151680115	151680116	151680117	151680118	151680119	151680120	151680121	151680122
CKTS: 8	151680123	151680124	151680125	151680126	151680127	151680128	151680129	151680130	151680131	151680132	151680133	151680134	151680135	151680136	151680137	151680138	151680139	151680140	151680141	151680142	151680143	151680144
CKTS: 10	151680145	151680146	151680147	151680148	151680149	151680150	151680151	151680152	151680153	151680154	151680155	151680156	151680157	151680158	151680159	151680160	151680161	151680162	151680163	151680164	151680165	151680166
CKTS: 12	151680167	151680168	151680169	151680170	151680171	151680172	151680173	151680174	151680175	151680176	151680177	151680178	151680179	151680180	151680181	151680182	151680183	151680184	151680185	151680186	151680187	151680188
CKTS: 14	151680189	151680190	151680191	151680192	151680193	151680194	151680195	151680196	151680197	151680198	151680199	151680200	151680201	151680202	151680203	151680204	151680205	151680206	151680207	151680208	151680209	151680210
CKTS: 16	151680211	151680212	151680213	151680214	151680215	151680216	151680217	151680218	151680219	151680220	151680221	151680222	151680223	151680224	151680225	151680226	151680227	151680228	151680229	151680230	151680231	151680232
CKTS: 18	151680233	151680234	151680235	151680236	151680237	151680238	151680239	151680240	151680241	151680242	151680243	151680244	151680245	151680246	151680247	151680248	151680249	151680250	151680251	151680252	151680253	151680254
CKTS: 20	151680255	151680256	151680257	151680258	151680259	151680260	151680261	151680262	151680263	151680264	151680265	151680266	151680267	151680268	151680269	151680270	151680271	151680272	151680273	151680274	151680275	151680276
CKTS: 22	151680277	151680278	151680279	151680280	151680281	151680282	151680283	151680284	151680285	151680286	151680287	151680288	151680289	151680290	151680291	151680292	151680293	151680294	151680295	151680296	151680297	151680298
CKTS: 24	151680299	151680300	151680301	151680302	151680303	151680304	151680305	151680306	151680307	151680308	151680309	151680310	151680311	151680312	151680313	151680314	151680315	151680316	151680317	151680318	151680319	151680320
CKTS: 26	151680321	151680322	151680323	151680324	151680325	151680326	151680327	151680328	151680329	151680330	151680331	151680332	151680333	151680334	151680335	151680336	151680337	151680338	151680339	151680340	151680341	151680342
CKTS: 28	151680343	151680344	151680345	151680346	151680347	151680348	151680349	151680350	151680351	151680352	151680353	151680354	151680355	151680356	151680357	151680358	151680359	151680360	151680361	151680362	151680363	151680364
CKTS: 30	151680365	151680366	151680367	151680368	151680369	151680370	151680371	151680372	151680373	151680374	151680375	151680376	151680377	151680378	151680379	151680380	151680381	151680382	151680383	151680384	151680385	151680386
CKTS: 32	151680387	151680388	151680389	151680390	151680391	151680392	151680393	151680394	151680395	151680396	151680397	151680398	151680399	151680400	151680401	151680402	151680403	151680404	151680405	151680406	151680407	151680408
CKTS: 34	151680409	151680410	151680411	151680412	151680413	151680414	151680415	151680416	151680417	151680418	151680419	151680420	151680421	151680422	151680423	151680424	151680425	151680426	151680427	151680428	151680429	151680430
CKTS: 36	151680431	151680432	151680433	151680434	151680435	151680436	151680437	151680438	151680439	151680440	151680441	151680442	151680443	151680444	151680445	151680446	151680447	151680448	151680449	151680450	151680451	151680452
CKTS: 38	151680453	151680454	151680455	151680456	151680457	151680458	151680459	151680460	151680461	151680462	151680463	151680464	151680465	151680466	151680467	151680468	151680469	151680470	151680471	151680472	151680473	151680474
CKTS: 40	151680475	151680476	151680477	151680478	151680479	151680480	151680481	151680482	151680483	151680484	151680485	151680486	151680487	151680488	151680489	151680490	151680491	151680492	151680493	151680494	151680495	151680496

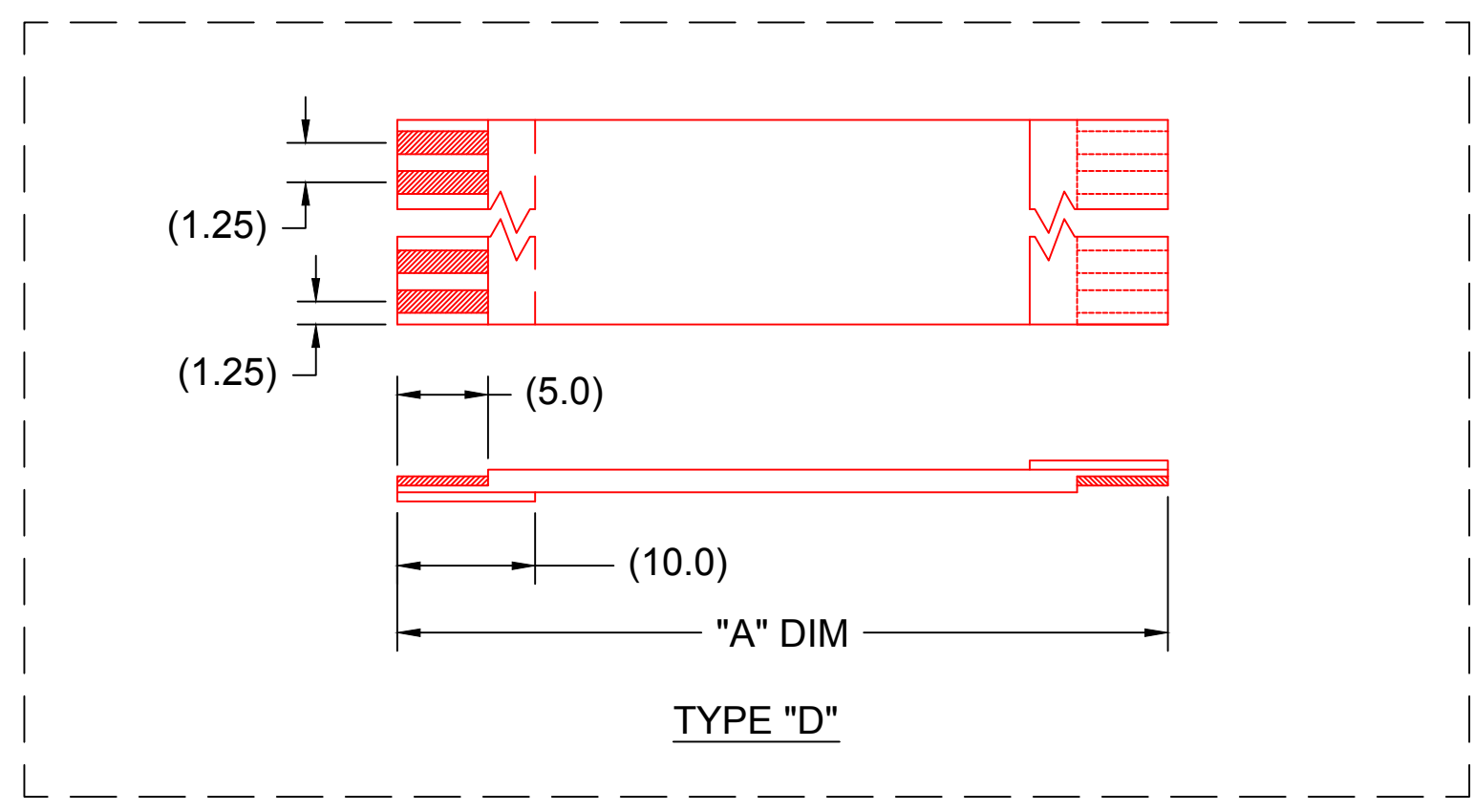
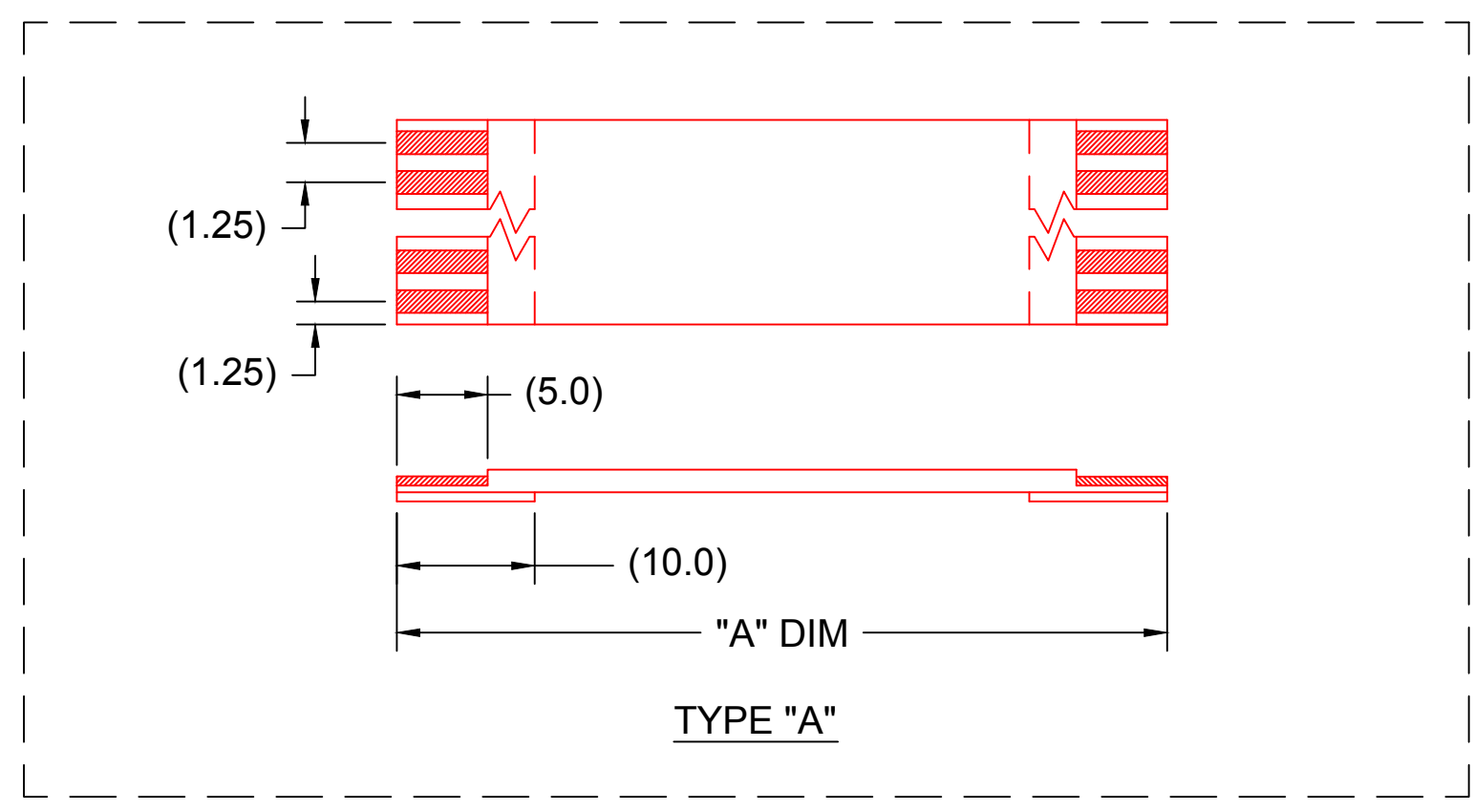

NOTES:
 1. NO PRINTING ON JUMPER CABLE UNLESS OTHERWISE SPECIFIED. IF PRINTING IS REQUIRED, THEN IT WOULD BE CONSIDERED A SPECIAL JUMPER CABLE.

RELEASED EC NO: USW2012-0099 DRWN: JLW 2011/10/28 REV	QUALITY SYMBOL	GENERAL TOLERANCES (UNLESS SPECIFIED)		DIMENSION STYLE		SCALE	DESIGN UNITS	THIRD ANGLE PROJECTION		
	▼=0 ∇=0	mm	INCH	MM		---	METRIC			
		4 PLACES	±---	±---	DRAWN BY	DATE	TITLE			
		3 PLACES	±---	±---	CHECKED BY	DATE	1.25MM CENTER FFC JUMPER CABLE			
	2 PLACES	±---	±---	APPROVED BY		DATE	MOLEX INCORPORATED			
	1 PLACE	±---	±---	SFULTON		2011/11/03	SD-15168-001			
		ANGULAR ±1/2°		MATERIAL NO.		DOCUMENT NO.		SHEET NO.		
		DRAFT WHERE APPLICABLE MUST REMAIN WITHIN DIMENSIONS		SEE CHART		SD-15168-001		1 OF 2		
		SIZE C	THIS DRAWING CONTAINS INFORMATION THAT IS PROPRIETARY TO MOLEX INCORPORATED AND SHOULD NOT BE USED WITHOUT WRITTEN PERMISSION							

