



Chipsmall Limited consists of a professional team with an average of over 10 year of expertise in the distribution of electronic components. Based in Hongkong, we have already established firm and mutual-benefit business relationships with customers from,Europe,America and south Asia,supplying obsolete and hard-to-find components to meet their specific needs.

With the principle of "Quality Parts,Customers Priority,Honest Operation,and Considerate Service",our business mainly focus on the distribution of electronic components. Line cards we deal with include Microchip,ALPS,ROHM,Xilinx,Pulse,ON,Everlight and Freescale. Main products comprise IC,Modules,Potentiometer,IC Socket,Relay,Connector.Our parts cover such applications as commercial,industrial, and automotives areas.

We are looking forward to setting up business relationship with you and hope to provide you with the best service and solution. Let us make a better world for our industry!



Contact us

Tel: +86-755-8981 8866 Fax: +86-755-8427 6832

Email & Skype: info@chipsmall.com Web: www.chipsmall.com

Address: A1208, Overseas Decoration Building, #122 Zhenhua RD., Futian, Shenzhen, China



**ATP Tooling Kit
Engineering No.
ATP-C-130**



**Application Tooling
Specification Sheet**

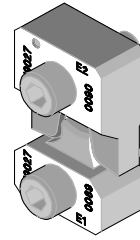

Order No. 19027-0088

SCOPE

Tooling: ATP Tooling Kits used with Molex Air Tape Press: (ATP 100 and 300 series) or a Molex Mylar Tape Applicator (MTA series). Refer to the appropriate tool instruction manual for installation and operation information.

Products: Krimptite™, Insulkrimp®, and Versakrimp™ Ring Tongue, Spade Tongue, Hook Tongue, Flanged Spade Tongue, Rectangular Tongue, Snap Spades, Multistud Ring, Temp Terminals, Butt Splices and Step Down Butt Splices 10–12 AWG and 14–16 AWG Heavy Duty.

Refer to the Product part number charts on this sheet for terminals with the barrel and tongue styles listed above.

Also see ATP Tooling Kits 19027-0300 and 19027-0301. These kits use 19027-0088 (ATP-C-130) tooling with spacers. Adding the appropriate spacers to this kit allows crimping of all products listed for kits 19027-0300 or 19027-0301.

Testing Mechanical

The tensile test or pull test is a means of evaluating the mechanical properties of the crimped connections. The following charts show the UL Specifications for various wire sizes. The tensile strength is shown in pounds and indicates the minimum acceptable force to break or separate terminal from the conductor.

Wire Size (AWG)	*UL - 486 A	*UL - 486 C
16	30	15
14	50	25
12	70	35
10	80	40

*UL - 486 A - Terminals (copper conductors only).

*UL - 486 C - Butt Splices, Parallel Splices

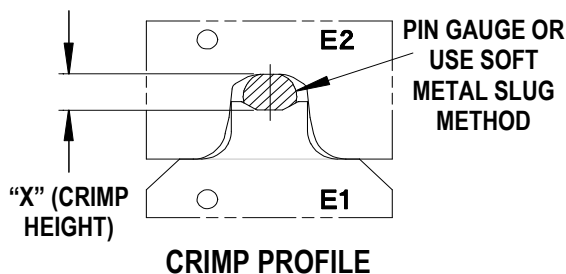

Use gauge pins or soft metal slug (solder) method to measure the "X" dimension. Verify tooling crimp height calibration by referring to the Go/No Go dimensions shown in the chart below.

Molex does not sell gauge pins contact your local industrial supplier.

Color Code	Wire Range		"X" Dimension Conductor Crimp			Crimp Inspection Marking
	AWG	mm ²	Mean	Go	No Go	
N/A	10 - 16	1.00 - 6.00	.119	.116	.123	N/A

The following is a Partial List of the Product Part Numbers and their specifications that this tooling is designed to crimp. We will be adding to this list and an up to date copy is available on www.molex.com.

HEAVY DUTY					
Wire Size: 14 - 16 AWG 1.00 - 2.50mm ²					
Terminal No.	Terminal Eng No. (REF)	Wire Strip Length		Insulation Diameter Maximum	
		In	mm	In	mm
19044-0019	B-128-04HDT	.281	7.14	N/A	N/A
19044-0020	B-128-06HDT	.281	7.14	N/A	N/A
19044-0021	B-128-08HDT	.281	7.14	N/A	N/A
19044-0022	B-130-10HDT	.281	7.14	N/A	N/A
19044-0023	B-130-14HDT	.281	7.14	N/A	N/A
19044-0024	B-130-56HDT	.281	7.14	N/A	N/A
19044-0025	B-136-04HDT	.281	7.14	N/A	N/A
19044-0026	B-136-06HDT	.281	7.14	N/A	N/A
19044-0027	B-136-08HDT	.281	7.14	N/A	N/A
19044-0164	B-128-10HDT	.281	7.14	N/A	N/A
19054-0023	B-236-04HDXT	.312	7.93	.250	6.35
19054-0024	B-236-06HDXT	.312	7.93	.250	6.35
19054-0025	B-236-08HDXT	.312	7.93	.250	6.35
19056-0080	B-328-06HDT	.281	7.14	N/A	N/A
19056-0082	B-328-08HDT	.281	7.14	N/A	N/A
19056-0084	B-328-10HDT	.281	7.14	N/A	N/A
19056-0086	B-330-10HDT	.281	7.14	N/A	N/A
19056-0088	B-330-14HDT	.281	7.14	N/A	N/A
19056-0090	B-330-56HDT	.281	7.14	N/A	N/A
19056-0096	B-336-04HDT	.281	7.14	N/A	N/A
19056-0098	B-336-06HDT	.281	7.14	N/A	N/A
19056-0100	B-336-08HDT	.281	7.14	N/A	N/A
19117-0057	B-117-10HDT	.281	7.14	N/A	N/A
19117-0086	B-117-06HDT	.281	7.14	N/A	N/A
19117-0087	B-117-08HDT	.281	7.14	N/A	N/A
19119-0063	B-217-06HDXT	.312	7.93	.250	6.35
19119-0064	B-217-08HDXT	.312	7.93	.250	6.35
19119-0065	B-217-10HDXT	.312	7.93	.250	6.35
19123-0056	B-317-06HDT	.281	7.14	N/A	N/A
19123-0057	B-317-08HDT	.281	7.14	N/A	N/A
19123-0058	B-317-10HDT	.281	7.14	N/A	N/A
19140-0136	B-141-06HDT	.281	7.14	N/A	N/A
19140-0137	B-141-08HDT	.281	7.14	N/A	N/A
19140-0138	B-141-10HDT	.281	7.14	N/A	N/A
19146-0073	B-341-06HDT	.281	7.14	N/A	N/A
19146-0074	B-341-08HDT	.281	7.14	N/A	N/A
19146-0075	B-341-10HDT	.281	7.14	N/A	N/A

Wire Size: 10 - 12 AWG 4.00 - 6.00mm ²					
Terminal No.	Terminal Eng No. (REF)	Wire Strip Length		Insulation Diameter Maximum	
		In	mm	In	mm
19069-0147	C-128-04T	.281	7.14	N/A	N/A
19069-0148	C-128-06T	.281	7.14	N/A	N/A
19069-0149	C-130-38T	.281	7.14	N/A	N/A
19069-0150	C-136-04T	.281	7.14	N/A	N/A
19069-0208	C-128-08T	.281	7.14	N/A	N/A
19069-0212	C-128-10T	.281	7.14	N/A	N/A
19069-0218	C-130-10T	.281	7.14	N/A	N/A
19069-0221	C-130-14T	.281	7.14	N/A	N/A
19069-0225	C-130-56T	.281	7.14	N/A	N/A
19069-0232	C-136-06T	.281	7.14	N/A	N/A
19069-0235	C-136-08T	.281	7.14	N/A	N/A
19069-0443	C-101-14T	.281	7.14	N/A	N/A
19079-0012	C-1006-MST	.281	7.14	N/A	N/A
19087-0146	C-1103-08T	.281	7.14	N/A	N/A
19087-0148	C-1106-06T	.281	7.14	N/A	N/A
19087-0150	C-112-06T	.281	7.14	N/A	N/A
19087-0152	C-112-08T	.281	7.14	N/A	N/A
19087-0154	C-112-10T	.281	7.14	N/A	N/A
19093-0066	C-3103-08T	.281	7.14	N/A	N/A
19093-0068	C-3106-06T	.281	7.14	N/A	N/A
19093-0070	C-312-06T	.281	7.14	N/A	N/A
19093-0072	C-312-08T	.281	7.14	N/A	N/A
19093-0074	C-312-10T	.281	7.14	N/A	N/A
19098-0062	C-1196-06T	.281	7.14	N/A	N/A
19098-0064	C-1197-08T	.281	7.14	N/A	N/A
19098-0066	C-1198-10T	.281	7.14	N/A	N/A
19098-0070	C-1710-06T	.281	7.14	N/A	N/A
19098-0075	C-1719-10T	.281	7.14	N/A	N/A
19098-0086	C-1199-14T	.281	7.14	N/A	N/A
19098-0087	C-1710-05T	.281	7.14	N/A	N/A
19098-0088	C-1711-08T	.281	7.14	N/A	N/A
19098-0089	C-1712-10T	.281	7.14	N/A	N/A
19098-0091	C-1718-08T	.281	7.14	N/A	N/A
19118-0081	C-1104-08T	.281	7.14	N/A	N/A
19118-0083	C-1104-10T	.281	7.14	N/A	N/A
19118-0084	C-117-06T	.281	7.14	N/A	N/A
19118-0087	C-117-08T	.281	7.14	N/A	N/A
19118-0090	C-117-10T	.281	7.14	N/A	N/A
19118-0128	C-1101-08T	.281	7.14	N/A	N/A
19118-0129	C-1104-06T	.281	7.14	N/A	N/A
19124-0062	C-3101-08T	.281	7.14	N/A	N/A

Wire Size: 10 – 12 AWG 4.00 – 6.00mm ²					
Terminal No.	Terminal Eng No. (REF)	Wire Strip Length		Insulation Diameter Maximum	
		In	mm	In	mm
19124-0064	C-3104-06T	.281	7.14	N/A	N/A
19124-0068	C-317-06T	.281	7.14	N/A	N/A
19124-0070	C-317-08T	.281	7.14	N/A	N/A
19124-0072	C-317-10T	.281	7.14	N/A	N/A
19129-0006	C-1105-08T	.281	7.14	N/A	N/A
19129-0079	C-1102-08T	.281	7.14	N/A	N/A
19141-0080	C-1105-06T	.281	7.14	N/A	N/A
19141-0082	C-141-06T	.281	7.14	N/A	N/A
19141-0084	C-141-08T	.281	7.14	N/A	N/A
19141-0086	C-141-10T	.281	7.14	N/A	N/A
19147-0084	C-3102-08T	.281	7.14	N/A	N/A
19147-0087	C-3105-06T	.281	7.14	N/A	N/A
19147-0089	C-3105-08T	.281	7.14	N/A	N/A
19147-0091	C-3105-10T	.281	7.14	N/A	N/A
19147-0093	C-341-06T	.281	7.14	N/A	N/A
19147-0095	C-341-08T	.281	7.14	N/A	N/A
19147-0098	C-341-10T	.281	7.14	N/A	N/A
19178-0015	C-111-06T	.281	7.14	N/A	N/A
19178-0017	C-111-08T	.281	7.14	N/A	N/A
19178-0019	C-111-10T	.281	7.14	N/A	N/A
19178-0023	C-199-14T	.281	7.14	N/A	N/A
19180-0014	C-311-06T	.281	7.14	N/A	N/A
19180-0016	C-311-08T	.281	7.14	N/A	N/A
19180-0018	C-311-10T	.281	7.14	N/A	N/A
19180-0020	C-399-14T	.281	7.14	N/A	N/A
19189-0017	C-146T	.234	5.95	N/A	N/A
19193-0105	C-328-06T	.281	7.14	N/A	N/A
19193-0108	C-328-08T	.281	7.14	N/A	N/A
19193-0111	C-328-10T	.281	7.14	N/A	N/A

Wire Size: 10 – 12 AWG 4.00 – 6.00mm ²					
Terminal No.	Terminal Eng No. (REF)	Wire Strip Length		Insulation Diameter Maximum	
		In	mm	In	mm
19193-0113	C-328-209T	.281	7.14	N/A	N/A
19193-0115	C-330-10T	.281	7.14	N/A	N/A
19193-0118	C-330-14T	.281	7.14	N/A	N/A
19193-0122	C-330-56T	.281	7.14	N/A	N/A
19193-0127	C-336-04T	.281	7.14	N/A	N/A
19193-0129	C-336-06T	.281	7.14	N/A	N/A
19193-0131	C-336-08T	.281	7.14	N/A	N/A
19193-0133	C-340-10T	.281	7.14	N/A	N/A
19193-0135	C-340-14T	.281	7.14	N/A	N/A
19203-0092	C-S-128-06T	.281	7.14	N/A	N/A
19203-0094	C-S-128-10T	.281	7.14	N/A	N/A
19203-0095	C-S-130-14T	.281	7.14	N/A	N/A
19203-0096	C-S-130-56T	.281	7.14	N/A	N/A
19203-0097	C-T-328-06T	.281	7.14	N/A	N/A
19203-0098	C-T-328-08T	.281	7.14	N/A	N/A
19203-0100	C-T-328-10T	.281	7.14	N/A	N/A
19203-0101	C-T-330-14T	.281	7.14	N/A	N/A
19203-0111	C-U-128-06T	.281	7.14	N/A	N/A
19203-0112	C-U-128-08T	.281	7.14	N/A	N/A
19203-0114	C-U-128-10T	.281	7.14	N/A	N/A
19203-0115	C-U-130-14T	.281	7.14	N/A	N/A
19203-0116	C-U-130-56T	.281	7.14	N/A	N/A
19203-0117	C-U-140-38T	.281	7.14	N/A	N/A
19203-0278	C-S-128-08T	.281	7.14	N/A	N/A
19211-0002	WP-1210T	.281	7.14	N/A	N/A
19215-0027	CB-346T	.359	9.12	N/A	N/A
19215-0030	CS-346T	.359	9.12	N/A	N/A

Parts List

Item	Order No.	Engineering No.	Description	Qty
	19027-0088	ATP-C-130	ATP Tooling Kit	REF
1	19027-0089	ATP-C-130-E1	Conductor Anvil	1
2	19027-0090	ATP-C-130-E2	Conductor Punch	1
3	N/A	N/A	#10-32 by 5/8" SHCS	2**
4	N/A	N/A	O-ring 1/16 W. by 9/32" O.D.	2**

** The following purchased parts are available from an Industrial supply company such as MSC 1-800-645-7270

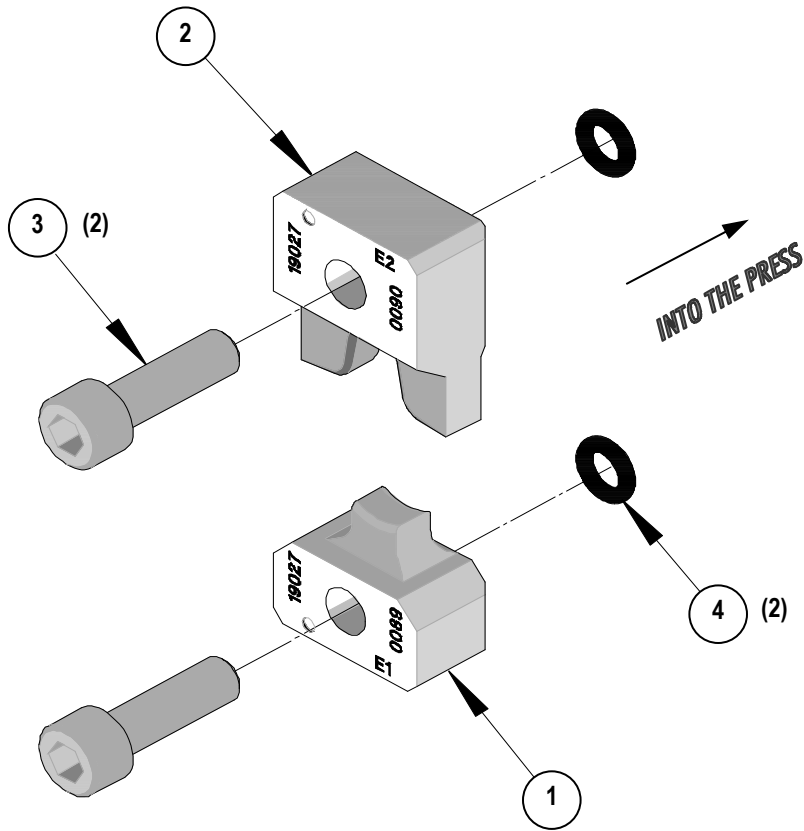

<http://www.molex.com>