



Chipsmall Limited consists of a professional team with an average of over 10 year of expertise in the distribution of electronic components. Based in Hongkong, we have already established firm and mutual-benefit business relationships with customers from,Europe,America and south Asia,supplying obsolete and hard-to-find components to meet their specific needs.

With the principle of “Quality Parts,Customers Priority,Honest Operation,and Considerate Service”,our business mainly focus on the distribution of electronic components. Line cards we deal with include Microchip,ALPS,ROHM,Xilinx,Pulse,ON,Everlight and Freescale. Main products comprise IC,Modules,Potentiometer,IC Socket,Relay,Connector.Our parts cover such applications as commercial,industrial, and automotives areas.

We are looking forward to setting up business relationship with you and hope to provide you with the best service and solution. Let us make a better world for our industry!



Contact us

Tel: +86-755-8981 8866 Fax: +86-755-8427 6832

Email & Skype: info@chipsmall.com Web: www.chipsmall.com

Address: A1208, Overseas Decoration Building, #122 Zhenhua RD., Futian, Shenzhen, China



13	12	11	10	9	8	7	6	5	4	3	2	1
MATERIAL NUMBER	ENGINEERING NUMBER	MATERIAL NUMBER TAPE	ENGINEERING NUMBER TAPE	WIRE AWG	MWID $\triangle 4$	ID MIN	INSULATION COLOR					
191640010	SA-269	191640807	SA-269T	22-18	.235/5.97	.054/1.37	RED					
191640040	SB-289	191640315	SB-289T	16-14	.264/6.71	.080/2.03	BLUE					

(A)

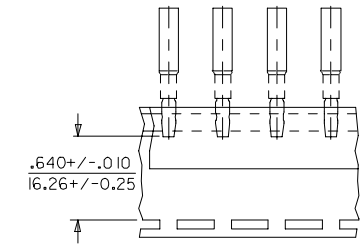

PARTS ON TAPE

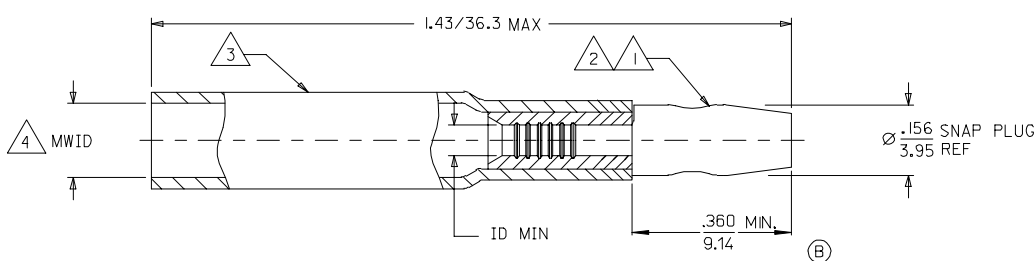

(B)

SALES DRAWING

NOTES:

- $\triangle 1$ TERMINAL MATERIAL: COPPER ALLOY
- $\triangle 2$ FINISH: ELECTRO TIN PLATE.
- $\triangle 3$ INSULATION MATERIAL: HEAT SHRINKABLE TUBING WITH HOTMELT ADHESIVE INNER LINER. COLOR: SEE CHART
- $\triangle 4$ MWID = MAXIMUM WIRE INSULATION DIAMETER.

RELEASED FC NO: ETC2007-0054 DRWN: JLOMASTRO 2006/08/16 CHKD: RDEROSS 2006/08/16 APPR: JMACNEIL 2006/08/17 REVISION DESCRIPTION	QUALITY SYMBOLS	GENERAL TOLERANCES (UNLESS SPECIFIED)		DIMENSION STYLE	SCALE	DESIGN UNITS	THIRD ANGLE PROJECTION	
	$\nabla = 0$ $\nabla = 0$	mm	INCH	IN/MM	---	INCH		
		4 PLACES ± ---	± ---	ASAYDEH	DATE	05/12/13	TITLE	
		3 PLACES ± ---	± ---	CHECKED BY	DATE	05/12/13	.156 BULLET PLUG PERMA-SEAL	
	2 PLACES ± ---	± ---	APPROVED BY	DATE	05/12/13	MATERIAL NO.		
	1 PLACE ± ---	± ---	RDEROSS	DATE	05/12/13	DOCUMENT NO.		
	ANGULAR ± --- °	± --- °	MATERIAL NO.		SD-19164-031		SHEET NO.	
			DRAFT WHERE APPLICABLE MUST REMAIN WITHIN DIMENSIONS		SEE CHART		1 OF 1	
			SIZE C		THIS DRAWING CONTAINS INFORMATION THAT IS PROPRIETARY TO MOLEX INCORPORATED AND SHOULD NOT BE USED WITHOUT WRITTEN PERMISSION			