



Chipsmall Limited consists of a professional team with an average of over 10 year of expertise in the distribution of electronic components. Based in Hongkong, we have already established firm and mutual-benefit business relationships with customers from,Europe,America and south Asia,supplying obsolete and hard-to-find components to meet their specific needs.

With the principle of “Quality Parts,Customers Priority,Honest Operation,and Considerate Service”,our business mainly focus on the distribution of electronic components. Line cards we deal with include Microchip,ALPS,ROHM,Xilinx,Pulse,ON,Everlight and Freescale. Main products comprise IC,Modules,Potentiometer,IC Socket,Relay,Connector.Our parts cover such applications as commercial,industrial, and automotives areas.

We are looking forward to setting up business relationship with you and hope to provide you with the best service and solution. Let us make a better world for our industry!



Contact us

Tel: +86-755-8981 8866 Fax: +86-755-8427 6832

Email & Skype: info@chipsmall.com Web: www.chipsmall.com

Address: A1208, Overseas Decoration Building, #122 Zhenhua RD., Futian, Shenzhen, China



MATERIAL NUMBER	ENGINEERING NUMBER	WIRE RANGE	"L" MAX	"A" MIN	"B" MAX	MATERIAL	MATERIAL THICKNESS	TEMPERATURE RATING
192030165	A-T-302	22-18 (0.3-1.0mm ²)	.330 / (8.4)	.060 / (1.5)	.130 / (3.3)	COPPER	.032 / (0.8)	650F (342C)
192030172	B-T-304	16-14 (1.2-2.0mm ²)	.330 / (8.4)	.091 / (2.3)	.160 / (4.1)	COPPER	.032 / (0.8)	650F (342C)
192030169	C-T-303	12-10 (3.0-6.0mm ²)	.330 / (8.4)	.130 / (3.3)	.225 / (5.7)	COPPER	.040 / (1.0)	650F (342C)

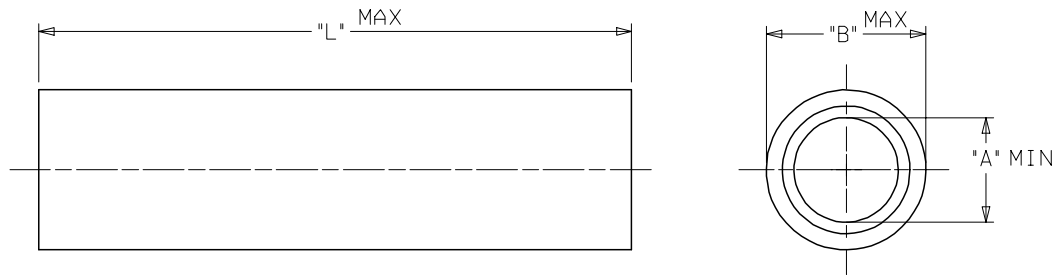

NOTES:
 1. PLATING: ELECTRO-NICKEL.
 2. ALL DIMENSIONS IN INCHES/(MM).
 3. RoHS COMPLIANT

RELEASE FOR PROD EC NO: ETC2007-0146 DRW: JLOMASTRO 2006/10/11 CHKD: JMACNEIL 2006/10/11 APPR: JMACNEIL 2006/10/12	QUALITY SYMBOLS ▽=0 ▽=0	GENERAL TOLERANCES (UNLESS SPECIFIED)		DIMENSION STYLE	SCALE	DESIGN UNITS	THIRD ANGLE PROJECTION	
			mm	INCH	IN/MM	INCH		
		4 PLACES	± ---	± ---	DRAWN BY	DATE	TITLE	
		3 PLACES	± ---	± .010	JLOMASTRO	10/02/06	PARALLEL SPLICE VERSAKRIMP TEMP TERMS	
2 PLACES	± 0.25	± .01	CHECKED BY	DATE				
1 PLACE	± 0.3	± ---	JMACNEIL	10/02/06				
		ANGULAR ±1/2°	APPROVED BY	DATE				
			RDEROSS	10/04/06				
			MATERIAL NO.	DOCUMENT NO.				
			SEE CHART	SD-19203-042				
			SIZE	THIS DRAWING CONTAINS INFORMATION THAT IS PROPRIETARY TO MOLEX INCORPORATED AND SHOULD NOT BE USED WITHOUT WRITTEN PERMISSION				
			B					
				SHEET NO. 1 OF 1				