



Chipsmall Limited consists of a professional team with an average of over 10 year of expertise in the distribution of electronic components. Based in Hongkong, we have already established firm and mutual-benefit business relationships with customers from,Europe,America and south Asia,supplying obsolete and hard-to-find components to meet their specific needs.

With the principle of “Quality Parts,Customers Priority,Honest Operation,and Considerate Service”,our business mainly focus on the distribution of electronic components. Line cards we deal with include Microchip,ALPS,ROHM,Xilinx,Pulse,ON,Everlight and Freescale. Main products comprise IC,Modules,Potentiometer,IC Socket,Relay,Connector.Our parts cover such applications as commercial,industrial, and automotives areas.

We are looking forward to setting up business relationship with you and hope to provide you with the best service and solution. Let us make a better world for our industry!



Contact us

Tel: +86-755-8981 8866 Fax: +86-755-8427 6832

Email & Skype: info@chipsmall.com Web: www.chipsmall.com

Address: A1208, Overseas Decoration Building, #122 Zhenhua RD., Futian, Shenzhen, China



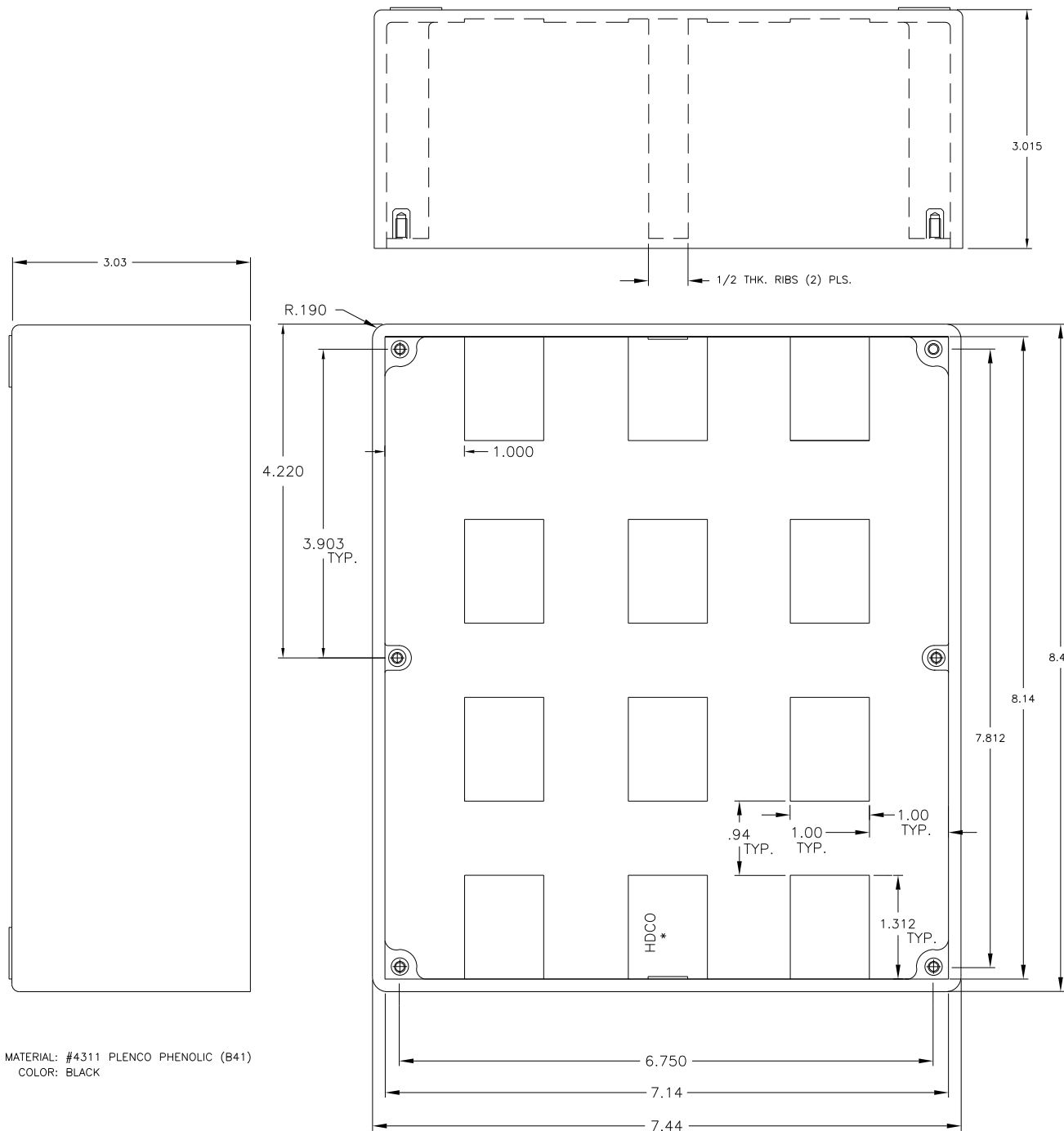

MATERIAL: #4311 PLENCO PHENOLIC (B41)
 COLOR: BLACK

NOTE(S) :

- (1) DURING MOLDING PROCESS NO BLISTERED, WARPPED CONDITIONS PERMITTED.
- (2) DURING MOLDING PROCESS OPERATOR MUST USE COOLING FIXTURE.
- (3) DURING MOLDING PROCESS NO PLASTICS FLASHES ALLOWED IN FM.BRASS INSERTS (6) PLS.
- (4) OPERATOR MUST CLEANED ALL FOUR (4) CORNERS FOR SMOOTH CONDITIONS.

CAD/REDRAWN :4/17/97 : HD

6-32 UNC-2B THREAD.
 INSERT NO. 10183,
 H.H.BRASS,
 (6) PLS. X 5/16 DEEP

TOLERANCES: UNLESS OTHERWISE SPECIFIED	DO NOT SCALE DRAWING	BASE PART 0280-01
DECIMALS: X.XXX ± .005 X.XX ± .015	MM: X.XX ± 0.15MM X.X ± 0.4MM	P/N # 0280
FRACTIONS ± 1/64	ANG. ± 1°	INSERT 10183

B	ADDED BASE PART	JAM	1/31/14
A	WAS 10011	JAM	10/28/02
C H A N G E S			

HARRY DAVIES MOLDING Co.L.L.C.		
DATE	5/13/71	MOLD No:0280
DRAWN BY	NH	FRAME No:0280
APPROVED	BY XXXX	SHEET 1 of 1
SCALE	FULL	