



Chipsmall Limited consists of a professional team with an average of over 10 year of expertise in the distribution of electronic components. Based in Hongkong, we have already established firm and mutual-benefit business relationships with customers from,Europe,America and south Asia,supplying obsolete and hard-to-find components to meet their specific needs.

With the principle of “Quality Parts,Customers Priority,Honest Operation,and Considerate Service”,our business mainly focus on the distribution of electronic components. Line cards we deal with include Microchip,ALPS,ROHM,Xilinx,Pulse,ON,Everlight and Freescale. Main products comprise IC,Modules,Potentiometer,IC Socket,Relay,Connector.Our parts cover such applications as commercial,industrial, and automotives areas.

We are looking forward to setting up business relationship with you and hope to provide you with the best service and solution. Let us make a better world for our industry!



## Contact us

Tel: +86-755-8981 8866 Fax: +86-755-8427 6832

Email & Skype: [info@chipsmall.com](mailto:info@chipsmall.com) Web: [www.chipsmall.com](http://www.chipsmall.com)

Address: A1208, Overseas Decoration Building, #122 Zhenhua RD., Futian, Shenzhen, China



## NOTES:

1. MATERIALS AND FINISHES(PLATING THICKNESS IN MICRO-INCHES):  
BODY - BRASS, NICKEL PLATING  
CONTACT - BERYLLIUM COPPER, GOLD PLATING  
INSULATOR - PTFE, NATURAL
2. ELECTRICAL:  
A. IMPEDANCE: 50 OHM  
B. FREQUENCY RANGE: DC 0-11 GHz  
C. VSWR(RETURN LOSS): 1.3, MAX.  
D. DIELECTRIC WITHSTANDING VOLTAGE: 1500 VRMS, MIN.
3. MECHANICAL:  
A. DURABILITY: 500 CYCLES MIN.  
B. TEMPERATURE RANGE: - 65°C to +165°C
4. SEE AMPHENOL SPEC. 349-50586 FOR CABLE STRIPPING AND ASSEMBLY INSTRUCTIONS

THIRD ANGLE PROJ.



## REVISIONS

| REV | DESCRIPTION | DATE      | ECO   | APPR  |
|-----|-------------|-----------|-------|-------|
| A2  | SEE SHEET 1 | 28-Oct-02 | --    | TONY  |
| A3  | SEE SHEET 1 | 21-Apr-03 | --    | TONY  |
| A4  | SEE SHEET 1 | 19-Sep-03 | --    | SHALY |
| B   | SEE SHEET 1 | 28-Oct-02 | --    | SH    |
| E   | SEE SHEET 1 | 23-Jun-05 | 47077 | SCOTT |

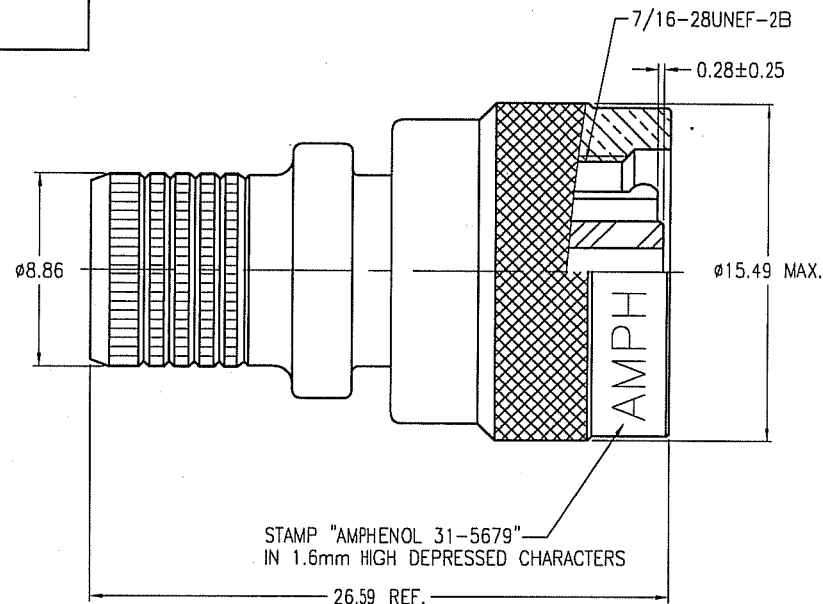
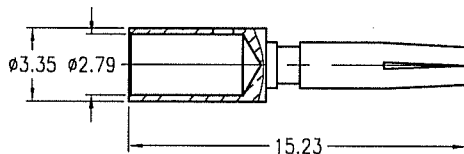
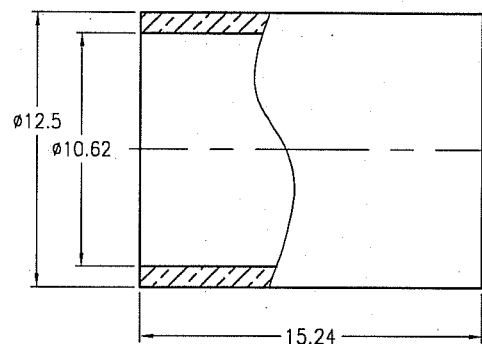

## CUSTOMER OUTLINE DRAWING

ALL OTHER SHEETS ARE FOR INTERNAL USE ONLY

UNLESS OTHERWISE SPECIFIED, DIMENSIONS ARE IN METRIC AND TOLERANCES ARE:  
0.5 - 6mm ±0.1mm 6 - 30mm ±0.2mm 30 - 120mm ±0.3mm ANGLES ±1°

NOTICE - These drawings, specifications, or other data (1) are, and remain the property of Amphenol Corp. (2) must be returned upon request; and (3) are confidential and not to be disclosed to any person other than those to whom they are given by Amphenol Corp. The furnishing of these drawings, specifications, or other data by Amphenol Corp., or to any other person to anyone for any purpose is not to be regarded by implication or otherwise in any manner licensing, granting rights or permitting such holder or any other person to manufacture, use or sell any product, process or design, patented or otherwise, that may in any way be related to or disclosed by said drawings, specifications, or other data.

MATERIAL

REFERENCE

FINISH

DRAWN

ROCKY

ENGINEER

SCOTT.H

APPROVED

SCOTT.H

CAD FILE

F:\DWG\CNPD\31\5679-ESZ

DATE

23-Sep-05

DATE

23-Sep-05

DATE

23-Sep-05

TITLE

TNC PLUG REVERSE INTERFACE  
(FOR BELDEN 9913 CABLE)

SCALE: 3/1

DWG SIZE

B

CODE ID

74868

REV

E

SHEET 2 OF 2

Amphenol RF

Danbury CT USA, Tainan Taiwan, Shenzhen China  
www.amphenolrf.com

DRAWING NO. 31-5679

ITEM NO. 31-5679

PART NO. 31-5679