



Chipsmall Limited consists of a professional team with an average of over 10 year of expertise in the distribution of electronic components. Based in Hongkong, we have already established firm and mutual-benefit business relationships with customers from,Europe,America and south Asia,supplying obsolete and hard-to-find components to meet their specific needs.

With the principle of “Quality Parts,Customers Priority,Honest Operation,and Considerate Service”,our business mainly focus on the distribution of electronic components. Line cards we deal with include Microchip,ALPS,ROHM,Xilinx,Pulse,ON,Everlight and Freescale. Main products comprise IC,Modules,Potentiometer,IC Socket,Relay,Connector.Our parts cover such applications as commercial,industrial, and automotives areas.

We are looking forward to setting up business relationship with you and hope to provide you with the best service and solution. Let us make a better world for our industry!



Contact us

Tel: +86-755-8981 8866 Fax: +86-755-8427 6832

Email & Skype: info@chipsmall.com Web: www.chipsmall.com

Address: A1208, Overseas Decoration Building, #122 Zhenhua RD., Futian, Shenzhen, China



SHEET DESCRIPTION
CONFIGURATIONS

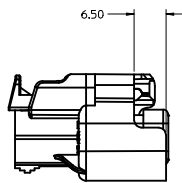

OPTION A

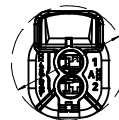
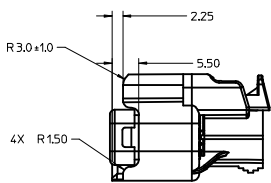

REAR VIEW

Ø23.40
MINIMUM PASS-THRU WITH
NO CLEARANCE
APPLIES TO NON CLIP-SLOT
OPTIONS A, C, D, & G

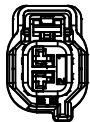
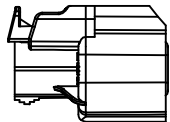

OPTION B

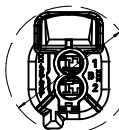
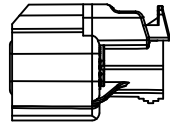

REAR VIEW

Ø26.00
MINIMUM PASS-THRU WITH
NO CLEARANCE
APPLIES TO NON CLIP-SLOT
OPTIONS B, E, & F

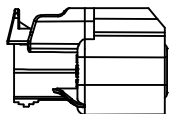

OPTION C

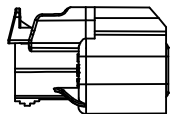
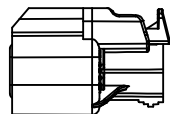

OPTION D

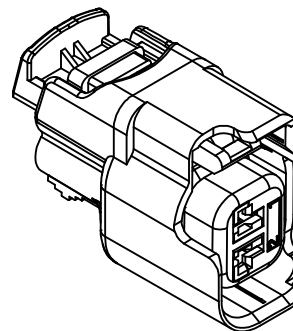
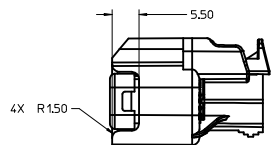

NON CLIP-SLOT OPTION
SCALE 4:1

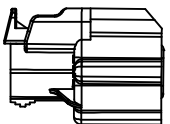

OPTION E

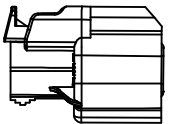
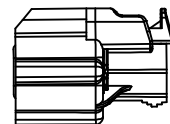

OPTION F

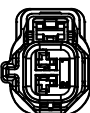
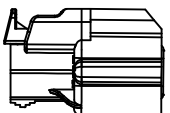
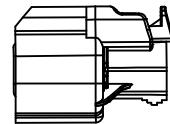

OPTION G

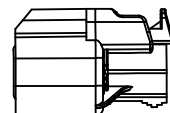

ENTER DESCRIPTION IEC NO. UAU2016-1241 DRAWN BY GURUSZENSKI, 2016/02/19 CHKD: CHYD: APPR: WKSHY 2016/02/22	QUALITY SYMBOLS ∇=0 ∇=0 ∇=0	GENERAL TOLERANCES (UNLESS SPECIFIED)		DIMENSION STYLE MM ONLY		SCALE 2:1	DESIGN UNITS METRIC	THIRD ANGLE PROJECTION
		4 PLACES ± --- ± --- 3 PLACES ± --- ± --- 2 PLACES ± 0.10 ± --- 1 PLACE ± 0.3 ± --- 0 PLACE ± ±	mm INCH ANGULAR ± 3 ° DRAFT WHERE APPLICABLE MUST REMAIN WITHIN DIMENSIONS	DRAWN BY DATE KCUNNINGHAM 2011/11/08 CHECKED BY DATE MYANSLAMBROU 1/26/2012 APPROVED BY DATE	TITLE MX150 2 WAY CABLE SEAL RECEPTACLE CONN. SYSTEM (5.0MM PITCH)		MATERIAL NO. SEE NOTE 2a.	DOCUMENT NO. SD-34062-002

SHEET DESCRIPTION
CONFIGURATIONS

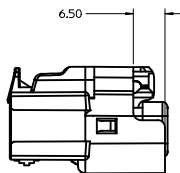

OPTION A W/CLIP-SLOT *

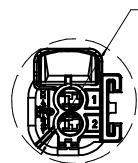
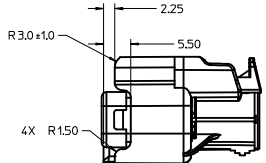

Ø 25.50
MINIMUM PASS-THRU WITH NO CLEARANCE APPLIES TO CLIP-SLOT OPTIONS A, C AND D

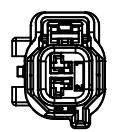
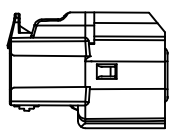

OPTION B W/CLIP-SLOT *

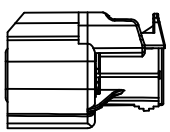

Ø 26.00
MINIMUM PASS-THRU WITH NO CLEARANCE APPLIES TO CLIP-SLOT OPTION B

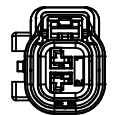
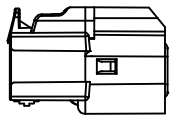

OPTION C W/CLIP-SLOT *

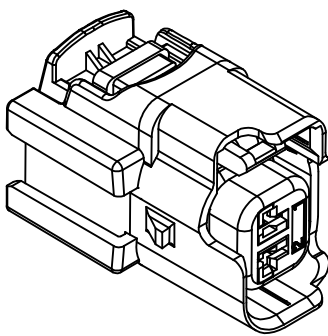
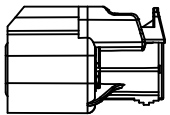

CLIP-SLOT OPTION
SCALE 4:1

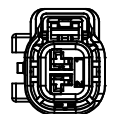
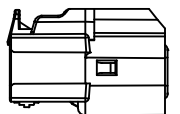

OPTION D W/CLIP-SLOT *

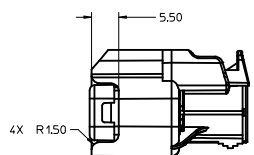

*WITH CLIP-SLOT CONFIGURATIONS
DO NOT MEET THE USCAR PACKAGING FRAME REQUIREMENTS

ENTER DESCRIPTION LEC NO: UAU2016-1241 DRAWN: BORUSZENSKI, 2016/02/19 CHKD: APPR: IKOSHY 2016/02/22 J18	QUALITY SYMBOLS ∇=0 ∇=0 ∇=0	GENERAL TOLERANCES (UNLESS SPECIFIED) <table border="1"> <tr> <th></th> <th>mm</th> <th>INCH</th> </tr> <tr> <td>4 PLACES</td> <td>± .10</td> <td>± .004</td> </tr> <tr> <td>3 PLACES</td> <td>± .15</td> <td>± .006</td> </tr> <tr> <td>2 PLACES</td> <td>± 0.10</td> <td>± .004</td> </tr> <tr> <td>1 PLACE</td> <td>± 0.3</td> <td>± .012</td> </tr> <tr> <td>0 PLACE</td> <td>±</td> <td>±</td> </tr> </table>		mm	INCH	4 PLACES	± .10	± .004	3 PLACES	± .15	± .006	2 PLACES	± 0.10	± .004	1 PLACE	± 0.3	± .012	0 PLACE	±	±	DIMENSION STYLE MM ONLY	SCALE 2:1	DESIGN UNITS METRIC	THIRD ANGLE PROJECTION
		mm	INCH																					
	4 PLACES	± .10	± .004																					
	3 PLACES	± .15	± .006																					
2 PLACES	± 0.10	± .004																						
1 PLACE	± 0.3	± .012																						
0 PLACE	±	±																						
DRAFT WHERE APPLICABLE MUST REMAIN WITHIN DIMENSIONS		MATERIAL NO. SEE NOTE 2a.	DRAWN BY KCUNNINGHAM	DATE 2011/11/08	CHECKED BY MVANSLAMBROU	DATE 1/26/2012																		
ANGULAR ± 3 °		DOCUMENT NO. SD-34062-002	TITLE MX150 2 WAY CABLE SEAL RECEPTACLE CONN. SYSTEM (5.0MM PITCH)																					
SIZE D		THIS DRAWING CONTAINS INFORMATION THAT IS PROPRIETARY TO MOLEX INCORPORATED AND SHOULD NOT BE USED WITHOUT WRITTEN PERMISSION																						

SHEET DESCRIPTION

RECEPTACLE CONNECTOR ASSEMBLY

CHARTED DIMENSIONS

CONFIGURATIONS	DIMENSIONS	
	A	B
OPTIONS A, C, D	16.6	22.0
OPTION B	16.6	23.9
OPTION E	20.2	23.9
OPTION F	16.6	23.9
OPTION G	18.4	22.0
OPTIONS A, C, D W/CLIP-SLOT	19.2	22.0
OPTION B W/CLIP-SLOT	19.2	23.9

OPTIONAL LASER MARKING SURFACE
SEE NOTE 3g

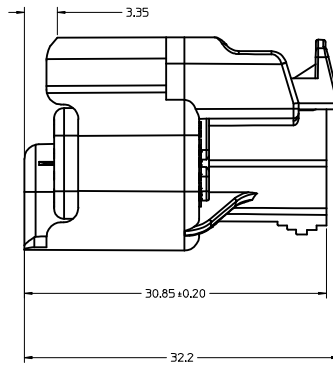
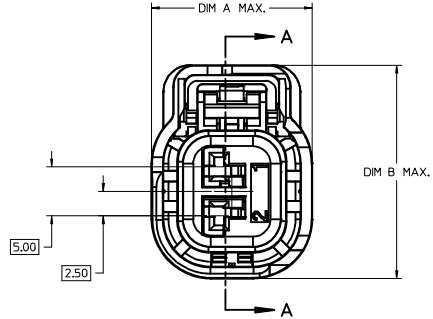
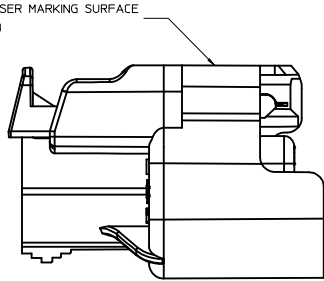

OPTIONAL LASER MARKING SURFACE
SEE NOTE 3g

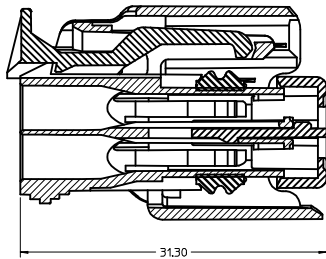
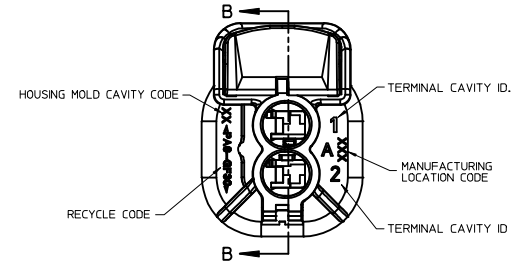
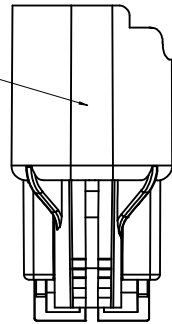

TPA SHOWN IN THE
PRE-STAGED POSITION
SECTION A-A

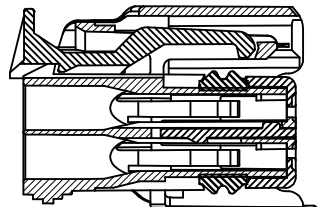

SECTION B-B
TPA SHOWN IN
FINAL-LOCK POSITION

ENTER DESCRIPTION IEC NO. UAU2016-1241 DRAWN/BORUSZENSKI, 2016/02/19 CHKD: APPR: WKOSHY J18	QUALITY SYMBOLS ∇=0 ∇=0 ∇=0	GENERAL TOLERANCES (UNLESS SPECIFIED)		DIMENSION STYLE MM ONLY		SCALE 4:1	DESIGN UNITS METRIC	THIRD ANGLE PROJECTION	
			mm	INCH	DRAWN BY KCUNNINGHAM	DATE 2011/11/08	TITLE MX150 2 WAY CABLE SEAL RECEPTACLE CONN. SYSTEM (5.0MM PITCH)		
		4 PLACES	±	---	CHECKED BY MYANSLAMBROU	DATE 1/26/2012	DOCUMENT NO. SD-34062-002		
		3 PLACES	±	---	APPROVED BY	DATE	SHEET NO. 4 OF 5		
			2 PLACES	±	0.10	MATERIAL NO. SEE NOTE 2a.			
			1 PLACE	±	0.3	SIZE D			
			0 PLACE	±		THIS DRAWING CONTAINS INFORMATION THAT IS PROPRIETARY TO MOLEX INCORPORATED AND SHOULD NOT BE USED WITHOUT WRITTEN PERMISSION			

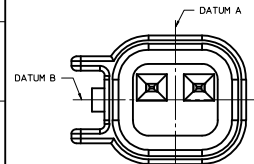

OPTIONS A, C, D
(SAME INTERFACE)

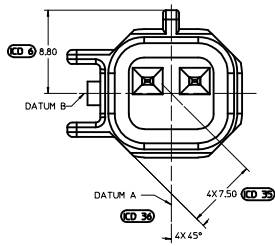

OPTION G

IF A HEADER IS RECESSED INTO A POCKET, THESE DIMENSIONS REPRESENT THE MINIMUM CLEARANCE REQUIRED FOR THE MATING CONNECTOR SHROUD.

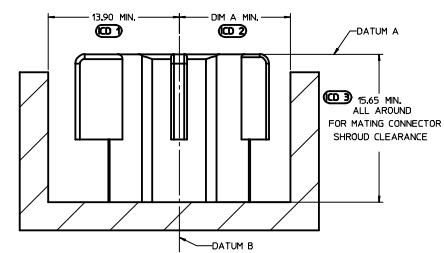

PACKAGING FRAME

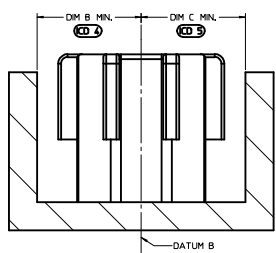

KEY OPTION	DIMENSIONS		
	DIM A	DIM B	DIM C
A, C, D	9.90	9.20	9.20
B	11.80	9.20	9.20
E	11.80	11.00	11.00
F	11.80	9.20	9.20
G	9.90	9.20	11.00
H	9.90	11.00	9.20

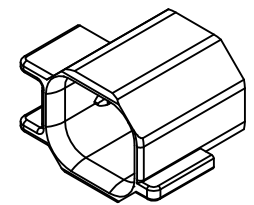

OPTION B

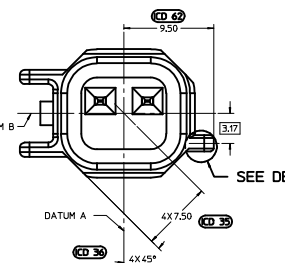

OPTION B

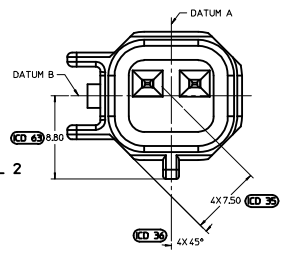

OPTION H

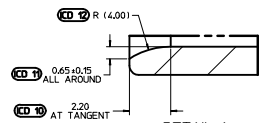

DETAIL 1
SCALE 10:1

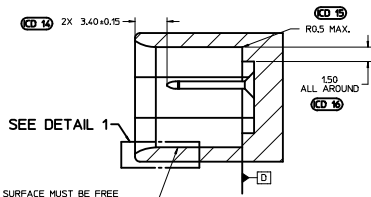

SECTION Y-Y

SEE DETAIL 1
SURFACE MUST BE FREE OF SURFACE DEFECTS AND PARTING LINES FOR SEALING ALL AROUND

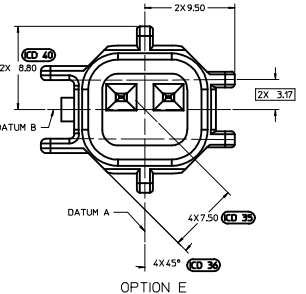

OPTION E

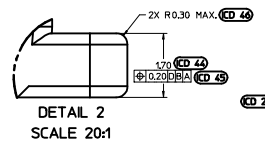

DETAIL 2
SCALE 20:1

TYPICAL
SEE KEYING OPTION VIEWS FOR POSITIONS

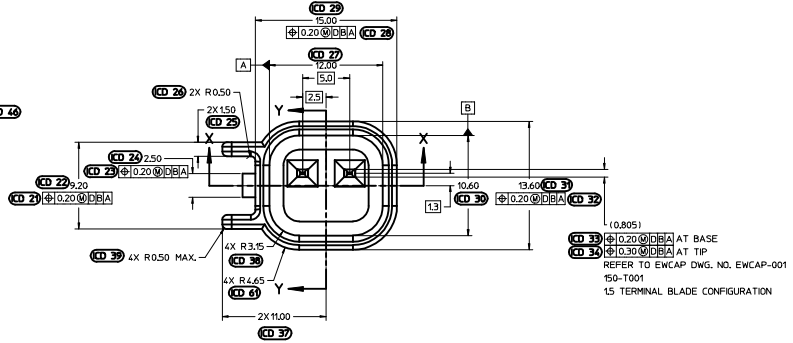

SECTION X-X

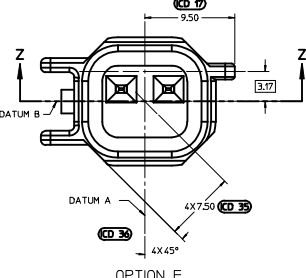

OPTION F

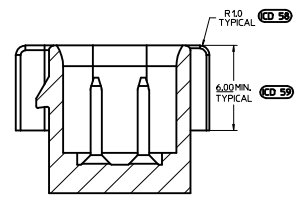

SECTION Z-Z
SEE KEYING OPTION VIEWS FOR POSITIONS

NOTES: UNLESS OTHERWISE SPECIFIED

- ALL DIMENSIONS SHOWN IN MILLIMETERS.
- DIMENSIONING AND TOLERANCING PER ASME Y14.5M-1994
- 0.25 RADI ON ALL CORNERS SHOWN SHARP.
- UNSPECIFIED RADI: 0.25 EXCEPT AS NOTED.
- STANDARD COLORS FOR POLARIZATION (SEE CHART). DEVIATION REQUIRES APPROVAL OF AUTHORIZED PERSON.
- REFER TO SAE/USCAR 12 CONNECTOR GUIDELINES FOR ADDITIONAL REQUIREMENTS.
- EXCEPT WHERE NOTED, DRAFT ON OUTSIDE SURFACES IS PERMISSIBLE WITHIN TOLERANCE.
- SYMBOL INDICATES DRAFT DIRECTION.
- FOR TERMINAL MATERIAL, DIMENSIONAL, AND COATING REQUIREMENTS AND ANY BLADE TERMINAL DESIGN INFORMATION NOT SHOWN ON THIS DRAWING SEE EWCAP DWG. NO. EWCAP-001
- A FULL SHROUD ON THE MATING CONNECTOR IS REQUIRED TO ENSURE THAT THE CONNECTOR-HEADER POLARIZATION FEATURES (OPTIONS A THRU H) WILL FUNCTION. THE FULL SHROUD ALSO PREVENTS SCOOP DAMAGE TO THE HEADER PINS. REFER TO SAE/USCAR-12 CONNECTOR DESIGN GUIDE LINES FOR ADDITIONAL INFORMATION.
- REFER TO USCAR/EWCAP PART LIST AS FOUND ON WEBSITE <http://www.uscarteoms.org>
- THIS IS A 100% CAD GENERATED PART. THE CAT MATHEMATICAL DATA IS THE MASTER FOR THIS PART. FOR DIMENSIONAL OR ANY INFORMATION NOT SHOWN ON THIS DRAWING, ANALYZE THE CAD MODEL.

OPTION	COLOR	SIMILAR TO AFL DRAWING R63461 (OPTION GEOMETRY IDENTICAL)	COMMENTS
A, C, D	BLACK	A	
B	LIGHT GRAY	B	
E	BLACK	E	NOT RECOMMENDED MATING CONNECTOR IS UNIVERSAL.
F	LIGHT GRAY	D	
G	BLACK	C	
H	LIGHT GRAY	F	

QUALITY SYMBOLS	GENERAL TOLERANCES (UNLESS SPECIFIED)		DIMENSION STYLE MM ONLY	SCALE 5:1	DESIGN UNITS METRIC	THIRD ANGLE PROJECTION	
	mm	INCH					
	∇	4 PLACES ± .010	± .005	DRAWN BY K CUNNINGHAM	DATE 2011/11/08	molex MX150 2 WAY CABLE SEAL RECEPTACLE CONN. SYSTEM (5.0MM PITCH)	
	∇	3 PLACES ± .010	± .005	CHECKED BY M VANS LAMBROU	DATE 1/26/2012		
∇	2 PLACES ± 0.13	± .005	APPROVED BY	DATE			
∇	1 PLACE ± 0.3	± .005					
	0 PLACE ± .	± .					
DRAFT WHERE APPLICABLE MUST REMAIN WITHIN DIMENSIONS			MATERIAL NO. N/A		DOCUMENT NO. SD-34062-002	SHEET NO. 5 OF 5	
ENTER DESCRIPTION EC NO. UAU2016-7241 DRAWING DESIGNER (016/02/15) APPROVER (KOSHY) DATE (02/22)							
J18 THIS DRAWING CONTAINS INFORMATION THAT IS PROPRIETARY TO MOLEX INCORPORATED AND SHOULD NOT BE USED WITHOUT WRITTEN PERMISSION							