



Chipsmall Limited consists of a professional team with an average of over 10 year of expertise in the distribution of electronic components. Based in Hongkong, we have already established firm and mutual-benefit business relationships with customers from,Europe,America and south Asia,supplying obsolete and hard-to-find components to meet their specific needs.

With the principle of "Quality Parts,Customers Priority,Honest Operation,and Considerate Service",our business mainly focus on the distribution of electronic components. Line cards we deal with include Microchip,ALPS,ROHM,Xilinx,Pulse,ON,Everlight and Freescale. Main products comprise IC,Modules,Potentiometer,IC Socket,Relay,Connector.Our parts cover such applications as commercial,industrial, and automotives areas.

We are looking forward to setting up business relationship with you and hope to provide you with the best service and solution. Let us make a better world for our industry!



## Contact us

Tel: +86-755-8981 8866 Fax: +86-755-8427 6832

Email & Skype: info@chipsmall.com Web: www.chipsmall.com

Address: A1208, Overseas Decoration Building, #122 Zhenhua RD., Futian, Shenzhen, China



2 WAY RECEPTACLE

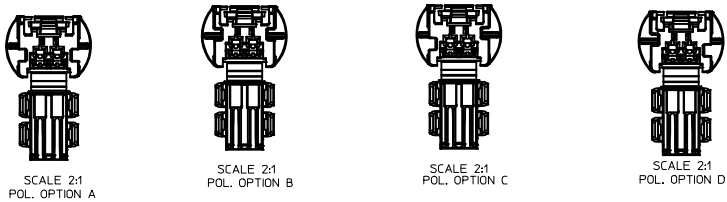

MX150 RECEPTACLE TERMINALS

PART NUMBER		MATERIAL	WIRE GAGE		PLATING
DIRRECTION B (RIGHT PAYOFF)	DIRRECTION D (LEFT PAYOFF)		METRIC (mm#)	SAE (AWG#)	
LARGE POLARIZATION RIB					
33012-2021	33012-3021	COPPER ALLOY	1.50	14/16	TIN
33012-2022	33012-3022	COPPER ALLOY	1.0 - 0.75	18/20	TIN
33012-2023	33012-3023	COPPER ALLOY	0.50	22	TIN

\* NOBLE PLATING TERMINAL AND YAZAKI TERMINAL NOT LIST AT THE TABLE

NOTES: VALID UNLESS OTHERWISE SPECIFIED

1. GENERAL:
  - a. APPLICATION SPECIFICATION SEE: AS-34796-001
  - b. PRODUCT SPECIFICATION SEE: PS-34976-001
  - c. PACKAGING SPECIFICATION PER MOLEX DRAWING: PK-31301-695
  - d. PARTS MUST BE IN COMPLIANCE TO MOLEX CHEMICAL SUBSTANCES FOR PRODUCTS AND PACKAGING SPECIFICATION: PS-40000-5015
  - e. DATA MUST BE SUBMITTED UNDER THE MOLEX PART NUMBER TO IMDS (COMPANY ID#13255)
  - f. FLAMMABILITY REQUIREMENT: PER ISO3795 OR GM3191
    1. BURN RATE 100 mm/MIN MAXIMUM
    2. MATERIAL MUST BE SELF EXTINGUISHING
  - g. VISUAL DEFECTS SHALL MEET COSMETIC STANDARD PS-45499-002 (Class B)
  - h. PACKAGING: IN THE EVENT THAT THE PART IS FOUND DAMAGE DURING TRANSIT, REFER TO MOLEX SPECIFICATION PS-31301-865, AVAILABLE AT WWW.MOLEX.COM <HTTP://WWW.MOLEX.COM>
2. DESIGN - MATERIALS:
  - a. MATERIAL: UNFILLED PBT
3. DESIGN - GEOMETRY:
  - a. THIS IS A 100% CAD GENERATED PART. THE CAD MATHEMATICAL DATA IS THE MASTER FOR THIS PART. FOR DIMENSIONAL OR ANY INFORMATION NOT SHOWN ON THIS DRAWING, ANALYZE THE CAD MODEL.
  - b. GEOMETRIC DIMENSIONS AND TOLERANCES PER ASME Y14.5M - 1994
  - c. GENERAL TOLERANCES:
    - LINEAR: PLEASE SEE BELOW
    - ANGULAR: ±3°
  - d. EDGES AND UNDIMENSIONED DETAILS PER ISO13715
  - e. CORNERS SHOWN AS SHARP TO BE R 0.2 MAX
  - f. LETTERING SHALL BE 0.1 MAX RAISED IN 0.15 MAX RECESS PAD AND NOT PROTRUDE THE SURFACE. THIS INCLUDES RECYCLING CODE, PLANT AND CAVITY ID, VENDOR ID, CIRCUIT ID, AND PART SERIES NUMBER.

3 WAY RECEPTACLE

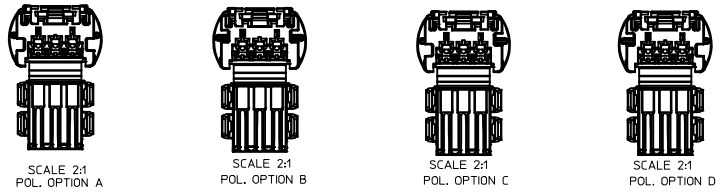

4 WAY RECEPTACLE

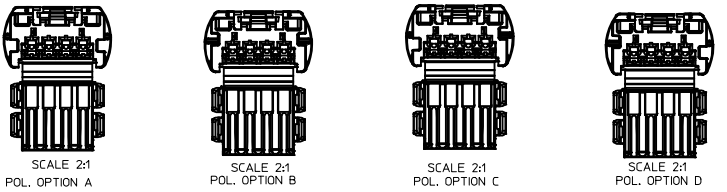

MX150 RECEPTACLE ASSEMBLIES

MATERIAL NUMBER BULK PACKAGING	CIRCUIT	POL	COLOR	MATING MALE CONNECTOR	
				/W GM CLIP	/W FORD CLIP
34796-0201	2	A	BLACK	34797-0201	34797-0205
34796-0202	2	B	NATURE	34797-0202	34797-0206
34796-0203	2	C	GRAY	34797-0203	34797-0207
34796-0204	2	D	DARK GRAY	34797-0204	34797-0208
34796-0301	3	A	BLACK	34797-0301	34797-0305
34796-0302	3	B	NATURE	34797-0302	34797-0306
34796-0303	3	C	GRAY	34797-0303	34797-0307
34796-0304	3	D	DARK GRAY	34797-0304	34797-0308
34796-0401	4	A	BLACK	34797-0401	34797-0405
34796-0402	4	B	NATURE	34797-0402	34797-0406
34796-0403	4	C	GRAY	34797-0403	34797-0407
34796-0404	4	D	DARK GRAY	34797-0404	34797-0408

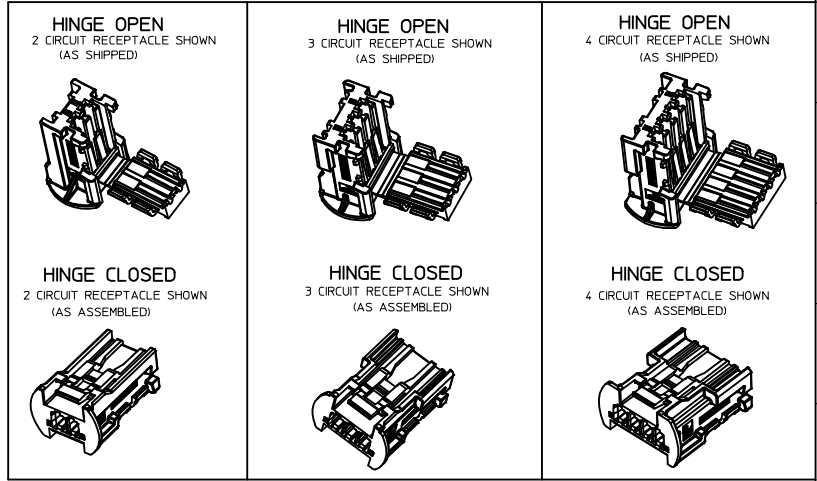

LAST BALLOON ON DRAWING:  
  
 DELETED BALLOONS:

INITIAL RELEASE EC NO. GCA2016-0100 DRAWN: JBZHANG03 CHXK: APPR: CROU 2016/01/20	QUALITY SYMBOLS	GENERAL TOLERANCES (UNLESS SPECIFIED)	DIMENSION STYLE	SCALE	DESIGN UNITS	THIRD ANGLE PROJECTION	
	∇=0 ∇=0 ∇=0	mm INCH 4 PLACES ± --- ± --- 3 PLACES ± --- ± --- 2 PLACES ± 0.13 ± --- 1 PLACE ± 0.25 ± --- ANGULAR ± 3°	MM ONLY DRAWN BY DATE XBTANG 2010/12/31 CHECKED BY DATE JLOHMAN 2011/01/11 APPROVED BY DATE SMARCEAU 2011/06/27	2:1	METRIC		
	DRAFT WHERE APPLICABLE MUST REMAIN WITHIN DIMENSIONS		MATERIAL NO.	DOCUMENT NO.		SHEET NO.	
	SEE TABLE		SD-34796-001	MOLEX INCORPORATED		1 OF 2	

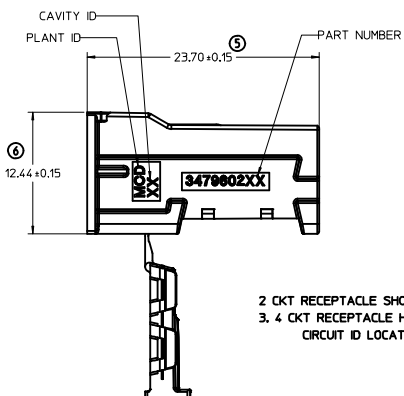
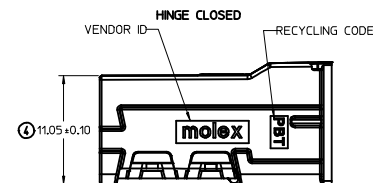
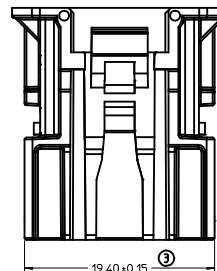
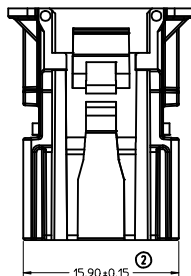
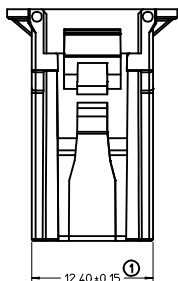

2 CKT RECEPTACLE SHOWN BELOW.  
3, 4 CKT RECEPTACLE HAS SIMILAR  
CIRCUIT ID LOCATION.

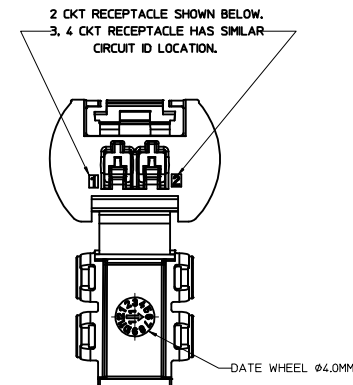
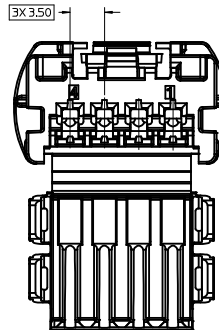
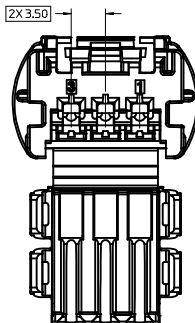
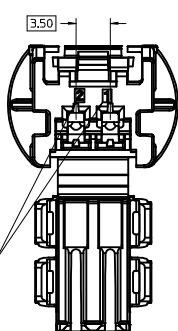

### PASS THRU DIAMETER INFORMATION

1 MM ADDITIONAL CLEARANCE ADDED TO TIGHTEST FIT CIRCLE

(HINGE CLOSED)

PASS THRU DIAMETER  
(Ø19.4)

PASS THRU DIAMETER  
(Ø20.9)

PASS THRU DIAMETER  
(Ø22.0)

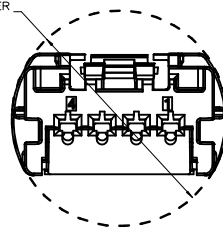
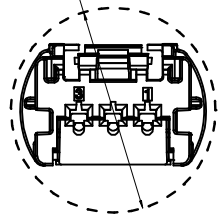
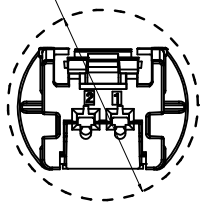

INITIAL RELEASE IEC NO: GCA2016-0100 DRAWN: JBZHANG03 CHKD: APPR: CB01U 2016/01/20	QUALITY SYMBOLS ∇=0 ∇=0 ∇=0	GENERAL TOLERANCES (UNLESS SPECIFIED)		DIMENSION STYLE MM ONLY	SCALE 4:1	DESIGN UNITS METRIC	THIRD ANGLE PROJECTION		
		4 PLACES ± --- ± ---	3 PLACES ± --- ± ---	2 PLACES ± 0.13 ± ---	1 PLACE ± 0.25 ± ---	DRAWN BY XBTANG	DATE 2010/12/31	CHECKED BY JLOHMAN	DATE 2011/01/11
		ANGULAR ± 3°		DRAFT WHERE APPLICABLE MUST REMAIN WITHIN DIMENSIONS		MATERIAL NO. SEE TABLE	DOCUMENT NO. SD-34796-001	MOLEX INCORPORATED	SHEET NO. 2 OF 2
		DRAFT WHERE APPLICABLE MUST REMAIN WITHIN DIMENSIONS		DRAFT WHERE APPLICABLE MUST REMAIN WITHIN DIMENSIONS		THIS DRAWING CONTAINS INFORMATION THAT IS PROPRIETARY TO MOLEX INCORPORATED AND SHOULD NOT BE USED WITHOUT WRITTEN PERMISSION			