



Chipsmall Limited consists of a professional team with an average of over 10 year of expertise in the distribution of electronic components. Based in Hongkong, we have already established firm and mutual-benefit business relationships with customers from,Europe,America and south Asia,supplying obsolete and hard-to-find components to meet their specific needs.

With the principle of “Quality Parts,Customers Priority,Honest Operation,and Considerate Service”,our business mainly focus on the distribution of electronic components. Line cards we deal with include Microchip,ALPS,ROHM,Xilinx,Pulse,ON,Everlight and Freescale. Main products comprise IC,Modules,Potentiometer,IC Socket,Relay,Connector.Our parts cover such applications as commercial,industrial, and automotives areas.

We are looking forward to setting up business relationship with you and hope to provide you with the best service and solution. Let us make a better world for our industry!



Contact us

Tel: +86-755-8981 8866 Fax: +86-755-8427 6832

Email & Skype: info@chipsmall.com Web: www.chipsmall.com

Address: A1208, Overseas Decoration Building, #122 Zhenhua RD., Futian, Shenzhen, China



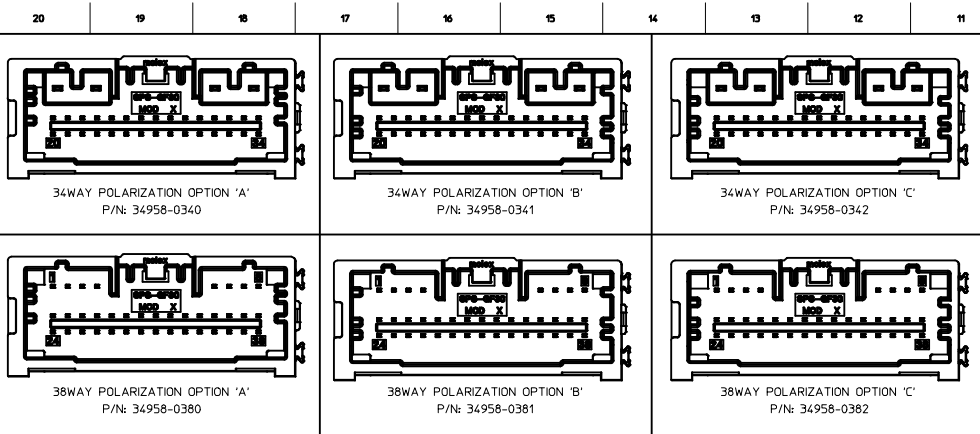

MATERIAL NUMBER			CKT SIZE	DESCRIPTION	POL	COLOR
TRAY PACKAGING PK-31302-070	T&R PACKAGING PK-47799-0001	TUBE PACKAGING PK-31301-688				
34958-0340	34958-8340	34958-7340	34	34WAY MIN50 VERTICAL HEADER ASSEMBLY	A	BLACK
34958-0341	34958-8341	34958-7341	34	34WAY MIN50 VERTICAL HEADER ASSEMBLY	B	GREY
34958-0342	34958-8342	34958-7342	34	34WAY MIN50 VERTICAL HEADER ASSEMBLY	C	DK GREY
34958-0380	34958-8380	34958-7380	38	38WAY MIN50 VERTICAL HEADER ASSEMBLY	A	BLACK
34958-0381	34958-8381	34958-7381	38	38WAY MIN50 VERTICAL HEADER ASSEMBLY	B	GREY
34958-0382	34958-8382	34958-7382	38	38WAY MIN50 VERTICAL HEADER ASSEMBLY	C	DK GREY

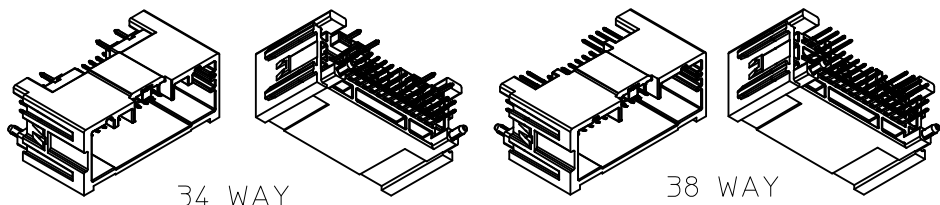

ISOMETRIC VIEWS
SCALE 2:1

NOTES: VALID UNLESS OTHERWISE SPECIFIED
1. GENERAL:

a. CONNECTOR HEADER MUST BE VALIDATED TO THE FOLLOWING FUNCTIONAL REQUIREMENTS:

VALIDATION SPECIFICATION - GMW3191 JUNE 2012

SOLDERABILITY - SMES-152

b. APPLICATION REQUIREMENTS (REFERENCE ONLY) FOR:

SEE APPLICATION SPECIFICATION - AS-34959-001

SEE PRODUCT SPECIFICATION - PS-34959-001

MATES WITH: SD-34959-030

c. PACKAGING SPECIFICATION: SEE TABLE

2. DESIGN MATERIALS:

a. SHROUD (PLASTIC HOUSING):
RESIN - SPS 30%GF

b. 0.50mm BLADES:
BASE MATERIAL: C26800
PLATING TYPE: AS NOTED

c. 12mm BLADES:
BASE MATERIAL: C26800
PLATING TYPE: AS NOTED

3. PLATING REQUIREMENTS:

a. UNDERPLATING - OVERALL NICKEL

b. OVERPLATING - OVERALL TIN

INSPECTION BALLOON NUMBER LOG	
PER DRAWING REVISION:	A5
LAST BALLOON NUMBER USED:	20
ADDED BALLOON NUMBERS:	
REMOVED BALLOON NUMBERS:	9, 10

ENTER DESCRIPTION IEC NO: UAU2017-0815 DRAWN: JFISCHER01 2017/03/14 CHKD: CHYK APPR: RBAUMAN 2017/03/21 REV:	QUALITY SYMBOLS ▽=0 ▽=0 ▽=0	GENERAL TOLERANCES (UNLESS SPECIFIED) <table border="1"> <tr> <th></th> <th>mm</th> <th>INCH</th> </tr> <tr> <td>4 PLACES</td> <td>±0.15</td> <td>±0.005</td> </tr> <tr> <td>3 PLACES</td> <td>±0.25</td> <td>±0.010</td> </tr> <tr> <td>2 PLACES</td> <td>±0.38</td> <td>±0.015</td> </tr> <tr> <td>1 PLACE</td> <td>±0.51</td> <td>±0.020</td> </tr> <tr> <td>0 PLACE</td> <td>±0.64</td> <td>±0.025</td> </tr> </table>		mm	INCH	4 PLACES	±0.15	±0.005	3 PLACES	±0.25	±0.010	2 PLACES	±0.38	±0.015	1 PLACE	±0.51	±0.020	0 PLACE	±0.64	±0.025	DIMENSION STYLE MM ONLY DRAWN BY: JFISCHER01 DATE: 2013/12/05 CHECKED BY: DATE: APPROVED BY: RBAUMAN DATE: 2014/02/19	SCALE: 3:1 DESIGN UNITS: METRIC THIRD ANGLE PROJECTION	TITLE: 34 & 38 CKT MIN50 VERTICAL HEADER ASSMBLY SALES DRAWING molex	MATERIAL NO: SEE CHART DOCUMENT NO: SD-34958-300	SHEET NO: 1 OF 2
		mm	INCH																						
	4 PLACES	±0.15	±0.005																						
	3 PLACES	±0.25	±0.010																						
2 PLACES	±0.38	±0.015																							
1 PLACE	±0.51	±0.020																							
0 PLACE	±0.64	±0.025																							
DRAFT WHERE APPLICABLE MUST REMAIN WITHIN DIMENSIONS		SIZE: D THIS DRAWING CONTAINS INFORMATION THAT IS PROPRIETARY TO MOLEX INCORPORATED AND SHOULD NOT BE USED WITHOUT WRITTEN PERMISSION																							

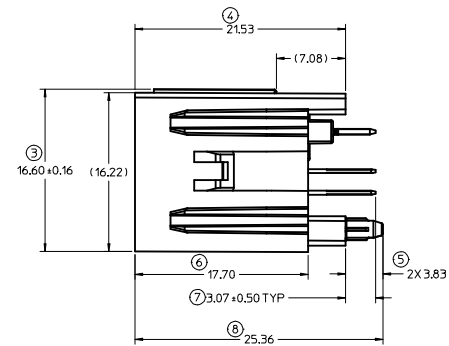
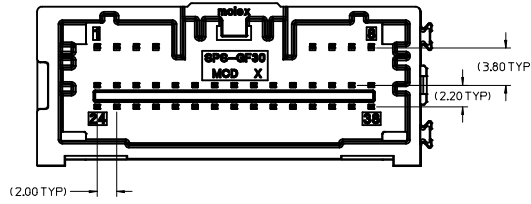
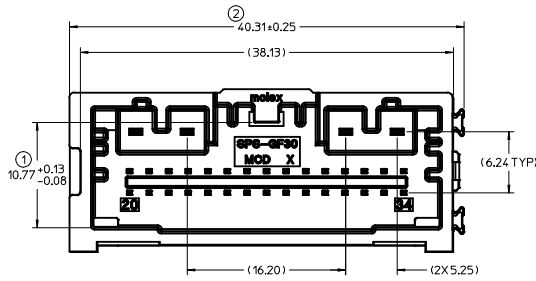

REFERENCE PCB LAYOUT

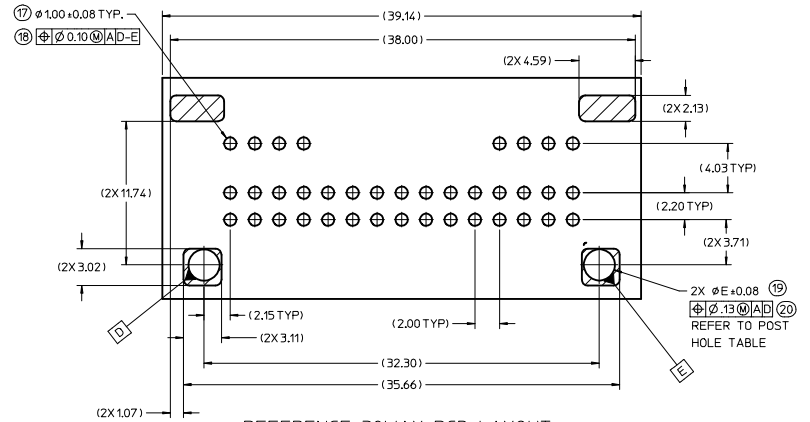
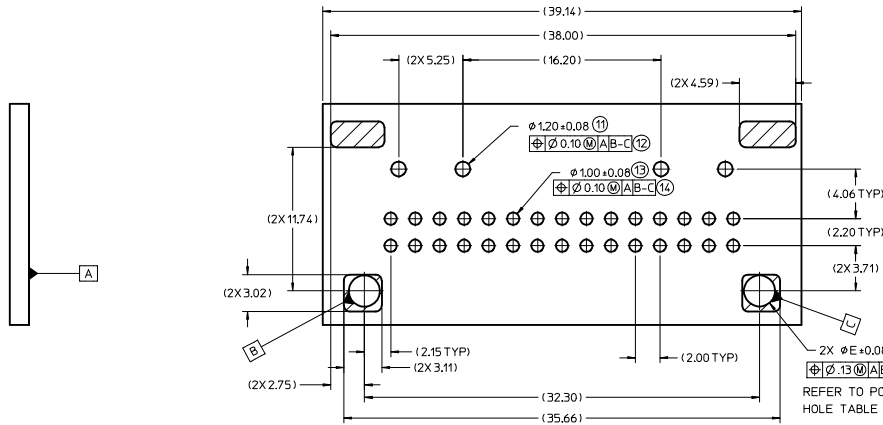

REFERENCE 34WAY PCB LAYOUT

REFERENCE 38WAY PCB LAYOUT

POST HOLE TABLE:

FOR DIM E:	
PRESS FIT:	2.15
DROP IN:	2.55

DN 16901	CODE LETTER	NOMINAL DIMENSION RANGE															
		OVER	0	1	3	6	10	15	22	30	40	53	70	90	120		
PRECISION	A	+0.10	+0.12	+0.14	+0.16	+0.20	+0.22	+0.24	+0.26	+0.28	+0.31	+0.35	+0.40	+0.50			
ENGINEERING	B	+0.05	+0.06	+0.07	+0.08	+0.10	+0.12	+0.14	+0.16	+0.18	+0.21	+0.25	+0.30	+0.40			

A: FOR NON-MOLD RELATED DIMENSIONS (ACROSS PARTING LINE)
B: FOR MOLD RELATED DIMENSIONS (WITHIN MOLD COMPONENTS)

ENTER DESCRIPTION EC NO: UAU2017-0815 DRAWN: JFISCHER01 2017/03/14 CHKD: APPR: RBAUMAN	QUALITY SYMBOLS ▽=0 ▽=0 ▽=0	GENERAL TOLERANCES (UNLESS SPECIFIED)		DIMENSION STYLE MM ONLY		SCALE 4:1	DESIGN UNITS METRIC	THIRD ANGLE PROJECTION
		4 PLACES ± --- ± ---	3 PLACES ± --- ± ---	2 PLACES ± --- ± ---	1 PLACE ± --- ± ---	0 PLACE ± --- ± ---	DRAWN BY JFISCHER01	DATE 2013/12/05
		DRAFT WHERE APPLICABLE MUST REMAIN WITHIN DIMENSIONS		APPROVED BY RBAUMAN		DATE 2014/02/19	MATERIAL NO. SEE CHART	DOCUMENT NO. SD-34958-300
				ANGULAR ± 1°				SHEET NO. 2 OF 2

THIS DRAWING CONTAINS INFORMATION THAT IS PROPRIETARY TO MOLEX INCORPORATED AND SHOULD NOT BE USED WITHOUT WRITTEN PERMISSION