

Chipsmall Limited consists of a professional team with an average of over 10 year of expertise in the distribution of electronic components. Based in Hongkong, we have already established firm and mutual-benefit business relationships with customers from,Europe,America and south Asia,supplying obsolete and hard-to-find components to meet their specific needs.

With the principle of “Quality Parts,Customers Priority,Honest Operation,and Considerate Service”,our business mainly focus on the distribution of electronic components. Line cards we deal with include Microchip,ALPS,ROHM,Xilinx,Pulse,ON,Everlight and Freescale. Main products comprise IC,Modules,Potentiometer,IC Socket,Relay,Connector.Our parts cover such applications as commercial,industrial, and automotives areas.

We are looking forward to setting up business relationship with you and hope to provide you with the best service and solution. Let us make a better world for our industry!



Contact us

Tel: +86-755-8981 8866 Fax: +86-755-8427 6832

Email & Skype: info@chipsmall.com Web: www.chipsmall.com

Address: A1208, Overseas Decoration Building, #122 Zhenhua RD., Futian, Shenzhen, China

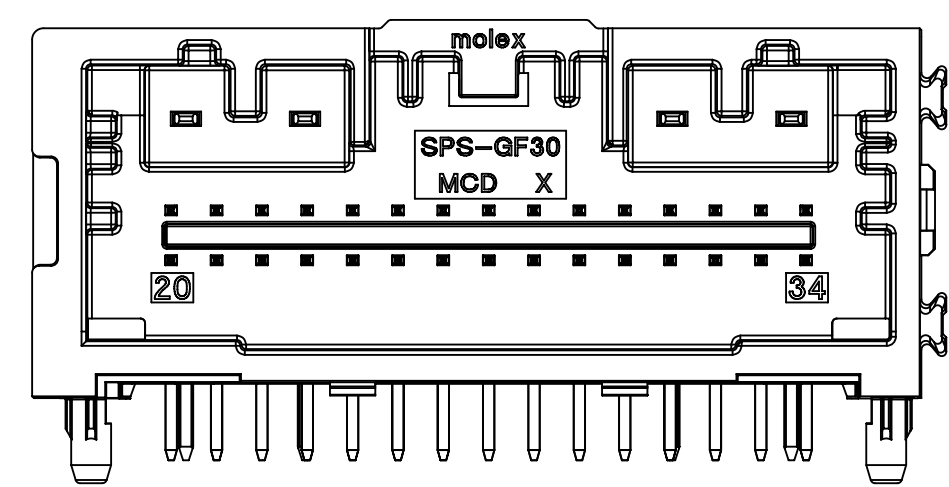

34WAY POLARIZATION OPTION 'A'
P/N: 34961-0340

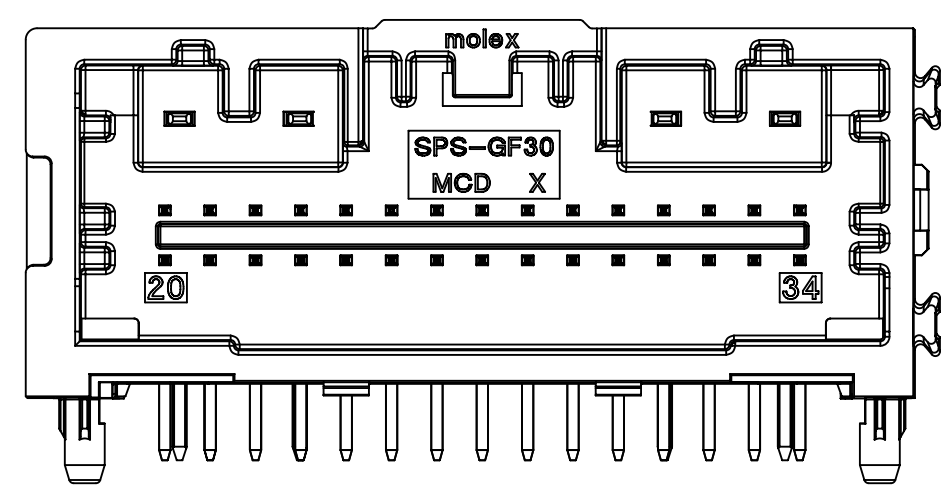

34WAY POLARIZATION OPTION 'B'
P/N: 34961-0341

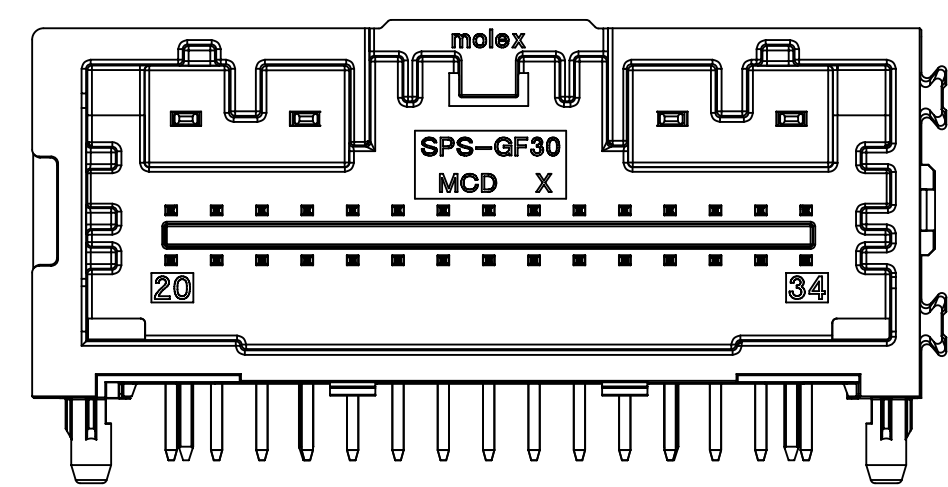

34WAY POLARIZATION OPTION 'C'
P/N: 34961-0342

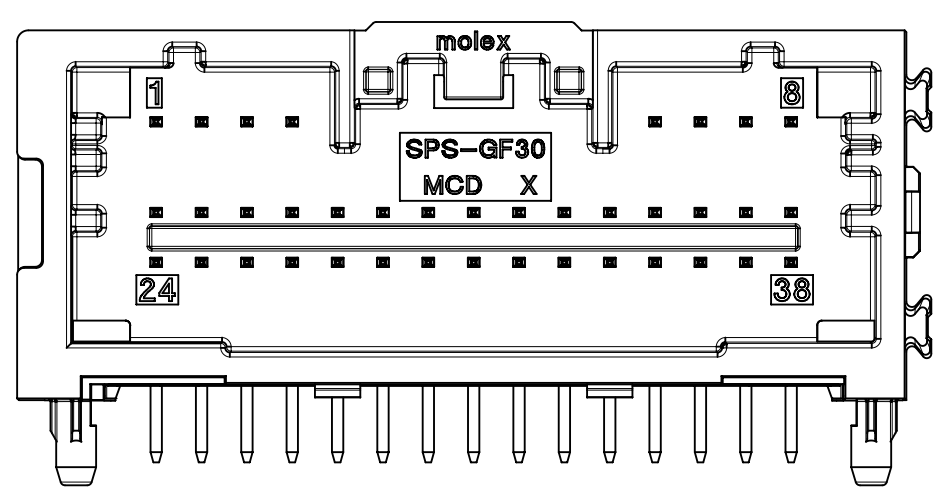

38WAY POLARIZATION OPTION UPDATED 'A'
P/N: 34961-0383

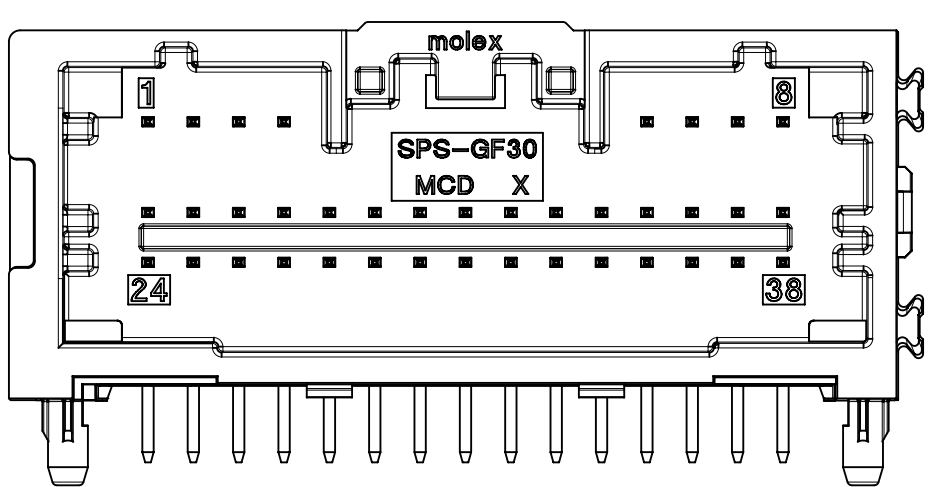

38WAY POLARIZATION OPTION UPDATED 'B'
P/N: 34961-0384

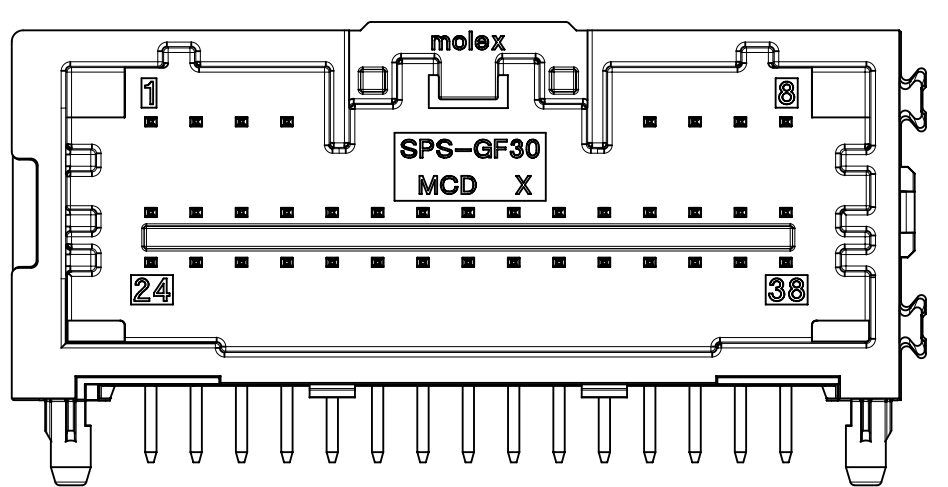

38WAY POLARIZATION OPTION UPDATED 'C'
P/N: 34961-0385

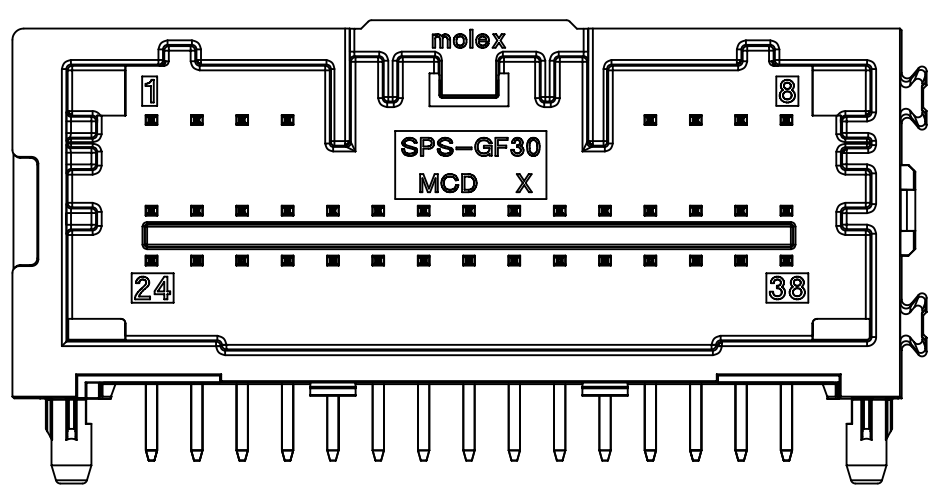

38WAY POLARIZATION OPTION 'A'
P/N: 34961-0380

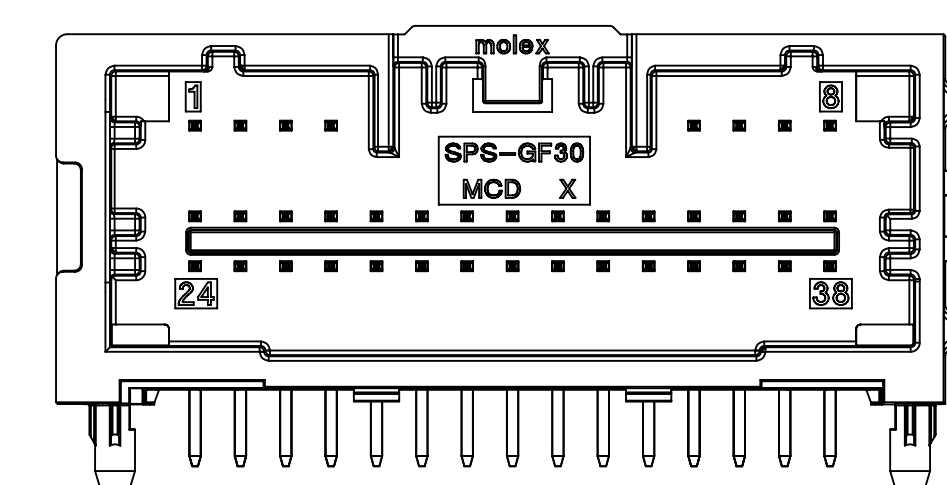

38WAY POLARIZATION OPTION 'B'
P/N: 34961-0381

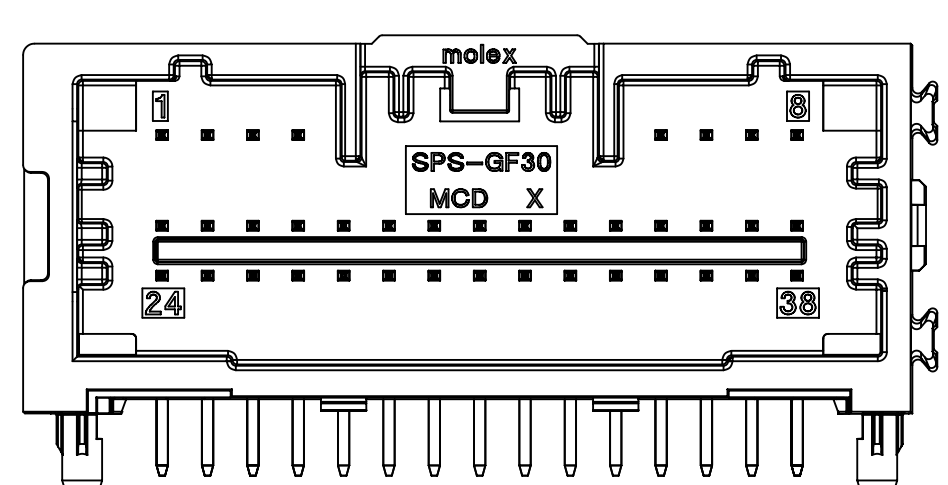

38WAY POLARIZATION OPTION 'C'
P/N: 34961-0382

NOTES: VALID UNLESS OTHERWISE SPECIFIED

1. GENERAL:

a. CONNECTOR HEADER MUST BE VALIDATED TO THE FOLLOWING FUNCTIONAL REQUIREMENTS:

VALIDATION SPECIFICATION = GMW3191 JUNE 2012

SOLDERABILITY = SMES-152

b. APPLICATION REQUIREMENTS (REFERENCE ONLY) FOR:

SEE APPLICATION SPECIFICATION = AS-34959-001

SEE PRODUCT SPECIFICATION = PS-34959-001

MATES WITH: SD-34959-030

c. PACKAGING SPECIFICATION PER MOLEX DRAWING PK-XXXXX-XXX

2. DESIGN: MATERIALS:

a. SHROUD (PLASTIC HOUSING):
RESIN - SPS 30%GF

b. PIN ALIGNMENT PLATE:
RESIN - SPS 30%GF

c. 0.50MM BLADES:
BASE MATERIAL: C26800
PLATING TYPE: AS NOTED

d. 1.20MM BLADES:
BASE MATERIAL: C26800
PLATING TYPE: AS NOTED

3. PLATING REQUIREMENTS:

a. UNDERPLATING - OVERALL NICKEL

b. OVERPLATING - OVERALL TIN

MATERIAL NUMBER			CKT SIZE	DESCRIPTION	POL	COLOR	STATUS
TRAY PACKAGING PK-31302-070	TUBE PACKAGING PK-31301-688	TAPE AND REEL PK-47799-0001					
34961-0340	34961-7340	34961-8340	34	34CKT MINI50 RIGHT ANGLE HEADER ASSEMBLY	A	BLACK	SALEABLE
34961-0341	34961-7341	34961-8341	34	34CKT MINI50 RIGHT ANGLE HEADER ASSEMBLY	B	GREY	SALEABLE
34961-0342	34961-7342	34961-8342	34	34CKT MINI50 RIGHT ANGLE HEADER ASSEMBLY	C	DK GREY	SALEABLE
34961-0380	34961-7380	34961-8380	38	38CKT MINI50 RIGHT ANGLE HEADER ASSEMBLY	A	BLACK	SALEABLE
34961-0381	34961-7381	34961-8381	38	38CKT MINI50 RIGHT ANGLE HEADER ASSEMBLY	B	GREY	SALEABLE
34961-0382	34961-7382	34961-8382	38	38CKT MINI50 RIGHT ANGLE HEADER ASSEMBLY	C	DK GREY	SALEABLE
34961-0383	34961-7383	34961-8383	38	38CKT MINI50 RIGHT ANGLE HEADER ASSEMBLY	UPDATED A	BLACK	OK To Tool
34961-0384	34961-7384	34961-8384	38	38CKT MINI50 RIGHT ANGLE HEADER ASSEMBLY	UPDATED B	GREY	OK To Tool
34961-0385	34961-7385	34961-8385	38	38CKT MINI50 RIGHT ANGLE HEADER ASSEMBLY	UPDATED C	DK GREY	OK To Tool

H	ADDED THE FOLLOW ITEMS TO CUSTOMER DRAWING: 1.ADDED DATUM F,DATUM G AND DATUM H,SEE SHEET 2 AND SHEET 3. 2.ADDED NEW UPWARD VIEW FOR 38WAY HEADER ASSEM. SEE SHEET 2. 3.ADDED NEW VIEW SECTION X-X,SECTION Y-Y,SECTION Z-Z AND SECTION W-W, SEE SHEET 3.	10904363
G	ADDED NEW VIEW OF UPDATED POL A & B C, SEE SHEET 1. ADDED NEW P/N: 34961-0383 \ 34961-0384 \ 34961-0385 \ 34961-7383 \ 34961-7384 \ 34961-7385 \ 34961-8383 \ 34961-8384 \ 34961-8385 IN THE BOM ON SHEET 1. ADDED PRODUCT STATUS IN BOM.	10885609
REV	REV DESCRIPTION	ECN SAP NO.

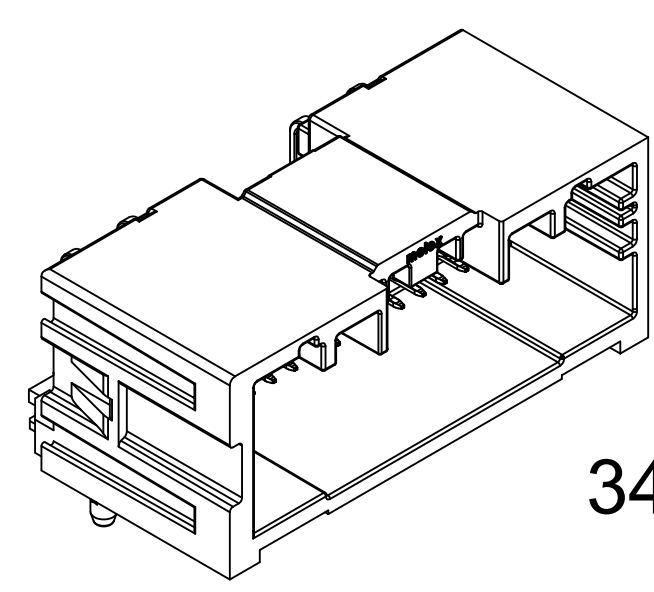

34 WAY

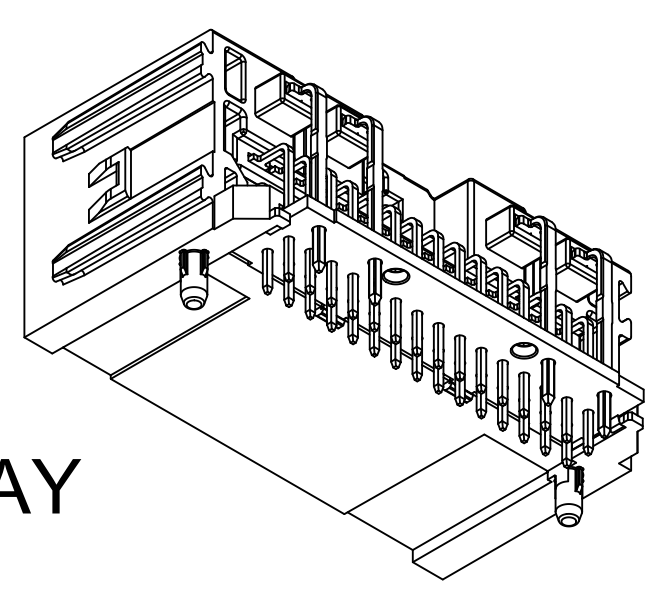

38 WAY

ISOMETRIC VIEW
SCALE 2:1

SYMBOLS	THIS DRAWING CONTAINS INFORMATION THAT IS PROPRIETARY TO MOLEX ELECTRONIC TECHNOLOGIES, LLC AND SHOULD NOT BE USED WITHOUT WRITTEN PERMISSION		CURRENT REV DESC:		
	DIMENSION UNITS	SCALE			
▽ = 0	mm	1:1			PRODUCT CUSTOMER DRAWING
▽ = 0	GENERAL TOLERANCES (UNLESS SPECIFIED)				DOCUMENT NUMBER
▽ = 0	ANGULAR TOL ± 1.0°				DOC TYPE
▽ = 0	4 PLACES	±	EC NO: 178280		DOC PART
▽ = 0	3 PLACES	±	DRWN: YPENG47 2018/06/22		REVISION
▽ = 0	2 PLACES	±	CHK'D: CDZHANG 2018/06/22		
▽ = 0	1 PLACE	±	APPR: JDENG02 2018/06/22		
▽ = 0	0 PLACES	±	INITIAL REVISION:		
⊠ = 0	DRAFT WHERE APPLICABLE MUST REMAIN WITHIN DIMENSIONS		DRWN: JFISCHER01 2012/11/21		
⊠ = 0	THIRD ANGLE PROJECTION		APPR: KDEKOSKI 2012/12/21		
⊠ = 0	DRAWING		SERIES		
	D-SIZE		34961		
	MATERIAL NUMBER		CUSTOMER		
	GENERAL MARKET		SHEET NUMBER		
			1 OF 4		

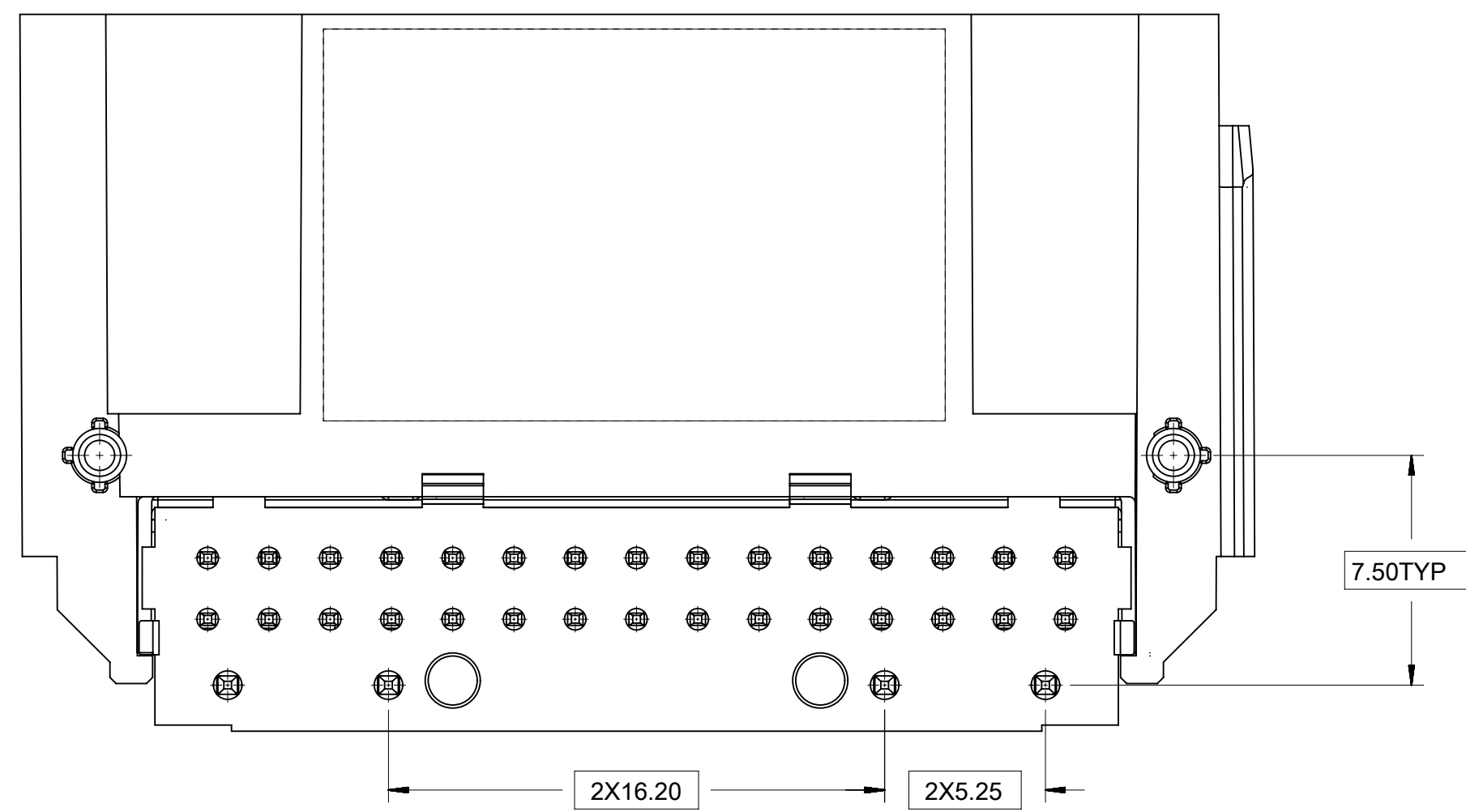
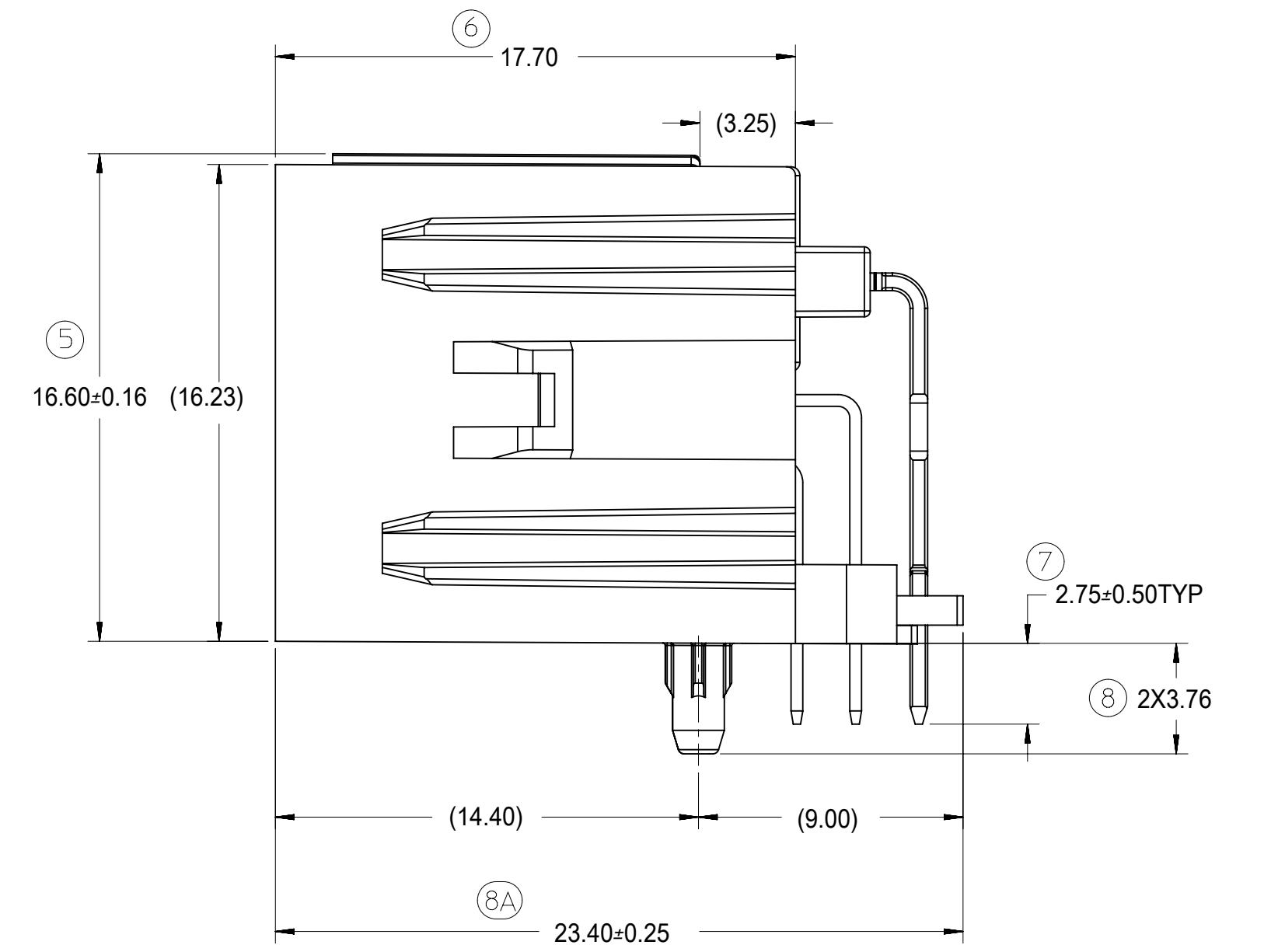
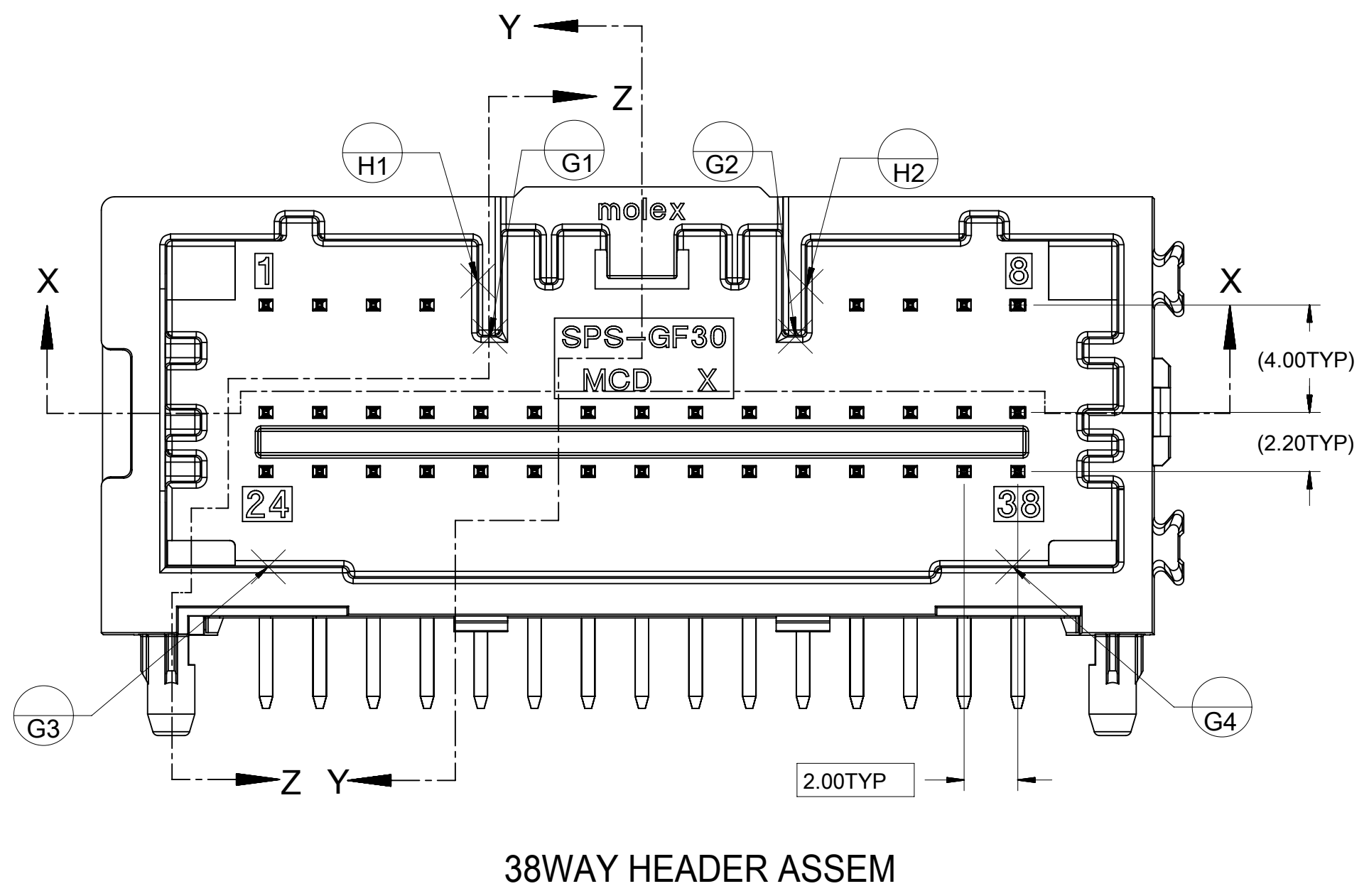
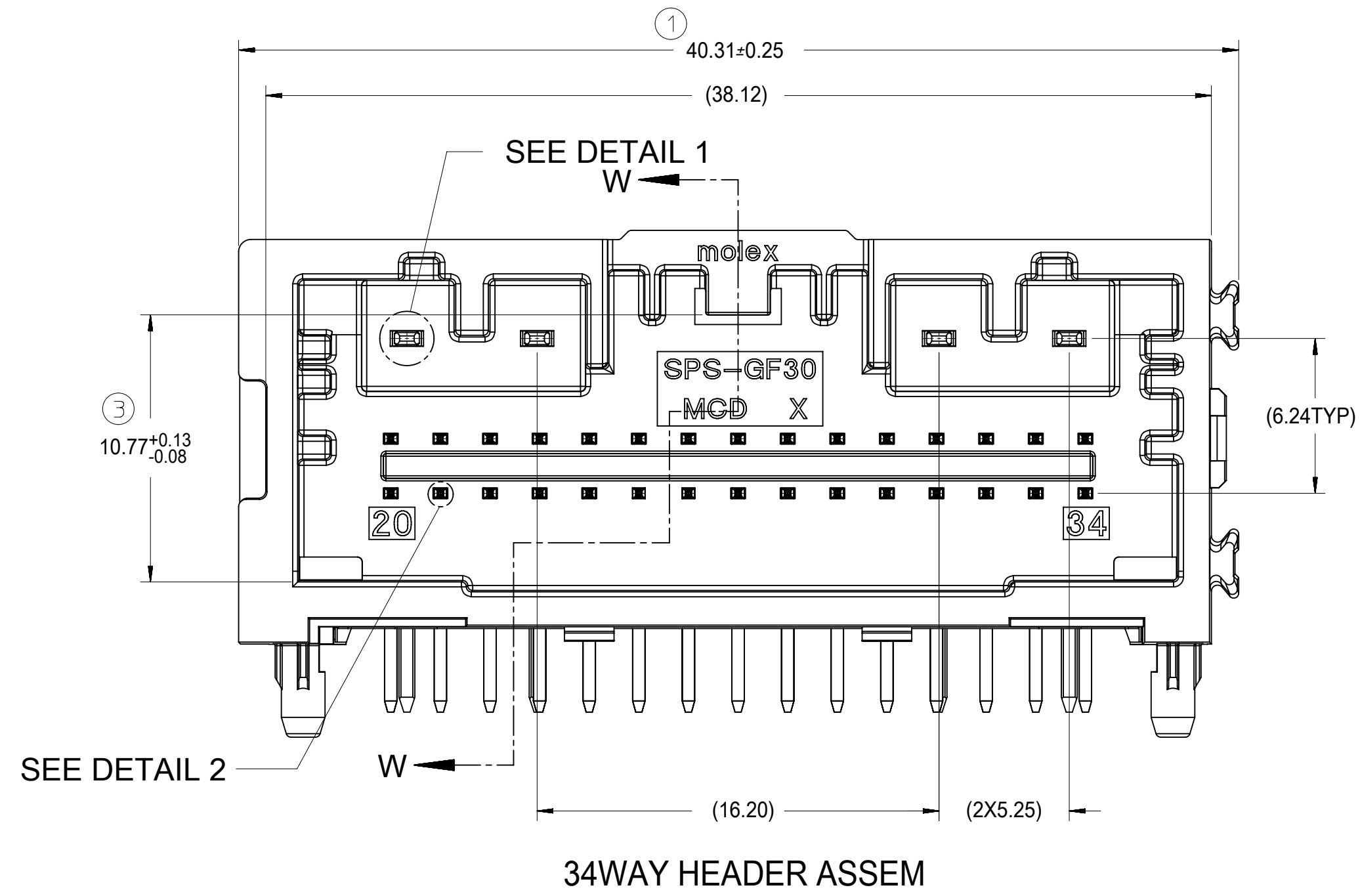

DIN 16901	CODE LETTER	NOMINAL DIMENSION RANGE													
		OVER UP TO	0	1	3	6	10	15	22	30	40	53	70	90	120
PRECISION	A		0.10	0.12	0.14	0.16	0.20	0.22	0.24	0.26	0.28	0.31	0.35	0.40	0.50
ENGINEERING	B		0.05	0.06	0.07	0.08	0.10	0.12	0.14	0.16	0.18	0.21	0.25	0.30	0.40

A: FOR NON-MOLD RELATED DIMENSIONS (ACROSS PARTING LINE)
 B: FOR MOLD RELATED DIMENSIONS (WITHIN MOLD COMPONENTS)

SYMBOLS	THIS DRAWING CONTAINS INFORMATION THAT IS PROPRIETARY TO MOLEX ELECTRONIC TECHNOLOGIES, LLC AND SHOULD NOT BE USED WITHOUT WRITTEN PERMISSION		CURRENT REV DESC:	
	▽ = 0	DIMENSION UNITS	SCALE	
▽ = 0	mm	10:1		
▽ = 0	GENERAL TOLERANCES (UNLESS SPECIFIED)			
▽ = 0	ANGULAR TOL ± 1.0°			
▽ = 0	4 PLACES ±	EC NO: 178280		
▽ = 0	3 PLACES ±	DRWN: YPENG47 2018/06/22		
▽ = 0	2 PLACES ±	CHK'D: CDZHANG 2018/06/22		
▽ = 0	1 PLACE ±	APPR: JDENG02 2018/06/22		
▽ = 0	0 PLACES ±	INITIAL REVISION:		
▽ = 0	DRAFT WHERE APPLICABLE MUST REMAIN WITHIN DIMENSIONS		DRWN: JFISCHER01 2012/11/21	2012/12/21
▽ = 0	THIRD ANGLE PROJECTION	DRAWING	SERIES	MATERIAL NUMBER
		D-SIZE	34961	CUSTOMER
				GENERAL MARKET
				SHEET NUMBER
				2 OF 4

molex

34 & 38 CKT MINI50
 RIGHT ANGLE HEADER ASSEMBLY SALES DRAWING

PRODUCT CUSTOMER DRAWING

DOCUMENT NUMBER	DOC TYPE	DOC PART	REVISION
SD-34961-030	PSD	001	H

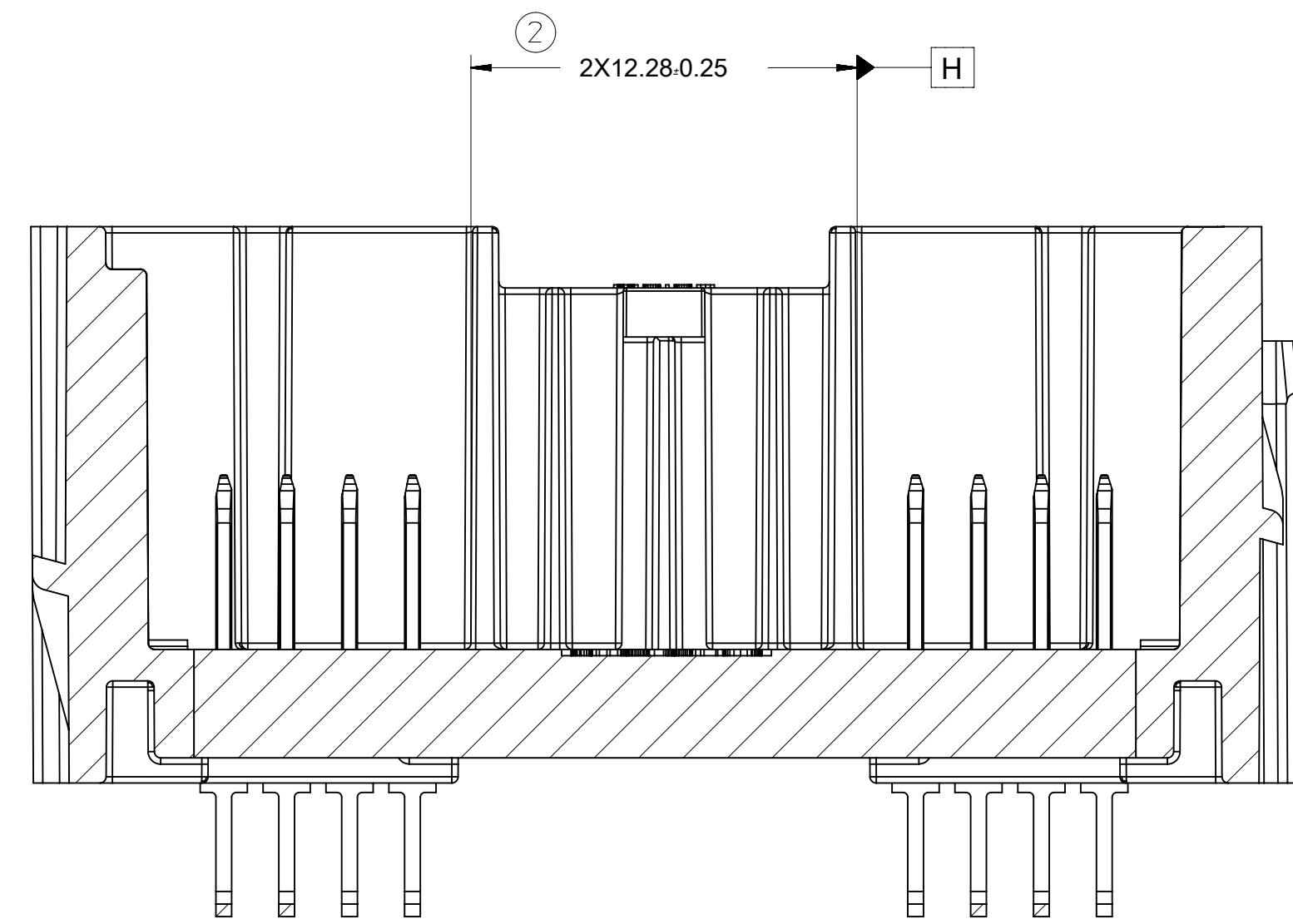

SECTION X-X

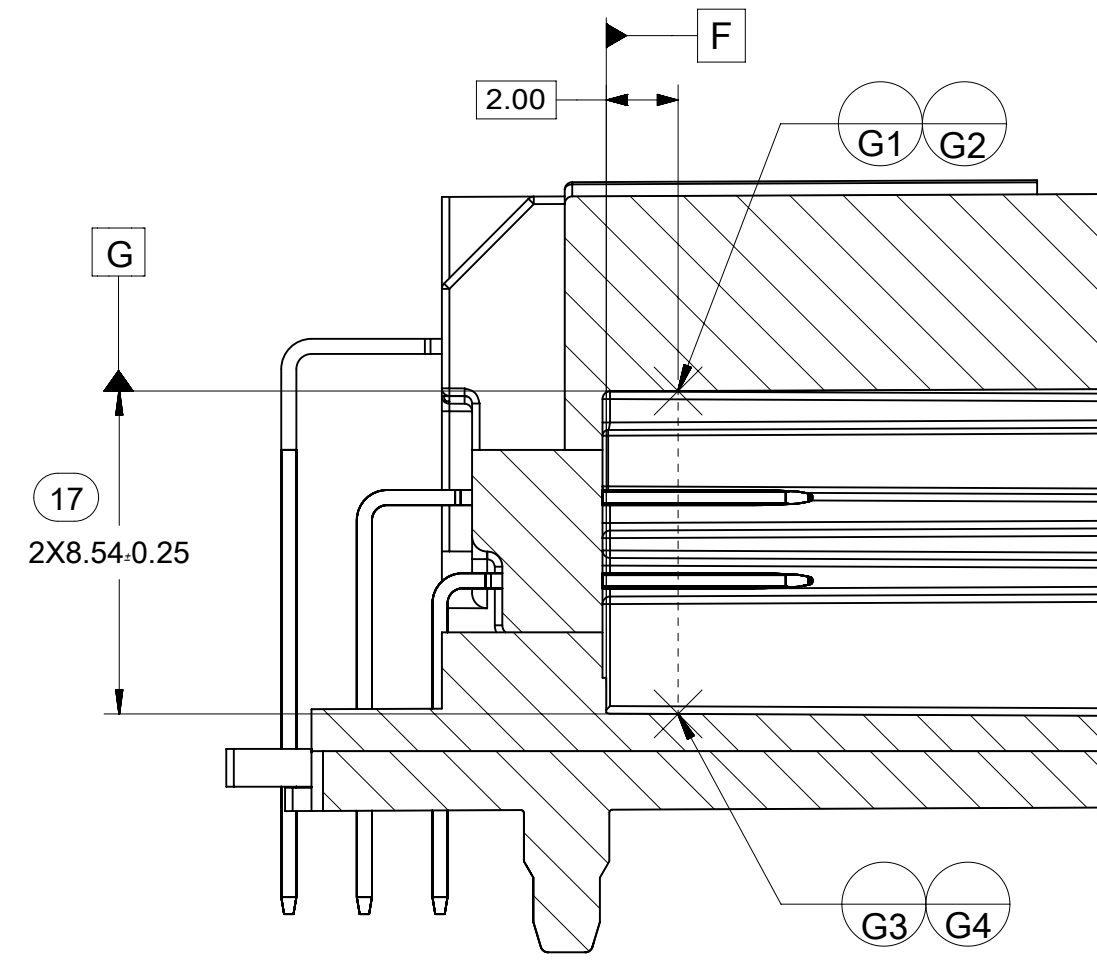

SECTION Z-Z

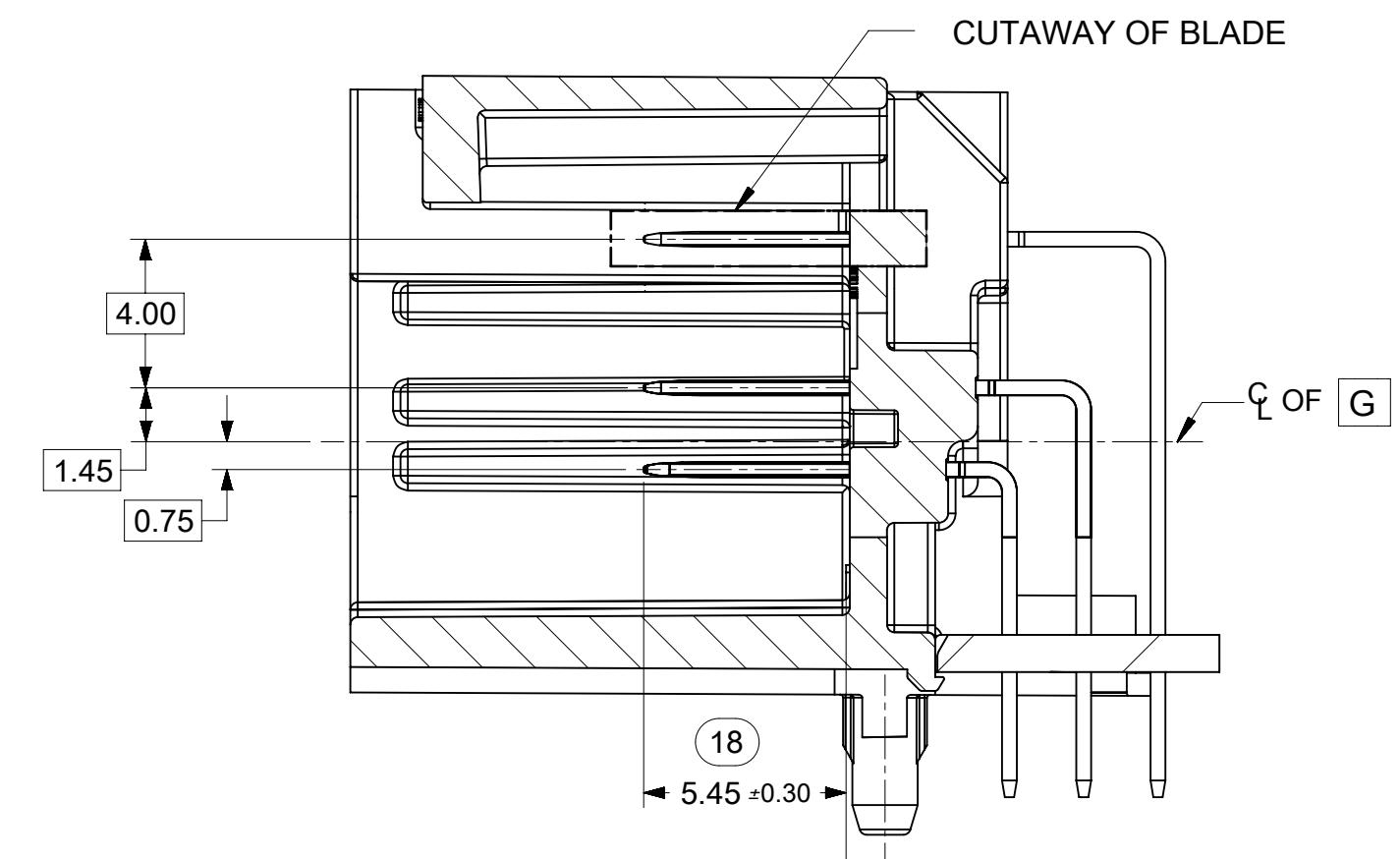

SECTION Y-Y

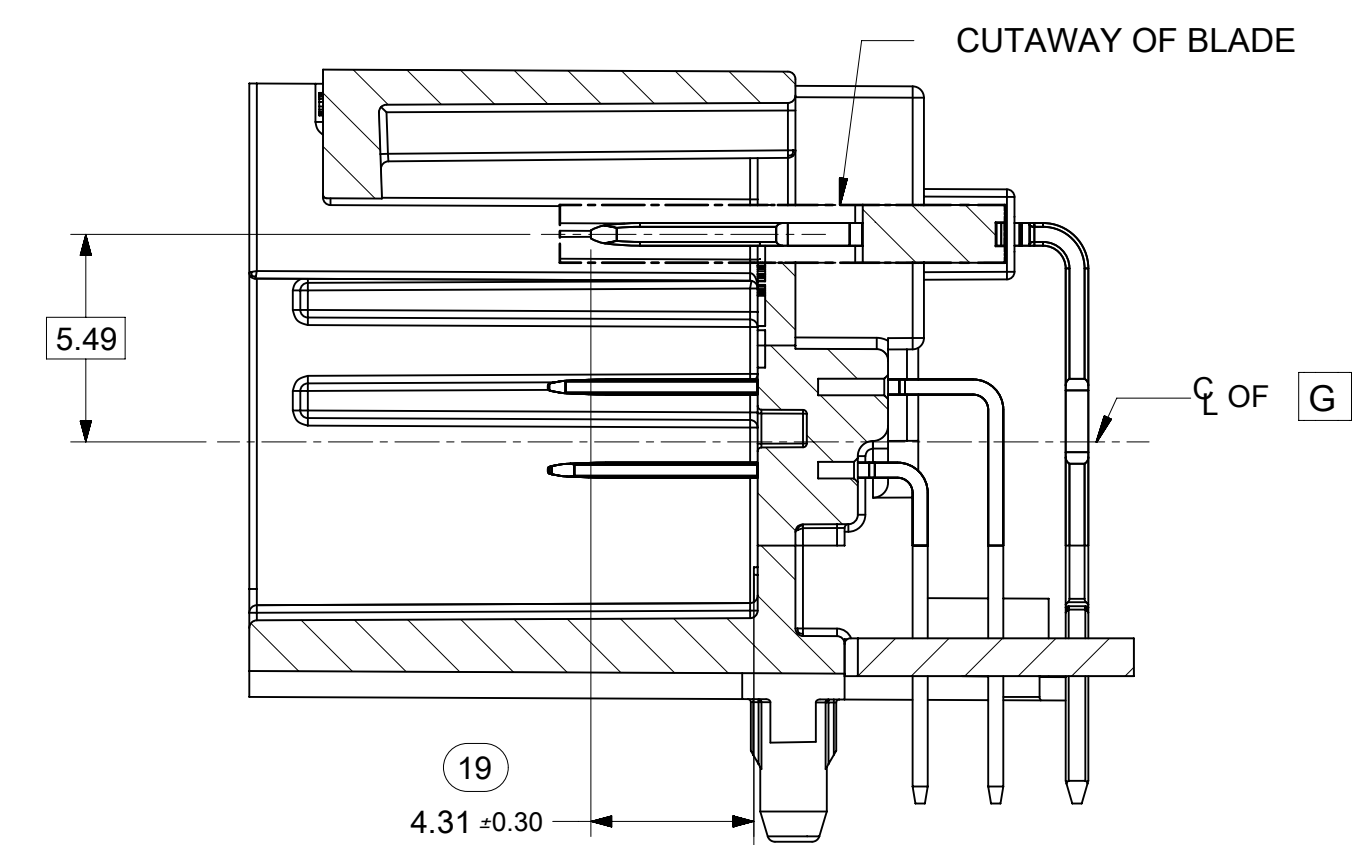

SECTION W-W

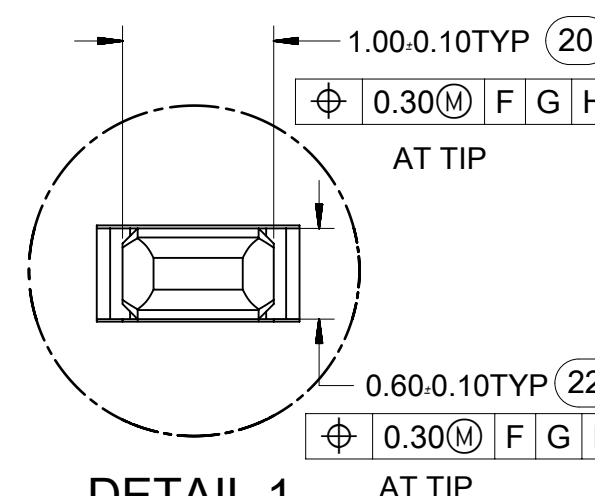

DETAIL 1
SCALE 20:1

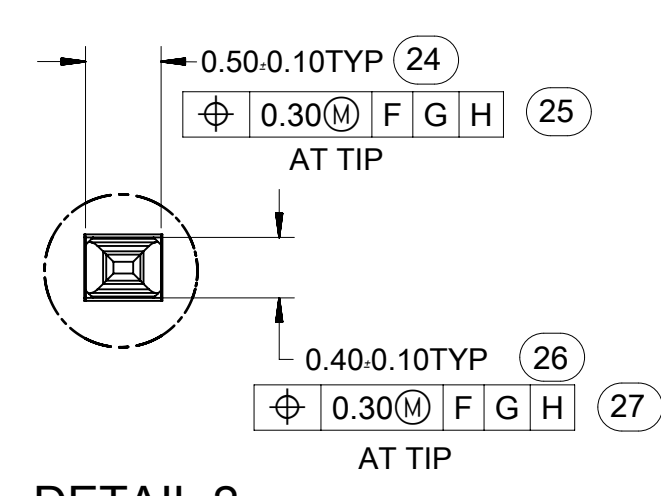

DETAIL 2
SCALE 20:1

DIN 16901	CODE LETTER	NOMINAL DIMENSION RANGE														
		OVER UP TO	0	1	3	6	10	15	22	30	40	53	70	90	120	160
PRECISION ENGINEERING	A		.10	.12	.14	.16	.20	.22	.24	.26	.28	.31	.35	.40	.50	
	B		.05	.06	.07	.08	.10	.12	.14	.16	.18	.21	.25	.30	.40	

A: FOR NON-MOLD RELATED DIMENSIONS (ACROSS PARTING LINE)
B: FOR MOLD RELATED DIMENSIONS (WITHIN MOLD COMPONENTS)

SYMBOLS	THIS DRAWING CONTAINS INFORMATION THAT IS PROPRIETARY TO MOLEX ELECTRONIC TECHNOLOGIES, LLC AND SHOULD NOT BE USED WITHOUT WRITTEN PERMISSION		CURRENT REV DESC:		molex	
▽ = 0	DIMENSION UNITS	SCALE	EC NO: 178280		34 & 38 CKT MINI50	
▽ = 0	mm	1:1	DRWN: YPENG47 2018/06/22		RIGHT ANGLE HEADER ASSEMBLY SALES DRAWING	
▽ = 0	GENERAL TOLERANCES (UNLESS SPECIFIED)		CHK'D: CDZHANG 2018/06/22		PRODUCT CUSTOMER DRAWING	
▽ = 0	ANGULAR TOL ± 1.0°		APPR: JDENG02 2018/06/22		DOCUMENT NUMBER	
▽ = 0	4 PLACES ±		INITIAL REVISION:		DOC TYPE	
▽ = 0	3 PLACES ±		DRWN: JFISCHER01 2012/11/21		DOC PART	
▽ = 0	2 PLACES ±		APPR: KDEKOSKI 2012/12/21		REVISION	
▽ = 0	1 PLACE ±		DRAFT WHERE APPLICABLE MUST REMAIN WITHIN DIMENSIONS		SD-34961-030	
▽ = 0	0 PLACES ±		THIRD ANGLE PROJECTION		PSD 001 H	
▽ = 0	DRAWING		SERIES		SHEET NUMBER	
▽ = 0	D-SIZE		34961		3 OF 4	
▽ = 0	MATERIAL NUMBER		CUSTOMER		GENERAL MARKET	

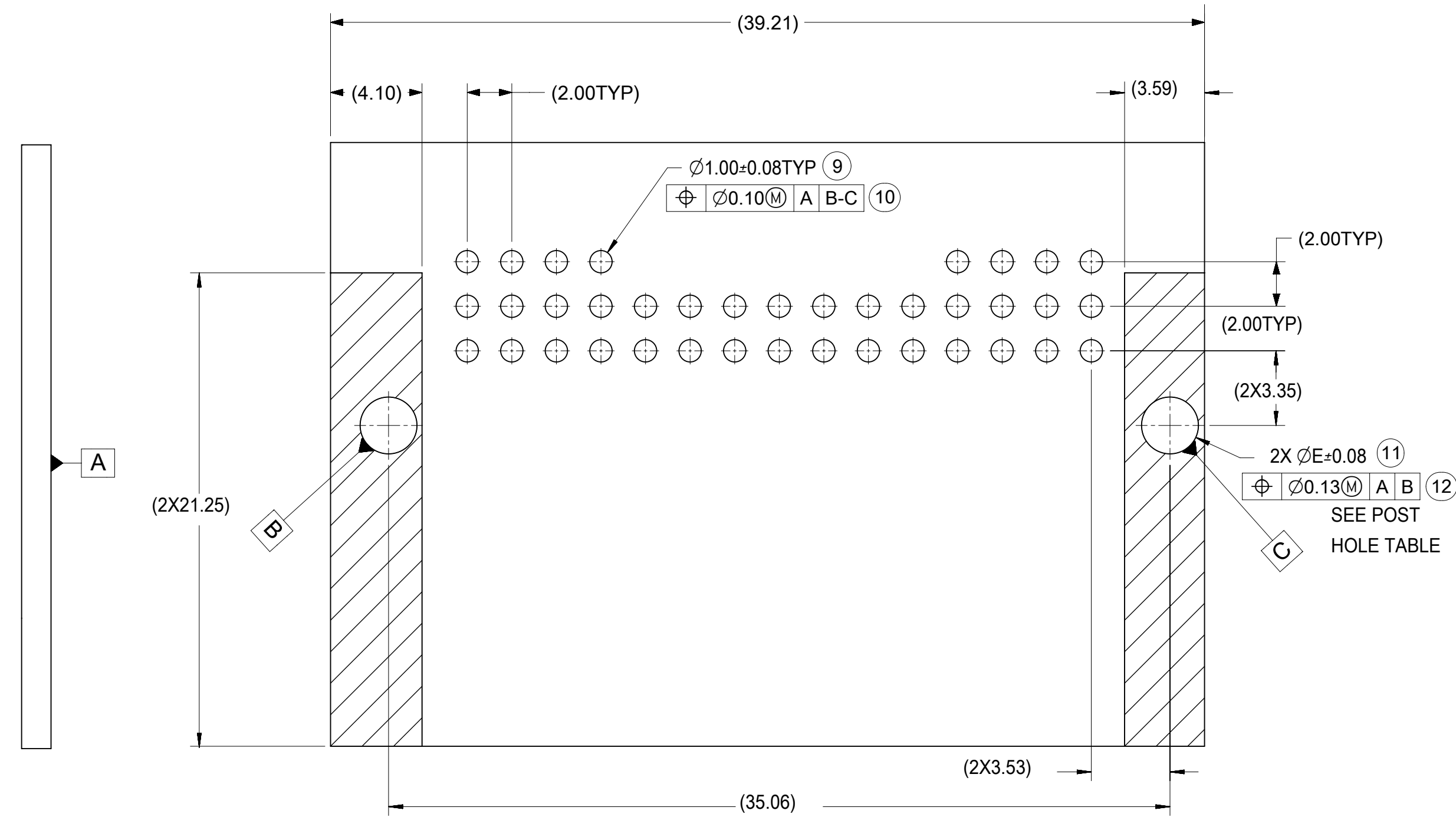

REFERENCE 38WAY PCB LAYOUT

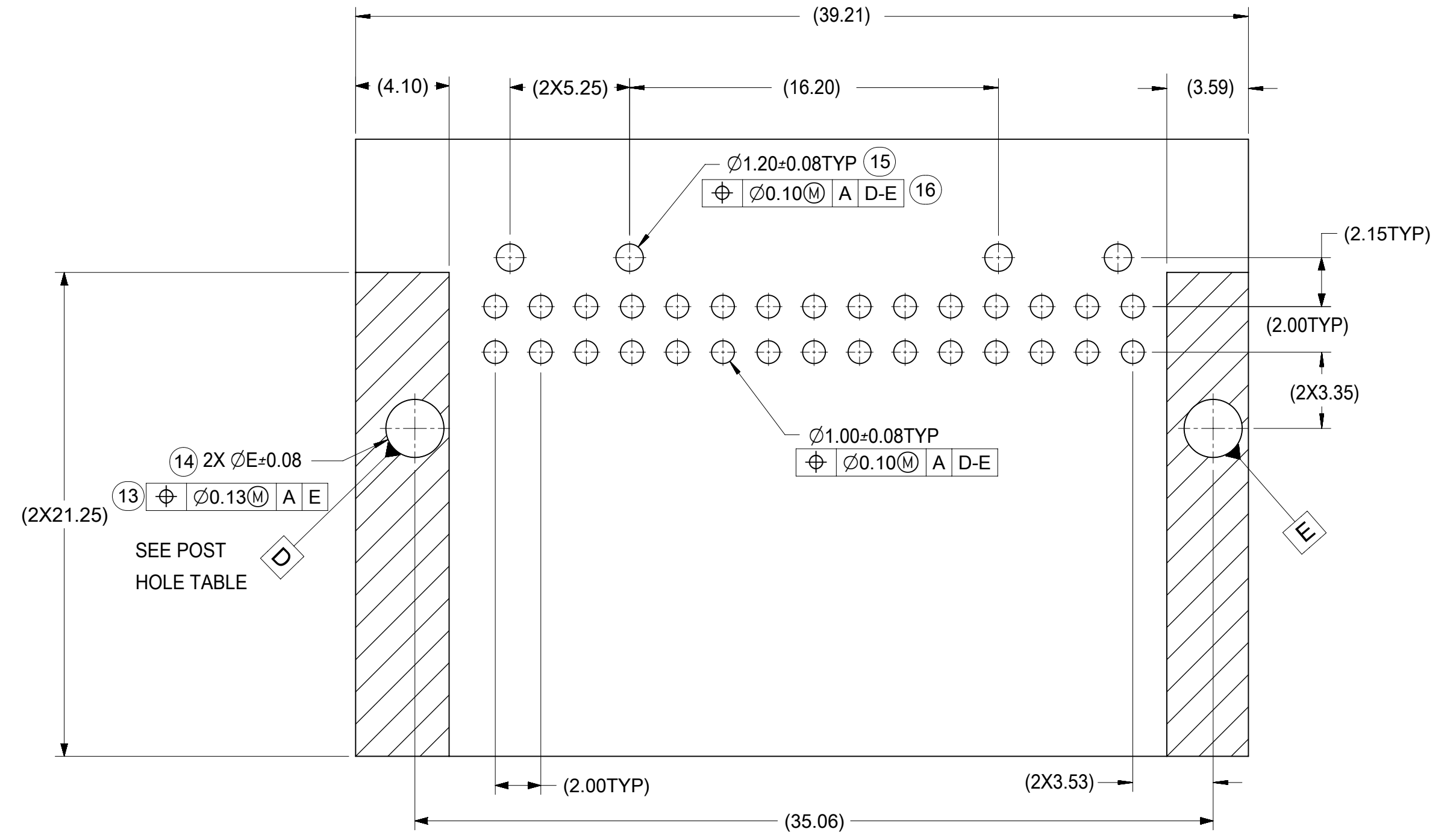

REFERENCE 34WAY PCB LAYOUT

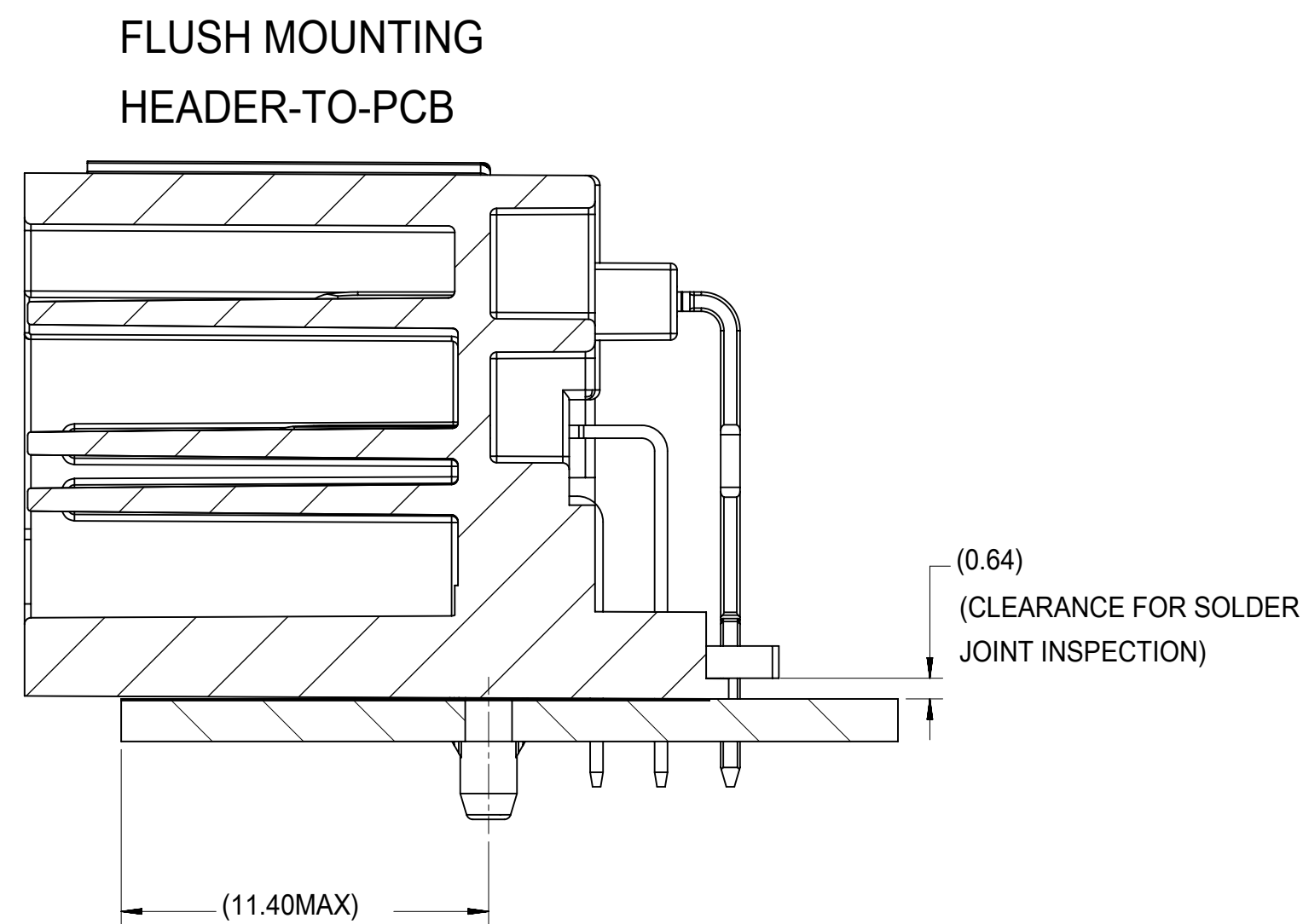

POST HOLE TABLE:

FOR DIM E:	
PRESS FIT:	2.15
DROP IN:	2.55

SYMBOLS	THIS DRAWING CONTAINS INFORMATION THAT IS PROPRIETARY TO MOLEX ELECTRONIC TECHNOLOGIES, LLC AND SHOULD NOT BE USED WITHOUT WRITTEN PERMISSION		CURRENT REV DESC:			
	DIMENSION UNITS	SCALE				
▽ = 0	mm	1:1	GENERAL TOLERANCES (UNLESS SPECIFIED)		34 & 38 CKT MINI50	
▽ = 0	ANGULAR TOL ± 1.0°		4 PLACES ±		RIGHT ANGLE HEADER ASSEMBLY SALES DRAWING	
▽ = 0	3 PLACES ±		3 PLACES ±		PRODUCT CUSTOMER DRAWING	
▽ = 0	2 PLACES ±		2 PLACES ±		DOCUMENT NUMBER	
▽ = 0	1 PLACE ±		1 PLACE ±		DOC TYPE	
⊠ = 0	0 PLACES ±		0 PLACES ±		DOC PART	
■ = 0	DRAFT WHERE APPLICABLE		THIRD ANGLE PROJECTION		REVISION	
▽ = 0	MUST REMAIN WITHIN DIMENSIONS		DRAWING		SD-34961-030	
	D-SIZE		SERIES		PSD 001 H	
	34961		GENERAL MARKET		SHEET NUMBER	
	4 OF 4					