



Chipsmall Limited consists of a professional team with an average of over 10 year of expertise in the distribution of electronic components. Based in Hongkong, we have already established firm and mutual-benefit business relationships with customers from,Europe,America and south Asia,supplying obsolete and hard-to-find components to meet their specific needs.

With the principle of “Quality Parts,Customers Priority,Honest Operation,and Considerate Service”,our business mainly focus on the distribution of electronic components. Line cards we deal with include Microchip,ALPS,ROHM,Xilinx,Pulse,ON,Everlight and Freescale. Main products comprise IC,Modules,Potentiometer,IC Socket,Relay,Connector.Our parts cover such applications as commercial,industrial, and automotives areas.

We are looking forward to setting up business relationship with you and hope to provide you with the best service and solution. Let us make a better world for our industry!



Contact us

Tel: +86-755-8981 8866 Fax: +86-755-8427 6832

Email & Skype: info@chipsmall.com Web: www.chipsmall.com

Address: A1208, Overseas Decoration Building, #122 Zhenhua RD., Futian, Shenzhen, China



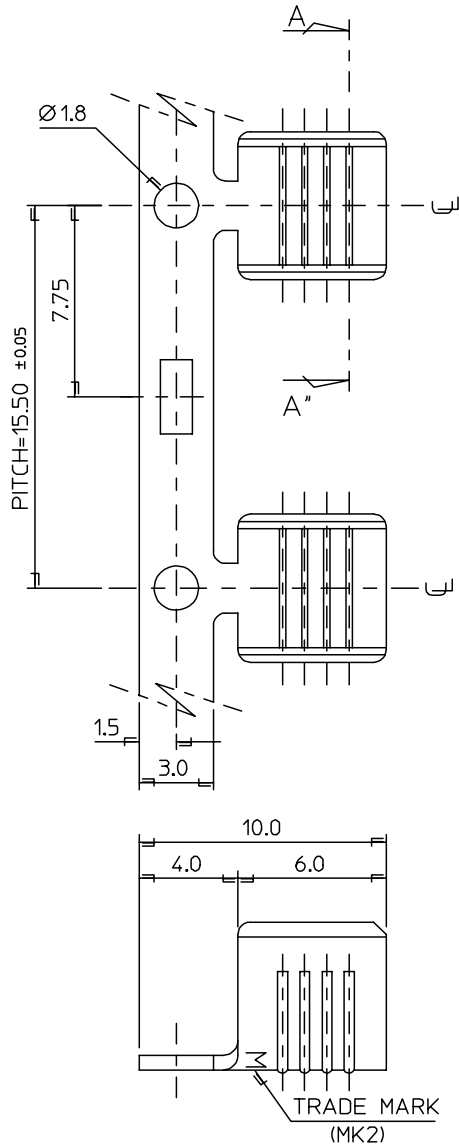

NOTES

1. MATERIAL : BRASS THICKNESS : 0.6mm
2. MATERIAL NO.

PART NO.	a	b	C	FINISH	WIRE RANGE	QUANTITY
35760-7300	6.0	6.0	R2.5	UNPLATED	4.0-6.0mm ²	2,000/REEL
35760-7310				POST PLATED TIN		
35760-7500	5.4	5.2	R2.2	UNPLATED	2.5-4.0mm ²	3,000/REEL
35760-7510				POST PLATED TIN		

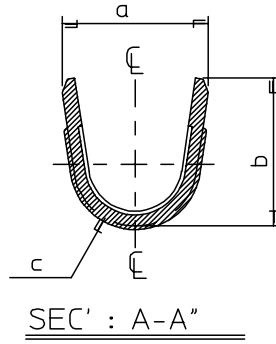

ADDITION OF OPTION EC NO:KOR2006-0064 DRWNSY/PARK 05/12/16 CHK: BC.YOON 05/12/16 APPR: SH.CHOI 05/12/16	QUALITY SYMBOLS MAJOR CRITICAL	GENERAL TOLERANCES: (UNLESS SPECIFIED)		SCALE 5:1	DESIGN UNITS <input checked="" type="checkbox"/> mm <input type="checkbox"/> INCH	THIRD ANGLE PROJECTION <input checked="" type="checkbox"/> THIRD ANGLE <input type="checkbox"/> FIRST ANGLE	DIMENSIONS: <input type="checkbox"/> mm <input type="checkbox"/> INCH <input checked="" type="checkbox"/> mm ONLY	SHT REV
		4 PLACES ±0. ±. 3 PLACES ±0. ±. 2 PLACES ±0.20 ±. 1 PLACE ±0.30 ±. ANGULAR: ± 0.15 °	DRAWN BY & DATE J.S.KANG 93/10/08 CHECKED BY & DATE B.K.CHOI 93/10/08 APPROVED BY & DATE C.W.LEE 93/10/08	TITLE: WIRE SPLICE(M)		MOLEX INCORPORATED		SHEET NO. 1 OF 1
B	REV	DRAFT WHERE APPLICABLE MUST REMAIN WITHIN DIMENSIONS		CAD FILENAME SD35760.DGN	MATERIAL NO. SEE TABLE	DRAWING NO. SD-35760-003	SIZE B	

DWG. NO.
SD-35760-003

SIMILAR ITEM

PROJECT NO.

c

B

DO NOT SCALE DRAWING
DIMENSION IN METRIC

F

E

D

C

B

A