



Chipsmall Limited consists of a professional team with an average of over 10 year of expertise in the distribution of electronic components. Based in Hongkong, we have already established firm and mutual-benefit business relationships with customers from,Europe,America and south Asia,supplying obsolete and hard-to-find components to meet their specific needs.

With the principle of "Quality Parts,Customers Priority,Honest Operation,and Considerate Service",our business mainly focus on the distribution of electronic components. Line cards we deal with include Microchip,ALPS,ROHM,Xilinx,Pulse,ON,Everlight and Freescale. Main products comprise IC,Modules,Potentiometer,IC Socket,Relay,Connector.Our parts cover such applications as commercial,industrial, and automotives areas.

We are looking forward to setting up business relationship with you and hope to provide you with the best service and solution. Let us make a better world for our industry!



Contact us

Tel: +86-755-8981 8866 Fax: +86-755-8427 6832

Email & Skype: info@chipsmall.com Web: www.chipsmall.com

Address: A1208, Overseas Decoration Building, #122 Zhenhua RD., Futian, Shenzhen, China



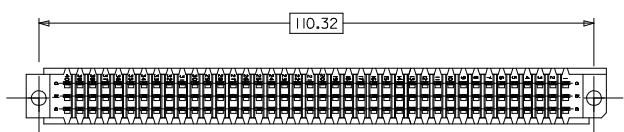
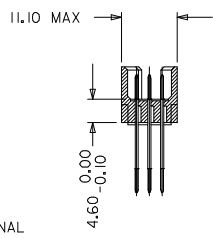
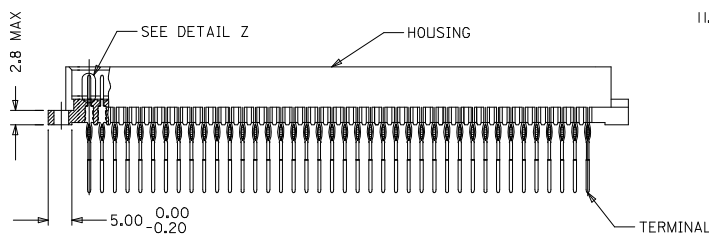
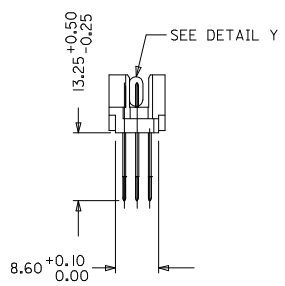
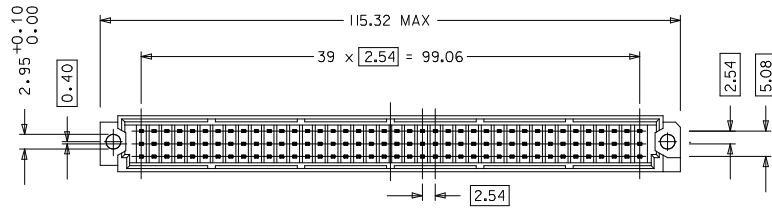

RECOMMENDED PCB LAYOUT
COMPONENT SIDE

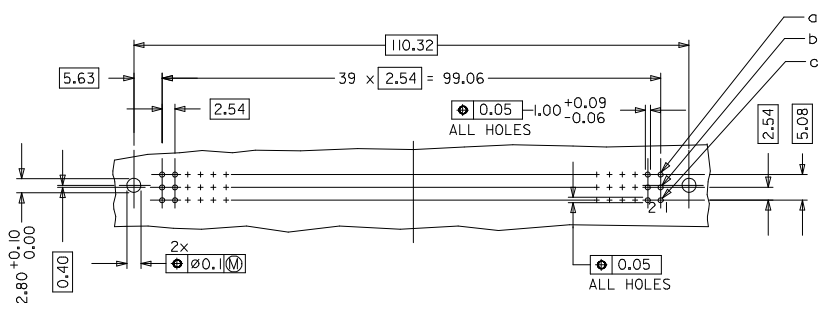

NOTES:

- 1) MATERIALS: THERMOPLASTIC POLYESTER, GLASS FILLED, UL94V-0.
COLOUR: PEBBLE GREY RAL 7032
TERMINAL - PHOSPHOR BRONZE
- 2) FINISH: CONTACT AREA

PERFORMANCE LEVEL 2: SLECTIVE GOLD (Au), THICKNESS = 0.6 MICROMETER,
OVER NICKEL, THICKNESS = 1.25 MICROMETER MIN

PRESS-IN AREA : Au FLASH, OVER NICKEL, THICKNESS = 1.25 MICROMETER MIN OVERALL

WRAP AREA : Au FLASH, OVER NICKEL, THICKNESS = 1.25 MICROMETER MIN OVERALL

TRANSFER PLUGGING AREA :
PERFORMANCE LEVEL 2 : SLECTIVE GOLD (Au), THICKNESS = 0.6 MICROMETER,
OVER NICKEL, THICKNESS = 1.25 MICROMETER MIN OVERALL
- 3) MATERIAL NUMBER, BATCH CODE UL AND CSA MARKING TO BE PRINTED ON THE CONNECTOR
- 4) CUT FACES OF TIP WITHOUT PLATING PERMITTED
- 5) PRODUCT SPECIFICATION : PS: 36515-001

DETAIL Z DETAIL Y

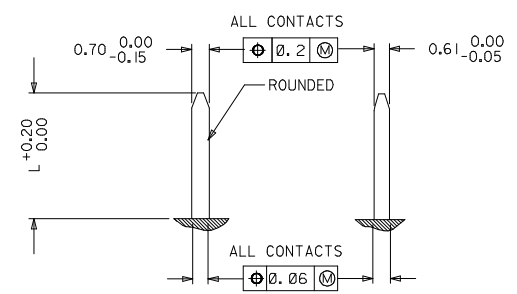

	L
NORMAL CONTACTS	4.8

RoHS COMPLIANT

EC NO: 2007-077Z DRAWN: JAVENGG CHKD: SSUDHR APPR: KRASAD 2008/06/07 2008/06/19 2009/10/22	QUALITY SYMBOLS ▽=0 ▽=0	GENERAL TOLERANCES (UNLESS SPECIFIED)	DIMENSION STYLE MM ONLY	SCALE 2:1	DESIGN UNITS METRIC	THIRD ANGLE PROJECTION																									
		<table border="1"> <tr> <th></th> <th>mm</th> <th>INCH</th> </tr> <tr> <td>4 PLACES</td> <td>±---</td> <td>±---</td> </tr> <tr> <td>3 PLACES</td> <td>±0.05</td> <td>±---</td> </tr> <tr> <td>2 PLACES</td> <td>±0.1</td> <td>±---</td> </tr> <tr> <td>1 PLACE</td> <td>±0.15</td> <td>±---</td> </tr> </table>		mm	INCH	4 PLACES	±---	±---	3 PLACES	±0.05	±---	2 PLACES	±0.1	±---	1 PLACE	±0.15	±---	<table border="1"> <tr> <th>DRAWN BY</th> <th>DATE</th> </tr> <tr> <td>SS</td> <td>1999/11/23</td> </tr> <tr> <th>CHECKED BY</th> <th>DATE</th> </tr> <tr> <td>GJLOWE</td> <td>1999/11/23</td> </tr> <tr> <th>APPROVED BY</th> <th>DATE</th> </tr> <tr> <td>GJLOWE</td> <td>1999/11/23</td> </tr> </table>	DRAWN BY	DATE	SS	1999/11/23	CHECKED BY	DATE	GJLOWE	1999/11/23	APPROVED BY	DATE	GJLOWE	1999/11/23	TITLE ASSEMBLY, DIN 41612
	mm	INCH																													
4 PLACES	±---	±---																													
3 PLACES	±0.05	±---																													
2 PLACES	±0.1	±---																													
1 PLACE	±0.15	±---																													
DRAWN BY	DATE																														
SS	1999/11/23																														
CHECKED BY	DATE																														
GJLOWE	1999/11/23																														
APPROVED BY	DATE																														
GJLOWE	1999/11/23																														
		DRAFT WHERE APPLICABLE MUST REMAIN WITHIN DIMENSIONS	MATERIAL NO. 36514-0002	DOCUMENT NO. SD-36514-002	MOLEX INCORPORATED																										
			THIS DRAWING CONTAINS INFORMATION THAT IS PROPRIETARY TO MOLEX INCORPORATED AND SHOULD NOT BE USED WITHOUT WRITTEN PERMISSION		SHEET NO. 1 OF 1																										