



Chipsmall Limited consists of a professional team with an average of over 10 year of expertise in the distribution of electronic components. Based in Hongkong, we have already established firm and mutual-benefit business relationships with customers from,Europe,America and south Asia,supplying obsolete and hard-to-find components to meet their specific needs.

With the principle of “Quality Parts,Customers Priority,Honest Operation,and Considerate Service”,our business mainly focus on the distribution of electronic components. Line cards we deal with include Microchip,ALPS,ROHM,Xilinx,Pulse,ON,Everlight and Freescale. Main products comprise IC,Modules,Potentiometer,IC Socket,Relay,Connector.Our parts cover such applications as commercial,industrial, and automotives areas.

We are looking forward to setting up business relationship with you and hope to provide you with the best service and solution. Let us make a better world for our industry!



Contact us

Tel: +86-755-8981 8866 Fax: +86-755-8427 6832

Email & Skype: info@chipsmall.com Web: www.chipsmall.com

Address: A1208, Overseas Decoration Building, #122 Zhenhua RD., Futian, Shenzhen, China



NOTES:

1. MATERIAL: COPPER ALLOY 151, 0.50mm THICK.

2. PLATING:

SELECT GOLD: 0,00076 MIN. SELECT. GOLD IN CONTACT AREA,
0,00254 MIN. SELECT *TIN IN CRIMP AREA, OVER 0,00127 NICKEL.

OVERALL *TIN: 0,00254 MIN. BRIGHT *TIN OVER 0,00127 MIN. NICKEL

* THE PRIMARY SHIPPING CARTON WILL BE LABELED "COMPLIANT TO RoHS
DIRECTIVE 2002/95/EC AND ELV ANNEX II OF DIRECTIVE 2000/53/EC".
CARTONS WITHOUT THIS LABEL MAY CONTAIN PRODUCT WITH TIN-LEAD.

3. PRODUCT SPECIFICATION: PS-42815-001.

4. PART IS DESIGN IN METRIC.

5. TERMINALS FOR USE WITH STRANDED WIRE ONLY,
STRANDED TINNED WIRE IS RECOMMENDED.

6. AFTER CRIMPING, THIS DIMENSION = 3.55mm MIN.

7. AFTER CRIMPING, THIS DIMENSION = 2.25mm MAX.

8. CRIMP SPECIFICATION: 638301000.

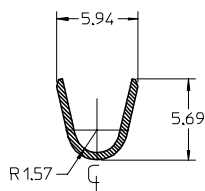
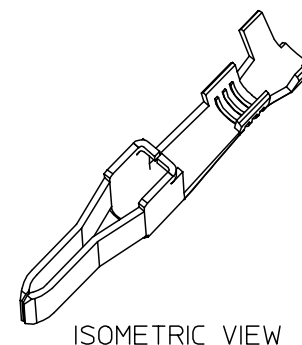
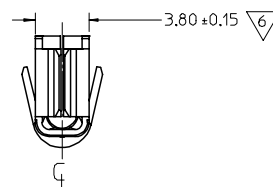
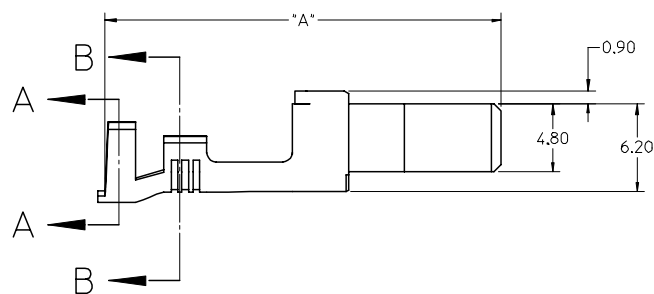
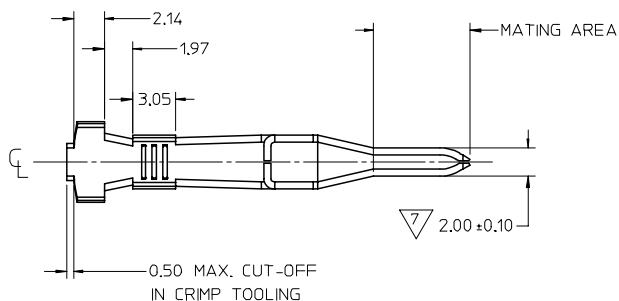
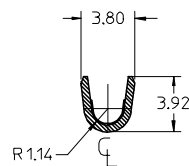
9. WHEN USING TIN-PLATED TERMINALS FOR APPLICATIONS
INVOLVING VIBRATION AND/OR THERMAL CYCLING,
MOLEX STRONGLY RECOMMENDS THE USE OF NYE LUBRICANT,
NYOGEL 760G, ON THE MATING AREA OF THE TERMINAL.
LUBRICANT SHOULD BE APPLIED AFTER THE TERMINALS ARE
INSERTED INTO THE HOUSING.SECTION A-A
INSULATION CRIMPSECTION B-B
CONDUCTOR CRIMP

MATERIAL NO.	CONFIGURATION	DIM. "A"	PLATING
42817-0041	STANDARD	27.60	TIN 9
42817-0141	MAKE-FIRST/BREAK-LAST	29.60	TIN 9
42817-0042	STANDARD	27.60	SELECT GOLD
42817-0142	MAKE-FIRST/BREAK-LAST	29.60	SELECT GOLD

LEAD-FREE EC NO: UCP2004-2391 DRWN: MCARRANZ004/06/07 CHKD: JCOMERC 2004/06/07 APPR: JCOMERC 2004/06/10	QUALITY SYMBOLS	DESCRIPTION	GENERAL TOLERANCES (UNLESS SPECIFIED)		SCALE 4:1	DESIGN UNITS METRIC	THIRD ANGLE PROJECTION		REVISE ON CAD ONLY	
					DIMENSION STYLE MM ONLY		TITLE			
					DRAWN BY MFIRLEJ		DATE 2002/05/15			
					CHECKED BY JCOMERC		DATE 2002/05/15		MOLEX MOLEX INCORPORATED	
					APPROVED BY JCOMERC		DATE 2002/05/15		MATERIAL NO. SEE CHART	
									DOCUMENT NO. SD-42817-020	
									SHEET NO. 1 OF 1	
B1	REV		DRAFT WHERE APPLICABLE MUST REMAIN WITHIN DIMENSIONS		THIS DRAWING CONTAINS INFORMATION THAT IS PROPRIETARY TO MOLEX INCORPORATED AND SHOULD NOT BE USED WITHOUT WRITTEN PERMISSION					