



Chipsmall Limited consists of a professional team with an average of over 10 year of expertise in the distribution of electronic components. Based in Hongkong, we have already established firm and mutual-benefit business relationships with customers from,Europe,America and south Asia,supplying obsolete and hard-to-find components to meet their specific needs.

With the principle of “Quality Parts,Customers Priority,Honest Operation,and Considerate Service”,our business mainly focus on the distribution of electronic components. Line cards we deal with include Microchip,ALPS,ROHM,Xilinx,Pulse,ON,Everlight and Freescale. Main products comprise IC,Modules,Potentiometer,IC Socket,Relay,Connector.Our parts cover such applications as commercial,industrial, and automotives areas.

We are looking forward to setting up business relationship with you and hope to provide you with the best service and solution. Let us make a better world for our industry!



Contact us

Tel: +86-755-8981 8866 Fax: +86-755-8427 6832

Email & Skype: info@chipsmall.com Web: www.chipsmall.com

Address: A1208, Overseas Decoration Building, #122 Zhenhua RD., Futian, Shenzhen, China



.295±.006
(7.49±0.15)

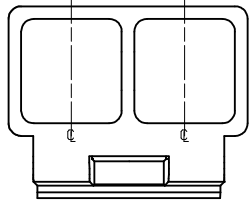

NOTES:

1) MATERIAL

A: NYLON 66, UL94V-2, COLOR: (SEE CHART).

B: NYLON 66, UL94V-0, COLOR: (SEE CHART).

C: NYLON 66, UL94V-0, COLOR (SEE CHART).

D: NYLON, UL94V-2, COLOR: BLACK, IEC 60335-1 GLOW WIRE CAPABLE.

2) FINISH: NONE

3) PRODUCT SPECIFICATION: SEE PSX-43335-9999 FOR APPLICABLE SPECIFICATIONS.

4) PACKAGING INFORMATION: PER PK-43335-001.

5) THIS CONNECTOR HOUSING WILL MATE TO A-43160-***2, 43180-***2 AND 43680-***2 HOUSINGS.

6) THIS CONNECTOR HOUSING FOR USE WITH 43375-**** TERMINALS.

ITEM NUMBER	MATERIAL (SEE NOTE 1)	COLOR
43335-1002	A	NATURAL
43335-2002	B	BLACK
43335-3002	A	RED
43335-4002	A	BLUE
43335-5002	C	NATURAL
43335-7002	D	BLACK

.623±.008
(15.82±0.20)

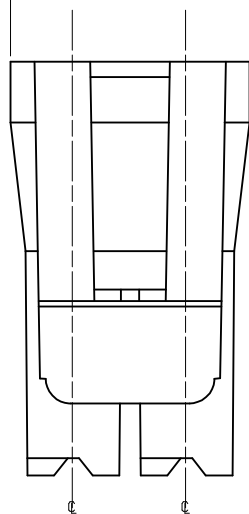

.188±.010
(4.78±0.25)

.327±.020
(8.31±0.51)

.338±.006
(8.59±0.15)

1.078±.010
(27.38±0.25)

1.033±.008
(26.24±0.20)

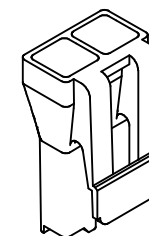

43335-*002
(SCALE 2:1)

ADD-7002 PN EC NO: UCP2014-2026 DRWNGES 2013/11/07 CHKD: BANDERSON 2013/11/11 APPR: FSMITH 2014/04/17	QUALITY SYMBOLS 	GENERAL TOLERANCES (UNLESS SPECIFIED)		DIMENSION STYLE IN/MM		SCALE 1:1	DESIGN UNITS INCH	THIRD ANGLE PROJECTION		
	DESCRIPTION 4 PLACES ± --- ± --- 3 PLACES ± --- ± --- 2 PLACES ± --- ± --- 1 PLACE ± --- ± --- 0 PLACE ± --- ± ---	ANGULAR ±1/2°	DRAWN BY MAB	DATE 08-15-95	TITLE 2-CIR RECEPTACLE HOUSING .125/(3.18)X .020/(0.51) FLAT BLADE SYS. - T.P.A.					
	DRAFT WHERE APPLICABLE MUST REMAIN WITHIN DIMENSIONS	MATERIAL NO. SEE CHART	CHECKED BY KBP	DATE 08-15-95	DOCUMENT NO. SD-43335-*002					
	REV G	SHEET NO. 1 OF 1	THIS DRAWING CONTAINS INFORMATION THAT IS PROPRIETARY TO MOLEX INCORPORATED AND SHOULD NOT BE USED WITHOUT WRITTEN PERMISSION							