



Chipsmall Limited consists of a professional team with an average of over 10 year of expertise in the distribution of electronic components. Based in Hongkong, we have already established firm and mutual-benefit business relationships with customers from,Europe,America and south Asia,supplying obsolete and hard-to-find components to meet their specific needs.

With the principle of “Quality Parts,Customers Priority,Honest Operation,and Considerate Service”,our business mainly focus on the distribution of electronic components. Line cards we deal with include Microchip,ALPS,ROHM,Xilinx,Pulse,ON,Everlight and Freescale. Main products comprise IC,Modules,Potentiometer,IC Socket,Relay,Connector.Our parts cover such applications as commercial,industrial, and automotives areas.

We are looking forward to setting up business relationship with you and hope to provide you with the best service and solution. Let us make a better world for our industry!



Contact us

Tel: +86-755-8981 8866 Fax: +86-755-8427 6832

Email & Skype: info@chipsmall.com Web: www.chipsmall.com

Address: A1208, Overseas Decoration Building, #122 Zhenhua RD., Futian, Shenzhen, China



PART NUMBER	PLATING	RECOMMENDED WIRE SIZE	DIM "A" HEIGHT	DIM "B" WIDTH	RECOMMENDED CRIMP APPLICATOR	PACKAGE SIZE
173693-4634	30μ * GOLD STRIPE OVER 50μ * NICKEL OVERALL WITH 80-130μ * SELECT TIN	8 AWG (2) 12 AWG	7.42±0.5	5.84±0.5	63832-6300	1800 PARTS/ REEL
173693-4632		10-12 AWG (2) 14 AWG	5.97±0.5	5.33±0.5	63832-6000	2500 PARTS/ REEL
173693-4636		14-16 AWG (2) 16 AWG (2) 18 AWG	5.20±0.5	5.33±0.5	63832-6100	

- NOTES:
1. MATERIAL: COPPER ALLOY .032 IN THICK
 2. FINISH: PER MOLEX PLATING SPECIFICATION ES-88 - SEE CHART
 3. FOR CRIMP APPLICATOR SEE CHART
 4. FOR CRIMP TOOLING CONTACT MOLEX OR VISIT THE MOLEX WEBSITE AT: WWW.MOLEX.COM
 5. STANDARD PACKAGE SIZE: SEE CHART
 6. SEE PRODUCT SPECIFICATION: PS-173693-001 FOR MORE INFORMATION
 7. PARTS ARE RoHS COMPLIANT
 8. FOR MATING CONTACT: SEE CHART
 9. FOR CRIMP SET UP INFORMATION SEE MOLEX APPLICATION SPECIFICATION DOCUMENT:
- 8 AWG - ATS-638326300
10/12 AWG - ATS-638326000
14/16 AWG - ATS-638326100

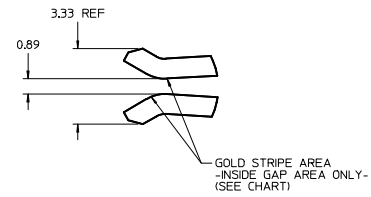
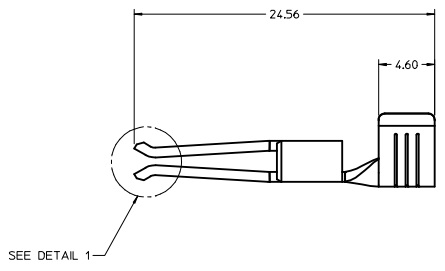
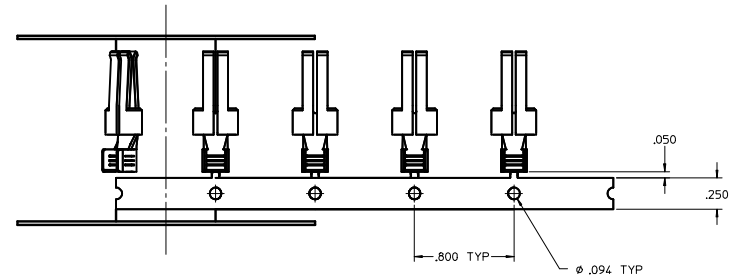
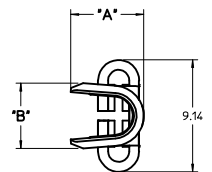
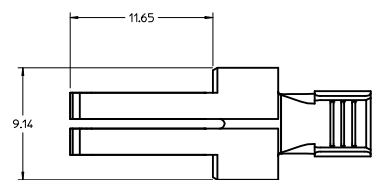
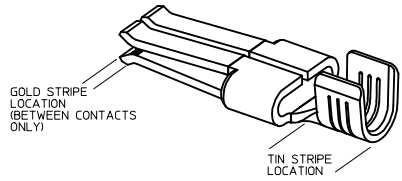

DETAIL 1
SCALE 10:1

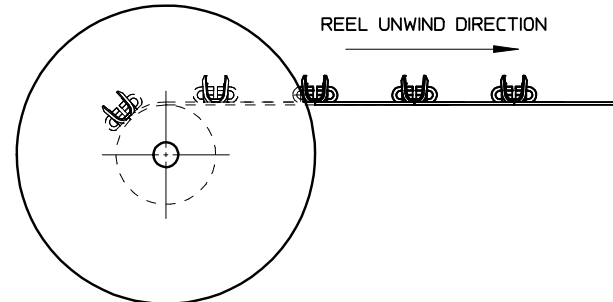

PRELIMINARY IEC NO. UCF2016-4071 DRAWN BY JSCHAFFER 2016/04/15 CHKD BY PI SZCZOR APPR: BPI SZCZOR 2016/10/03	QUALITY SYMBOLS	GENERAL TOLERANCES (UNLESS SPECIFIED)	DIMENSION STYLE	SCALE	DESIGN UNITS	THIRD ANGLE PROJECTION
	▽=0	4 PLACES ± --- INCH	MM ONLY	5:1	METRIC	☉
	▽=0	3 PLACES ± ---				
	▽=0	2 PLACES ± 0.13				
		1 PLACE ± 0.25				
		0 PLACE ± ---				
		ANGULAR ±1/2°				
		DRAFT WHERE APPLICABLE MUST REMAIN WITHIN DIMENSIONS				
			MATERIAL NO.	DOCUMENT NO.		
			SEE CHART	SD-173693-001		
						SHEET NO. 1 OF 1

PART NUMBER	PLATING	RECOMMENDED WIRE SIZE	DIM "A" HEIGHT	DIM "B" WIDTH	RECOMMENDED CRIMP APPLICATOR	PACKAGE SIZE
44262-4634	30μ * GOLD STRIPE OVER 50μ * NICKEL OVERALL WITH 80-130μ * SELECT TIN	8 AWG (2) 12 AWG	7.42±0.5	5.84±0.5	63832-6300	1800 PARTS/ REEL
44262-4632		10-12 AWG (2) 14 AWG	5.97±0.5	5.33±0.5	63832-6000	2500 PARTS/ REEL
44262-4636		14-16 AWG (2) 16 AWG (2) 18 AWG	5.20±0.5	5.33±0.5	63832-6100	

- NOTES:
1. MATERIAL: COPPER ALLOY .032 IN THICK
 2. FINISH: PER MOLEX PLATING SPECIFICATION ES-88 - SEE CHART
 3. FOR CRIMP APPLICATOR SEE CHART
 4. FOR CRIMP TOOLING CONTACT MOLEX OR VISIT THE MOLEX WEBSITE AT: WWW.MOLEX.COM
 5. STANDARD PACKAGE SIZE: SEE CHART
 6. SEE PRODUCT SPECIFICATION: PS-44262-001 FOR MORE INFORMATION
 7. PARTS ARE RoHS COMPLIANT
 8. FOR MATING CONTACT: SEE CHART
 9. FOR CRIMP SET UP INFORMATION SEE MOLEX APPLICATION SPECIFICATION DOCUMENT:
- 8 AWG - ATS-638326300
 10/12 AWG - ATS-638326000
 14/16 AWG - ATS-638326100

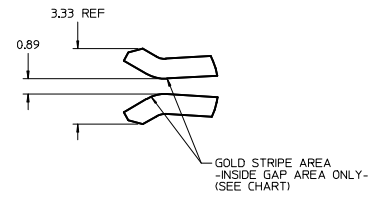
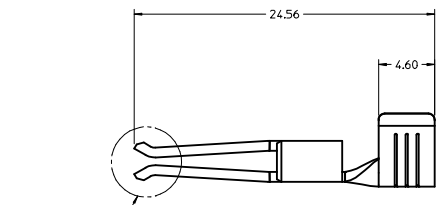
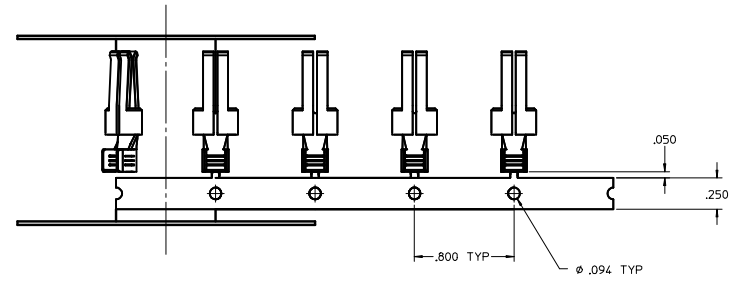
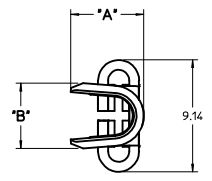
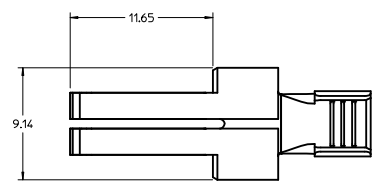
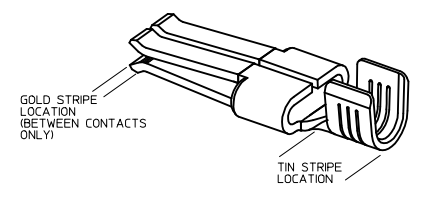

DETAIL 1
SCALE 10:1

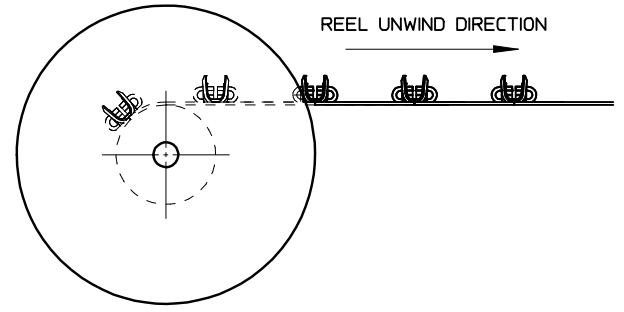

RELEASED IEC NO. UCF2015-4855 DRAWN BY: JOUILLES 2015/05/19 CHKD BY: SZCZOR 2015/05/21 APPR: APATEL 2015/06/11	QUALITY SYMBOLS	GENERAL TOLERANCES (UNLESS SPECIFIED)	DIMENSION STYLE	SCALE	DESIGN UNITS	THIRD ANGLE PROJECTION
	∇=0 ∇=0 ∇=0	4 PLACES ± mm ± INCH 3 PLACES ± --- ± --- 2 PLACES ± 0.13 ± --- 1 PLACE ± 0.25 ± --- 0 PLACE ± --- ± ---	MM ONLY	5:1	METRIC	
	DRAFT WHERE APPLICABLE MUST REMAIN WITHIN DIMENSIONS	ANGULAR ±1/2° MATERIAL NO. SEE CHART SIZE D	DRAWN BY: JOUILLES 2015/05/19 CHECKED BY: BPI SZCZOR 2015/05/21 APPROVED BY: APATEL 2015/06/11	TITLE: TERMINAL - RECEPTACLE POWER CONTACT TEN60 POWER FAMILY molex DOCUMENT NO. SD-44262-2000	SHEET NO. 1 OF 1	