



Chipsmall Limited consists of a professional team with an average of over 10 year of expertise in the distribution of electronic components. Based in Hongkong, we have already established firm and mutual-benefit business relationships with customers from,Europe,America and south Asia,supplying obsolete and hard-to-find components to meet their specific needs.

With the principle of “Quality Parts,Customers Priority,Honest Operation,and Considerate Service”,our business mainly focus on the distribution of electronic components. Line cards we deal with include Microchip,ALPS,ROHM,Xilinx,Pulse,ON,Everlight and Freescale. Main products comprise IC,Modules,Potentiometer,IC Socket,Relay,Connector.Our parts cover such applications as commercial,industrial, and automotives areas.

We are looking forward to setting up business relationship with you and hope to provide you with the best service and solution. Let us make a better world for our industry!



Contact us

Tel: +86-755-8981 8866 Fax: +86-755-8427 6832

Email & Skype: info@chipsmall.com Web: www.chipsmall.com

Address: A1208, Overseas Decoration Building, #122 Zhenhua RD., Futian, Shenzhen, China



REV NC	0460-229-16**	REVISIONS		
SYM	DESCRIPTION	DATE	APPROVED	
NC	NEW RELEASE PER E.O. PI9398	11-17-06	RCC	

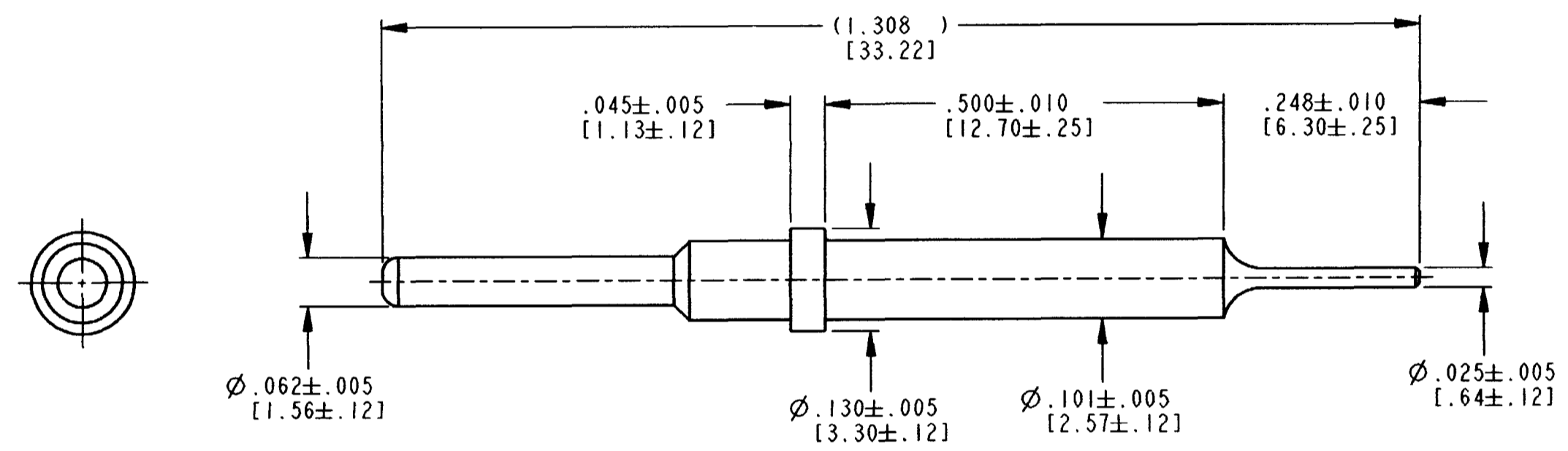

- NOTES:
1. DIMENSIONS ARE IN INCHES [mm].
 2. WHEN ** = 141: PLATING IS NICKEL.
 3. FOR CONTACT APPLICATION, SEE DRAWING 0425-202-0000.

SIGNATURE & DATE		CONTACT PIN SIZE 16 EXTENSION	EP	MATL. CODE	
DR	J. APOSTOL 24OCT2006		The Deutch Company DEUTSCH I.P.D. 3850 INDUSTRIAL AVE. HEMET, CALIF. 92545		
CHK	<i>[Signature]</i> 11/2/06		B 0460-229-16**	DWG SIZE	CODE 11139
PE	<i>[Signature]</i> 11/21/06			SHEET OF	
APPD	<i>[Signature]</i> 11-17-06	ENVELOPE			
SCALE	NONE	WT			