



Chipsmall Limited consists of a professional team with an average of over 10 year of expertise in the distribution of electronic components. Based in Hongkong, we have already established firm and mutual-benefit business relationships with customers from,Europe,America and south Asia,supplying obsolete and hard-to-find components to meet their specific needs.

With the principle of “Quality Parts,Customers Priority,Honest Operation,and Considerate Service”,our business mainly focus on the distribution of electronic components. Line cards we deal with include Microchip,ALPS,ROHM,Xilinx,Pulse,ON,Everlight and Freescale. Main products comprise IC,Modules,Potentiometer,IC Socket,Relay,Connector.Our parts cover such applications as commercial,industrial, and automotives areas.

We are looking forward to setting up business relationship with you and hope to provide you with the best service and solution. Let us make a better world for our industry!



## Contact us

Tel: +86-755-8981 8866 Fax: +86-755-8427 6832

Email & Skype: info@chipsmall.com Web: www.chipsmall.com

Address: A1208, Overseas Decoration Building, #122 Zhenhua RD., Futian, Shenzhen, China



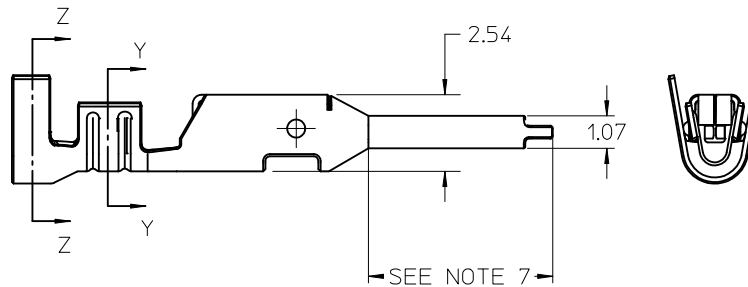
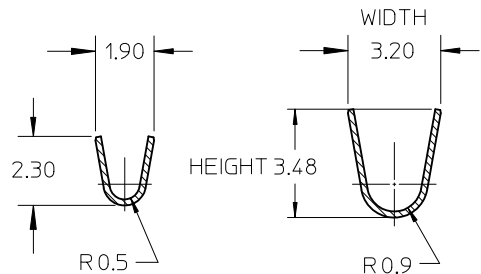
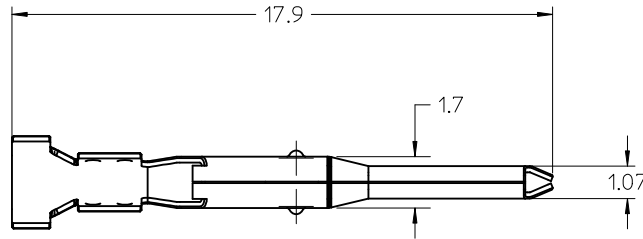
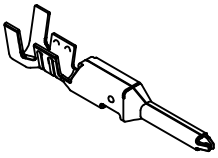

SECTION Y-Y  
CONDUCTOR CRIMP

SECTION Z-Z  
INSULATION CRIMP

NOTES:

- MATERIAL: HIGH PERFORMANCE COPPER ALLOY
- FINISH:  
222 - OVERALL TIN: 100 MI MIN OVER NICKEL  
228 - SELECT GOLD: 30 MI MIN,  
SELECT TIN: 100 MI MIN  
OVER NICKEL
- PRODUCT SPECIFICATION: PS-46064-001
- PACKAGING:  
REEL PACK PER : PK-46056-002  
LOOSE PACK PER : PK-5556-003
- TERMINAL TO BE USED WITH ASSY NUMBER: 46065
- WIRE SPECIFICATION: SEE CHART.
- WHEN USING OVERALL TIN PLATED TERMINALS:  
FOR APPLICATIONS INVOLVING VIBRATION AND/OR  
THERMAL CYCLING, MOLEX STRONGLY RECOMMENDS  
THE USE OF NYE LUBRICANT, NYOGEL 760G, ON  
THE MATING END OF THE TERMINAL. LUBRICANT  
MAY BE APPLIED BEFORE OR AFTER THE TERMINALS  
ARE INSERTED INTO THE HOUSING.

LOOSE PACKAGED MATERIAL NUMBER	REEL PACKAGED MATERIAL NUMBER	FINISH	WIRE SPEC	INSULATION DIA	INSULATION (CRIMPED)		CONDUCTOR (CRIMPED)					
					HEIGHT		WIDTH		HEIGHT		WIDTH	
					MIN	MAX	MIN	MAX	MIN	MAX	MIN	MAX
46056-0004	46056-0002	222 - TIN	UL1015 18/20 AWG	2.52 / 2.81	N/A	3.20	2.70	2.90	1.05	1.15	1.50	1.70
46056-0005	46056-0003	228 - SELECT GOLD	UL1015 18/20 AWG	2.52 / 2.81	N/A	3.20	2.70	2.90	1.05	1.15	1.50	1.70

UPDATE NOTE 4 EC NO: UCP2011-1228 DRWN: JJAGUILAR 2010/10/29 CHKD: APPR: FSMITH 2010/11/09	QUALITY SYMBOLS	GENERAL TOLERANCES (UNLESS SPECIFIED)	DIMENSION STYLE	SCALE	DESIGN UNITS	THIRD ANGLE PROJECTION														
		<table border="1"> <thead> <tr> <th></th> <th>mm</th> <th>INCH</th> </tr> </thead> <tbody> <tr> <td>4 PLACES</td> <td>± ---</td> <td>± ---</td> </tr> <tr> <td>3 PLACES</td> <td>± ---</td> <td>± ---</td> </tr> <tr> <td>2 PLACES</td> <td>± 0.25</td> <td>± ---</td> </tr> <tr> <td>1 PLACE</td> <td>± 0.38</td> <td>± ---</td> </tr> </tbody> </table>		mm	INCH		4 PLACES	± ---	± ---	3 PLACES	± ---	± ---	2 PLACES	± 0.25	± ---	1 PLACE	± 0.38	± ---	MM ONLY	4:1
		mm	INCH																	
	4 PLACES	± ---	± ---																	
3 PLACES	± ---	± ---																		
2 PLACES	± 0.25	± ---																		
1 PLACE	± 0.38	± ---																		
<table border="1"> <thead> <tr> <th>DESCRIPTION</th> <th>DATE</th> </tr> </thead> <tbody> <tr> <td>DRAWN BY</td> <td>2007/03/22</td> </tr> <tr> <td>CHECKED BY</td> <td></td> </tr> <tr> <td>APPROVED BY</td> <td>2010/11/09</td> </tr> </tbody> </table>	DESCRIPTION	DATE	DRAWN BY	2007/03/22	CHECKED BY		APPROVED BY	2010/11/09	TITLE <b>SEALED MINIFIT H20 PLUG TERMINAL</b>											
DESCRIPTION	DATE																			
DRAWN BY	2007/03/22																			
CHECKED BY																				
APPROVED BY	2010/11/09																			
DRAFT WHERE APPLICABLE MUST REMAIN WITHIN DIMENSIONS	MATERIAL NO. <b>SEE CHART</b>	MOLEX INCORPORATED DOCUMENT NO. <b>SD-46056-001</b>	SHEET NO. <b>1 OF 1</b>																	