



Chipsmall Limited consists of a professional team with an average of over 10 year of expertise in the distribution of electronic components. Based in Hongkong, we have already established firm and mutual-benefit business relationships with customers from,Europe,America and south Asia,supplying obsolete and hard-to-find components to meet their specific needs.

With the principle of “Quality Parts,Customers Priority,Honest Operation,and Considerate Service”,our business mainly focus on the distribution of electronic components. Line cards we deal with include Microchip,ALPS,ROHM,Xilinx,Pulse,ON,Everlight and Freescale. Main products comprise IC,Modules,Potentiometer,IC Socket,Relay,Connector.Our parts cover such applications as commercial,industrial, and automotives areas.

We are looking forward to setting up business relationship with you and hope to provide you with the best service and solution. Let us make a better world for our industry!



Contact us

Tel: +86-755-8981 8866 Fax: +86-755-8427 6832

Email & Skype: info@chipsmall.com Web: www.chipsmall.com

Address: A1208, Overseas Decoration Building, #122 Zhenhua RD., Futian, Shenzhen, China



P/N 46112-601 SHOWN

POWER HOUSING ASSY W/ INTERLOCK

NO OF CKT	MATERIAL NUMBER	COMPLIANT PIN PLATING	DIM A	DIM B SEE SHT 2	DIM C SEE SHT 2
2	46112-0201	TIN	12.24/1.482	12.75/1.502	2.69/1.106
4	46112-0401	TIN	24.24/1.954	24.74/1.974	
6	46112-0601	TIN	36.24/1.427	36.75/1.447	
8	46112-0801	TIN	48.24/1.899	48.74/1.919	
10	46112-1001	TIN	60.24/2.372	60.76/2.392	
12	46112-1201	TIN	75.00/2.953	75.51/2.973	
14	46112-1401	TIN	84.24/3.317	84.76/3.337	

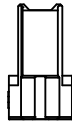
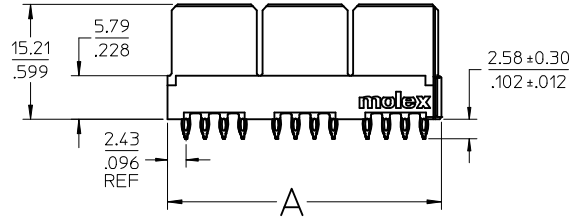
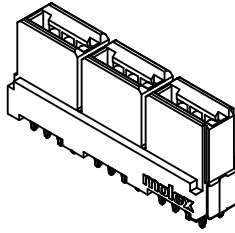
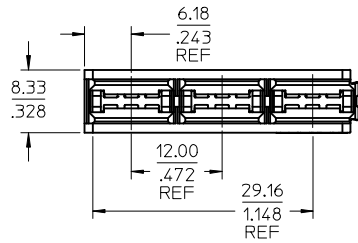

NOTES:

1. MATERIAL: HOUSING: LCP, 94-V0, COLOR: BLACK.
POWER CONTACTS: COPPER ALLOY.
SIGNAL CONTACTS: MODIFIED TIN BRASS.
2. FINISH: SELECT GOLD - 0.75 μM/30 μ INCHES
SELECTED TIN - 1.91 μM/75 μ INCHES
3. POWER CONTACTS ARE LUBRICATED IN CONTACT AREA.
4. PARTS ARE RoHS COMPLIANT.
5. MATES TO MOLEX P/N 45985-SERIES OR EDGE CARD 157/1.062.
6. PRODUCT SPECIFICATION PS-46114-001.
7. PACKAGING: PER PK-46114-003.

POWER HOUSING ASSY WITH (2) GUIDES

NO OF CKT	MATERIAL NUMBER	COMPLIANT PIN PLATING	DIM A	DIM B	DIM C
2	46112-0203	TIN	18.94/1.746	19.46/1.766	5.45/1.215
4	46112-0403	TIN	30.94/1.218	31.45/1.238	
6	46112-0603	TIN	42.94/1.691	43.46/1.711	
8	46112-0803	TIN	54.94/2.163	55.45/2.183	
10	46112-1003	TIN	66.94/2.635	67.44/2.655	
12	46112-1203	TIN	78.94/3.108	79.45/3.128	
14	46112-1403	TIN	90.94/3.580	91.44/3.600	

P/N 46112-603 SHOWN

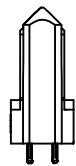
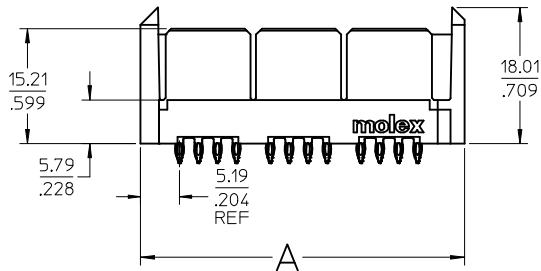
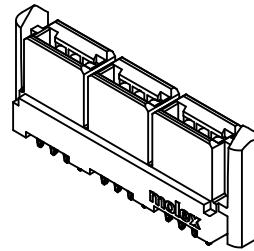
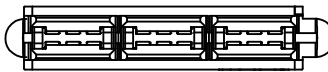

REMOVE TIN/LEAD EC NO: UCP2016-2607 DRWINGS: 2015/12/24 CHKD: APPR: BPLSZLZOR 2016/01/20 REV: C5	QUALITY SYMBOLS	GENERAL TOLERANCES (UNLESS SPECIFIED)	DIMENSION STYLE IN/MM	SCALE 2:1	DESIGN UNITS INCH	THIRD ANGLE PROJECTION
	▽=0	4 PLACES ± --- ± ---	mm INCH	DRAWN BY DATE	TITLE	LPH VERTICAL RECEPTACLE POWER ASSEMBLY 2 CKT-14 CKT, PRESS-FIT molex
	▽=0	3 PLACES ± --- ± .010		CHECKED BY DATE		
	▽=0	2 PLACES ± 0.25 ± ---		APPROVED BY DATE	JCOMERC I 2009/12/03	
	▽=0	1 PLACE ± --- ± ---		MATERIAL NO.	DOCUMENT NO.	SHEET NO.
		0 PLACE ± --- ± ---	ANGULAR ±1/2°	SEE CHART	SD-46112-200	1 OF 2
			DRAFT WHERE APPLICABLE MUST REMAIN WITHIN DIMENSIONS	THIS DRAWING CONTAINS INFORMATION THAT IS PROPRIETARY TO MOLEX INCORPORATED AND SHOULD NOT BE USED WITHOUT WRITTEN PERMISSION		

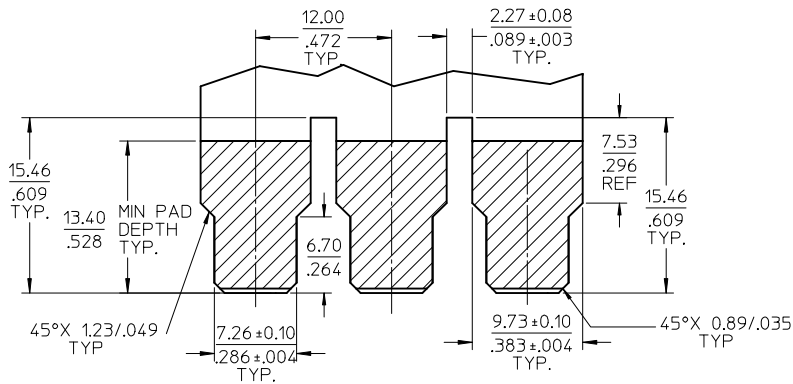

RECOMENDED EDGE CARD LAYOUT
 EDGE CARD THICKNESS: 1.57/.062
 PLATING: GOLD 30 μ INCHES MIN.
 OVER 150 μ INCHES NICKEL.

45°X 0.38/.015 TYP

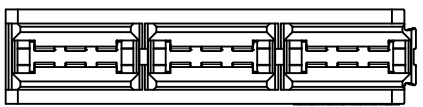

P/N 46112-601 SHOWN

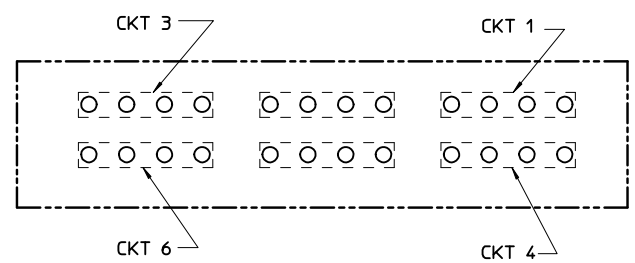

PCB LAYOUT: COMPONENT SIDE
 SCALE 4:1

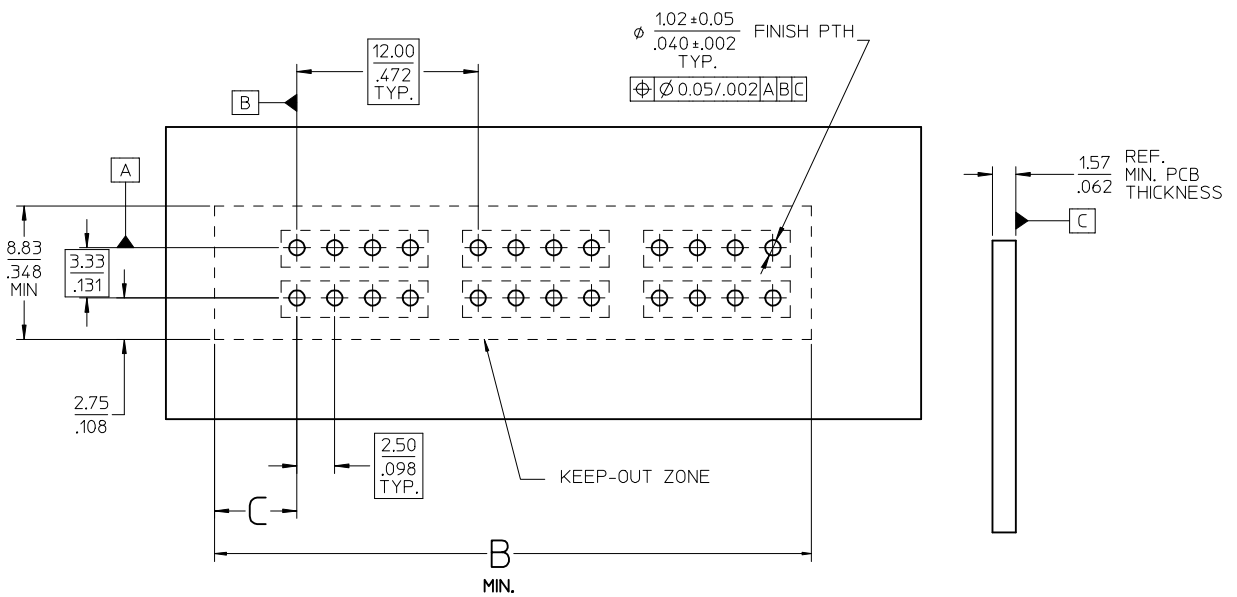

PCB COMPONENT SIDE
 SCALE 4:1

SEE SHEET 1 IEC NO: UCP2016-2607 DRAWINGS 2015/12/24 CHKD: JCOMERC I APPR: BPI SZCZOR 2016/01/20	QUALITY SYMBOLS	GENERAL TOLERANCES (UNLESS SPECIFIED)	DIMENSION STYLE	SCALE	DESIGN UNITS	THIRD ANGLE PROJECTION
	▽=0	mm INCH	IN/MM	3:1	INCH	☉
	▽=0	4 PLACES ± --- ± ---	DRAWN BY DATE	TITLE	LPH VERTICAL RECEPTACLE POWER ASSEMBLY	
	▽=0	3 PLACES ± --- ± .010	CHECKED BY DATE	2 CKT-14 CKT, PRESS-FIT		
	▽=0	2 PLACES ± 0.25 ± ---	APPROVED BY DATE	molex		
		1 PLACE ± --- ± ---	JCOMERC I 2009/12/03	DOCUMENT NO.	SD-46112-200	
		0 PLACE ± --- ± ---	MATERIAL NO.	SHEET NO.		2 OF 2
		ANGULAR ±1/2°	SEE CHART			
		DRAFT WHERE APPLICABLE MUST REMAIN WITHIN DIMENSIONS	THIS DRAWING CONTAINS INFORMATION THAT IS PROPRIETARY TO MOLEX INCORPORATED AND SHOULD NOT BE USED WITHOUT WRITTEN PERMISSION			