



Chipsmall Limited consists of a professional team with an average of over 10 year of expertise in the distribution of electronic components. Based in Hongkong, we have already established firm and mutual-benefit business relationships with customers from,Europe,America and south Asia,supplying obsolete and hard-to-find components to meet their specific needs.

With the principle of “Quality Parts,Customers Priority,Honest Operation,and Considerate Service”,our business mainly focus on the distribution of electronic components. Line cards we deal with include Microchip,ALPS,ROHM,Xilinx,Pulse,ON,Everlight and Freescale. Main products comprise IC,Modules,Potentiometer,IC Socket,Relay,Connector.Our parts cover such applications as commercial,industrial, and automotives areas.

We are looking forward to setting up business relationship with you and hope to provide you with the best service and solution. Let us make a better world for our industry!



Contact us

Tel: +86-755-8981 8866 Fax: +86-755-8427 6832

Email & Skype: info@chipsmall.com Web: www.chipsmall.com

Address: A1208, Overseas Decoration Building, #122 Zhenhua RD., Futian, Shenzhen, China



PART NUMBER	NUMBER OF WIRE OPENINGS	CIRCUIT POSITION	WIRE SIZE(S) SEE NOTE 6	WIRE HOLE DIAMETER
46396-5201	3	1, 2, 3	16 AWG	2.34/.092
46396-5202	2	4, 5	10 AWG	4.46/.176
46396-5203	3	3, 4, 5	16 AWG	2.74/.108
46396-5204	3	1, 2, 3	12 AWG	3.92/.154
46396-5205	3	1, 2, 3	10 AND 12 AWG	(214,34/.172 114,74/.188)
46396-5211	3	1, 2, 3	16 AWG	2.74/.108
46396-5231	5	1, 2, 3, 4, 5	12 AWG	4.00/.158

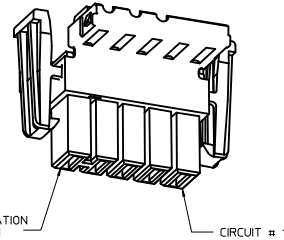
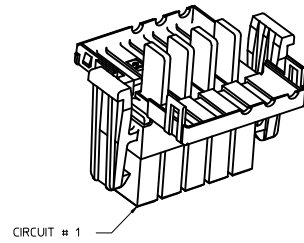

- NOTES:
1. MATERIAL: PBT OR EQUIVALENT, 94V-0. COLOR: BLACK
 2. HOUSING ACCEPTS MOLEX TERMINAL SERIES: 44262-4**** (SEE MOLEX DRAWING NUMBER SD-44262-001 FOR TERMINAL OPTIONS)
 3. HOUSING AND ASSOCIATED COMPONENTS ARE RoHS COMPLIANT
 4. PACKAGED PER MOLEX PACKAGING SPEC: PK-46396-****
 5. RECEPTACLE HOUSING MATES WITH PLUG HOUSING 46394-5001 (SEE MOLEX DRAWING NUMBER SD-46394-001 FOR DETAILS)
 6. FINAL FIT OF WIRE THRU WIRE OPENINGS WILL DEPEND ON THE OUTSIDE DIAMETER OF THE WIRE.

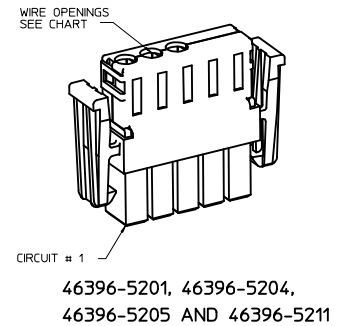
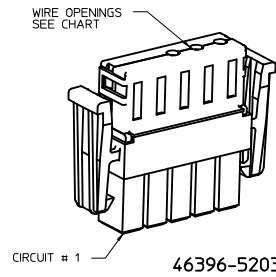
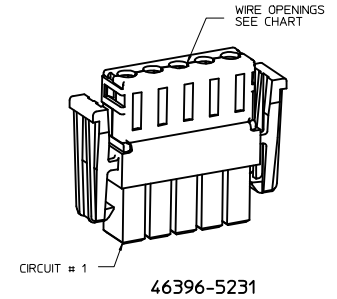
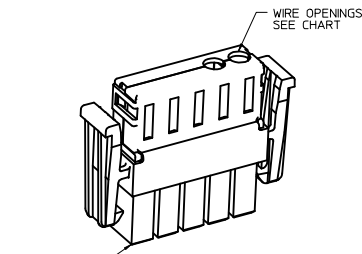
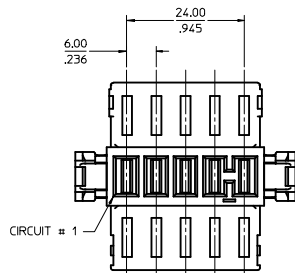
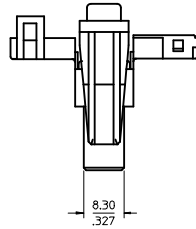
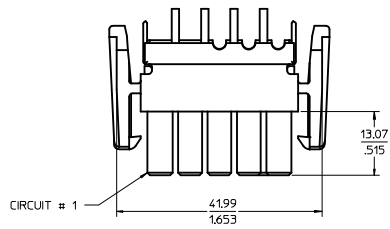
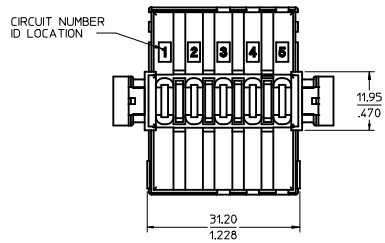

WIRE OPENING CONFIGURATIONS
CONNECTORS SHOWN CLOSED

ADD PART NOS TO CHG EC NO: UCP2009-0623 DRAWN DATA: 2008/09/23 CHYK: 2008/09/23 APPR: JCOMERCL APPR: 2008/10/03	QUALITY SYMBOLS	GENERAL TOLERANCES (UNLESS SPECIFIED)	DIMENSION STYLE	SCALE	DESIGN UNITS	THIRD ANGLE PROJECTION
	▽=0	mm INCH	MM/IN	2:1	METRIC	⊙ □
	▽=0	4 PLACES ± --- ± --- 3 PLACES ± --- ± .005 2 PLACES ± 0.13 ± .010 1 PLACE ± 0.25 ± --- ANGULAR ±1/2°	DRAWN BY DATE MATA 07-10-07 CHECKED BY DATE MATA 2007/01/15 APPROVED BY DATE APATEL 2007/01/15	TITLE	RECEPTACLE HOUSING 5 POSITION WITH LATCH POWER CONNECTOR	
	▽=0	DRAFT WHERE APPLICABLE MUST REMAIN WITHIN DIMENSIONS	MATERIAL NO. SEE CHART	DOCUMENT NO.	MOLEX INCORPORATED SD-46396-101	
SHEET NO. 1 OF 1		THIS DRAWING CONTAINS INFORMATION THAT IS PROPRIETARY TO MOLEX INCORPORATED AND SHOULD NOT BE USED WITHOUT WRITTEN PERMISSION				