



Chipsmall Limited consists of a professional team with an average of over 10 year of expertise in the distribution of electronic components. Based in Hongkong, we have already established firm and mutual-benefit business relationships with customers from,Europe,America and south Asia,supplying obsolete and hard-to-find components to meet their specific needs.

With the principle of “Quality Parts,Customers Priority,Honest Operation,and Considerate Service”,our business mainly focus on the distribution of electronic components. Line cards we deal with include Microchip,ALPS,ROHM,Xilinx,Pulse,ON,Everlight and Freescale. Main products comprise IC,Modules,Potentiometer,IC Socket,Relay,Connector.Our parts cover such applications as commercial,industrial, and automotives areas.

We are looking forward to setting up business relationship with you and hope to provide you with the best service and solution. Let us make a better world for our industry!



Contact us

Tel: +86-755-8981 8866 Fax: +86-755-8427 6832

Email & Skype: info@chipsmall.com Web: www.chipsmall.com

Address: A1208, Overseas Decoration Building, #122 Zhenhua RD., Futian, Shenzhen, China



KIT PART NUMBER	HOUSING No.	TPA No.
46408-1200	46408-0003	46549-0001

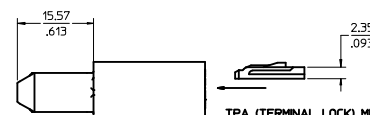
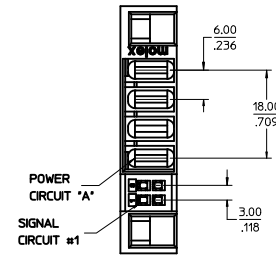
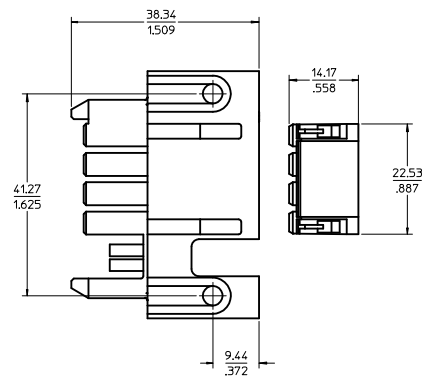
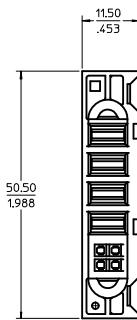

TPA (TERMINAL LOCK) MUST BE PUSHED IN FIRMLY TO LOCK TERMINALS IN PLACE

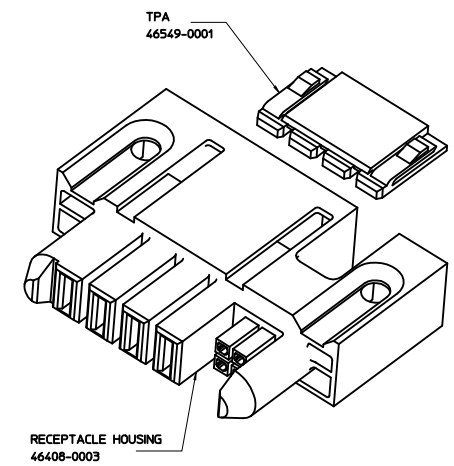

REPLACING PART NO.
46408-0001

- NOTES:
1. MATERIAL: PBT OR EQUIVALENT, 94V-0. COLOR: BLACK.
 2. HOUSING ACCEPTS MOLEX TERMINALS: 44262-4532 (POWER) AND 43030-0001 (SIGNAL). NOT SHOWN. SOLD SEPARATELY
 3. HOUSING DESIGNED FOR M3.5 FLAT HEAD SCREWS SUPPLIED BY CUSTOMER.
 4. RECEPTACLE MATES WITH PLUG HOUSING 46409-0003.
 5. RECEPTACLE REQUIRES INCLUDED POWER TERMINAL LOCK (TPA) 46549-0001, ALSO AVAILABLE SEPARATELY.
 6. HOUSING AND ASSOCIATED COMPONENTS ARE ROHS COMPLIANT.
 7. PACKAGED PER MOLEX PACKAGING SPEC: PK-46408-***

REV	DESCRIPTION	QUALITY SYMBOLS	GENERAL TOLERANCES (UNLESS SPECIFIED)		DIMENSION STYLE	SCALE	DESIGN UNITS	THIRD ANGLE PROJECTION
			mm	INCH	MM/IN	1:1	METRIC	☉
4	PLACES	±	---	±	---	SBGIEL	DATE	TITLE
3	PLACES	±	---	±	.010	SBGIEL	DATE	RECEPTACLE HOUSING AND TPA KIT
2	PLACES	±	0.25	±	---	SBGIEL	DATE	4 CKT POWER AND SIGNAL
1	PLACE	±	---	±	---	APATEL	DATE	MOLEX INCORPORATED
			ANGULAR ± 2 °					
DRAFT WHERE APPLICABLE MUST REMAIN WITHIN DIMENSIONS					MATERIAL NO.	DATE	DOCUMENT NO.	SHEET NO.
					46408-1200	2011/10/28	SD-46408-1200	1 OF 1
THIS DRAWING CONTAINS INFORMATION THAT IS PROPRIETARY TO MOLEX INCORPORATED AND SHOULD NOT BE USED WITHOUT WRITTEN PERMISSION								