



Chipsmall Limited consists of a professional team with an average of over 10 year of expertise in the distribution of electronic components. Based in Hongkong, we have already established firm and mutual-benefit business relationships with customers from,Europe,America and south Asia,supplying obsolete and hard-to-find components to meet their specific needs.

With the principle of “Quality Parts,Customers Priority,Honest Operation,and Considerate Service”,our business mainly focus on the distribution of electronic components. Line cards we deal with include Microchip,ALPS,ROHM,Xilinx,Pulse,ON,Everlight and Freescale. Main products comprise IC,Modules,Potentiometer,IC Socket,Relay,Connector.Our parts cover such applications as commercial,industrial, and automotives areas.

We are looking forward to setting up business relationship with you and hope to provide you with the best service and solution. Let us make a better world for our industry!



## Contact us

Tel: +86-755-8981 8866 Fax: +86-755-8427 6832

Email & Skype: info@chipsmall.com Web: www.chipsmall.com

Address: A1208, Overseas Decoration Building, #122 Zhenhua RD., Futian, Shenzhen, China



10 9 8 7 6 5 4 3 2 1

F

E

D

C

B

A

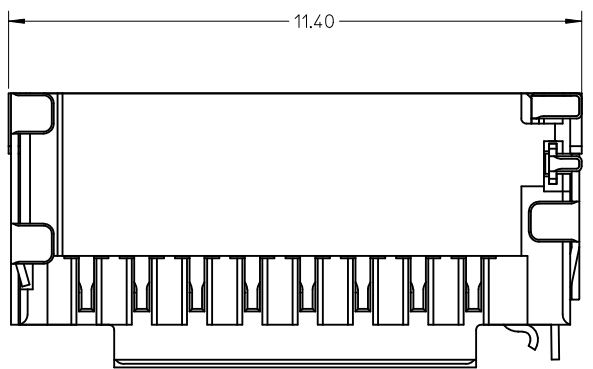
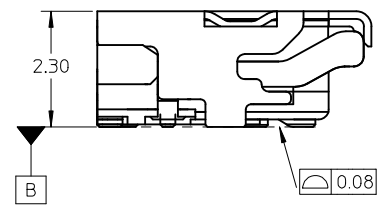
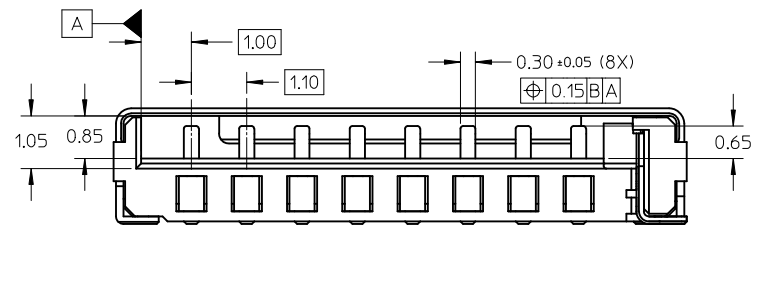
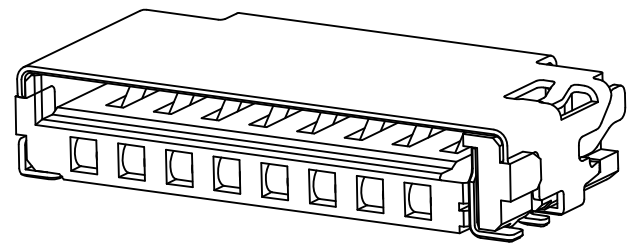
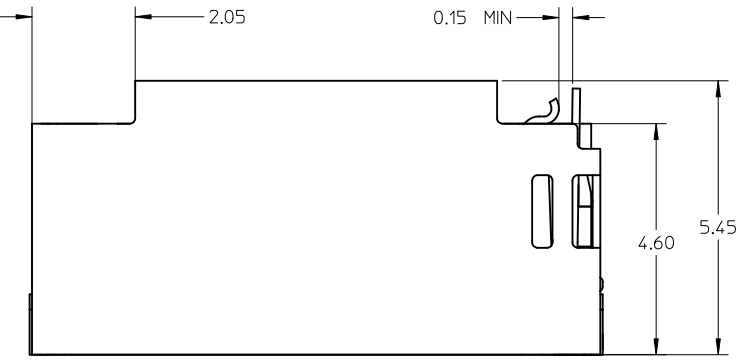

NOTES:

1. MATERIAL:
  - 1-1 HOUSING: LCP, 30% G/F, UL 94V-0, BLACK
  - 1-2 SIGNAL TERMINAL AND DETECT TERMINAL: PHOSPHOR BRONZE
  - 1-3 METAL SHELL: STAINLESS STEEL
2. FINISH:
  - 2-1 SIGNAL TERMINAL: 1.25 MICRON NICKEL MIN UNDER-PLATED, CONTACT AREA SEE TABLE, GOLD FLASH ON SOLDER AREA.
  - 2-2 METAL SHELL: GOLD FLASH OVER NICKEL ON SOLDER AREA.
  - 2-3 DETECT PIN: 1.25 MICRON NICKEL MIN UNDER-PLATED GOLD FLASH PLATED ON CONTACT AREA, TIN PLATED ON SOLDER AREA.
3. PRODUCT SPECIFICATION: PS-47309-001.
4. PACKAGE SPECIFICATION: PK-47571-001.
5. PRODUCT COMPLIANT TO RoHS DIRECTIVE 2002/95/EC AND ELV 2000/53/EC.

47571-0101	0.38 MICRON MIN. GOLD PLATING
47571-0001	0.76 MICRON MIN. GOLD PLATING
47571-2001	0.1 MICRON MIN. GOLD PLATING
P/N	CONTACT AREA PLATING

ADD PART NUMBER EC NO: SH2012-0261 DRWG: GLLI CHKD: APPR: AYIN REV	2012/02/10 2012/02/23	QUALITY SYMBOLS $F_A=0$ $F_C=0$ $F_D=0$	GENERAL TOLERANCES (UNLESS SPECIFIED)		DIMENSION STYLE MM ONLY		SCALE 1:1	DESIGN UNITS METRIC	THIRD ANGLE PROJECTION	
				4 PLACES ± --- ± --- 3 PLACES ± --- ± --- 2 PLACES ± 0.15 ± --- 1 PLACE ± 0.25 ± ---	mm INCH	DRAWN BY GLLI	DATE 2012/02/10	TFR HEADER WITH DETECT PIN		
				ANGULAR ± 3 °		CHECKED BY XQ ZHANG	DATE 2012/02/10			
				DRAFT WHERE APPLICABLE MUST REMAIN WITHIN DIMENSIONS	SEE TABLE		APPROVED BY AYIN	DATE 2012/02/23	MOLEX INCORPORATED	
					MATERIAL NO.	DOCUMENT NO.	SD-47571-001		SHEET NO. 1 OF 2	

9 8 7 6 5 4 3 2 1

10 9 8 7 6 5 4 3 2 1

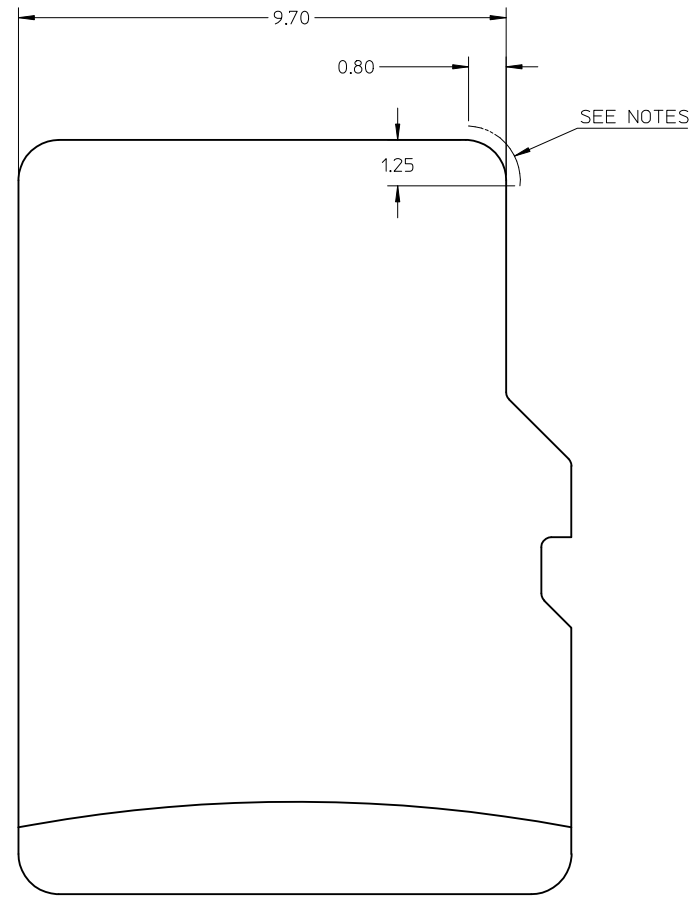
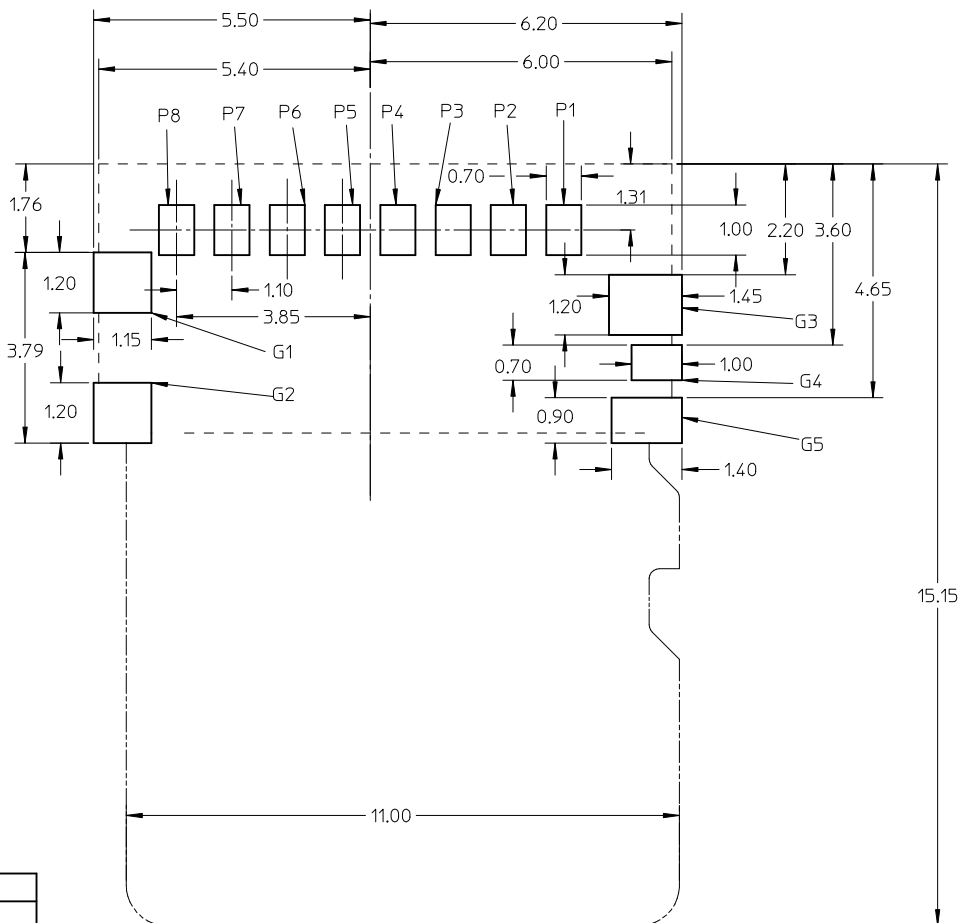

G5	DET
G4	POL
G3	GND
G2	GND
G1	GND
P8	DAT1
P7	DAT0
P6	VSS
P5	CLK
P4	VDD
P3	CMD
P2	CD/DAT3
P1	DAT2
NAME	TYPE
PIN ASSIGNMENT	

----- CONNECTOR PROFILE  
 - - - - - CARD PROFILE

NOTES:  
 NO CONDUCTIVE EXPOSURE TRACE IS ALLOWED ON THE SIDE FACE OF THE CARD AT THIS AREA.

G5	DET
G4	POL
G3	GND
G2	GND
G1	GND
P8	DAT1
P7	DAT0
P6	VSS
P5	CLK
P4	VDD
P3	CMD
P2	CD/DAT3
P1	DAT2
NAME	TYPE
PIN ASSIGNMENT	

<b>SEE SHEET 1</b> EC NO: SH2012-0261 DRW:GLL1 CHKD: APPR:AYIN	2012/02/10 2012/02/23 DESCRIPTION REV	QUALITY SYMBOLS	GENERAL TOLERANCES (UNLESS SPECIFIED)	DIMENSION STYLE	SCALE	DESIGN UNITS	THIRD ANGLE PROJECTION															
		$\nabla = 0$ $\nabla = 0$ $\nabla = 0$	<table border="1"> <tr><th></th><th>mm</th><th>INCH</th></tr> <tr><td>4 PLACES</td><td>± ---</td><td>± ---</td></tr> <tr><td>3 PLACES</td><td>± ---</td><td>± ---</td></tr> <tr><td>2 PLACES</td><td>± 0.15</td><td>± ---</td></tr> <tr><td>1 PLACE</td><td>± 0.25</td><td>± ---</td></tr> </table>		mm	INCH	4 PLACES	± ---	± ---	3 PLACES	± ---	± ---	2 PLACES	± 0.15	± ---	1 PLACE	± 0.25	± ---	MM ONLY	1:1	METRIC	
			mm	INCH																		
		4 PLACES	± ---	± ---																		
3 PLACES	± ---	± ---																				
2 PLACES	± 0.15	± ---																				
1 PLACE	± 0.25	± ---																				
	ANGULAR ± 3 °	<table border="1"> <tr><td>DRAWN BY</td><td>DATE</td><td>TITLE</td></tr> <tr><td>GLL1</td><td>2012/02/10</td><td rowspan="3">TFR HEADER WITH DETECT PIN</td></tr> <tr><td>CHECKED BY</td><td>DATE</td></tr> <tr><td>XQ ZHANG</td><td>2012/02/10</td></tr> <tr><td>APPROVED BY</td><td>DATE</td><td></td></tr> <tr><td>AYIN</td><td>2012/02/23</td><td></td></tr> </table>	DRAWN BY	DATE	TITLE	GLL1	2012/02/10	TFR HEADER WITH DETECT PIN	CHECKED BY	DATE	XQ ZHANG	2012/02/10	APPROVED BY	DATE		AYIN	2012/02/23					
DRAWN BY	DATE	TITLE																				
GLL1	2012/02/10	TFR HEADER WITH DETECT PIN																				
CHECKED BY	DATE																					
XQ ZHANG	2012/02/10																					
APPROVED BY	DATE																					
AYIN	2012/02/23																					
	DRAFT WHERE APPLICABLE MUST REMAIN WITHIN DIMENSIONS	SEE SHEET 1	<table border="1"> <tr><td>MATERIAL NO.</td><td>DOCUMENT NO.</td><td>SHEET NO.</td></tr> <tr><td></td><td>SD-47571-001</td><td>2 OF 2</td></tr> </table>	MATERIAL NO.	DOCUMENT NO.	SHEET NO.		SD-47571-001	2 OF 2													
MATERIAL NO.	DOCUMENT NO.	SHEET NO.																				
	SD-47571-001	2 OF 2																				

9 8 7 6 5 4 3 2 1

10 9 8 7 6 5 4 3 2 1

F

E

D

C

B

A

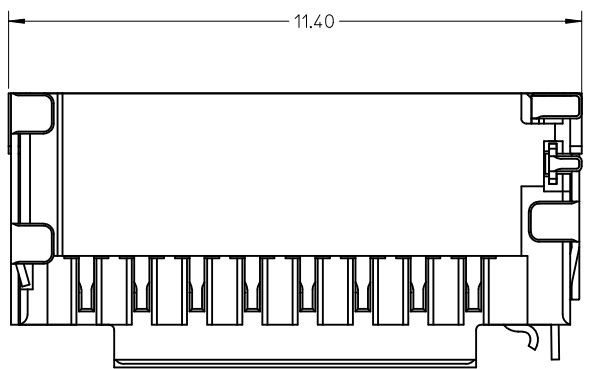
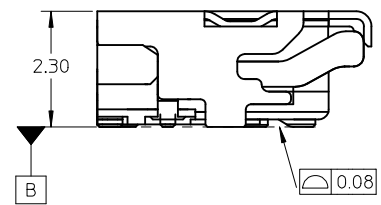
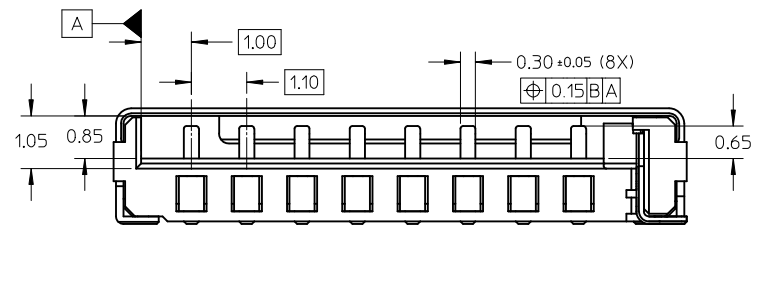
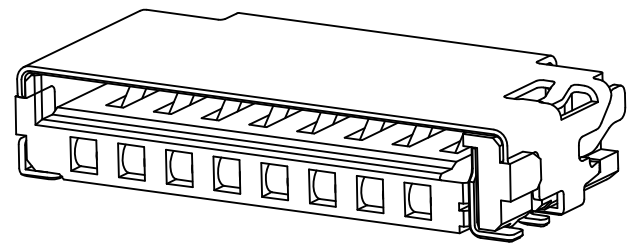
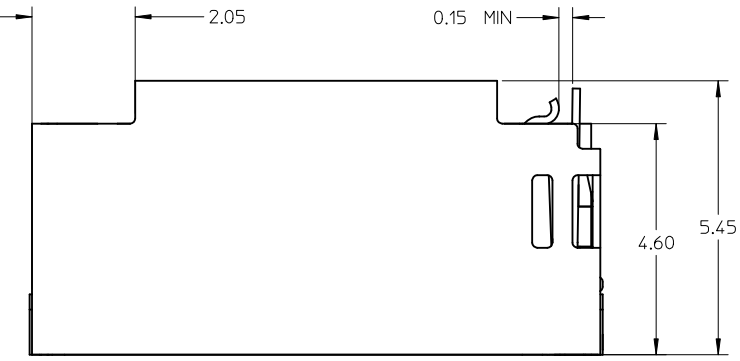

NOTES:

1. MATERIAL:
  - 1-1 HOUSING: LCP, 30% G/F, UL 94V-0, BLACK
  - 1-2 SIGNAL TERMINAL AND DETECT TERMINAL: PHOSPHOR BRONZE
  - 1-3 METAL SHELL: STAINLESS STEEL
2. FINISH:
  - 2-1 SIGNAL TERMINAL: 1.25 MICRON NICKEL MIN UNDER-PLATED, CONTACT AREA SEE TABLE, GOLD FLASH ON SOLDER AREA.
  - 2-2 METAL SHELL: GOLD FLASH OVER NICKEL ON SOLDER AREA.
  - 2-3 DETECT PIN: 1.25 MICRON NICKEL MIN UNDER-PLATED GOLD FLASH PLATED ON CONTACT AREA, TIN PLATED ON SOLDER AREA.
3. PRODUCT SPECIFICATION: PS-47309-001.
4. PACKAGE SPECIFICATION: PK-47571-001.
5. PRODUCT COMPLIANT TO RoHS DIRECTIVE 2002/95/EC AND ELV 2000/53/EC.

47571-0101	0.38 MICRON MIN. GOLD PLATING
47571-0001	0.76 MICRON MIN. GOLD PLATING
P/N	CONTACT AREA PLATING

ADD PART NUMBER EC NO: SH2011-0368 DRWN: XQZHANG CHKD: GLLI APPR: XJSONG	DESCRIPTION 2011/09/02 2011/09/07 2011/09/13	QUALITY SYMBOLS	GENERAL TOLERANCES (UNLESS SPECIFIED)		DIMENSION STYLE MM ONLY		SCALE 1:1	DESIGN UNITS METRIC	THIRD ANGLE PROJECTION	
		$F_A=0$	mm	INCH	DRAWN BY IVAN HE	DATE 2007/06/12	TITLE TFR HEADER W/DETECT PIN			
		$F_C=0$	4 PLACES ± --- ± ---	3 PLACES ± --- ± ---	CHECKED BY XIXU	DATE 2007/06/12	MOLEX INCORPORATED DOCUMENT NO. SD-47571-001 SHEET NO. 1 OF 2			
		$F_D=0$	2 PLACES ± 0.15 ± ---	1 PLACE ± 0.25 ± ---	APPROVED BY JNCHEN	DATE 2007/06/12				
	ANGULAR ± 1 °	DRAFT WHERE APPLICABLE MUST REMAIN WITHIN DIMENSIONS		MATERIAL NO. SEE TABLE		THIS DRAWING CONTAINS INFORMATION THAT IS PROPRIETARY TO MOLEX INCORPORATED AND SHOULD NOT BE USED WITHOUT WRITTEN PERMISSION				

9 8 7 6 5 4 3 2 1

10 9 8 7 6 5 4 3 2 1

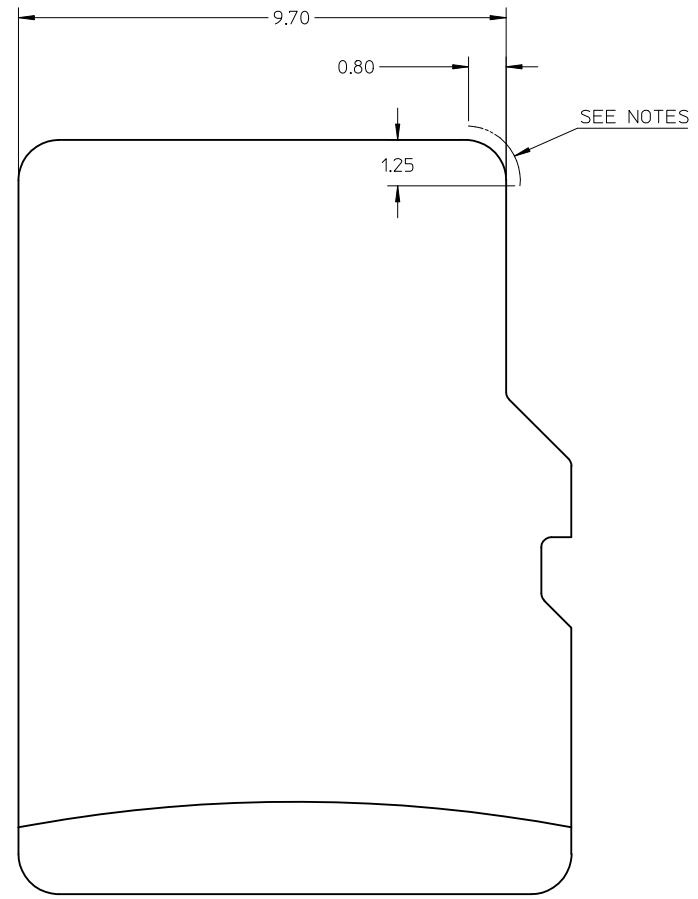
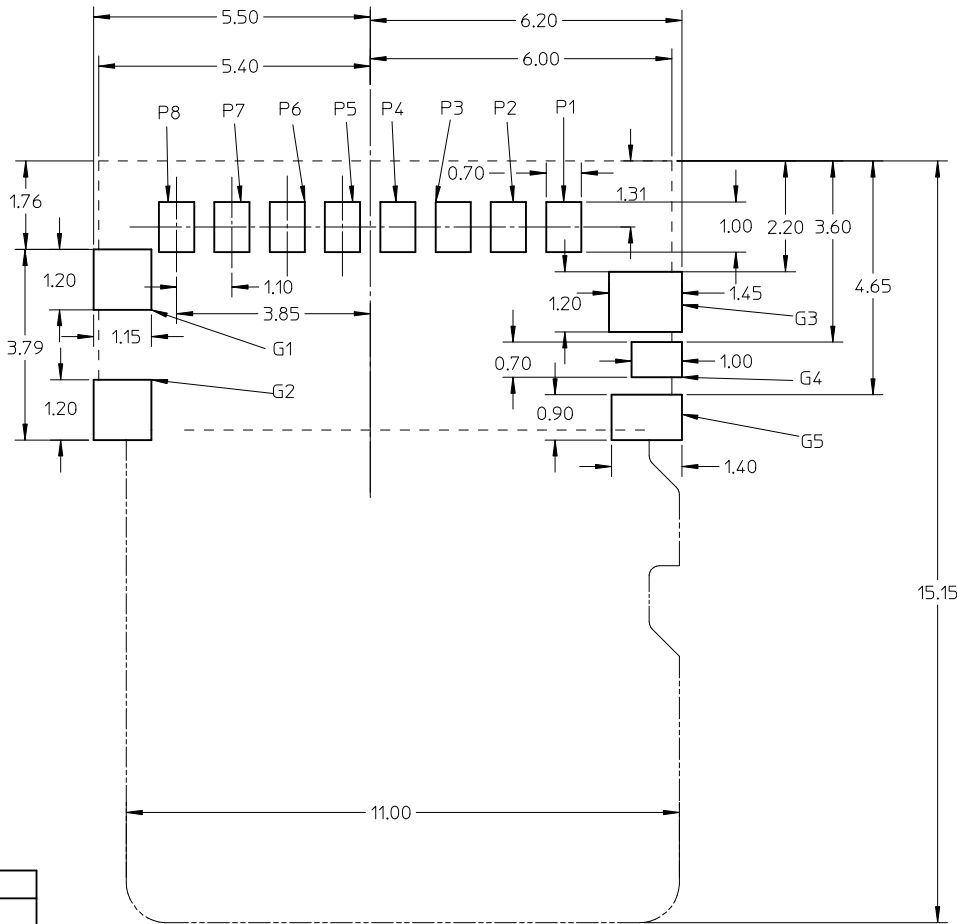

G5	DET
G4	POL
G3	GND
G2	GND
G1	GND
P8	DAT1
P7	DAT0
P6	VSS
P5	CLK
P4	VDD
P3	CMD
P2	CD/DAT3
P1	DAT2
NAME	TYPE
PIN ASSIGNMENT	

----- CONNECTOR PROFILE  
 ..... CARD PROFILE

NOTES:  
 NO CONDUCTIVE EXPOSURE TRACE IS ALLOWED ON THE SIDE FACE OF THE CARD AT THIS AREA.

G5	DET
G4	POL
G3	GND
G2	GND
G1	GND
P8	DAT1
P7	DAT0
P6	VSS
P5	CLK
P4	VDD
P3	CMD
P2	CD/DAT3
P1	DAT2
NAME	TYPE
PIN ASSIGNMENT	

SEE SHEET 1	EC NO: SH2011-0368	2011/09/02	QUALITY SYMBOLS
	DRWN: XZHANG	2011/09/07	
	CHKD: GLLI	2011/09/13	
	APPR: XJSONG	2011/09/13	
D	DESCRIPTION		

GENERAL TOLERANCES (UNLESS SPECIFIED)	
	mm
4 PLACES	± 0.15
3 PLACES	± 0.25
2 PLACES	± 0.30
1 PLACE	± 0.40
ANGULAR ± 1°	
DRAFT WHERE APPLICABLE MUST REMAIN WITHIN DIMENSIONS	

DIMENSION STYLE	
MM ONLY	
DRAWN BY	DATE
IVAN HE	2007/06/12
CHECKED BY	DATE
XIXU	2007/06/12
APPROVED BY	DATE
JNCHEN	2007/06/12
MATERIAL NO.	
SEE SHEET 1	
SIZE	A3

SCALE	DESIGN UNITS	THIRD ANGLE PROJECTION
1:1	METRIC	
TITLE		
TFR HEADER W/DETECT PIN		
MOLEX INCORPORATED		SHEET NO.
DOCUMENT NO.		2 OF 2
SD-47571-001		
THIS DRAWING CONTAINS INFORMATION THAT IS PROPRIETARY TO MOLEX INCORPORATED AND SHOULD NOT BE USED WITHOUT WRITTEN PERMISSION		

9 8 7 6 5 4 3 2 1