



Chipsmall Limited consists of a professional team with an average of over 10 year of expertise in the distribution of electronic components. Based in Hongkong, we have already established firm and mutual-benefit business relationships with customers from,Europe,America and south Asia,supplying obsolete and hard-to-find components to meet their specific needs.

With the principle of “Quality Parts,Customers Priority,Honest Operation,and Considerate Service”,our business mainly focus on the distribution of electronic components. Line cards we deal with include Microchip,ALPS,ROHM,Xilinx,Pulse,ON,Everlight and Freescale. Main products comprise IC,Modules,Potentiometer,IC Socket,Relay,Connector.Our parts cover such applications as commercial,industrial, and automotives areas.

We are looking forward to setting up business relationship with you and hope to provide you with the best service and solution. Let us make a better world for our industry!



Contact us

Tel: +86-755-8981 8866 Fax: +86-755-8427 6832

Email & Skype: info@chipsmall.com Web: www.chipsmall.com

Address: A1208, Overseas Decoration Building, #122 Zhenhua RD., Futian, Shenzhen, China



10 9 8 7 6 5 4 3 2 1

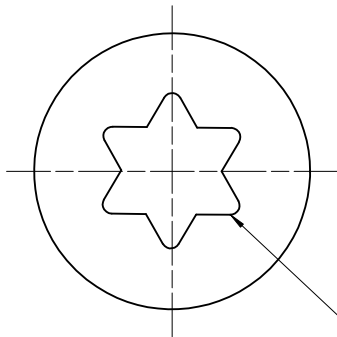

6 POINT T-20 TORX DRIVE

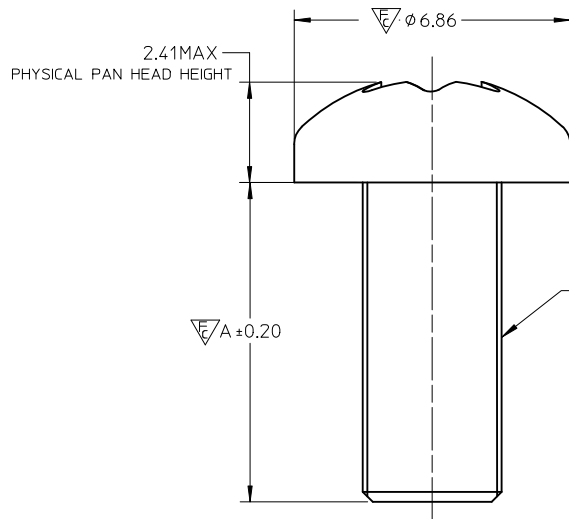
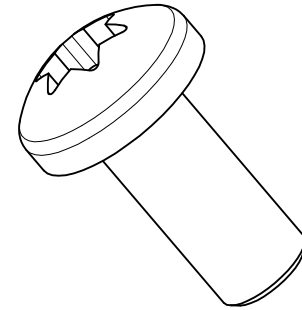

6-32 UNC-2B THREAD

NOTES:

1. MATERIAL: LOW CARBON STEEL.
MIN HARDNESS-ROCKWELL HARDNESS B70.
2. PLATING: 2 MICRON MINIMUM ELECTROLYTIC NICKEL.
PROCESS TEST: 48 HOURS AT 85°C/85% HUMIDITY WITH NO VISIBLE CORROSION.
3. REMOVE ALL BURRS OR SHARP EDGES AROUND PERIMETER OF PART.
SHARPNESS OF EDGES SUBJECT TO HANDLING ARE REQUIRED TO MEET UL1439 TEST.
4. PART SHALL BE DEGREASED AND FREE OF OIL AND DIRT MARKS.
5. THE PART IS COMPLAINT TO RoHS DIRECTIVE 2002/95/EC AND ELV DIRECTIVE 2000/53/EC.

47597-6202	5.60
47597-6102	5.17
47597-6002	6.35
MATERIAL NUMBER	DIM A

ENTER DESCRIPTION EC NO: SH2011-0332 DRWN: ZHANG11 CHKD: APPR: AYIN A2	DESCRIPTION 2011/04/22 2011/06/16	QUALITY SYMBOLS <div><div>F_A=0</div><div>F_C=2</div><div>F_P=0</div></div>	GENERAL TOLERANCES (UNLESS SPECIFIED)		DIMENSION STYLE MM ONLY		SCALE 6:1	DESIGN UNITS METRIC	THIRD ANGLE PROJECTION			
			<div><div>mm</div><div>INCH</div></div>		DRAWN BY	DATE	TITLE SCR,PAN,T20,6X30,H/16"L					
					CHECKED BY	DATE						
			4 PLACES ± --- ± ---		APPROVED BY		DATE	MOLEX INCORPORATED				
			3 PLACES ± --- ± ---		WFDENG		2010/07/09					
			2 PLACES ± 0.15 ± ---		MATERIAL NO.		DOCUMENT NO.		SHEET NO.			
			1 PLACE ± 0.25 ± ---		SEE TABLE		SD-47597-012		1 OF 1			
			ANGULAR ± 1 °		SIZE A3		THIS DRAWING CONTAINS INFORMATION THAT IS PROPRIETARY TO MOLEX INCORPORATED AND SHOULD NOT BE USED WITHOUT WRITTEN PERMISSION					
			DRAFT WHERE APPLICABLE MUST REMAIN WITHIN DIMENSIONS									

9 8 7 6 5 4 3 2 1