



Chipsmall Limited consists of a professional team with an average of over 10 year of expertise in the distribution of electronic components. Based in Hongkong, we have already established firm and mutual-benefit business relationships with customers from,Europe,America and south Asia,supplying obsolete and hard-to-find components to meet their specific needs.

With the principle of “Quality Parts,Customers Priority,Honest Operation,and Considerate Service”,our business mainly focus on the distribution of electronic components. Line cards we deal with include Microchip,ALPS,ROHM,Xilinx,Pulse,ON,Everlight and Freescale. Main products comprise IC,Modules,Potentiometer,IC Socket,Relay,Connector.Our parts cover such applications as commercial,industrial, and automotives areas.

We are looking forward to setting up business relationship with you and hope to provide you with the best service and solution. Let us make a better world for our industry!



## Contact us

Tel: +86-755-8981 8866 Fax: +86-755-8427 6832

Email & Skype: info@chipsmall.com Web: www.chipsmall.com

Address: A1208, Overseas Decoration Building, #122 Zhenhua RD., Futian, Shenzhen, China



DWG. NO.  
SD-49511-001

SIMILAR ITEM

PROJECT NO.

B

DO NOT SCALE DRAWING  
DIMENSION IN METRIC

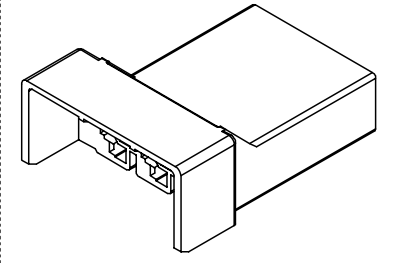
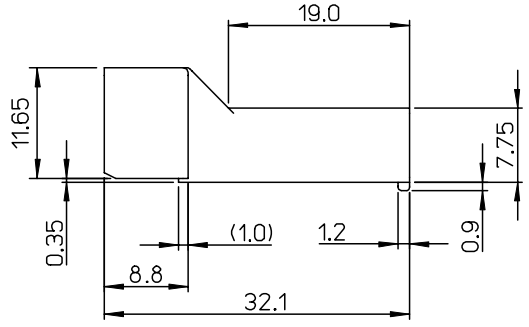
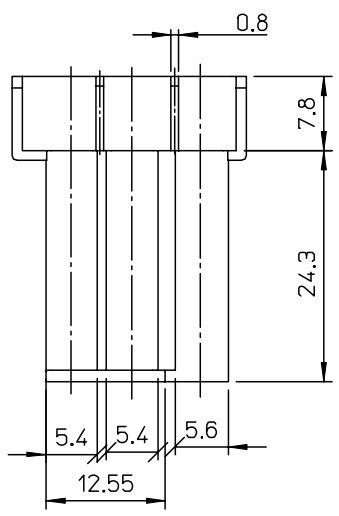
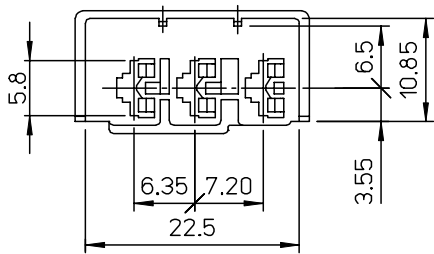
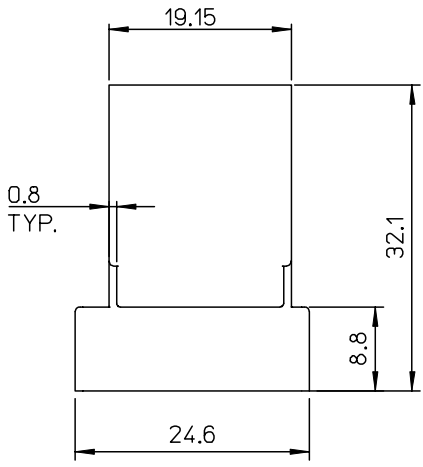

ISOMETRIC VIEW

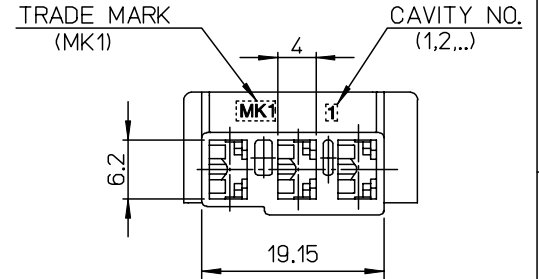

NOTES

- MATERIAL : POLYAMIDE6(UL94V-0, UNFILLED G/F)  
BLACK COLOR,  
(GLOW WIRE CAPABLE HAVING AN IEC GWIT & GWFI RATING OF 960 DEGREES C  
AT 0.75mm WALL THICKNESS)
- APPLICABLE TERMINAL : 35068-9\*\*2

NEW RELEASED ECN NO. KOR2005-0062 DRWN: JB.JIN 04/10/01 CHK: W.Y.YANG APPR: CW.LEE	QUALITY SYMBOLS MAJOR $\blacktriangledown = 0$ CRITICAL $\nabla = 0$	GENERAL TOLERANCES: (UNLESS SPECIFIED)		SCALE 1:1	DESIGN UNITS <input checked="" type="checkbox"/> mm <input type="checkbox"/> INCH	THIRD ANGLE PROJECTION	DIMENSIONS: <input type="checkbox"/> mm <input type="checkbox"/> INCH <input checked="" type="checkbox"/> mm ONLY		SHT	REV	
		4 PLACES	$\pm 0.$	$\pm -$	DRAWN BY & DATE C.B.CHIN 04/07/02		TITLE: .187 MP-LCOK HOUSING-3P (FOR DOOR S/W)				
		3 PLACES	$\pm 0.$	$\pm -$	CHECKED BY & DATE W.Y.YANG 04/07/02						
		2 PLACES	$\pm 0.25$	$\pm -$	APPROVED BY & DATE C.W.LEE 04/07/02		MOLEX INCORPORATED		SHEET NO. 1 OF 1		
1 PLACE	$\pm 0.30$	$\pm -$	ANGULAR: $\pm 1^\circ$		CAD FILENAME E495000301.MO	MATERIAL NO. 495110301	DRAWING NO. SD-49511-001	SIZE B			
A	REV	DRAFT WHERE APPLICABLE MUST REMAIN WITHIN DIMENSIONS				THIS DRAWING CONTAINS INFORMATION THAT IS PROPRIETARY TO MOLEX INCORPORATED AND SHOULD NOT BE USED WITHOUT WRITTEN PERMISSION.				KOREA	MX-A3