



Chipsmall Limited consists of a professional team with an average of over 10 year of expertise in the distribution of electronic components. Based in Hongkong, we have already established firm and mutual-benefit business relationships with customers from,Europe,America and south Asia,supplying obsolete and hard-to-find components to meet their specific needs.

With the principle of "Quality Parts,Customers Priority,Honest Operation,and Considerate Service",our business mainly focus on the distribution of electronic components. Line cards we deal with include Microchip,ALPS,ROHM,Xilinx,Pulse,ON,Everlight and Freescale. Main products comprise IC,Modules,Potentiometer,IC Socket,Relay,Connector.Our parts cover such applications as commercial,industrial, and automotives areas.

We are looking forward to setting up business relationship with you and hope to provide you with the best service and solution. Let us make a better world for our industry!



## Contact us

Tel: +86-755-8981 8866 Fax: +86-755-8427 6832

Email & Skype: info@chipsmall.com Web: www.chipsmall.com

Address: A1208, Overseas Decoration Building, #122 Zhenhua RD., Futian, Shenzhen, China



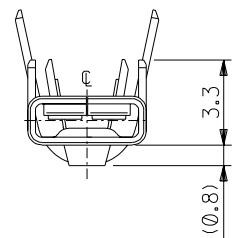
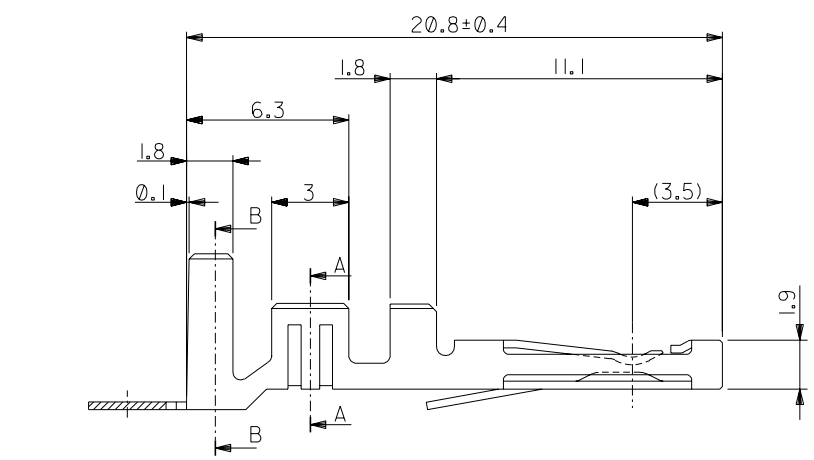
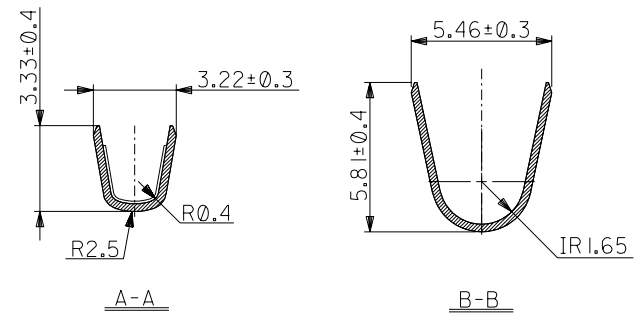
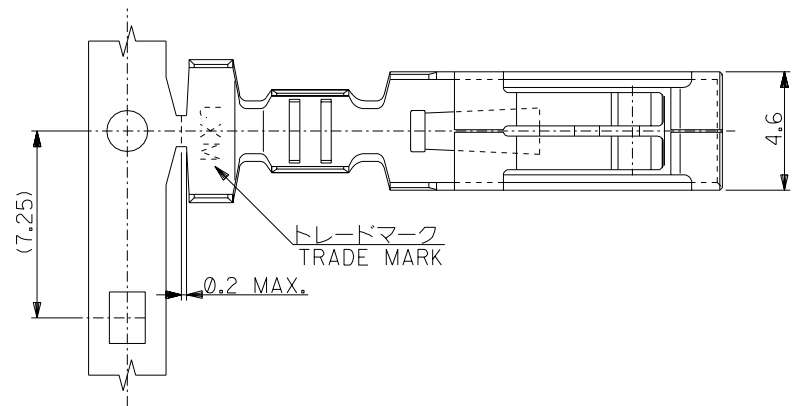

注記)  
NOTES:

1. 材質  
MATERIAL  
銅合金 (板厚: 0.3)  
COPPER ALLOY (THICKNESS: 0.3)
2. メッキ仕様  
TERMINAL PLATING  
接点部 : 金メッキ 0.1μm MIN.  
CONTACT AREA : GOLD 0.1 MICROMETER MINIMUM.  
パラジウムニッケルメッキ 0.6 μm MIN.  
PALLADIUM NICKEL 0.6 MICROMETER MINIMUM.  
圧着部 : 錫メッキ 1.0 μm MIN.  
CRIMP AREA : TIN 1.0 MICROMETER MINIMUM.  
下地メッキ : ニッケルメッキ 1.5 μm MIN.  
UNDER PLATE : NICKEL 1.5 MICROMETER MINIMUM.
3. 適用電線範囲 :  
APPLICABLE WIRE RANGE :  
UL 1015 AWG\*#18~14  
UL 1865 AWG\*#16~14
4. 被覆外径 : φ 3.8 MAX.  
INSULATION EXTERNAL DIA : φ 3.8 MAX.
5. 適用ハウジングアセンブリ : 53777シリーズ  
APPLICABLE HOUSING ASS'Y : 53777 SERIES
6. 適用ハウジング : 54084-0305  
APPLICABLE HOUSING : 54084-0305
7. 本製品は50637-\*\*-49の鉛フリー品である。  
THIS PRODUCT IS LEAD FREE OF 50637-\*\*-49.

	バラ状 LOOSE	50637-0128
50637-**-28	連鎖状 CHAIN	50637-0028
MODEL No.	端子形状 TERMINAL CONFIGURATION	MATERIAL No.

角度 ANGLE	±3°	材料 MATERIAL	注記参照 SEE NOTES	材料 MATERIAL	注記参照 SEE NOTES	モレックス MOLEX-JAPAN CO.,LTD. 日本モレックス株式会社
30以上 OVER	+0.3	仕上げ FINISH	—	仕上がり FINISH	—	REVISE ONLY ON CAD SYSTEM
10以上 OVER 30 UNDER	+0.25	適用電線範囲 WIRE RANGE	注記参照 SEE NOTES	適用電線範囲 WIRE RANGE	注記参照 SEE NOTES	TITLE 名称 2mm PITCH AC/DC CONN. REC. CRIMP TERM. (MIDI DRAWER CONNECTOR)
10 UNDER	+0.2	被覆外径 INS. RANGE	注記参照 SEE NOTES	被覆外径 INS. RANGE	注記参照 SEE NOTES	(MIDI DRAWER CONNECTOR) -LEAD FREE-
一般公差 GENERAL TOLERANCES	記号 LTR	変更内容 REVISION RECORD	DR. CHK. DATE	DRAWN BY 04/05/07 H.KAWABATA	CHK'D BY 04/05/07 K.TOJO	DWG. NO. SD-50637-001
				APP'D BY 04/05/07 M.SASAO	尺度 SCALE 5:1	REV 0