



Chipsmall Limited consists of a professional team with an average of over 10 year of expertise in the distribution of electronic components. Based in Hongkong, we have already established firm and mutual-benefit business relationships with customers from,Europe,America and south Asia,supplying obsolete and hard-to-find components to meet their specific needs.

With the principle of “Quality Parts,Customers Priority,Honest Operation,and Considerate Service”,our business mainly focus on the distribution of electronic components. Line cards we deal with include Microchip,ALPS,ROHM,Xilinx,Pulse,ON,Everlight and Freescale. Main products comprise IC,Modules,Potentiometer,IC Socket,Relay,Connector.Our parts cover such applications as commercial,industrial, and automotives areas.

We are looking forward to setting up business relationship with you and hope to provide you with the best service and solution. Let us make a better world for our industry!



Contact us

Tel: +86-755-8981 8866 Fax: +86-755-8427 6832

Email & Skype: info@chipsmall.com Web: www.chipsmall.com

Address: A1208, Overseas Decoration Building, #122 Zhenhua RD., Futian, Shenzhen, China



DWG. NO. SD-51047-***00

F

D

V

C

B

DO NOT SCALE DRAWING

| | | | | |
|----------------------------------|----------------------------------|----------------------------------|----------------------------------|---|
| EC NO. DRWN: CHK: APPR: | EC NO. DRWN: CHK: APPR: | EC NO. DRWN: CHK: APPR: | EC NO. DRWN: CHK: APPR: | REDRAWN EC NO. JC2000-0629 DRWN: K.KOHAMA 000/3/28 CHK: T.YAMAGUCHI 000/3/30 APPR: M.FUKUSHIMA 000/3/30 |
| INS. RANGE 被覆外径 | WIRE RANGE 適用線径範囲 | FINISH 仕上り | MATERIAL 材料 | DESCRIPTION |
| —//— | —//— | —//— | ポリエステル POLYESTER | UL94V-0 |

| | | | | | | | |
|-----|-------------|---|---------------|--|--|-------------------------------|----------------------|
| REV | DESCRIPTION | GENERAL TOLERANCES: (UNLESS SPECIFIED) 一般公差 | SCALE 10:1 | DESIGN UNITS <input checked="" type="checkbox"/> mm <input type="checkbox"/> INCH | THIRD ANGLE PROJECTION <input type="checkbox"/> mm <input type="checkbox"/> INCH <input checked="" type="checkbox"/> mm ONLY | SHT REV | REVISION CAD ONLY |
| | | 10 UNDER 未満 | +0.2 | DRAWN BY & DATE K.KOHAMA 000/3/28 | TITLE: 1.25 W/W CONN. PLG HSG. | | |
| | | 10 OVER 以上 | +0.25 | CHECKED BY & DATE T.YAMAGUCHI 007/3/30 | | | |
| | | 30 OVER 以上 | +0.3 | APPROVED BY & DATE M.FUKUSHIMA 000/3/30 | | | |
| | | ANGLE 角度 | +3° | CAD FILENAME S51047.S10 | MATERIAL NO. 51047-***00 | DRAWING NO. SD-51047-***00 | SHEET NO. 1 |

| | | |
|--|--|-----------|
| THIS DRAWING CONTAINS INFORMATION THAT IS PROPRIETARY TO MOLEX INCORPORATED AND SHOULD NOT BE USED WITHOUT WRITTEN PERMISSION. | | SIZE B |
|--|--|-----------|

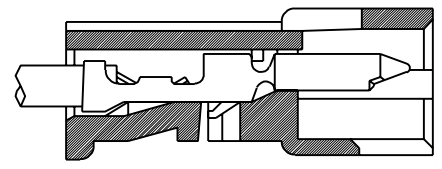
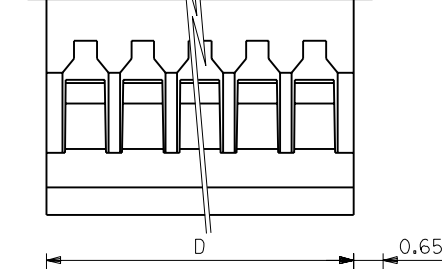
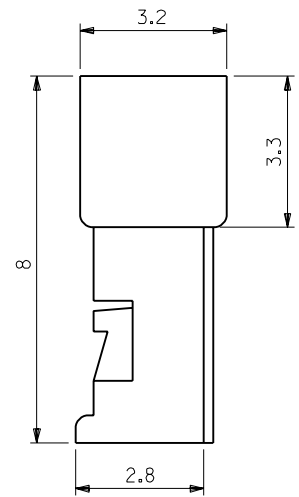
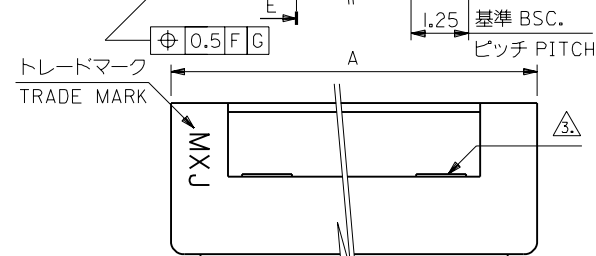
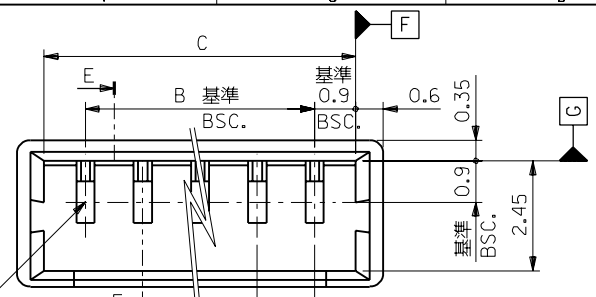

断面E-E
SECT. E-E

注)
NOTE.

- △ 適合ターミナル: 50125-8*00, 50133-8*00
APPLICABLE TERMINAL: 50125-8*00, 50133-8*00
- 2. 嵌合相手: 51021-***00
MATE WITH: 51021-***00
- △ ロック窓は、2、3極は1ヶ、4極以上は2ヶとする。
LOCKING WINDOW: ONE PLACE FOR 2AND3CKT.
AND TWO PLACES FOR MORE THAN 4CKT.

| | | | | | |
|-------|-------|-------|-------|------------|---------|
| 12.95 | 14.25 | 13.05 | 11.25 | 51047-1000 | 10 |
| 11.7 | 13 | 11.8 | 10 | -0900 | 9 |
| 10.45 | 11.75 | 10.55 | 8.75 | -0800 | 8 |
| 9.2 | 10.5 | 9.3 | 7.5 | -0700 | 7 |
| 7.95 | 9.25 | 8.05 | 6.25 | -0600 | 6 |
| 6.7 | 8 | 6.8 | 5 | -0500 | 5 |
| 5.45 | 6.75 | 5.55 | 3.75 | -0400 | 4 |
| 4.2 | 5.5 | 4.3 | 2.5 | -0300 | 3 |
| 2.95 | 4.25 | 3.05 | 1.25 | 51047-0200 | 2 |
| D | A | C | B | ENG.NO. | 極数 CKT. |