



Chipsmall Limited consists of a professional team with an average of over 10 year of expertise in the distribution of electronic components. Based in Hongkong, we have already established firm and mutual-benefit business relationships with customers from,Europe,America and south Asia,supplying obsolete and hard-to-find components to meet their specific needs.

With the principle of "Quality Parts,Customers Priority,Honest Operation,and Considerate Service",our business mainly focus on the distribution of electronic components. Line cards we deal with include Microchip,ALPS,ROHM,Xilinx,Pulse,ON,Everlight and Freescale. Main products comprise IC,Modules,Potentiometer,IC Socket,Relay,Connector.Our parts cover such applications as commercial,industrial, and automotives areas.

We are looking forward to setting up business relationship with you and hope to provide you with the best service and solution. Let us make a better world for our industry!



Contact us

Tel: +86-755-8981 8866 Fax: +86-755-8427 6832

Email & Skype: info@chipsmall.com Web: www.chipsmall.com

Address: A1208, Overseas Decoration Building, #122 Zhenhua RD., Futian, Shenzhen, China



注記
NOTES

1. 材質
MATERIAL
銅合金 (板厚: 0.3)
COPPER ALLOY (THICKNESS : 0.3)
2. メッキ仕様
TERMINAL PLATING
接点部 : 金メッキ 0.25 μm MIN.
CONTACT AREA : GOLD 0.25 μm MIN.
圧着部 : 錫メッキ 1.0 μm MIN.
CRIMP AREA : TIN 1.0 μm MIN.
下地メッキ : ニッケルメッキ 1.27 μm MIN.
UNDER PLATE : NICKEL 1.27 μm MIN.
3. 適用電線範囲 : UL 1015 , AWG #18~14
APPLICABLE WIRE RANGE : UL 1015 , AWG #18~14
4. 被覆外径 : φ3.8 MAX.
INSULATION EXTERNAL DIA : φ3.8 MAX.
5. 適用ハウジング : 51300-**** , 51301-****
APPLICABLE HOUSING : 51300-**** , 51301-****
6. 適用圧着工具 (手動) : 57413-5300 (適用電線 : AWG #16~14)
APPLICABLE CRIMP TOOL (HAND) : 57413-5300 (APPLICABLE WIRE AWG #16~14)
: 57413-5400 (適用電線 : AWG #18)
: 57413-5400 (APPLICABLE WIRE AWG #18)
7. 本製品は 56194-9185 の鉛フリー品である。
THIS PRODUCT IS LEAD FREE OF 56194-9185.

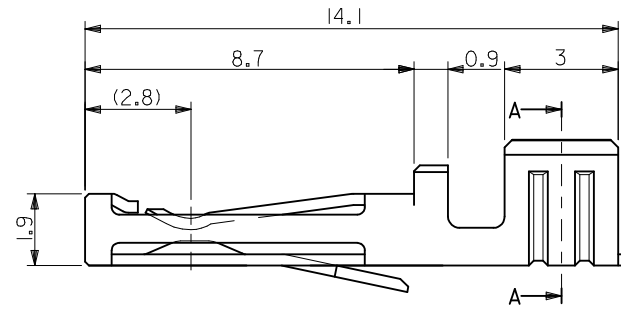
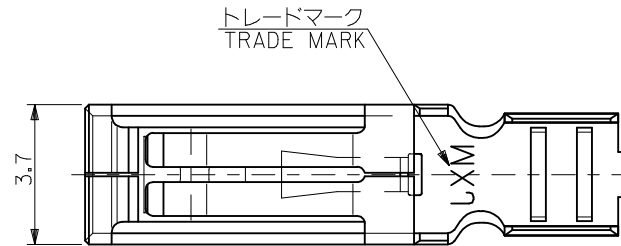
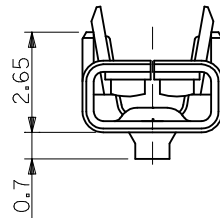
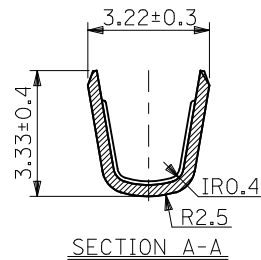

①	CHAIN	56194-9028	56194-9***
	バラ状 LOOSE	56194-9128	
	端子形状 TERMINAL CONFIGURATION	MATERIAL No.	MODEL No.

RELEASED EC NO: WNA2010-0098 DRWN: TMOELLER 2009/08/11 CHKD: MURPHY APPR: JFURPHY 2009/08/14 REV A	DESCRIPTION 10 UNDER ±0.2 10 OVER 30 UNDER ±0.25 30 OVER ±0.3 ANGULAR ±3 ° DRAFT WHERE APPLICABLE MUST REMAIN WITHIN DIMENSIONS	GENERAL TOLERANCES (UNLESS SPECIFIED)		DIMENSION STYLE MM ONLY		SCALE 1:1	DESIGN UNITS METRIC	THIRD ANGLE PROJECTION	
		DRAWN BY M. NABEI	DATE '07/10/30	TITLE COMPACT ROBOT CONN. POWER CRIMP SOCKET -LEAD FREE-					
		CHECKED BY M. ISOGAYA	DATE '07/10/30	MOLEX INCORPORATED					
		APPROVED BY N. UKITA	DATE '07/10/30	MATERIAL NO. SD-56194-003					
		SIZE A3		THIS DRAWING CONTAINS INFORMATION THAT IS PROPRIETARY TO MOLEX INCORPORATED AND SHOULD NOT BE USED WITHOUT WRITTEN PERMISSION					