



Chipsmall Limited consists of a professional team with an average of over 10 year of expertise in the distribution of electronic components. Based in Hongkong, we have already established firm and mutual-benefit business relationships with customers from,Europe,America and south Asia,supplying obsolete and hard-to-find components to meet their specific needs.

With the principle of "Quality Parts,Customers Priority,Honest Operation,and Considerate Service",our business mainly focus on the distribution of electronic components. Line cards we deal with include Microchip,ALPS,ROHM,Xilinx,Pulse,ON,Everlight and Freescale. Main products comprise IC,Modules,Potentiometer,IC Socket,Relay,Connector.Our parts cover such applications as commercial,industrial, and automotives areas.

We are looking forward to setting up business relationship with you and hope to provide you with the best service and solution. Let us make a better world for our industry!



## Contact us

Tel: +86-755-8981 8866 Fax: +86-755-8427 6832

Email & Skype: info@chipsmall.com Web: www.chipsmall.com

Address: A1208, Overseas Decoration Building, #122 Zhenhua RD., Futian, Shenzhen, China



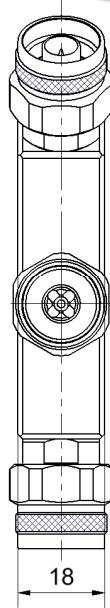
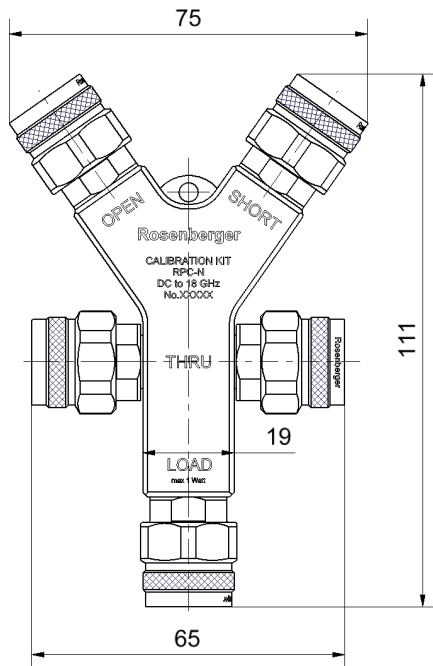

All dimensions are in mm; tolerances according to ISO 2768 m-H

**Interface**

According to

IEC 61169-16

**Contents and Documentation**

This kit is delivered with

- **Standard Definitions Card**  
Printed Standard Definitions that can be used on nearly all Vector Network Analyzers
- **Test Results Documentation**
- **Lanyard**
- **Hard Shell Case**

**Material and plating**

**Connector parts**

Center conductor  
Outer conductor  
Coupling nut  
Body  
Dielectric  
Substrate

**Material**

CuBe  
Stainless steel  
Stainless steel  
Aluminum  
PPE  
Al<sub>2</sub>O<sub>3</sub>

**Plating**

Gold, min. 1.27 μm, over nickel  
Passivated  
Passivated  
black anodized

Dieses Dokument ist urheberrechtlich geschützt • This document is protected by copyright • Rosenberger Hochfrequenztechnik GmbH & Co. KG

RF\_35/09;14/6.2



**Electrical data**

Frequency range	DC to 18 GHz
<b>Thru</b>	
Return loss	≥ 40 dB, DC to 6 GHz ≥ 36 dB, 6 GHz to 9 GHz ≥ 32 dB, 9 GHz to 18 GHz
<b>Open</b>	
Error from nominal phase <sup>1</sup>	≤ 2.0°, DC to 6 GHz ≤ 3.0°, 6 GHz to 9 GHz ≤ 4.0°, 9 GHz to 18 GHz
<b>Short</b>	
Error from nominal phase <sup>2</sup>	≤ 1.5°, DC to 6 GHz ≤ 2.0°, 6 GHz to 9 GHz ≤ 2.5°, 9 GHz to 18 GHz
<b>Load</b>	
Return loss	≥ 42 dB, DC to 6 GHz ≥ 36 dB, 6 GHz to 9 GHz ≥ 30 dB, 9 GHz to 18 GHz
DC-Resistance	50 Ω ± 0.5 Ω
Power handling	≤ 1.0 W

<sup>1</sup> The nominal phase is defined by the Offset Delay, the Offset Loss and the Fringing Capacitances

<sup>2</sup> The nominal phase is defined by the Offset Delay, the Offset Loss and the Short Inductance

**Mechanical data**

Mating cycles	≥ 500
Maximum torque	1.70 Nm
Recommended torque	1.10 Nm
Gauge	5.28 mm to 5.32 mm

**General standard definitions**

For proper operation the vector network analyzer (VNA) needs a model describing the electrical behaviour of this calibration standard. The different models, units, and terms used will depend on the VNA type and they will have to be entered into the VNA. All values are based on typical geometry and plating.

**Thru**

Offset Z <sub>0</sub> / Impedance / Z <sub>0</sub>	50 Ω
Offset Delay	212.814 ps
Length (electrical) / Offset Length	63.80 mm
Offset Loss	2.20 GΩ/s
Loss	0.0407 dB/√GHz
Line Loss @ 1GHz	0.0006 dB/mm

**Open**

Offset Z <sub>0</sub> / Impedance / Z <sub>0</sub>	50 Ω
Offset Delay	73.384 ps
Length (electrical) / Offset Length	22.00 mm
Offset Loss	0.80 GΩ/s
Loss	0.0102 dB/√GHz
Fringing Capacitances	C <sub>0</sub> = -14.2000 x 10 <sup>-15</sup> F / -14.2000 fF
	C <sub>1</sub> = 400.000 x 10 <sup>-27</sup> F/Hz / 0.40000 fF /GHz
	C <sub>2</sub> = -16.0000 x 10 <sup>-36</sup> F/Hz <sup>2</sup> / -0.01600 fF /GHz <sup>2</sup>
	C <sub>3</sub> = 1.00000 x 10 <sup>-45</sup> F/Hz <sup>3</sup> / 0.00100 fF /GHz <sup>3</sup>

**Short**

Offset $Z_o$ / Impedance / $Z_o$	50 Ω
Offset Delay	73.384 ps
Length (electrical) / Offset Length	22.00 mm
Offset Loss	0.80 GΩ/s
Loss	0.0102 dB/√GHz
Short Inductance	$L_0 = -27.0000 \times 10^{-12} \text{ H} \quad / \quad -27.0000 \text{ pH}$
	$L_1 = 7200.00 \times 10^{-24} \text{ H/Hz} \quad / \quad 7.20000 \text{ pH/GHz}$
	$L_2 = -800.000 \times 10^{-33} \text{ H/Hz}^2 \quad / \quad -0.80000 \text{ pH/GHz}^2$
	$L_3 = 26.0000 \times 10^{-42} \text{ H/Hz}^3 \quad / \quad 0.02600 \text{ pH/GHz}^3$

**Load**

Offset $Z_o$ / Impedance / $Z_o$	50 Ω
Offset Delay	0.0000 ps
Length (electrical) / Offset Length	0.000 mm
Offset Loss	0.00 GΩ/s
Loss	0.0000 dB/√GHz

**Environmental data**

Operating temperature range <sup>3</sup>	+20 °C to +26 °C
Rated temperature range of use <sup>4</sup>	0 °C to +50 °C
Storage temperature range	-40 °C to +85 °C
RoHS	compliant

<sup>3</sup> Temperature range over which these specifications are valid.

<sup>4</sup> This range is underneath and above the operating temperature range, within the calibration kit is fully functional and could be used without damage

**Declaration of documentation**

Standard delivery for this kit includes Test Results. The documentation issued reports which quantities were tested individually, traceable to national / international standards. Model based standard definitions of the calibration standards are reported in Agilent / Keysight, Rohde & Schwarz and Anritsu compatible VNA format.

**Inspection interval**

Recommendation	12 months
----------------	-----------

**Packing**

Standard	1 pce in bag
Weight	263 g/pce

While the information has been carefully compiled to the best of our knowledge, nothing is intended as representation or warranty on our part and no statement herein shall be construed as recommendation to infringe existing patents. In the effort to improve our products, we reserve the right to make changes judged to be necessary.

Draft	Date	Approved	Date	Rev.	Engineering change number	Name	Date
Marcel Panicke	26.11.14	Markus Müller	26.10.17	e00	17-1795	Marion Striegler	26.10.17

Rosenberger Hochfrequenztechnik GmbH & Co. KG P.O.Box 1260 D-84526 Tittmoning Germany www.rosenberger.de	Tel. : +49 8684 18-0 Email : info@rosenberger.de	Page 3 / 3
--	---	---------------