



Chipsmall Limited consists of a professional team with an average of over 10 year of expertise in the distribution of electronic components. Based in Hongkong, we have already established firm and mutual-benefit business relationships with customers from,Europe,America and south Asia,supplying obsolete and hard-to-find components to meet their specific needs.

With the principle of “Quality Parts,Customers Priority,Honest Operation,and Considerate Service”,our business mainly focus on the distribution of electronic components. Line cards we deal with include Microchip,ALPS,ROHM,Xilinx,Pulse,ON,Everlight and Freescale. Main products comprise IC,Modules,Potentiometer,IC Socket,Relay,Connector.Our parts cover such applications as commercial,industrial, and automotives areas.

We are looking forward to setting up business relationship with you and hope to provide you with the best service and solution. Let us make a better world for our industry!



## Contact us

Tel: +86-755-8981 8866 Fax: +86-755-8427 6832

Email & Skype: info@chipsmall.com Web: www.chipsmall.com

Address: A1208, Overseas Decoration Building, #122 Zhenhua RD., Futian, Shenzhen, China





# QUARTER TURN LOCK - SPRING LOADED



\*Example with cam.  
Cam sold separately.

### Specifications

- Material:  
Housing: Zinc Alloy (Zamak) DIN-EN 1774-ZnAl4Cu1 or PA6 GFR 30  
Driver: Zinc Alloy (Zamak) DIN-EN 1774-ZnAl4Cu1 or PA6 GFR 30  
Cam: Steel or Plastic  
Gasket: Rubber
- Finish: Chrome or Black coated

### Features

- Specially designed internal spring provides tactile resistance
- Cam does not rotate beyond quarter turn due to stop lip
- Suitable for use on electric panels, machinery covers

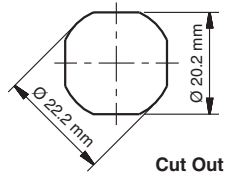
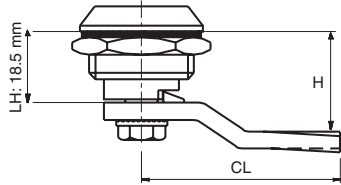

Cut Out

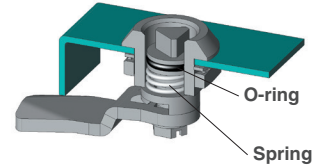

### Driver/Head Styles



3mm Double Bit



Slot



10mm Hexagon female



8mm Triangular



Slot (2x4)

Item Number		Driver	Cam	
Zinc Alloy / Chrome	Zinc Alloy / Black	Nylon / Black		
060111300	060121300	060201300	3mm Double Bit	Select Cam Below
060115200	060125200	-	Slot	Select Cam Below
060116100	060126100	-	10mm Hexagon female	Select Cam Below
-	-	060203800	8mm Triangular	Select Cam Below
-	-	060204200	Slot (2x4)	Select Cam Below

### Steel Cam

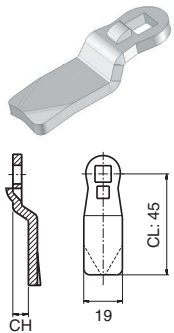

Material: Steel  
Finish: Zinc plated  
Thickness: 4 mm

Item Number	CH (mm)	CL (mm)	H (mm)
30403033	0	45	18.5
30403439	1	45	19.5
30403159	2	45	20.5
30403063	3	45	21.5
30403149	4	45	22.5
30403160	6	45	24.5
30403161	8	45	26.5
30403162	10	45	28.5
30403045	12	45	30.5
30403163	14	45	32.5
30403151	16	45	34.5
30403165	18	45	36.5

Item Number	CH (mm)	CL (mm)	H (mm)
30403166	20	45	38.5
30403167	22	45	40.5
30403168	24	45	42.5
30403169	-2	45	16.5
30403170	-4	45	14.5
30403171	-6	45	12.5
30403172	-8	45	10.5
30403173	-10	45	8.5
30403174	-12	45	6.5
30403175	-14	45	4.5

### Nylon Cam

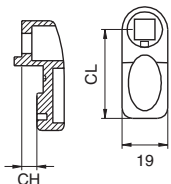

Item Number	CH (mm)	CL (mm)	H (mm)
30402004	0	35	18.5
30402011	0	25	18.5
30402005	6	35	24.5
30402008	4	45	22.5
30402013	-4	45	14.5