



Chipsmall Limited consists of a professional team with an average of over 10 year of expertise in the distribution of electronic components. Based in Hongkong, we have already established firm and mutual-benefit business relationships with customers from,Europe,America and south Asia,supplying obsolete and hard-to-find components to meet their specific needs.

With the principle of "Quality Parts,Customers Priority,Honest Operation,and Considerate Service",our business mainly focus on the distribution of electronic components. Line cards we deal with include Microchip,ALPS,ROHM,Xilinx,Pulse,ON,Everlight and Freescale. Main products comprise IC,Modules,Potentiometer,IC Socket,Relay,Connector.Our parts cover such applications as commercial,industrial, and automotives areas.

We are looking forward to setting up business relationship with you and hope to provide you with the best service and solution. Let us make a better world for our industry!



Contact us

Tel: +86-755-8981 8866 Fax: +86-755-8427 6832

Email & Skype: info@chipsmall.com Web: www.chipsmall.com

Address: A1208, Overseas Decoration Building, #122 Zhenhua RD., Futian, Shenzhen, China



PART ILLUSTRATED IN THIS DRAWING IS 67600-8001

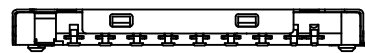
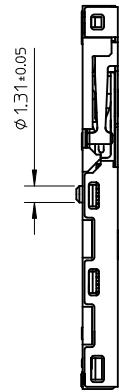
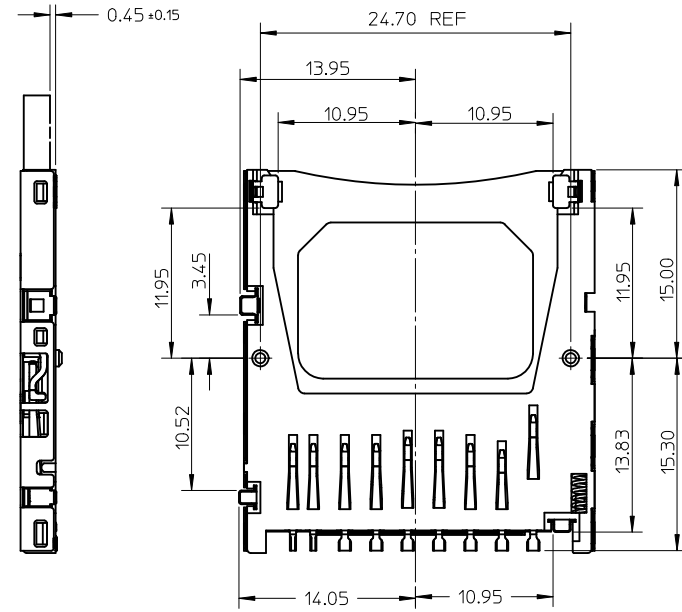
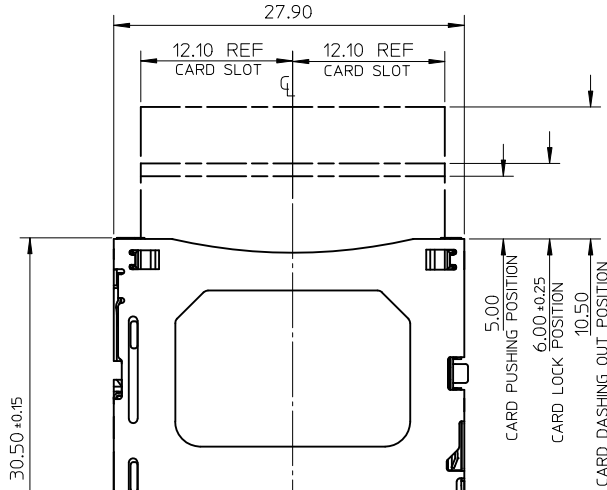
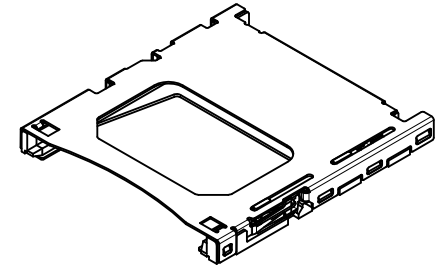
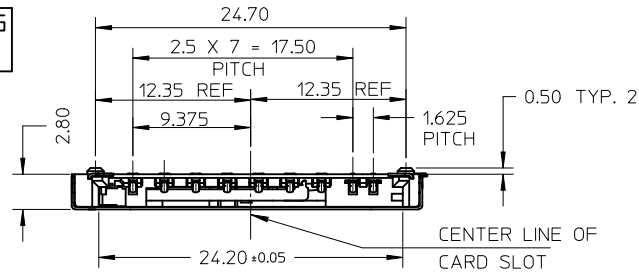

MATERIAL NO.	DESCRIPTION
67600-8001	STANDARD
67600-8005	W/O CARD LOCK PIN

REV	DESCRIPTION
G	UPDATE 1) VIEWS, 2) PART NUMBER TABLE 3) NOTE 9, 4) ADD NOTE 10

REVISED	EC NO: S2012-0634	DRWN: JESSIECHUA 2012/02/28	CHKD: CWANG25 2012/03/07	APPR: MAGESHKN 2012/03/07
DESCRIPTION				

QUALITY SYMBOLS	GENERAL TOLERANCES (UNLESS SPECIFIED)
▽=0	mm INCH
∇=0	4 PLACES ± --- ± ---
	3 PLACES ± --- ± ---
	2 PLACES ± 0.25 ± ---
	1 PLACE ± 0.25 ± ---
	ANGULAR ± 3 °
	DRAFT WHERE APPLICABLE MUST REMAIN WITHIN DIMENSIONS

DIMENSION STYLE		SCALE	DESIGN UNITS	THIRD ANGLE PROJECTION
MM ONLY		1:1	METRIC	
DRAWN BY	DATE	TITLE		
DAVID HU	2004/12/20	SD MEMORY CARD CONN. ASS'Y (TOP MOUNT TYPE) LEAD-FREE		
CHECKED BY	DATE	MOLEX INCORPORATED		
HARVEY	2004/12/20	DOCUMENT NO. SD-67600-006		
APPROVED BY	DATE	SHEET NO. 1 OF 2		
VINCENT	2004/12/20			
MATERIAL NO.	SEE TABLE			

DRAWN BY		DATE	TITLE	
DAVID HU		2004/12/20	SD MEMORY CARD CONN. ASS'Y (TOP MOUNT TYPE) LEAD-FREE	
CHECKED BY		DATE	MOLEX INCORPORATED	
HARVEY		2004/12/20	DOCUMENT NO. SD-67600-006	
APPROVED BY		DATE	SHEET NO. 1 OF 2	
VINCENT		2004/12/20		
MATERIAL NO.		SEE TABLE		

NOTES:

- 1.MATERIAL:
 PLASTIC PART: HIGH TEMPERATURE THERMOPLASTIC.
 METAL PART: COPPER ALLOY OR STAINLESS STEEL.
- 2.TERMINAL AND NAIL COPLANARITY TO BE 0.1 MAX.
- 3.WHEN DELIVERING, THE PUSH/PUSH MECHANISM IS IN THE STATE OF THE UNLOCK.(CARD DASHING OUT POSITION).
- 4.CARD READ ONLY BY THE TIME THE CARD DETECTION SWITCH WORKS.
- 5.OPENING AND CLOSE OF EACH SWITCH.

CARD INSERTION STATUS	WRITE PROTECT SWITCH		CARD DETECT SWITCH
	WRITE PROTECT POSITION	WRITE ENABLE POSITION	
CARD UNINSERTION	OPEN	OPEN	OPEN
CARD HALF INSERTION	CLOSE	CLOSE	OPEN
CARD INSERTION	OPEN	CLOSE	CLOSE

- 6.TERMINAL PLATING:
 CONTACT AREA: GOLD, THICKNESS=0.2 MICRON MIN.
 SOLDER TAIL AREA(A): TIN, THICKNESS=1.27 MICRON MIN.
 (B): GOLD FLASH, THICKNESS=0.05 MICRON MIN.
 UNDER PLATE: NICKEL, THICKNESS=1 MICRON MIN.
7. PRODUCT SPECIFICATION : PER PS-67600-001.
8. TAPE AND REEL REFERS TO SD-67600-003 SHEET3.
9. N/A
10. DATE CODE: "YYMMDDA", "YY" REPRESENTS YEAR, "MM"REPRESENTS MONTH, "DD" REPRESENTS DAY; "A" REPRESENTS SHIFT.

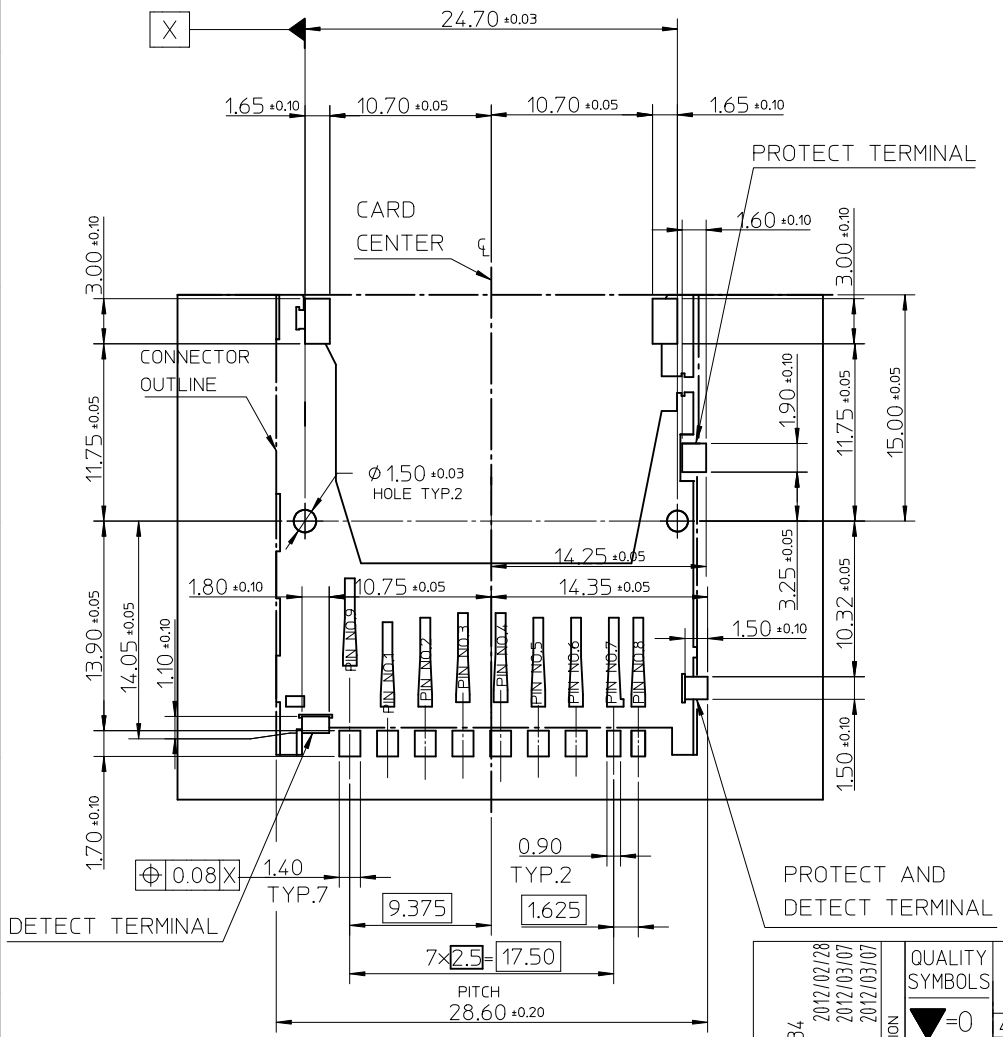

REVISED	EC NO: S2012-0634	2012/02/28
	DRWN: JESSIECHUA	2012/03/07
	CHKD: CWANG25	2012/03/07
	APPR: MAGESHKN	2012/03/07
REV	DESCRIPTION	QUALITY SYMBOLS
		▽=0 C=0

GENERAL TOLERANCES (UNLESS SPECIFIED)		DIMENSION STYLE MM ONLY		SCALE 1:1	DESIGN UNITS METRIC	THIRD ANGLE PROJECTION
	mm	INCH	DRAWN BY DAVID HU	DATE 2004/12/20	TITLE SD MEMORY CARD CONN. ASS'Y (TOP MOUNT TYPE) LEAD-FREE	
4 PLACES	± ---	± ---	CHECKED BY HARVEY	DATE 2004/12/20	MOLEX INCORPORATED	
3 PLACES	± ---	± ---	APPROVED BY VINCENT	DATE 2004/12/20		
2 PLACES	± 0.25	± ---	MATERIAL NO. SEE TABLE		DOCUMENT NO. SD-67600-006	SHEET NO. 2 OF 2
1 PLACE	± 0.25	± ---	THIS DRAWING CONTAINS INFORMATION THAT IS PROPRIETARY TO MOLEX INCORPORATED AND SHOULD NOT BE USED WITHOUT WRITTEN PERMISSION			
ANGULAR ± 3 °						
DRAFT WHERE APPLICABLE MUST REMAIN WITHIN DIMENSIONS						