



Chipsmall Limited consists of a professional team with an average of over 10 year of expertise in the distribution of electronic components. Based in Hongkong, we have already established firm and mutual-benefit business relationships with customers from,Europe,America and south Asia,supplying obsolete and hard-to-find components to meet their specific needs.

With the principle of “Quality Parts,Customers Priority,Honest Operation,and Considerate Service”,our business mainly focus on the distribution of electronic components. Line cards we deal with include Microchip,ALPS,ROHM,Xilinx,Pulse,ON,Everlight and Freescale. Main products comprise IC,Modules,Potentiometer,IC Socket,Relay,Connector.Our parts cover such applications as commercial,industrial, and automotives areas.

We are looking forward to setting up business relationship with you and hope to provide you with the best service and solution. Let us make a better world for our industry!



## Contact us

Tel: +86-755-8981 8866 Fax: +86-755-8427 6832

Email & Skype: info@chipsmall.com Web: www.chipsmall.com

Address: A1208, Overseas Decoration Building, #122 Zhenhua RD., Futian, Shenzhen, China



MATERIALS AND FINISHES:

BODY STAINLESS STEEL  
 PASSIVATED

CENTER CONTACT BERYLLIUM COPPER  
 PLATED GOLD

INSULATOR TEFLON

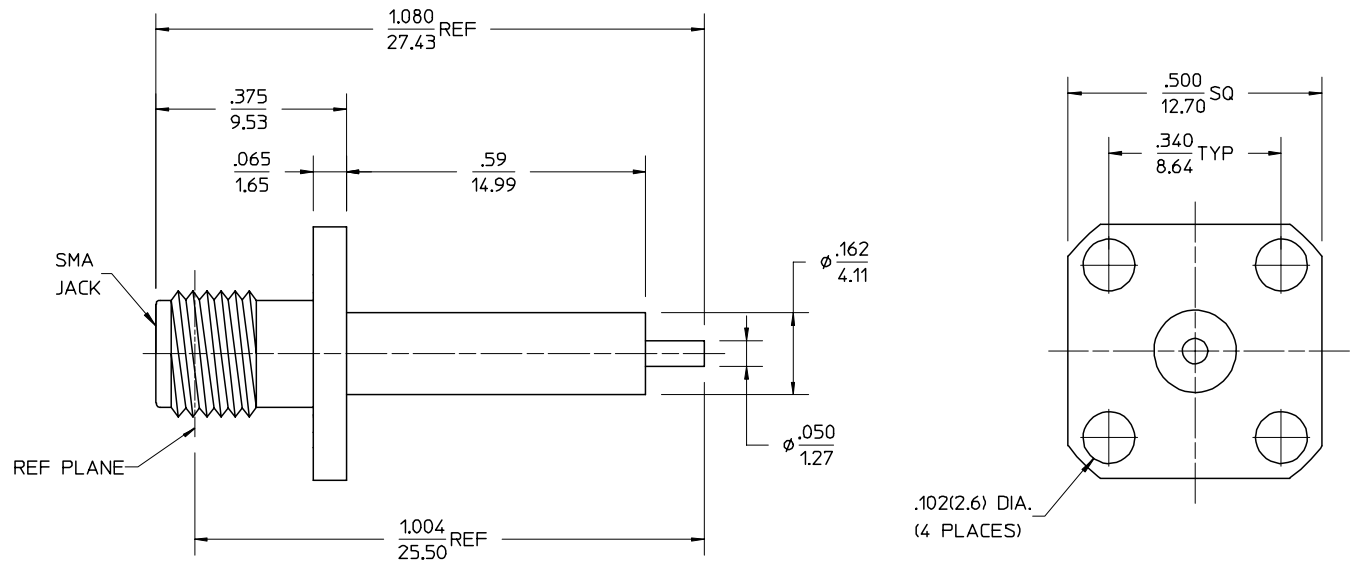

PART # 73251-0410

MIL-STD-348, FIGURE 310-2	INTERFACE
PS-89675-2820	ELECTRO/MECH PERFORMANCE
SPECIFICATION	DESCRIPTION

CHG: 58 WAS .590	EC NO. URF-1710 DRWN: JDW 04/11/03 CHK: SSS 04/11/03 APPR: GMH 04/11/03 CHG: NEW RELEASE	EC NO. URF-1699 DRWN: TEF 04/01/03 CHK: SSS 04/01/03 APPR: JW 04/01/03	REV 1 WAS A SINCE EC NO 0013 WAS CANCELLED REMOVED MIL SPECS FROM MATERIAL AND FINISHES TEF 03/19/02	EC NO. RF-0013 DRWN: EDC 12/10/97 CHK: DHG 01/09/98 APPR: GMH 01/09/98	DESCRIPTION
A1	A	2	1	REV	

UNLESS OTHERWISE SPECIFIED DIMS ARE INCHES AND ANGLES ARE DEGREES.

- √ 63 ALL OVER.
- NO CHATTER OR NON-UNIFORM SURFACE FINISH ALLOWED.
- PARTS TO BE FREE OF BURRS & SHARP EDGES .005 MAX BREAK.
- EXTERNAL THREADS TO BE ROLLED OR SINGLE POINT.
- DIAMETERS TO BE CONCENTRIC WITHIN .003 TIR.

QUALITY SYMBOLS	GENERAL TOLERANCES: (UNLESS SPECIFIED)	SCALE	DESIGN UNITS <input type="checkbox"/> mm <input checked="" type="checkbox"/> INCH	THIRD ANGLE PROJECTION	DIMENSIONS: <input type="checkbox"/> mm <input checked="" type="checkbox"/> INCH <input type="checkbox"/> mm ONLY
MAJOR	mm	INCH	DRAWN BY & DATE EDC 12/10/97	TITLE: SMA JACK, RECEPTACLE, 4 HOLE FLANGE MOUNT, EXTENDED DIELECTRIC POST SMA-SDJR/F	REVISE ON CAD ONLY
CRITICAL	4 PLACES * — ± .0005	3 PLACES * — ± .005	CHECKED BY & DATE DHG 01/09/98	MATERIAL NO. SEE NOTE	SHEET NO. 1 of 1
	2 PLACES * — ± .01	1 PLACE * — ± .1	APPROVED BY & DATE GMH 01/09/98	DRAWING NO. SD-73251-041	SIZE B
	ANGULAR: ± 1/2°		CAD FILENAME	THIS DRAWING CONTAINS INFORMATION THAT IS PROPRIETARY TO MOLEX INCORPORATED AND SHOULD NOT BE USED WITHOUT WRITTEN PERMISSION.	
	DRAFT WHERE APPLICABLE MUST REMAIN WITHIN DIMENSIONS				