



Chipsmall Limited consists of a professional team with an average of over 10 year of expertise in the distribution of electronic components. Based in Hongkong, we have already established firm and mutual-benefit business relationships with customers from,Europe,America and south Asia,supplying obsolete and hard-to-find components to meet their specific needs.

With the principle of “Quality Parts,Customers Priority,Honest Operation,and Considerate Service”,our business mainly focus on the distribution of electronic components. Line cards we deal with include Microchip,ALPS,ROHM,Xilinx,Pulse,ON,Everlight and Freescale. Main products comprise IC,Modules,Potentiometer,IC Socket,Relay,Connector.Our parts cover such applications as commercial,industrial, and automotives areas.

We are looking forward to setting up business relationship with you and hope to provide you with the best service and solution. Let us make a better world for our industry!



## Contact us

Tel: +86-755-8981 8866 Fax: +86-755-8427 6832

Email & Skype: info@chipsmall.com Web: www.chipsmall.com

Address: A1208, Overseas Decoration Building, #122 Zhenhua RD., Futian, Shenzhen, China



**MATERIALS AND FINISHES**

BODY: 303 SST  
 PLATED: PASSIVATED

CENTER CONTACT: BERYLLIUM COPPER  
 PLATED: GOLD

INSULATOR: TEFLON

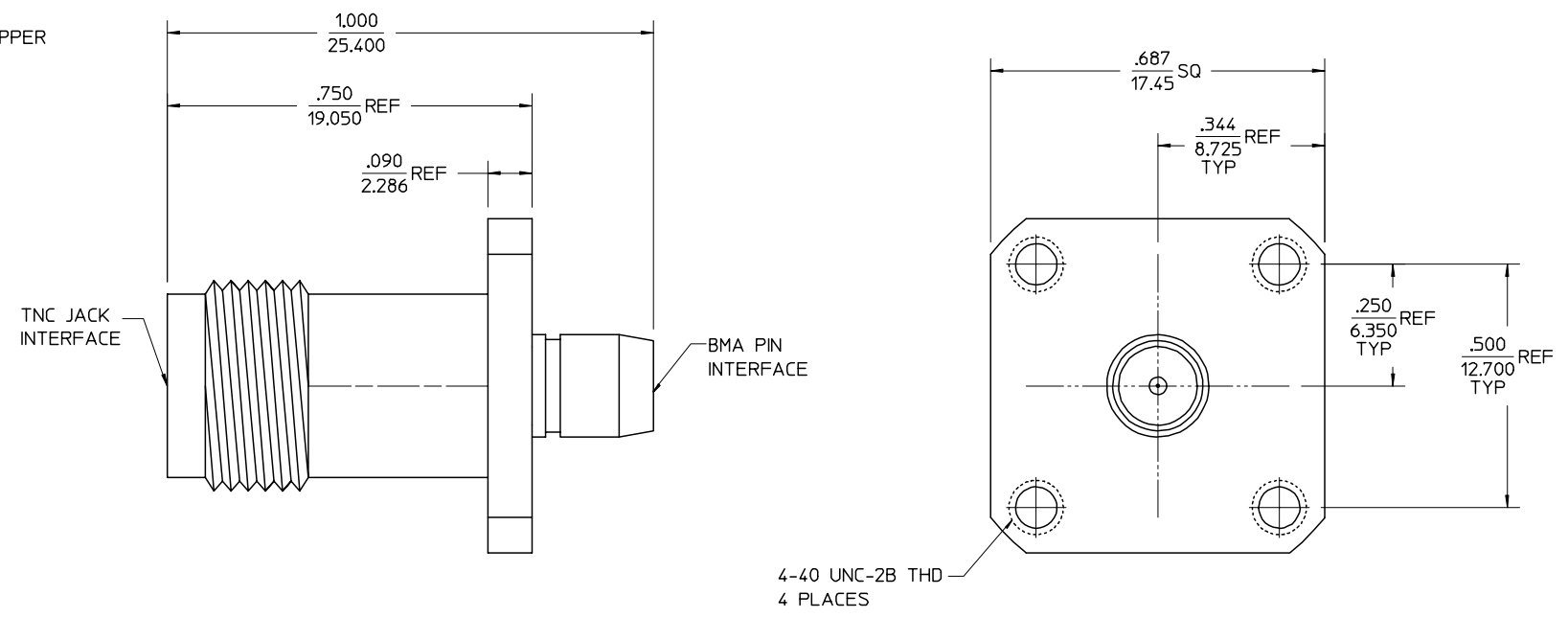

PART # 73386-0500

MIL-STD-348A, FIG 321-1	INTERFACE SPECIFICATION (BMA)
ES-89675-1780	INTERFACE SPECIFICATION (TNC)
SPECIFICATION	DESCRIPTION

CHG: NEW RELEASE P/N ES-89675-1780 WAS MIL-STD-348A, FIG 3132	EC NO. URF-1603 DRWN: SSS 11/19/02 CHK: TEF 11/19/02 APPR: GMH 11/19/02	CHG: 'MALE' IN TITLE WAS 'PIN'	APPR: SSS 11/18/02 CHG: XXXXX	EC NO. URF-XXXX DRWN: XXX 00/00/00 CHK: XXX 00/00/00 APPR: XXX 00/00/00	DESCRIPTION
A	2	1	REV		

UNLESS OTHERWISE SPECIFIED DIMS ARE INCHES AND ANGLES ARE DEGREES.

1.  $\sqrt{63}$  ALL OVER.
2. NO CHATTER OR NON-UNIFORM SURFACE FINISH ALLOWED.
3. PARTS TO BE FREE OF BURRS & SHARP EDGES .005 MAX BREAK.
4. EXTERNAL THREADS TO BE ROLLED OR SINGLE POINT.
5. DIAMETERS TO BE CONCENTRIC WITHIN .003 TIR.

QUALITY SYMBOLS

MAJOR

CRITICAL

GENERAL TOLERANCES: (UNLESS SPECIFIED)	
mm	INCH
4 PLACES * ——— ±.0005	
3 PLACES * ——— ±.005	
2 PLACES * ——— ±.01	
1 PLACE * ——— ±.1	
ANGULAR: ±2°	
DRAFT WHERE APPLICABLE MUST REMAIN WITHIN DIMENSIONS	

SCALE	DESIGN UNITS
SSS 10/21/02	<input type="checkbox"/> mm <input checked="" type="checkbox"/> INCH
DRAWN BY & DATE	
TEF 10/21/02	
CHECKED BY & DATE	
GMH 10/21/02	
APPROVED BY & DATE	
GMH 10/21/02	
CAD FILENAME	

THIRD ANGLE PROJECTION	DIMENSIONS:	1	A
<input type="checkbox"/> mm <input checked="" type="checkbox"/> INCH	<input type="checkbox"/> mm <input type="checkbox"/> INCH	SHT	REV
TITLE:			
BSA, TNC JACK, 4 HOLE FLANG/BMA, MALE			
50 OHM - BSA-TNC/BMA			
MOLEX MOLEX INCORPORATED			
MATERIAL NO.	DRAWING NO.	SHEET NO.	
SEE NOTE	SD-73386-050	1 of 1	
THIS DRAWING CONTAINS INFORMATION THAT IS PROPRIETARY TO MOLEX INCORPORATED AND SHOULD NOT BE USED WITHOUT WRITTEN PERMISSION.			SIZE
			B