



Chipsmall Limited consists of a professional team with an average of over 10 year of expertise in the distribution of electronic components. Based in Hongkong, we have already established firm and mutual-benefit business relationships with customers from,Europe,America and south Asia,supplying obsolete and hard-to-find components to meet their specific needs.

With the principle of "Quality Parts,Customers Priority,Honest Operation,and Considerate Service",our business mainly focus on the distribution of electronic components. Line cards we deal with include Microchip,ALPS,ROHM,Xilinx,Pulse,ON,Everlight and Freescale. Main products comprise IC,Modules,Potentiometer,IC Socket,Relay,Connector.Our parts cover such applications as commercial,industrial, and automotives areas.

We are looking forward to setting up business relationship with you and hope to provide you with the best service and solution. Let us make a better world for our industry!



Contact us

Tel: +86-755-8981 8866 Fax: +86-755-8427 6832

Email & Skype: info@chipsmall.com Web: www.chipsmall.com

Address: A1208, Overseas Decoration Building, #122 Zhenhua RD., Futian, Shenzhen, China



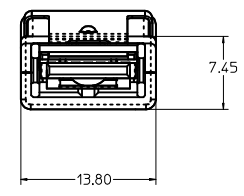
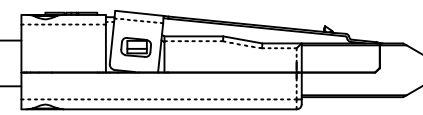
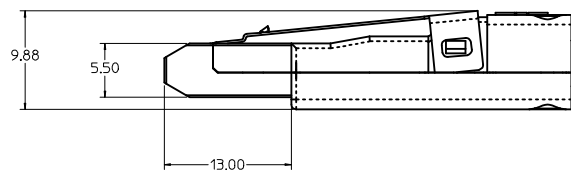
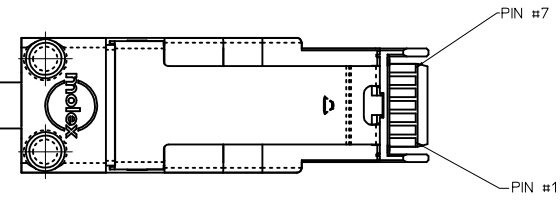
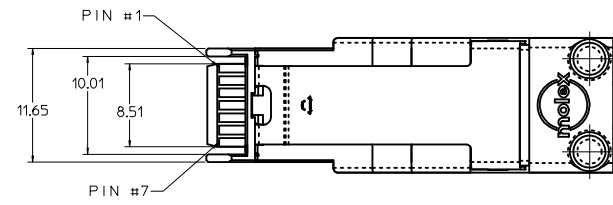

WIRING DIAGRAM			
P1		P2	
PIN	SIGNAL	PIN	SIGNAL
1	GROUND	7	GROUND
2	Rx+	6	Tx+
3	Rx-	5	Tx-
4	GROUND	4	GROUND
5	Tx-	3	Rx-
6	Tx+	2	Rx+
7	GROUND	1	GROUND

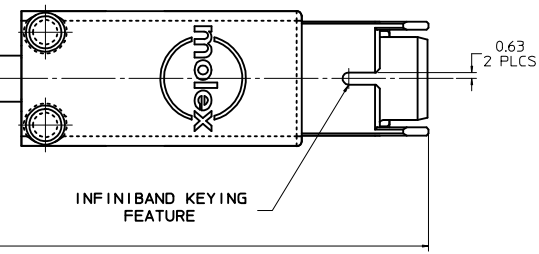
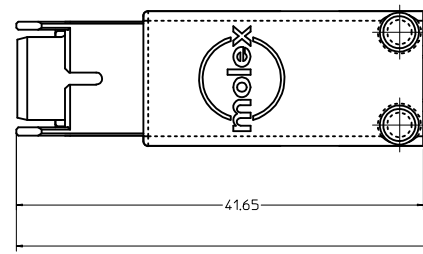

LENGTH
SEE CHART

MOLEX P/N	LENGTH
739392001	0.5 M ± 0.03 M
739392002	1 M ± 0.05 M
739392003	2 M ± 0.06 M
739392004	3 M ± 0.07 M
739392005	5 M ± 0.08 M
739392011	7 M ± 0.08 M
739392017	.3 M ± 0.03 M

- NOTES:**
- MATERIAL:**
HOUSING - ZINC DIE CAST
LATCH - PHOS BRONZE
PCB - FR-4
RIVET - STEEL
 - CHARACTERISTIC IMPEDANCE 100 OHMS DIFFERENTIALLY**

ADDED P/N EC NO: USY2009-0568 DRAWN: ERWIN 2009/06/17 CHKD: SCHNEIDER 2009/06/22 APPR: DODDYE 2009/06/23 REV DESCRIPTION	QUALITY SYMBOLS ▽=0 ▽=0	GENERAL TOLERANCES (UNLESS SPECIFIED) <table border="1"> <thead> <tr> <th></th> <th>mm</th> <th>INCH</th> </tr> </thead> <tbody> <tr> <td>4 PLACES</td> <td>±.005</td> <td>±.0005</td> </tr> <tr> <td>3 PLACES</td> <td>±.008</td> <td>±.0008</td> </tr> <tr> <td>2 PLACES</td> <td>±.015</td> <td>±.0015</td> </tr> <tr> <td>1 PLACE</td> <td>±.030</td> <td>±.0030</td> </tr> </tbody> </table> ANGULAR ± 2 °		mm	INCH	4 PLACES	±.005	±.0005	3 PLACES	±.008	±.0008	2 PLACES	±.015	±.0015	1 PLACE	±.030	±.0030	DIMENSION STYLE MM ONLY	SCALE 1:1 DESIGN UNITS METRIC THIRD ANGLE PROJECTION
		mm	INCH																
	4 PLACES	±.005	±.0005																
	3 PLACES	±.008	±.0008																
2 PLACES	±.015	±.0015																	
1 PLACE	±.030	±.0030																	
DRAWN BY: DSL CHECKED BY: DLD APPROVED BY: DLD	DATE: 2001/05/22 DATE: 2001/05/29 DATE: 2001/05/29	TITLE: HSSDC II PLUG TO PLUG INFINIBAND KEYING OPTION CABLE ASSEMBLY	MOLEX INCORPORATED	SHEET NO. 1 OF 1															
MATERIAL NO. SEE CHART SIZE D	DRAFT WHERE APPLICABLE MUST REMAIN WITHIN DIMENSIONS	THIS DRAWING CONTAINS INFORMATION THAT IS PROPRIETARY TO MOLEX INCORPORATED AND SHOULD NOT BE USED WITHOUT WRITTEN PERMISSION	DOCUMENT NO. SD-73939-200	MOLEX INCORPORATED															