



Chipsmall Limited consists of a professional team with an average of over 10 year of expertise in the distribution of electronic components. Based in Hongkong, we have already established firm and mutual-benefit business relationships with customers from,Europe,America and south Asia,supplying obsolete and hard-to-find components to meet their specific needs.

With the principle of “Quality Parts,Customers Priority,Honest Operation,and Considerate Service”,our business mainly focus on the distribution of electronic components. Line cards we deal with include Microchip,ALPS,ROHM,Xilinx,Pulse,ON,Everlight and Freescale. Main products comprise IC,Modules,Potentiometer,IC Socket,Relay,Connector.Our parts cover such applications as commercial,industrial, and automotives areas.

We are looking forward to setting up business relationship with you and hope to provide you with the best service and solution. Let us make a better world for our industry!



Contact us

Tel: +86-755-8981 8866 Fax: +86-755-8427 6832

Email & Skype: info@chipsmall.com Web: www.chipsmall.com

Address: A1208, Overseas Decoration Building, #122 Zhenhua RD., Futian, Shenzhen, China



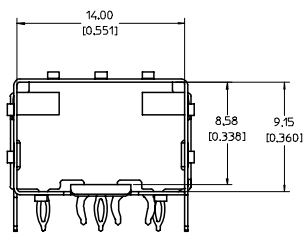
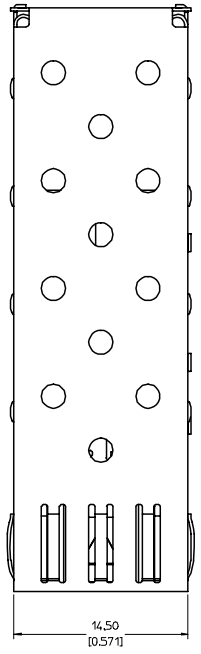
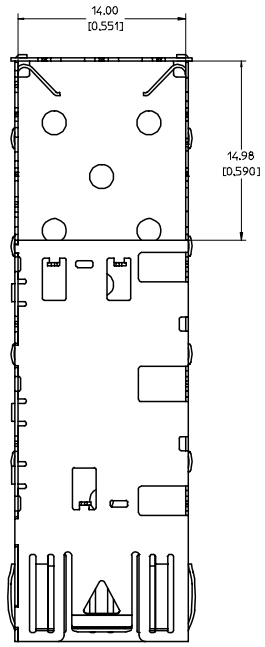

SPRING FINGER GASKET WITH TWO POINTS OF CONTACT. COMPLIES WITH (SFP) MSA BOARD AND BEZEL LOCATIONS.

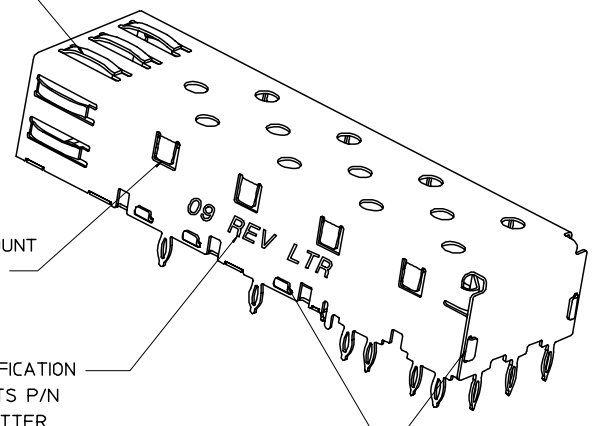

TABS USED TO MOUNT LIGHT PIPE COVER

CAGE IDENTIFICATION LAST 2 DIGITS P/N AND REV LETTER (ex: 09 X)

ONE PIECE DESIGN SECURELY PASTENED

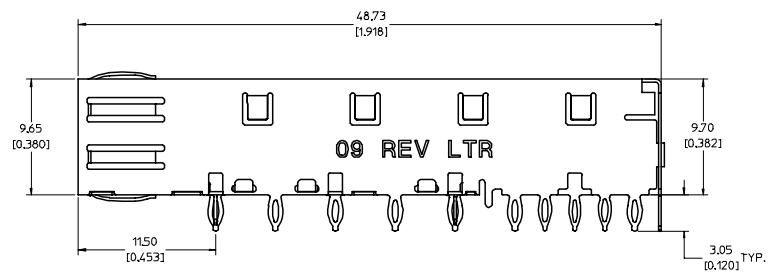

NOTES:

- PRESS FIT LEGS, 0.120 INCHES LONG. 157 [0.062] MINIMUM PCB THICKNESS.
- THIS CAGE IS FOR SINGLE SIDED USE ONLY.
- CAN BE USED WITH THE FOLLOWING LIGHT PIPE PART NUMBERS:
747260001 - LIGHT PIPE FROM BACK TO TOP (REFER TO DOCUMENT SD-74726-001)
747260002 - LIGHT PIPE FROM SIDE TO TOP (REFER TO DOCUMENT SD-74726-002)
- MATERIAL: COPPER ALLOY
PLATING: PRE-PLATED WITH NICKEL
- THIS PART MEETS THE RESTRICTION OF HAZARDOUS SUBSTANCES IN ELECTRICAL AND ELECTRONIC EQUIPMENT (ROHS) DIRECTIVE (2002/95/EC).

| UPDATED 3D MODELS EC NO: USY2008-0862 DRAWN BY: CCOX CHKD: CHKCD APPR: RMAHMOOD DATE: 2007/10/21 DATE: 2007/10/21 | QUALITY SYMBOLS | GENERAL TOLERANCES (UNLESS SPECIFIED) | DIMENSION STYLE | SCALE | DESIGN UNITS | THIRD ANGLE PROJECTION | | | | | | | | | | |
|---|---|--|-----------------|--------------|-----------------|--|-----------------|---|--------------------|-------|----------------|-------|-------|-----|--------|--|
| | $\nabla=0$ $\nabla=0$ | <table border="1"> <tr><th>mm</th><th>INCH</th></tr> <tr><td>4 PLACES ± .005</td><td>± .005</td></tr> <tr><td>3 PLACES ± .005</td><td>± .005</td></tr> <tr><td>2 PLACES ± 0.13</td><td>± .01</td></tr> <tr><td>1 PLACE ± 0.25</td><td>± .01</td></tr> </table> | mm | INCH | 4 PLACES ± .005 | ± .005 | 3 PLACES ± .005 | ± .005 | 2 PLACES ± 0.13 | ± .01 | 1 PLACE ± 0.25 | ± .01 | MM/IN | 5:1 | METRIC | |
| | mm | INCH | | | | | | | | | | | | | | |
| | 4 PLACES ± .005 | ± .005 | | | | | | | | | | | | | | |
| 3 PLACES ± .005 | ± .005 | | | | | | | | | | | | | | | |
| 2 PLACES ± 0.13 | ± .01 | | | | | | | | | | | | | | | |
| 1 PLACE ± 0.25 | ± .01 | | | | | | | | | | | | | | | |
| DESCRIPTION | <table border="1"> <tr><th>mm</th><th>INCH</th></tr> <tr><td>ANGULAR ± 1°</td><td></td></tr> </table> | mm | INCH | ANGULAR ± 1° | | DRAWN BY: CCOX DATE: 2006/11/22 CHECKED BY: RMAHMOOD DATE: 2006/11/22 APPROVED BY: | TITLE | SFP ONE PIECE CAGE PRESS-FIT (0.120 LEGS) | MOLEX INCORPORATED | | | | | | | |
| mm | INCH | | | | | | | | | | | | | | | |
| ANGULAR ± 1° | | | | | | | | | | | | | | | | |
| DRAFT WHERE APPLICABLE MUST REMAIN WITHIN DIMENSIONS | MATERIAL NO.: 747370009 DOCUMENT NO.: SD-74737-009 | SHEET NO.: 1 OF 4 | | | | | | | | | | | | | | |

20 19 18 17 16 15 14 13 12 11 10 9 8 7 6 5 4 3 2 1

M

L

K

J

I

H

G

F

E

D

C

B

A

M

L

K

J

I

H

G

F

E

D

C

B

A

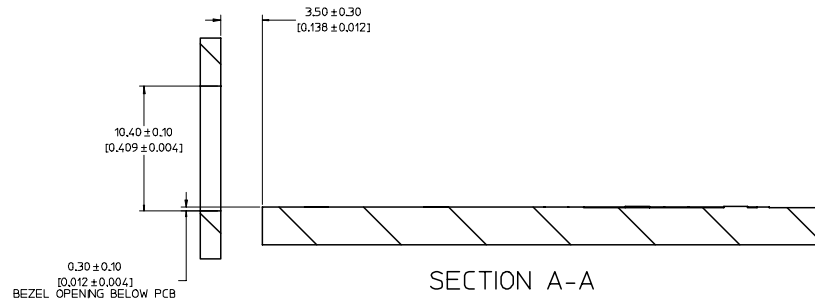
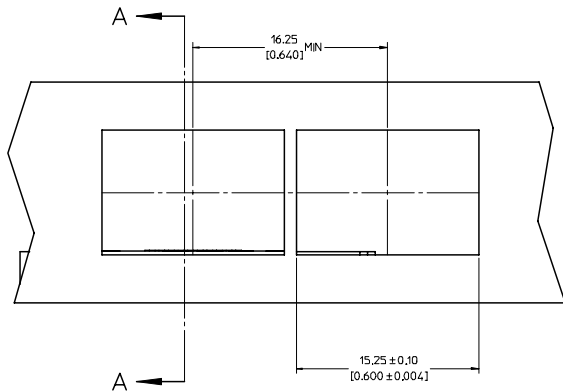
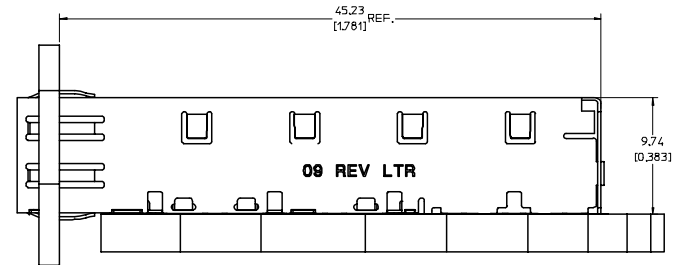

| | | | | | | | | |
|--|-----------------|---------------------------------------|-----------------------|--|---------------------------|---------------------------------|---------------------------------------|---|
| UPDATED 3D MODELS EC NO: USY2008-0962 DRAWN BY: CCOX 2007/10/05 CHECKED: RMAHMOOD 2007/10/21 APPROVED: RMAHMOOD 2007/10/23 | QUALITY SYMBOLS | GENERAL TOLERANCES (UNLESS SPECIFIED) | | DIMENSION STYLE | | SCALE | DESIGN UNITS | THIRD ANGLE PROJECTION |
| | ▽=0 ▽=0 | mm | INCH | MM/IN | | 5:1 | METRIC | |
| | | 4 PLACES ± --- ± --- | 3 PLACES ± --- ± .005 | 2 PLACES ± 0.13 ± .01 | 1 PLACE ± 0.25 ± --- | DRAWN BY: CCOX DATE: 2006/11/22 | CHECKED BY: RMAHMOOD DATE: 2006/11/22 | TITLE: SFP ONE PIECE CAGE PRESS-FIT (0.120 LEGS) |
| | | ANGULAR ± 1 ° | | DRAFT WHERE APPLICABLE MUST REMAIN WITHIN DIMENSIONS | | MATERIAL NO. 747370009 | APPROVED BY: DATE: | MOLEX INCORPORATED |
| | | | | | DOCUMENT NO. SD-74737-009 | | SHEET NO. 3 OF 4 | THIS DRAWING CONTAINS INFORMATION THAT IS PROPRIETARY TO MOLEX INCORPORATED AND SHOULD NOT BE USED WITHOUT WRITTEN PERMISSION |

19 18 17 16 15 14 13 12 11 10 9 8 7 6 5 4 3 2 1

