



Chipsmall Limited consists of a professional team with an average of over 10 year of expertise in the distribution of electronic components. Based in Hongkong, we have already established firm and mutual-benefit business relationships with customers from,Europe,America and south Asia,supplying obsolete and hard-to-find components to meet their specific needs.

With the principle of “Quality Parts,Customers Priority,Honest Operation,and Considerate Service”,our business mainly focus on the distribution of electronic components. Line cards we deal with include Microchip,ALPS,ROHM,Xilinx,Pulse,ON,Everlight and Freescale. Main products comprise IC,Modules,Potentiometer,IC Socket,Relay,Connector.Our parts cover such applications as commercial,industrial, and automotives areas.

We are looking forward to setting up business relationship with you and hope to provide you with the best service and solution. Let us make a better world for our industry!



## Contact us

Tel: +86-755-8981 8866 Fax: +86-755-8427 6832

Email & Skype: info@chipsmall.com Web: www.chipsmall.com

Address: A1208, Overseas Decoration Building, #122 Zhenhua RD., Futian, Shenzhen, China



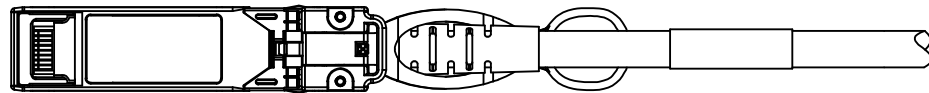
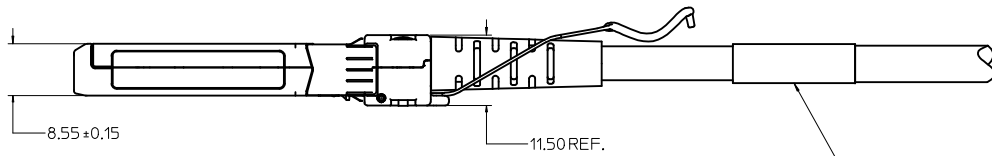
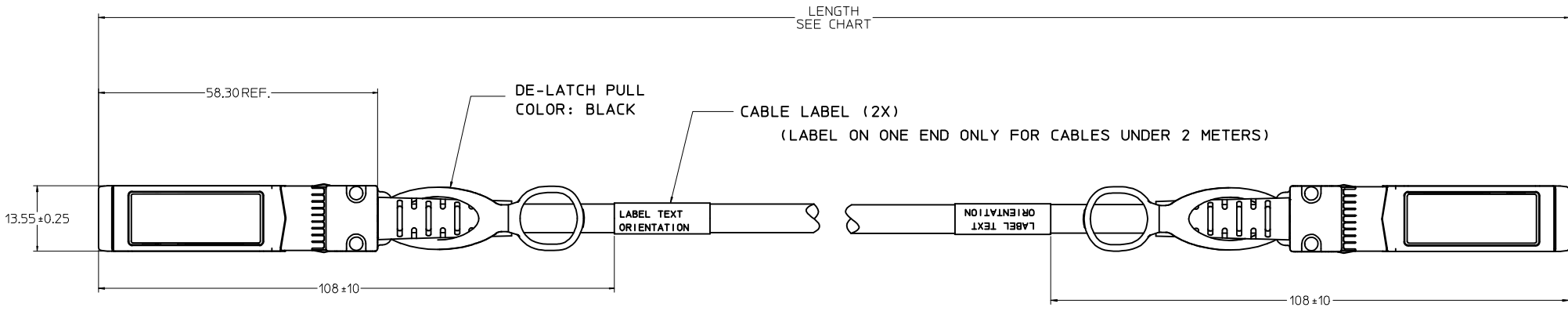

**NOTES:**

1. MATERIALS  
 BACKSHELLS - NICKEL PLATED ZINC  
 DE-LATCH - PLASTIC  
 PCB - FR-4  
 RIVETS - STAINLESS STEEL
2. IMPEDANCE - 100 OHMS DIFFERENTIAL, PASSIVE
3. PULL TO RELEASE, PLUNGER STYLE LATCH
4. EACH ASSEMBLY HAS A SERIAL ID
5. 11.09 Gbps BACKWARDS COMPATIBLE TO 1.0625 Gbps
6. LEAD FREE, NO RoHS EXEMPTIONS

ADDED P/NS IEC NO: CPG2013-0507 DRAWN BY: DRWN:GBARELLA CHKD:PSYTSMA APPR:RMKCHAN 2012/08/16 2012/08/24 2012/08/27	DESCRIPTION REVISIONS 1 2 3	QUALITY SYMBOLS		GENERAL TOLERANCES (UNLESS SPECIFIED)		DIMENSION STYLE		SCALE	DESIGN UNITS	THIRD ANGLE PROJECTION
		∇=0 ∇=0 ∇=0		mm    INCH 4 PLACES ± --- ± --- 3 PLACES ± --- ± --- 2 PLACES ± --- ± --- 1 PLACE ± --- ± --- 0 PLACE ±    ±		MM ONLY DRAWN BY: JERWIN DATE: 2007/01/30 CHECKED BY: K LLOYD DATE: 2007/01/30 APPROVED BY: RMAHMOOD DATE: 2007/01/30		2:1	METRIC	TITLE SFP+ PASSIVE 10G CABLE ASSEMBLY
		ANGULAR ± --- ° DRAFT WHERE APPLICABLE MUST REMAIN WITHIN DIMENSIONS		MATERIAL NO. SEE CHART		DOCUMENT NO. SD-74752-001		SHEET NO. 1 OF 4		
		SIZE D THIS DRAWING CONTAINS INFORMATION THAT IS PROPRIETARY TO MOLEX INCORPORATED AND SHOULD NOT BE USED WITHOUT WRITTEN PERMISSION								





REVISION HISTORY		
DATE	REV	DESCRIPTION
2012-08-16	P	1. ADDED P/N'S 747524541 AND 747524571
		2. MOVED WIRING DIAGRAM FROM PAGE 1 TO PAGE 2 AND ADDED LOW SPEED SIGNAL CHART
		3. MOVED LABEL DETAIL TO PAGE 3
		4. ADDED NEW VIEW OF SFP+ THAT SHOWS PCB.
		5. REMOVED P/N'S 747529009, 74759011 & 747529012
		6. INCREASED SIZE OF VIEWS ON PAGE 1.

<b>ADDED P/N'S</b> IEC NO: CPG2013-0507 DRAWN BY: DRWN:GARDIELLA 2012/08/16 CHECKED BY: CHYKOPSYTSA 2012/08/24 APPR:RKHAN 2012/08/27	QUALITY SYMBOLS ∇=0 ∇=0 ∇=0	GENERAL TOLERANCES (UNLESS SPECIFIED) <table border="1"> <tr> <td></td> <td>mm</td> <td>INCH</td> </tr> <tr> <td>4 PLACES</td> <td>±---</td> <td>±---</td> </tr> <tr> <td>3 PLACES</td> <td>±---</td> <td>±---</td> </tr> <tr> <td>2 PLACES</td> <td>±---</td> <td>±---</td> </tr> <tr> <td>1 PLACE</td> <td>±---</td> <td>±---</td> </tr> <tr> <td>0 PLACE</td> <td>±</td> <td>±</td> </tr> </table>		mm	INCH	4 PLACES	±---	±---	3 PLACES	±---	±---	2 PLACES	±---	±---	1 PLACE	±---	±---	0 PLACE	±	±	DIMENSION STYLE <b>MM ONLY</b>	SCALE <b>1:1</b>	DESIGN UNITS <b>METRIC</b>	THIRD ANGLE PROJECTION 
		mm	INCH																					
	4 PLACES	±---	±---																					
	3 PLACES	±---	±---																					
2 PLACES	±---	±---																						
1 PLACE	±---	±---																						
0 PLACE	±	±																						
			DRAWN BY: JERWIN DATE: 2007/01/30	CHECKED BY: KLOYD DATE: 2007/01/30	APPROVED BY: RMAHMOOD DATE: 2007/01/30	TITLE <b>SFP+ PASSIVE 10G CABLE ASSEMBLY</b>																		
		ANGULAR ±---° DRAFT WHERE APPLICABLE MUST REMAIN WITHIN DIMENSIONS	MATERIAL NO: <b>SEE CHART</b>	DOCUMENT NO. <b>SD-74752-001</b>	SHEET NO. <b>4 OF 4</b>																			
			THIS DRAWING CONTAINS INFORMATION THAT IS PROPRIETARY TO MOLEX INCORPORATED AND SHOULD NOT BE USED WITHOUT WRITTEN PERMISSION																					