



Chipsmall Limited consists of a professional team with an average of over 10 year of expertise in the distribution of electronic components. Based in Hongkong, we have already established firm and mutual-benefit business relationships with customers from,Europe,America and south Asia,supplying obsolete and hard-to-find components to meet their specific needs.

With the principle of “Quality Parts,Customers Priority,Honest Operation,and Considerate Service”,our business mainly focus on the distribution of electronic components. Line cards we deal with include Microchip,ALPS,ROHM,Xilinx,Pulse,ON,Everlight and Freescale. Main products comprise IC,Modules,Potentiometer,IC Socket,Relay,Connector.Our parts cover such applications as commercial,industrial, and automotives areas.

We are looking forward to setting up business relationship with you and hope to provide you with the best service and solution. Let us make a better world for our industry!



Contact us

Tel: +86-755-8981 8866 Fax: +86-755-8427 6832

Email & Skype: info@chipsmall.com Web: www.chipsmall.com

Address: A1208, Overseas Decoration Building, #122 Zhenhua RD., Futian, Shenzhen, China



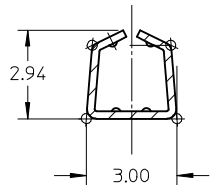

SECTION Z-Z

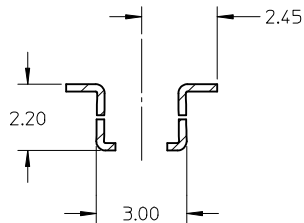

SECTION Y-Y

△ BEND WING TYPE

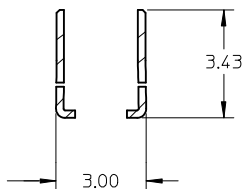

SECTION Y-Y

STRAIGHT WING TYPE △

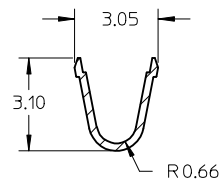

SECTION X-X

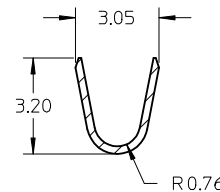

SECTION U-U

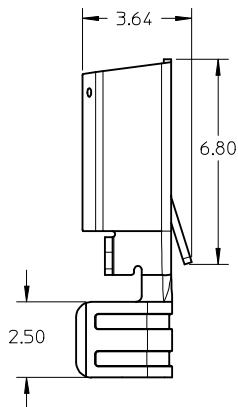
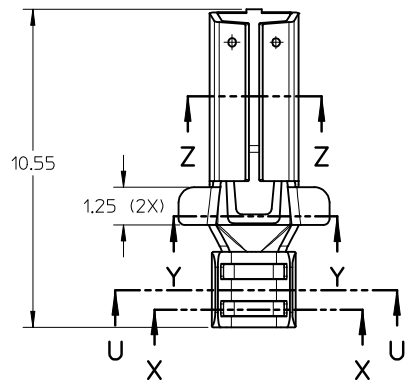
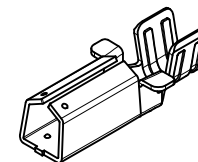

BEND WING TYPE △

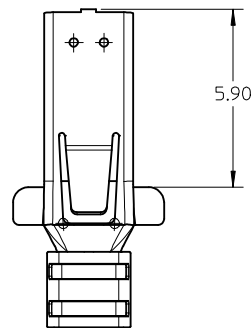

STRAIGHT WING TYPE △

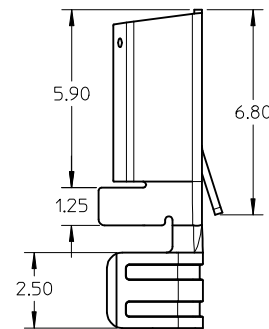

NOTES:

- MATERIAL : COPPER ALLOY
PLATING SPEC.: 0.94μm MIN. TIN OVER 0.54μm MIN. NICKEL UNDERPLATE.
- HOUSING TO BE USED WITH : SEE TABLE.
- CRIMP SPECIFICATION : CS-78036-001
- PRODUCT SPECIFICATION : SEE TABLE
- PACKAGING INFORMATION : PAPER REEL
- △ THE FIGURE SHOWN IS FOR ILLUSTRATION PURPOSE.
IT IS APPLIED TO BOTH STRAIGHT AND BEND WING TYPE.
- △ REFER TO TABLE FOR PART NUMBER.

ADD DIM 3.64	EC NO: S2009-0512	2009/02/06	QUALITY SYMBOLS
	DRWN:GEMEARLY	2009/02/06	
A2	CHKD:CGOH	2009/02/06	▽=0
	APPR:BOKKOK	2009/02/06	∇=0

DESCRIPTION
REV

GENERAL TOLERANCES (UNLESS SPECIFIED)	mm	INCH
	4 PLACES ± ---	± ---
DRAFT WHERE APPLICABLE MUST REMAIN WITHIN DIMENSIONS	3 PLACES ± ---	± ---
	2 PLACES ± 0.30	± ---
ANGULAR ± 3 °	1 PLACE ± ---	± ---
	DRAFT WHERE APPLICABLE MUST REMAIN WITHIN DIMENSIONS	

DIMENSION STYLE		SCALE	DESIGN UNITS	THIRD ANGLE PROJECTION
MM ONLY		NTS	METRIC	∇
DRAWN BY	DATE	TITLE		
BOKKOK	2007/02/26	PROJECTOR LAMP CONNECTOR		
CHECKED BY	DATE	13MM PITCH, RECEPTACLE		
CGOH	2007/03/01	TERMINAL		
APPROVED BY	DATE	MOLEX INCORPORATED		
KCLING	2007/03/01	SD-78036-003		
MATERIAL NO.	DOCUMENT NO.	SHEET NO.		
SEE TABLE	SEE TABLE	1 OF 3		

THIS DRAWING CONTAINS INFORMATION THAT IS PROPRIETARY TO MOLEX INCORPORATED AND SHOULD NOT BE USED WITHOUT WRITTEN PERMISSION	
---	--

10 9 8 7 6 5 4 3 2 1

F

E

D

C

B

A

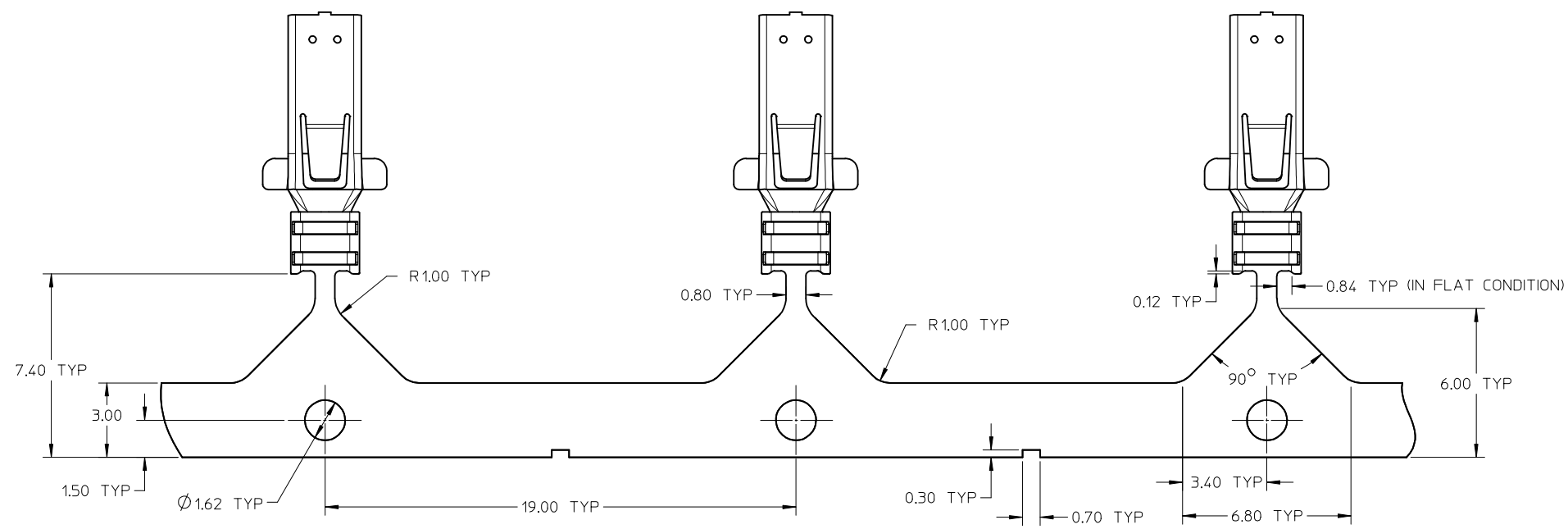

TERMINAL LAYOUT $\triangle 6$

ADD DIM 3.64 EC NO: S2009-0512 DRWN:EMENARLY 2009/02/06 CHKD:CGOH 2009/02/06 APPR:BOKOK 2009/02/06	QUALITY SYMBOLS	GENERAL TOLERANCES (UNLESS SPECIFIED)		DIMENSION STYLE	SCALE	DESIGN UNITS	THIRD ANGLE PROJECTION		
	$\nabla=0$	mm	INCH	MM ONLY	NTS	METRIC			
	$\triangle 6=0$	4 PLACES	± ---	± ---	DRAWN BY	DATE	TITLE		
		3 PLACES	± ---	± ---	BOKOK	2007/02/26	PROJECTOR LAMP CONNECTOR 13MM PITCH, RECEPTACLE TERMINAL		
	2 PLACES	± 0.30	± ---	CHECKED BY	DATE	MOLEX INCORPORATED DOCUMENT NO. SD-78036-003 SHEET NO. 2 OF 3			
	1 PLACE	± ---	± ---	CGOH	2007/03/01				
		ANGULAR ± 3 °		APPROVED BY	DATE				
		DRAFT WHERE APPLICABLE MUST REMAIN WITHIN DIMENSIONS		KCL ING	2007/03/01				
				MATERIAL NO.	SEE TABLE				
				SIZE	THIS DRAWING CONTAINS INFORMATION THAT IS PROPRIETARY TO MOLEX INCORPORATED AND SHOULD NOT BE USED WITHOUT WRITTEN PERMISSION				
				A3					

9 8 7 6 5 4 3 2 1

10 9 8 7 6 5 4 3 2 1

F

E

D

C

B

A

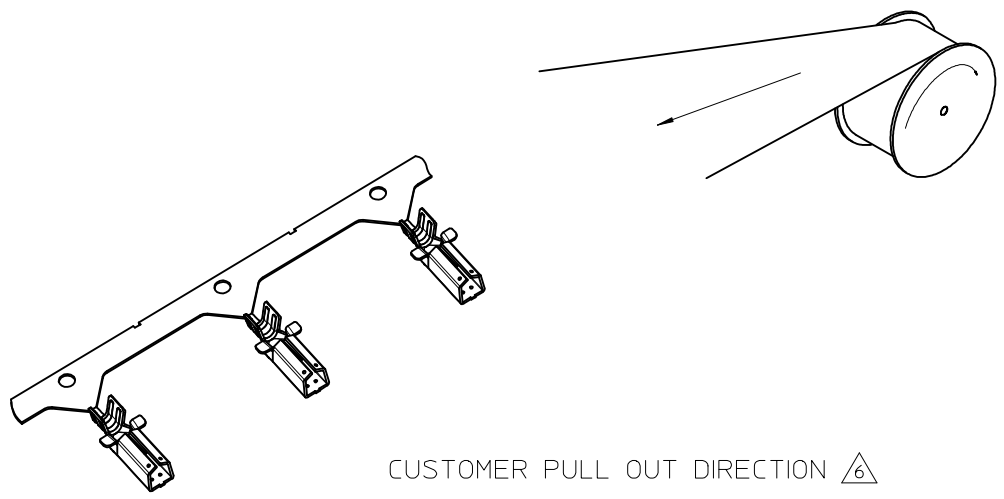

CUSTOMER PULL OUT DIRECTION $\triangle 6$

ADD DIM 3.64 EC NO: S2009-0512 DRW: NIGMENARLY 2009/02/06 CHK: D:CGOH 2009/02/06 APPR: BOKOK 2009/02/06	QUALITY SYMBOLS $\blacktriangledown = 0$ $\triangle = 0$	GENERAL TOLERANCES (UNLESS SPECIFIED)		DIMENSION STYLE MM ONLY		SCALE NTS	DESIGN UNITS METRIC	\odot \square THIRD ANGLE PROJECTION		
			mm	INCH	DRAWN BY BOKOK	DATE 2007/02/26	TITLE PROJECTOR LAMP CONNECTOR 13MM PITCH, RECEPTACLE TERMINAL			
		4 PLACES	\pm ---	\pm ---	CHECKED BY CGOH	DATE 2007/03/01	MOLEX INCORPORATED			
		3 PLACES	\pm ---	\pm ---	APPROVED BY KCLING	DATE 2007/03/01	MATERIAL NO. SEE TABLE	DOCUMENT NO. SD-78036-003	SHEET NO. 3 OF 3	
2 PLACES	\pm 0.30	\pm ---	ANGULAR $\pm 3^\circ$		THIS DRAWING CONTAINS INFORMATION THAT IS PROPRIETARY TO MOLEX INCORPORATED AND SHOULD NOT BE USED WITHOUT WRITTEN PERMISSION					
1 PLACE	\pm ---	\pm ---	DRAFT WHERE APPLICABLE MUST REMAIN WITHIN DIMENSIONS							

9 8 7 6 5 4 3 2 1