



Chipsmall Limited consists of a professional team with an average of over 10 year of expertise in the distribution of electronic components. Based in Hongkong, we have already established firm and mutual-benefit business relationships with customers from,Europe,America and south Asia,supplying obsolete and hard-to-find components to meet their specific needs.

With the principle of “Quality Parts,Customers Priority,Honest Operation,and Considerate Service”,our business mainly focus on the distribution of electronic components. Line cards we deal with include Microchip,ALPS,ROHM,Xilinx,Pulse,ON,Everlight and Freescale. Main products comprise IC,Modules,Potentiometer,IC Socket,Relay,Connector.Our parts cover such applications as commercial,industrial, and automotives areas.

We are looking forward to setting up business relationship with you and hope to provide you with the best service and solution. Let us make a better world for our industry!



Contact us

Tel: +86-755-8981 8866 Fax: +86-755-8427 6832

Email & Skype: info@chipsmall.com Web: www.chipsmall.com

Address: A1208, Overseas Decoration Building, #122 Zhenhua RD., Futian, Shenzhen, China



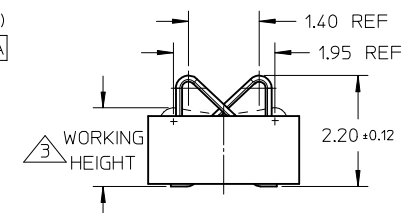
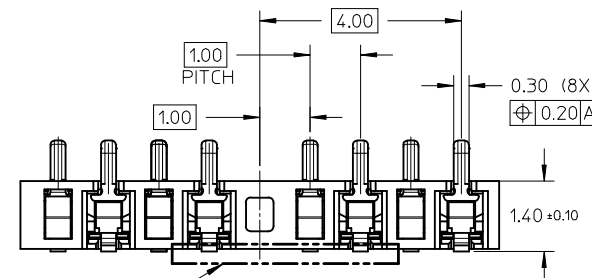
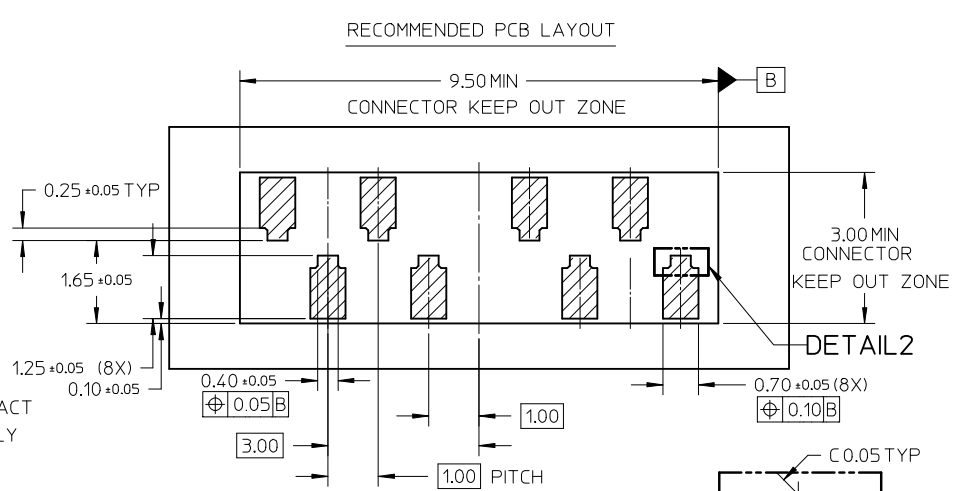
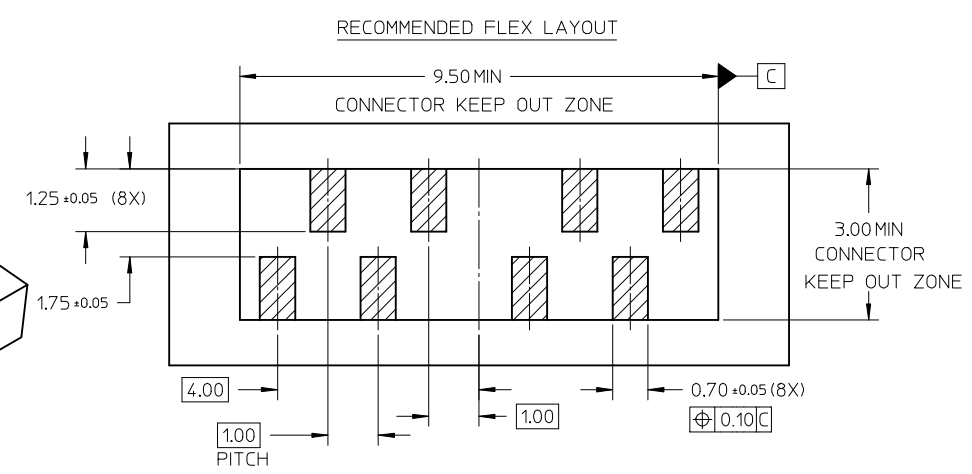
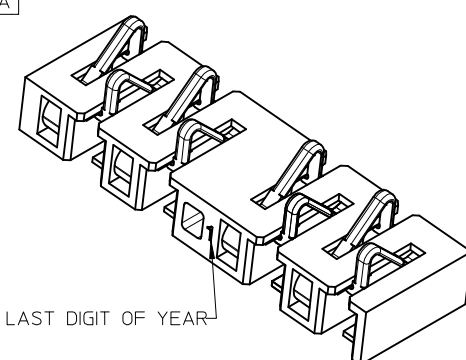
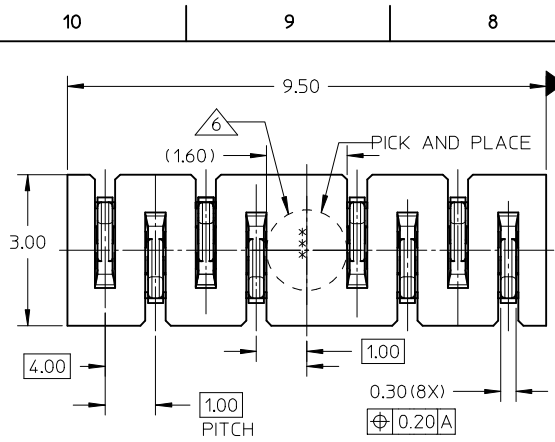

DETAIL1

TERMINAL PLATING SPECIFICATION

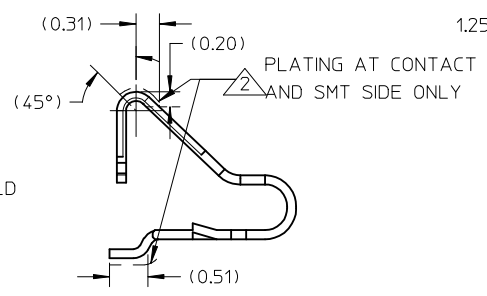

Soldertail High-Low No more than 0.10mm

- NOTES:
- MATERIALS:
HOUSING: LCP, 30% GLASS FILLED, COLOUR: BLACK
CONTACT: TITANIUM COPPER TiCu
 - FINISH:
CONTACT AREA: 0.38 MICROMETER (15 MICRO-INCH) MIN. GOLD OVER 1.27 MICROMETER (50 MICRO-INCH) MIN NICKEL UNDERPLATE.
SMT TAIL AREA: 1.27 MICROMETER (50 MICRO-INCH MIN.) PURE TIN (MATTE) OVER 1.27 MICROMETER (50 MICRO-INCH) MIN. NICKEL UNDERPLATE.
OTHER AREA PLATING: 1.27 MICROMETER (50 MICRO-INCH) MIN NICKEL OVERALL
 - AT 1.63mm WORKING HEIGHT, FORCE IS 50g +25g/-10g AT LOADING CURVE
AT 1.75mm WORKING HEIGHT, FORCE IS 35g MIN AT LOADING CURVE
 - PRODUCT SPECIFICATION SEE TBA.
 - LAST DIGIT OF THE YEAR TO BE LOCATED.
 - DATE CODE TO BE LOCATED.

REVISED EC NO: S2014-0117 2013/07/31 DRINK: JAKH 2013/08/07 CHKD: JESSIECHUA 2013/08/07 APPR: SHONG	DESCRIPTION	QUALITY SYMBOLS	GENERAL TOLERANCES (UNLESS SPECIFIED)		DIMENSION STYLE	SCALE	DESIGN UNITS	THIRD ANGLE PROJECTION		
		$F_A=0$ $F_E=0$ $F_B=0$	mm	INCH	MM ONLY	NTS	METRIC	8 CIRCUITS COMPRESSION CONNECTOR		
			4 PLACES ± --- ± ---	DRAWN BY	DATE	TITLE				
			3 PLACES ± --- ± ---	CHECKED BY	DATE					
A1	REV	ANGULAR ± 3°	DRAFT WHERE APPLICABLE MUST REMAIN WITHIN DIMENSIONS		APPROVED BY	DATE	MOLEX INCORPORATED			
					SHONG	2013/08/07	SD-78732-821			
					MATERIAL NO.	DOCUMENT NO.	SHEET NO.			
					78732-8021		1 OF 1			
					SIZE	THIS DRAWING CONTAINS INFORMATION THAT IS PROPRIETARY TO MOLEX INCORPORATED AND SHOULD NOT BE USED WITHOUT WRITTEN PERMISSION				
					A3					