



Chipsmall Limited consists of a professional team with an average of over 10 year of expertise in the distribution of electronic components. Based in Hongkong, we have already established firm and mutual-benefit business relationships with customers from,Europe,America and south Asia,supplying obsolete and hard-to-find components to meet their specific needs.

With the principle of “Quality Parts,Customers Priority,Honest Operation,and Considerate Service”,our business mainly focus on the distribution of electronic components. Line cards we deal with include Microchip,ALPS,ROHM,Xilinx,Pulse,ON,Everlight and Freescale. Main products comprise IC,Modules,Potentiometer,IC Socket,Relay,Connector.Our parts cover such applications as commercial,industrial, and automotives areas.

We are looking forward to setting up business relationship with you and hope to provide you with the best service and solution. Let us make a better world for our industry!



## Contact us

Tel: +86-755-8981 8866 Fax: +86-755-8427 6832

Email & Skype: [info@chipsmall.com](mailto:info@chipsmall.com) Web: [www.chipsmall.com](http://www.chipsmall.com)

Address: A1208, Overseas Decoration Building, #122 Zhenhua RD., Futian, Shenzhen, China



MATERIAL NUMBER	LED BACKLIGHT COLOR	DESCRIPTION
79540-5015	BLUE	470nm ±10nm
79540-5016	AMBER	587nm ±8nm

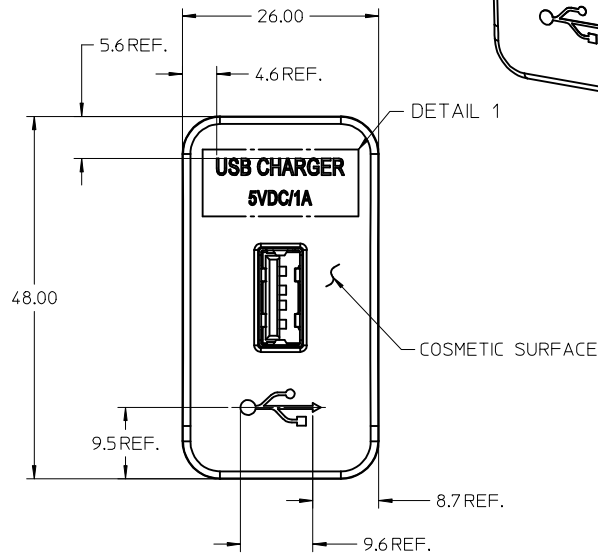
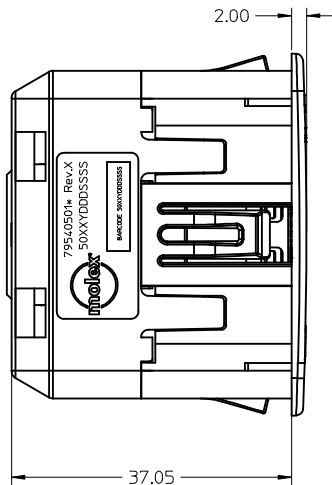
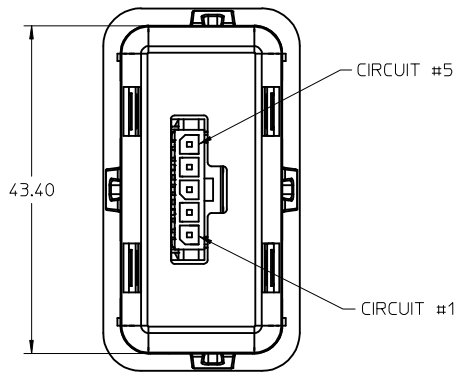
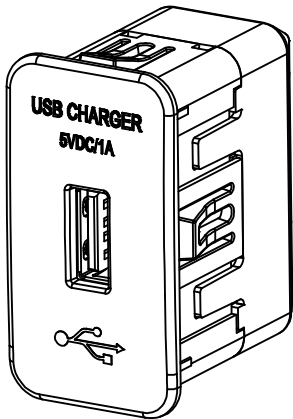
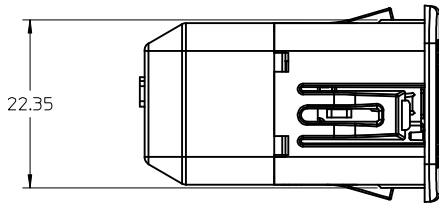

- NOTES:
- 1.- ASSEMBLY ACCORDING TO IPC-A-600 CLASS 2.
  - 2.- PRINTED GRAPHICS AND TEXT COLOR WHITE
  - 3.- DETAIL 1 TEXT TO BE ARIAL NARROW.
  - 4.- COSMETIC SURFACE FINISHING ACCORDING TO MT11010.
  - 5.- HOUSING MATERIAL: PC+ABS, COLOR BLACK
  - 6.- INPUT: 9VDC - 16VDC
  - 7.- OUTPUT 5VDC ±5% 1.0 AMP MAXIMUM
  - 8.- USE MOLEX P/N 0436450500 FOR INPUT CONNECTOR.
  - 9.- SEE MOLEX PS-79540-5002 FOR PERFORMANCE DETAILS.

PIN-OUT	
PIN	SIGNAL
1	GND
2	BATTERY +
3	BACKLIGHT
4	---
5	---

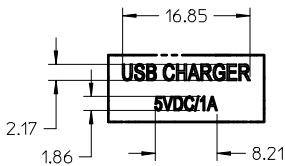

DETAIL 1  
Scale 2:1

LABEL DETAILS



\*: 5 OR 6 (SEE CHART)  
 X: REVISION LEVEL  
 Y: YEAR  
 DDD: DAY OF THE YEAR  
 SSSS: CONSECUTIVE NUMBER

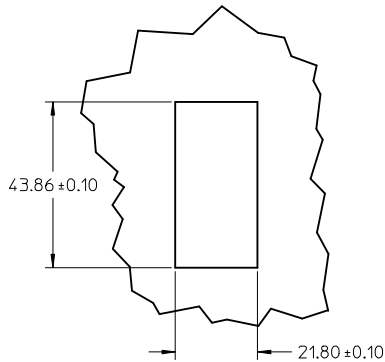

**RECOMMENDED PANEL**  
 THICKNESS: MIN: 3.36mm  
 MAX: 3.81mm  
 MEDIAN: 3.51mm

REVISED		QUALITY SYMBOLS		GENERAL TOLERANCES (UNLESS SPECIFIED)		DIMENSION STYLE		SCALE	DESIGN UNITS	THIRD ANGLE PROJECTION	
EC NO: PCB2015-0052		DESCRIPTION		mm		MM ONLY		2:1	METRIC		
DRAWN BY		DATE		±		DATE		TITLE			
CHECKED BY		DATE		±		DATE					
APPROVED BY		DATE		±		DATE					
MATERIAL NO.		DATE		±		DATE					
SIZE		ANGULAR ±		±		±					
DRAFT WHERE APPLICABLE		MUST REMAIN WITHIN DIMENSIONS		±		±					
SEE CHART		DOCUMENT NO.		SD-79540-5015		SHEET NO.		1 OF 1			
THIS DRAWING CONTAINS INFORMATION THAT IS PROPRIETARY TO MOLEX INCORPORATED AND SHOULD NOT BE USED WITHOUT WRITTEN PERMISSION											