



Chipsmall Limited consists of a professional team with an average of over 10 year of expertise in the distribution of electronic components. Based in Hongkong, we have already established firm and mutual-benefit business relationships with customers from,Europe,America and south Asia,supplying obsolete and hard-to-find components to meet their specific needs.

With the principle of “Quality Parts,Customers Priority,Honest Operation,and Considerate Service”,our business mainly focus on the distribution of electronic components. Line cards we deal with include Microchip,ALPS,ROHM,Xilinx,Pulse,ON,Everlight and Freescale. Main products comprise IC,Modules,Potentiometer,IC Socket,Relay,Connector.Our parts cover such applications as commercial,industrial, and automotives areas.

We are looking forward to setting up business relationship with you and hope to provide you with the best service and solution. Let us make a better world for our industry!



Contact us

Tel: +86-755-8981 8866 Fax: +86-755-8427 6832

Email & Skype: info@chipsmall.com Web: www.chipsmall.com

Address: A1208, Overseas Decoration Building, #122 Zhenhua RD., Futian, Shenzhen, China



13 12 11 10 9 8 7 6 5 4 3 2 1

| EDP NO. | ENG NO. |
|------------|----------------|
| 08-01-0101 | I797-AA(P909) |
| 08-01-0102 | I797-AA(P909)L |
| 08-06-0101 | I797-AA(550) |
| 08-06-0102 | I797-AA(550)L |
| 08-05-0103 | I797-AA(555) |
| 08-05-0104 | I797-AA(555)L |
| 08-03-0101 | I797-BA(P909) |
| 08-03-0102 | I797-BA(P909)L |
| 08-07-0101 | I797-BA(550) |
| 08-07-0102 | I797-BA(550)L |
| - - | I797-BA(555) |
| - - | I797-BA(555)L |

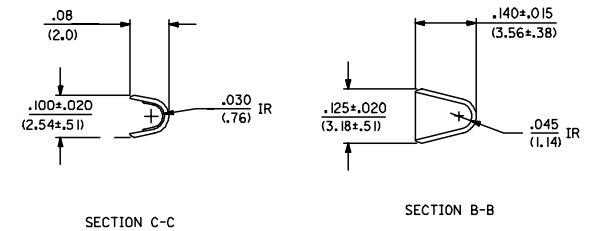
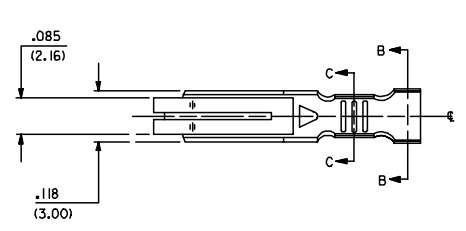

SECTION C-C SECTION B-B

18/24 AWG CRIMP

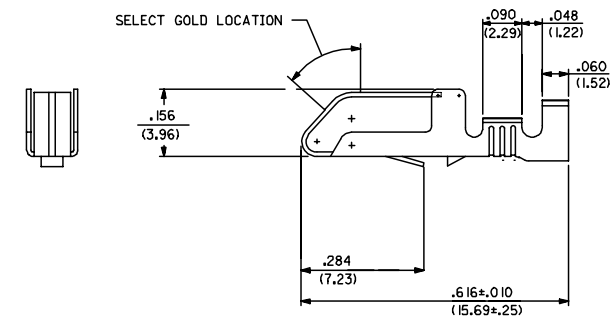

- NOTES:
1. MATERIAL: SEE LEGEND
 2. FINISH: (P909) - OVERALL HOT TIN DP: .000100/(0.00254) MIN
(550) - SELECT GOLD: .000015/(0.00038) MIN.
OVERALL GOLD FLASH: .000002/(0.00005) MIN.
OVERALL NICKEL UNDERPLATE: .000030/(0.00076) MIN.
(555) - SELECT GOLD: .000015/(0.00038) MIN.
OVERALL NICKEL UNDERPLATE: .000030/(0.00076) MIN.
 - *THE PRIMARY SHIPPING CARTON WILL BE LABELED TO COMPLY WITH RoHS DIRECTIVE 2002/95/EC AND ELV ANNEX II OF DIRECTIVE 2000/53/EC. CARTONS WITHOUT THIS LABEL MAY CONTAIN PRODUCT WITH TIN-LEAD PLATING.
 3. PRODUCT SPECIFICATION: PS-08-50
 4. TERMINALS AVAILABLE IN CHAIN OR LOOSE FORM. SEE LEGEND.
 5. DIMENSIONS GIVEN ACROSS CENTERLINES ARE SYMMETRICAL ABOUT THOSE CENTERLINES WITHIN HALF THE TOTAL TOLERANCE.
 6. PART CONFORMS TO CLASS B REQUIREMENTS OF COSMETIC SPECIFICATION PS-45499-002.

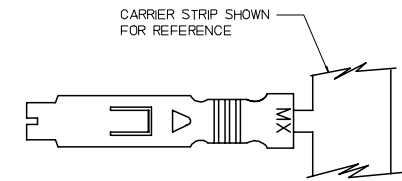

MATERIAL:
A= .011 THK BRASS
B= .011 THK PHOS BRONZE

WIRE SIZE
A=18 TO 24 AWG WIRE (SEE SHEET 1)
INS DIA. .060/.120
B=24 TO 30 AWG WIRE (SEE SHEET 2)
INS DIA. .040/.090
C=16 AWG WIRE (SEE SHEET 2)
INS DIA. .098 MAX

1797- ** (***)*
BLANK=CHAIN
L=LOOSE

PLATING
SEE NOTE 2

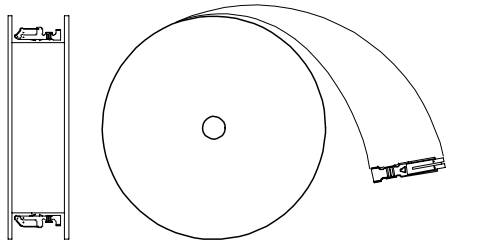

WINDING DIRECTION

| | | | | | |
|---|---------------------|--|---|--|------------------------|
| UPDATE NOTES FC NO: UCP2008-0273 DRAWN BY: DRW:ADERR 2007/10/03 CHK'D:LS:HM DT 2007/10/08 APPR:FSM TH 2007/10/09 REVISION: Y1 | QUALITY SYMBOLS | GENERAL TOLERANCES (UNLESS SPECIFIED) mm INCH 4 PLACES ± --- ± --- 3 PLACES ± --- ± .010 2 PLACES ± 0.25 ± .02 1 PLACE ± 0.5 ± --- ANGULAR ±1/2° | DIMENSION STYLE IN/MM DRAWN BY: SAMIEC DATE: 1992/08/13 CHECKED BY: ROBERTS DATE: 1992/08/13 APPROVED BY: LENZ DATE: 1992/08/13 | SCALE: --- DESIGN UNITS: INCH THIRD ANGLE PROJECTION | SHEET NO. 2 OF 2 Y1 |
| | | DRAFT WHERE APPLICABLE MUST REMAIN WITHIN DIMENSIONS | MATERIAL NO. SEE CHART DOCUMENT NO. SD-1797 | MOLEX INCORPORATED | SHEET NO. 1 OF 2 |

12 11 10 9 8 7 6 5 4 3 2 1

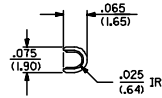
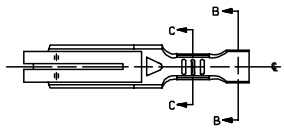

SECTION C-C

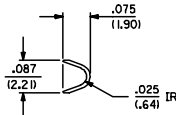

SECTION B-B

24-30 AWG CRIMP

| EDP NO. | ENG NO. |
|------------|----------------|
| 08-01-0105 | I797-AB(P909) |
| 08-01-0106 | I797-AB(P909)L |
| | |
| 08-06-0105 | I797-AB(550) |
| 08-06-0106 | I797-AB(550)L |
| 08-05-0105 | I797-AB(555) |
| 08-05-0106 | I797-AB(555)L |
| 08-03-0103 | I797-BB(P909) |
| 08-03-0104 | I797-BB(P909)L |
| | |
| - - | I797-BB(550) |
| - - | I797-BB(550)L |
| - - | I797-BB(555) |
| - - | I797-BB(555)L |

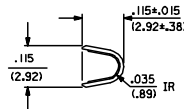
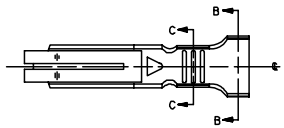

SECTION C-C

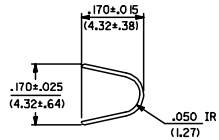

SECTION B-B

16 AWG CRIMP

| EDP NO. | ENG NO. |
|------------|----------------|
| 08-01-0116 | I797-AC(P909) |
| - - | I797-AC(P909)L |
| | |
| - - | I797-AC(550) |
| - - | I797-AC(550)L |
| - - | I797-AC(555) |
| - - | I797-AC(555)L |
| - - | I797-BC(P909) |
| - - | I797-BC(P909)L |
| | |
| - - | I797-BC(550) |
| - - | I797-BC(550)L |
| - - | I797-BC(555) |
| - - | I797-BC(555)L |

| | | | | | | | | |
|--|-------------------------------|---|-----------------------|--------------------------|------------------------------------|-------------------------|----------------------|------------------------|
| ADD 08-05-0106 DEC NO: UCP2008-0273 DRAWN BY: CHKCLSCHMIDT APPROVED BY: CHKCLSCHMIDT AA1 | QUALITY SYMBOLS ▽=0 ▽=0 | GENERAL TOLERANCES (UNLESS SPECIFIED) | | DIMENSION STYLE IN/MM | | SCALE --- | DESIGN UNITS INCH | THIRD ANGLE PROJECTION |
| | | 4 PLACES ± --- ± --- | DRAWN BY SAMIEC | DATE 1992/08/13 | TITLE CRIMP TERMINAL BIFURCATED | | | |
| | | 3 PLACES ± --- ± .010 | CHECKED BY ROBERTS | DATE 1992/08/13 | MOLEX INCORPORATED | | | |
| | | 2 PLACES ± 0.25 ± .02 1 PLACE ± 0.5 ± --- ANGULAR ±1/2° | APPROVED BY LENZ | DATE 1992/08/13 | MATERIAL NO. SEE CHART | DOCUMENT NO. SD-1797 | SHEET NO. 2 OF 2 | |
| DRAFT WHERE APPLICABLE MUST REMAIN WITHIN DIMENSIONS | | THIS DRAWING CONTAINS INFORMATION THAT IS PROPRIETARY TO MOLEX INCORPORATED AND SHOULD NOT BE USED WITHOUT WRITTEN PERMISSION | | | | | | |