



Chipsmall Limited consists of a professional team with an average of over 10 year of expertise in the distribution of electronic components. Based in Hongkong, we have already established firm and mutual-benefit business relationships with customers from,Europe,America and south Asia,supplying obsolete and hard-to-find components to meet their specific needs.

With the principle of “Quality Parts,Customers Priority,Honest Operation,and Considerate Service”,our business mainly focus on the distribution of electronic components. Line cards we deal with include Microchip,ALPS,ROHM,Xilinx,Pulse,ON,Everlight and Freescale. Main products comprise IC,Modules,Potentiometer,IC Socket,Relay,Connector.Our parts cover such applications as commercial,industrial, and automotives areas.

We are looking forward to setting up business relationship with you and hope to provide you with the best service and solution. Let us make a better world for our industry!



Contact us

Tel: +86-755-8981 8866 Fax: +86-755-8427 6832

Email & Skype: info@chipsmall.com Web: www.chipsmall.com

Address: A1208, Overseas Decoration Building, #122 Zhenhua RD., Futian, Shenzhen, China



Cable sleeve - CES-LRG-BK-16 - 0801621

Please be informed that the data shown in this PDF Document is generated from our Online Catalog. Please find the complete data in the user's documentation. Our General Terms of Use for Downloads are valid (<http://phoenixcontact.com/download>)

Large, slotted cable sleeves suitable for cables with a diameter of 15 ... 16 mm, material: NBR



Product Description

Slotted sleeves for accommodating pre-assembled cables and lines with a diameter of 15 ... 16 mm, can be used in CES sealing frames. When fitted, the sleeves also ensure strain relief according to DIN EN 50262.



Key Commercial Data

| | |
|--------------------------------------|----------|
| Packing unit | 1 pc |
| Minimum order quantity | 10 pc |
| Weight per Piece (excluding packing) | 31.0 g |
| Custom tariff number | 40169300 |
| Country of origin | Taiwan |

Technical data

Dimensions

| | |
|-------------------------|--------------------|
| External cable diameter | 1x 15 mm ... 16 mm |
| Length | 53 mm |
| Width | 39 mm |
| Height | 17 mm |

Ambient conditions

| | |
|---------------------------------|---|
| Degree of protection | IP54 (for sealing frames with screw locking. IP44 sealing frames with locking latch.) |
| Ambient temperature (operation) | -40 °C ... 125 °C (static) |

General

| | |
|---------------------|--|
| Product description | Slotted sleeves for accommodating pre-assembled cables and lines with a diameter of 15 ... 16 mm, can be used in CES sealing frames. When fitted, the sleeves also ensure strain relief according to DIN EN 50262. |
|---------------------|--|

Cable sleeve - CES-LRG-BK-16 - 0801621

Technical data

General

| | |
|-------------------|-------|
| No. of conductors | 1 |
| Material | NBR |
| Color | black |

Classifications

eCl@ss

| | |
|------------|----------|
| eCl@ss 4.0 | 27081002 |
| eCl@ss 4.1 | 27081002 |
| eCl@ss 5.0 | 27081002 |
| eCl@ss 5.1 | 27081002 |
| eCl@ss 6.0 | 27081002 |
| eCl@ss 7.0 | 27081002 |
| eCl@ss 8.0 | 27069216 |

ETIM

| | |
|----------|----------|
| ETIM 3.0 | EC000879 |
| ETIM 4.0 | EC000451 |
| ETIM 5.0 | EC000451 |

UNSPSC

| | |
|---------------|----------|
| UNSPSC 6.01 | 30212109 |
| UNSPSC 7.0901 | 39121708 |
| UNSPSC 11 | 39121708 |
| UNSPSC 12.01 | 39121708 |
| UNSPSC 13.2 | 39121708 |

Approvals

Approvals

Approvals

GL

Ex Approvals

Cable sleeve - CES-LRG-BK-16 - 0801621

Approvals

Approvals submitted

Approval details

| |
|----|
| GL |
|----|

Drawings

Dimensional drawing

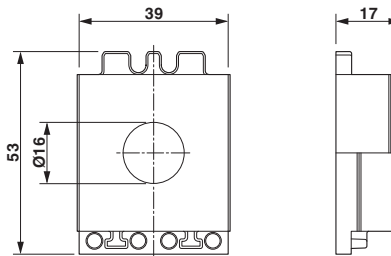

Dimensional drawing