



Chipsmall Limited consists of a professional team with an average of over 10 year of expertise in the distribution of electronic components. Based in Hongkong, we have already established firm and mutual-benefit business relationships with customers from,Europe,America and south Asia,supplying obsolete and hard-to-find components to meet their specific needs.

With the principle of “Quality Parts,Customers Priority,Honest Operation,and Considerate Service”,our business mainly focus on the distribution of electronic components. Line cards we deal with include Microchip,ALPS,ROHM,Xilinx,Pulse,ON,Everlight and Freescale. Main products comprise IC,Modules,Potentiometer,IC Socket,Relay,Connector.Our parts cover such applications as commercial,industrial, and automotives areas.

We are looking forward to setting up business relationship with you and hope to provide you with the best service and solution. Let us make a better world for our industry!



Contact us

Tel: +86-755-8981 8866 Fax: +86-755-8427 6832

Email & Skype: info@chipsmall.com Web: www.chipsmall.com

Address: A1208, Overseas Decoration Building, #122 Zhenhua RD., Futian, Shenzhen, China



TECHNICAL SPECIFICATIONS:

1- MATERIAL :

HOUSING : LCP GLASS FILLED UL 94 V-0 COLOUR: BLACK
 TERMINAL : PHOSPHOR BRONZE PLATED WITH :
 BASE FINISH: NICKEL
 CONTACT SURFACE FINISH:
 GOLD
 OR
 GOLD FLASH OVER PALLADIUM NICKEL.
 EXCEEDS PRODUCT REQUIREMENTS BASED ON PS-85504-001
 SHIELD : BRASS PLATED WITH 0.0020 MIN TIN

2- P.C. BOARD THICKNESS : 1.57

PART No.
85504-5001

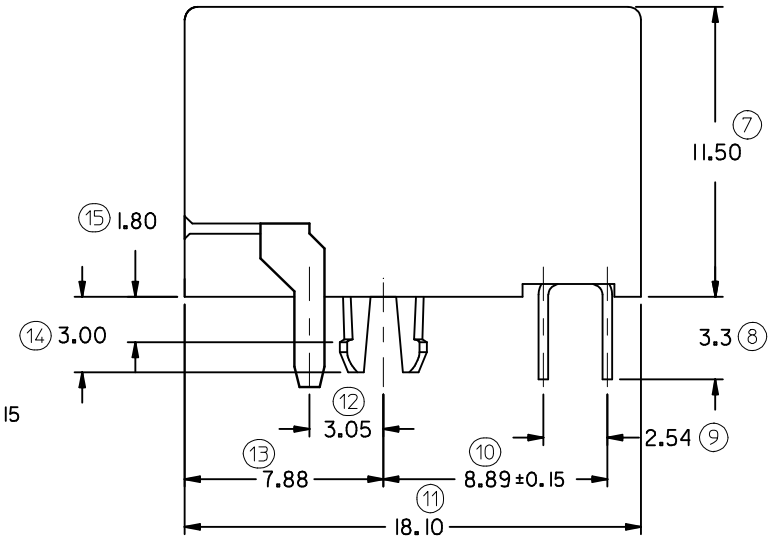
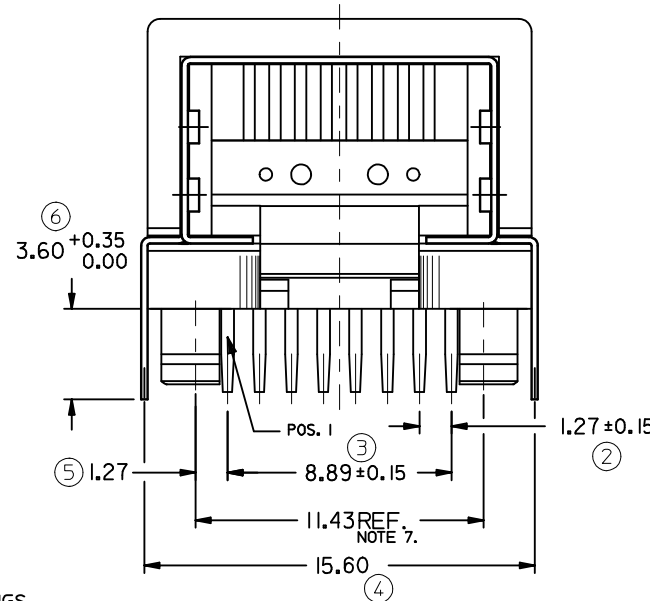
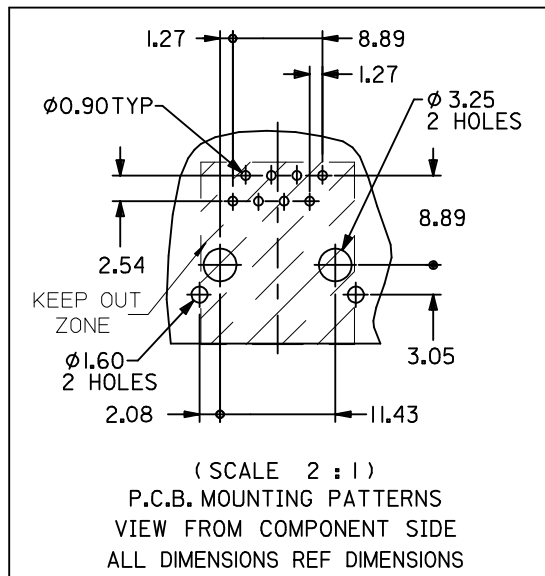
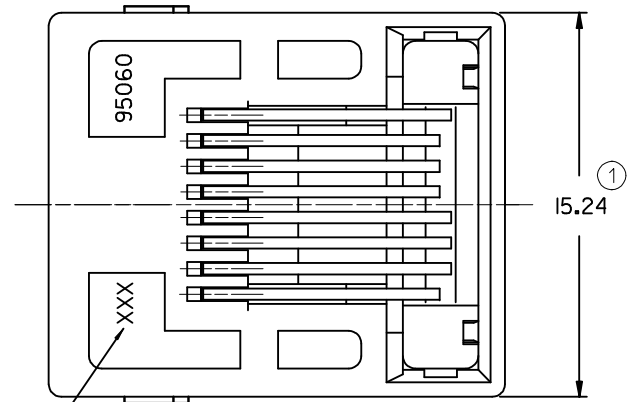
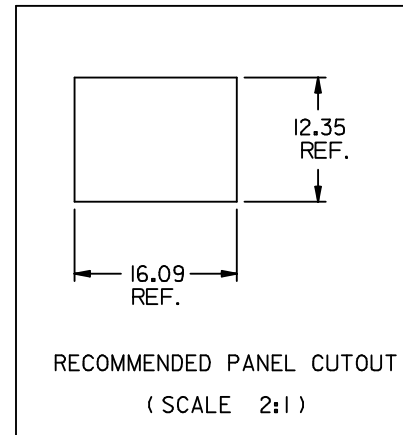

NOTES:

- JACK FOR MATING WITH IEC 60603-7 AND TIA-1096-A PLUGS (95043 MOLEX SERIES).
 - PRODUCT SPECIFICATION: MOLEX PS-85504-001
 - APPLICATION SPECIFICATION: SEE AS-85513-001
 - PACKAGING SPECIFICATION: MOLEX PK-95040
 - EXCEEDS CATEGORY 5E PERFORMANCE
 - LOGO MAY BE MXF, MG OR MXI
 - TRUE CENTRE OF PEGS.
- LAST INSPECTION NUMBER: 15

MODIFIED NOTE 1 EC NO: IPG2013-1394 2013/03/07 DRWN:DBYRNES 2013/03/20 CHKD:FDUGAN 2013/04/03 APPR:STGRIFFIN	DESCRIPTION	QUALITY SYMBOLS <div>▽=0</div> <div>◻=0</div>	GENERAL TOLERANCES (UNLESS SPECIFIED)		DIMENSION STYLE MM ONLY		SCALE 5:1	DESIGN UNITS METRIC	THIRD ANGLE PROJECTION				
				mm	INCH	DRAWN BY HB	DATE 99/07/07	TITLE RIGHT ANGLE LOW PROFILE CATEGORY 5 SHIELDED PC JACK (THROUGH HOLE)					
			4 PLACES	± ---	± ---	CHECKED BY	DATE						
			3 PLACES	± ---	± ---								
			2 PLACES	± 0.25	± ---								
			1 PLACE	± 0.35	± ---	APPROVED BY FB	DATE	MOLEX MOLEX INCORPORATED					
			ANGULAR ± 2 °		MATERIAL NO.	DOCUMENT NO.	SHEET NO.						
			DRAFT WHERE APPLICABLE MUST REMAIN WITHIN DIMENSIONS		SEE CHART	SD-85504-501	1 OF 1						
			REV	THIS DRAWING CONTAINS INFORMATION THAT IS PROPRIETARY TO MOLEX INCORPORATED AND SHOULD NOT BE USED WITHOUT WRITTEN PERMISSION									