



Chipsmall Limited consists of a professional team with an average of over 10 year of expertise in the distribution of electronic components. Based in Hongkong, we have already established firm and mutual-benefit business relationships with customers from,Europe,America and south Asia,supplying obsolete and hard-to-find components to meet their specific needs.

With the principle of “Quality Parts,Customers Priority,Honest Operation,and Considerate Service”,our business mainly focus on the distribution of electronic components. Line cards we deal with include Microchip,ALPS,ROHM,Xilinx,Pulse,ON,Everlight and Freescale. Main products comprise IC,Modules,Potentiometer,IC Socket,Relay,Connector.Our parts cover such applications as commercial,industrial, and automotives areas.

We are looking forward to setting up business relationship with you and hope to provide you with the best service and solution. Let us make a better world for our industry!



## Contact us

Tel: +86-755-8981 8866 Fax: +86-755-8427 6832

Email & Skype: info@chipsmall.com Web: www.chipsmall.com

Address: A1208, Overseas Decoration Building, #122 Zhenhua RD., Futian, Shenzhen, China



**DIE PROGRESSION DIRECTION**

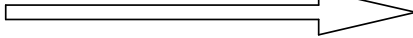

**TO CRIMPING TOOL**

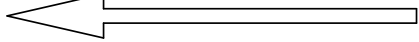

**NOTES:**

- 1) TERMINAL TO CRIMP WITH AWG#26 WIRE (UL1061 IS RECOMMENDED).
- 2) TERMINAL TO USE HOUSING P/N 87439-\*\*\*0\*.
- 3) REFER CRIMP SPECIFICATION CS-87421.
- 4) REFER PRODUCT SPECIFICATION PS-87437.

PART #	FINISH
87421-0000	2.5µM TIN
87421-0002	GOLD FLASH (SELECTIVE) OVER 1.0 µM NICKEL OVERALL

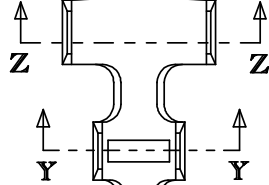
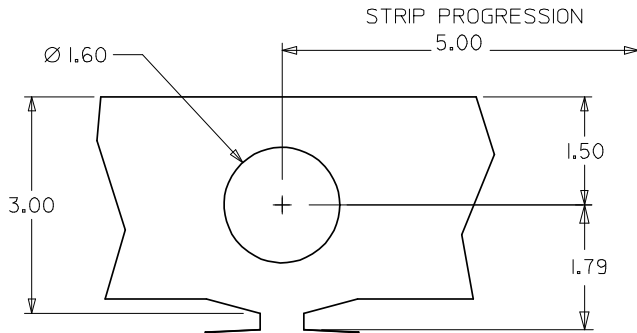

MIN GOLD FLASH  
PLATING LENGTH

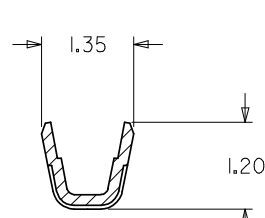
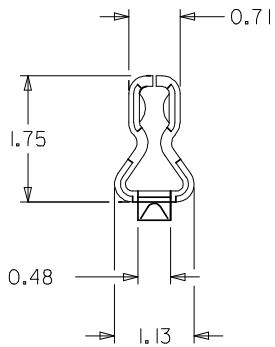

**SECT. Y-Y**

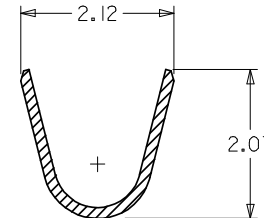

**SECT. Z-Z**

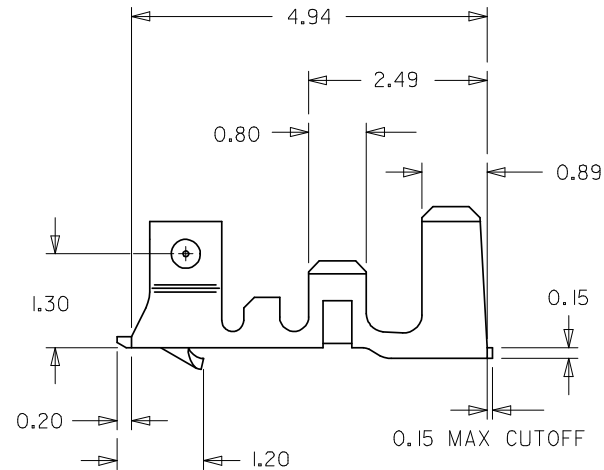

REVISED EC NO: J2008-3226 DRAWN: SLEE 2008/03/24 CHKD: NIKITA 2008/04/09 APPR: SLEE 2008/04/09	QUALITY SYMBOLS	SEE TABLE	NTS MM ONLY	SCALE	DESIGN UNITS METRIC	THIRD ANGLE PROJECTION															
	▼=0 ▽=0	<table border="1"> <thead> <tr> <th></th> <th>mm</th> <th>INCH</th> </tr> </thead> <tbody> <tr> <td>4 PLACES</td> <td>±---</td> <td>±---</td> </tr> <tr> <td>3 PLACES</td> <td>±---</td> <td>±---</td> </tr> <tr> <td>2 PLACES</td> <td>±0.20</td> <td>±---</td> </tr> <tr> <td>1 PLACE</td> <td>±---</td> <td>±---</td> </tr> </tbody> </table>		mm	INCH	4 PLACES	±---	±---	3 PLACES	±---	±---	2 PLACES	±0.20	±---	1 PLACE	±---	±---	DRAWN BY: SKANG DATE: 2007/07/18 CHECKED BY: ATSEE DATE: 2007/07/25 APPROVED BY: MLONG DATE: 2007/07/25	TITLE	1.50MM PITCH CRIMP	
		mm	INCH																		
	4 PLACES	±---	±---																		
3 PLACES	±---	±---																			
2 PLACES	±0.20	±---																			
1 PLACE	±---	±---																			
ANGULAR ± 3 ° DRAFT WHERE APPLICABLE MUST REMAIN WITHIN DIMENSIONS	MATERIAL NO. SEE TABLE	MOLEX INCORPORATED DOCUMENT NO. SD-87421-0000	SHEET NO. 1 OF 1																		
	THIS DRAWING CONTAINS INFORMATION THAT IS PROPRIETARY TO MOLEX INCORPORATED AND SHOULD NOT BE USED WITHOUT WRITTEN PERMISSION																				