



Chipsmall Limited consists of a professional team with an average of over 10 year of expertise in the distribution of electronic components. Based in Hongkong, we have already established firm and mutual-benefit business relationships with customers from,Europe,America and south Asia,supplying obsolete and hard-to-find components to meet their specific needs.

With the principle of “Quality Parts,Customers Priority,Honest Operation,and Considerate Service”,our business mainly focus on the distribution of electronic components. Line cards we deal with include Microchip,ALPS,ROHM,Xilinx,Pulse,ON,Everlight and Freescale. Main products comprise IC,Modules,Potentiometer,IC Socket,Relay,Connector.Our parts cover such applications as commercial,industrial, and automotives areas.

We are looking forward to setting up business relationship with you and hope to provide you with the best service and solution. Let us make a better world for our industry!



Contact us

Tel: +86-755-8981 8866 Fax: +86-755-8427 6832

Email & Skype: info@chipsmall.com Web: www.chipsmall.com

Address: A1208, Overseas Decoration Building, #122 Zhenhua RD., Futian, Shenzhen, China



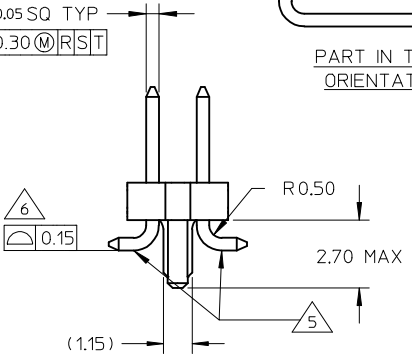
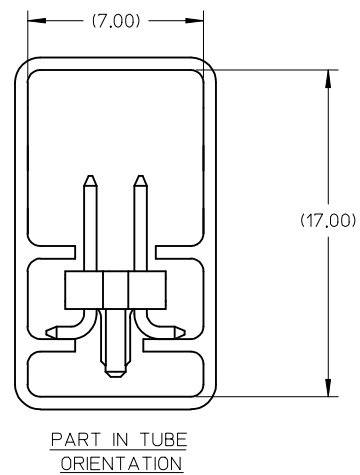
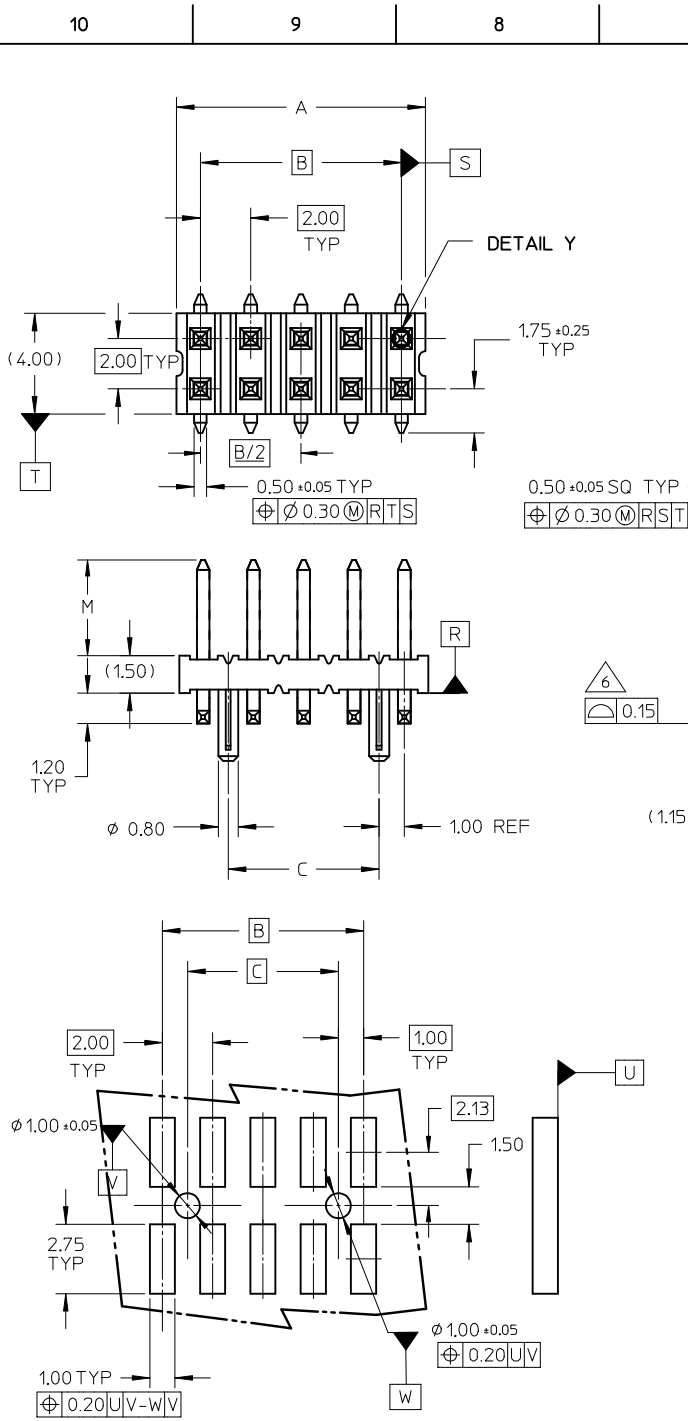

NOTE:

1. MATERIAL:
HSG - HIGH TEMPERATURE THERMOPLASTIC, UL 94V-0, COLOUR BLACK
PIN - 0.50 SQ PHOSPHOR BRONZE
2. PLATING:
 **50 / **52 - 0.38um MIN GOLD PLATE AT CONTACT AREA, TIN PLATE AT SOLDER AREA, BOTH OVER NICKEL UNDERPLATE
 **51 - 0.76um MIN GOLD PLATE AT CONTACT AREA, TIN PLATE AT SOLDER AREA, BOTH OVER NICKEL UNDERPLATE
 **77 - 0.05-0.25um GOLD PLATE AT CONTACT AREA, TIN PLATE AT SOLDER AREA, BOTH OVER NICKEL UNDERPLATE
 (** - REPRESENTS DIFFERENT CKT SIZE . SEE TABLE AT SHT 2)
3. PIN PUSHOUT FORCE: 1KG MIN IN EITHER DIRECTION
4. PRODUCT SPEC PS-87761-100 APPLIES.
5. BEND DEPRESSION IS ACCEPTABLE SO LONG AS IT DOES NOT AFFECT THE OVERALL COPLANARITY OF TAIL.
6. COPLANARITY IS TO BE MEASURED BY RESTING THE SOLDER TAIL ON A FLAT SURFACE.
7. FOR ILLUSTRATION PURPOSES, 10CKT IS SHOWN
8. TUBE LENGTH IS 560MM REF STANDARD.
9. RECOMMENDED PCB BOARD THK IS 1.60±0.10 MM.

ADD RIB DIM @ C7 EC NO: S2016-0864 DRWING: MENARLY 2016/02/18 CHKD: CGOH 2016/04/05 APPR: KILLIM 2016/04/05	QUALITY SYMBOLS	GENERAL TOLERANCES (UNLESS SPECIFIED)		DIMENSION STYLE MM ONLY		SCALE NTS	DESIGN UNITS METRIC	THIRD ANGLE PROJECTION	
	$F_A = 0$	4 PLACES	mm	INCH	DRAWN BY KSEE	DATE 2003/12/24	TITLE CUSTOM HEADER MGRID, 2MM DUAL ROW HDR WITH PEG, SMT		
	$F_G = 0$	3 PLACES	± ---	± ---	CHECKED BY KCLING	DATE 2004/01/12	<div style="text-align: center; font-weight: bold; font-size: 1.2em;">molex</div>		
	$F_B = 0$	2 PLACES	± 0.2	± ---	APPROVED BY SKTOH	DATE 2004/01/12			
	1 PLACE	± ---	± ---	MATERIAL NO. SEE TABLE		DOCUMENT NO. SD-87759-113		SHEET NO. 1 OF 2	
	0 PLACE	±	±	DRAFT WHERE APPLICABLE MUST REMAIN WITHIN DIMENSIONS		THIS DRAWING CONTAINS INFORMATION THAT IS PROPRIETARY TO MOLEX INCORPORATED AND SHOULD NOT BE USED WITHOUT WRITTEN PERMISSION			

10 9 8 7 6 5 4 3 2 1

F	PART NUMBER WITHOUT CAP IN TUBE	CKT SIZE	8			
	A		B	C	M	
	87759-0850/0851	08	7.90	6.00	4.00	3.80
	87759-0852	08	7.90	6.00	4.00	9.60
	87759-1050/1051	10	9.90	8.00	6.00	3.80
	87759-1250/1251	12	11.90	10.00	8.00	3.80
	87759-1450/1451	14	13.90	12.00	10.00	3.80
	87759-1650/1651	16	15.90	14.00	12.00	3.80
E	87759-1850/1851	18	17.90	16.00	14.00	3.80
	87759-2050/2051	20	19.90	18.00	16.00	3.80
	87759-2250/2251	22	21.90	20.00	18.00	3.80
	87759-2450/2451	24	23.90	22.00	20.00	3.80
	87759-2650/2651	26	25.90	24.00	22.00	3.80
	87759-2850/2851	28	27.90	26.00	24.00	3.80
D	87759-3050/3051	30	29.90	28.00	26.00	3.80
	87759-3250/3251	32	31.90	30.00	28.00	3.80
	87759-3450/3451	34	33.90	32.00	30.00	3.80
	87759-3650/3651	36	35.90	34.00	32.00	3.80
	87759-3850/3851	38	37.90	36.00	34.00	3.80
	87759-4050/4051	40	39.90	38.00	36.00	3.80
C	87759-4250/4251	42	41.90	40.00	38.00	3.80
	87759-4450/4451	44	43.90	42.00	40.00	3.80
	87759-4650/4651	46	45.90	44.00	42.00	3.80
	87759-4850/4851	48	47.90	46.00	44.00	3.80
	87759-5050/5051	50	49.90	48.00	46.00	3.80

B

SEE SHEET 1 EC NO: S2016-0864 DRWN: GMEARLY CHKD: CGOH APPR: KHLIM	2016/02/18 2016/04/05 2016/04/05	DESCRIPTION REV	QUALITY SYMBOLS	GENERAL TOLERANCES (UNLESS SPECIFIED)	DIMENSION STYLE	SCALE	DESIGN UNITS	THIRD ANGLE PROJECTION			
			$\nabla = 0$ $\nabla = 0$ $\nabla = 0$	mm INCH 4 PLACES ± --- ± --- 3 PLACES ± --- ± --- 2 PLACES ± 0.2 ± --- 1 PLACE ± --- ± --- 0 PLACE ± ±	MM ONLY	NTS	METRIC	DRAWN BY: KSEE DATE: 2003/12/24 CHECKED BY: KCLING DATE: 2004/01/12 APPROVED BY: SKTOH DATE: 2004/01/12	TITLE: CUSTOM HEADER MGRID, 2MM DUAL ROW HDR WITH PEG, SMT		
			ANGULAR ± 3 ° DRAFT WHERE APPLICABLE MUST REMAIN WITHIN DIMENSIONS	SEE TABLE	MATERIAL NO.	DOCUMENT NO.	molex		SHEET NO. 2 OF 2		
			THIS DRAWING CONTAINS INFORMATION THAT IS PROPRIETARY TO MOLEX INCORPORATED AND SHOULD NOT BE USED WITHOUT WRITTEN PERMISSION				SD-87759-113		SEE TABLE		

A

9 8 7 6 5 4 3 2 1